

TEMPORARY TRAFFIC CONTROL TYPICAL APPLICATION

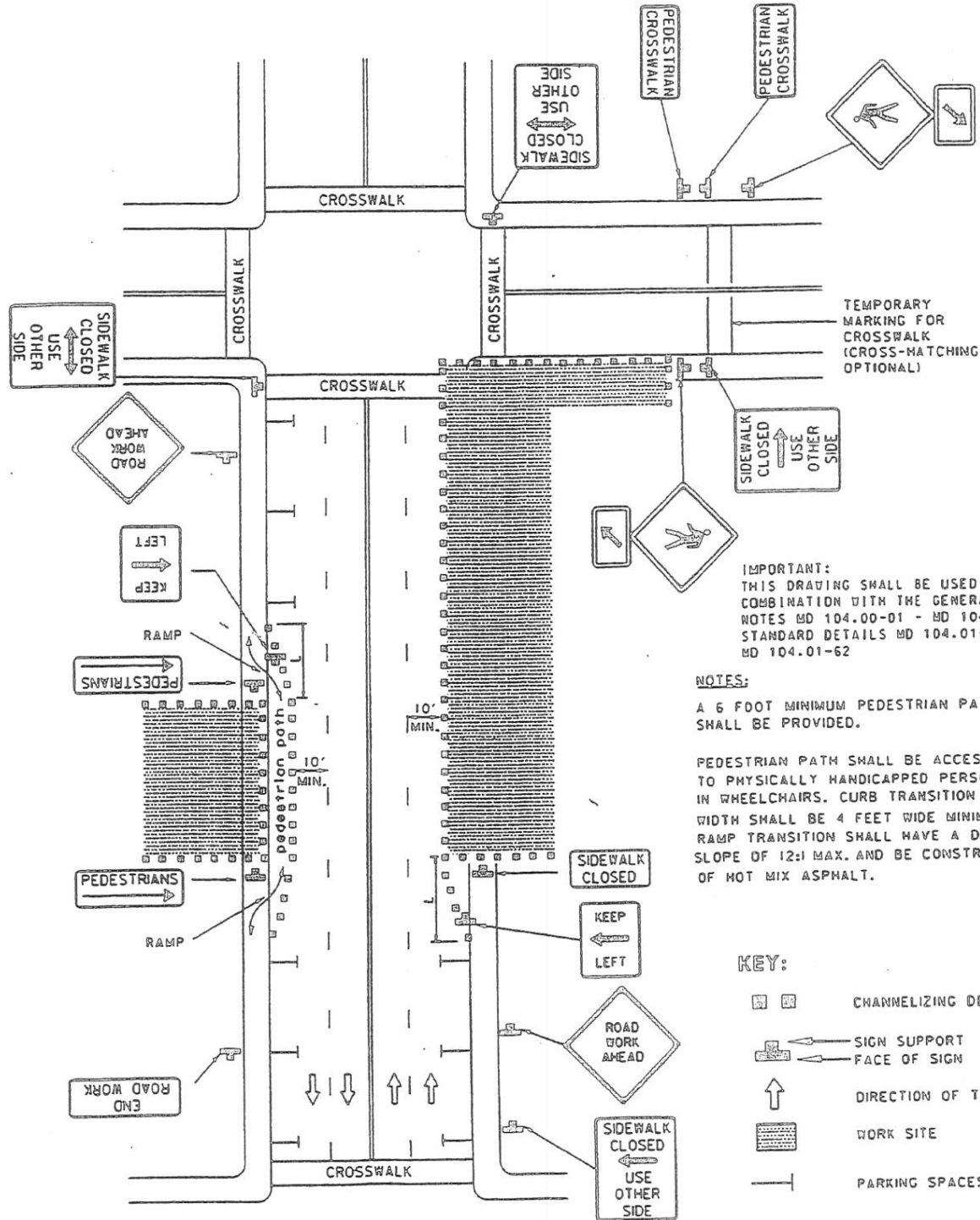

SPECIFICATION 104	CATEGORY CODE ITEMS
APPROVED	DIRECTOR - OFFICE OF TRAFFIC AND SAFETY
APPROVAL - SHA REVISIONS	APPROVAL - FEDERAL HIGHWAY ADMINISTRATION
APPROVAL 8-20-03	APPROVAL 9-23-03
REVISED	REVISED
REVISED	REVISED
REVISED	REVISED

Maryland Department of Transportation
STATE HIGHWAY ADMINISTRATION
 STANDARDS FOR HIGHWAYS AND INCIDENTAL STRUCTURES
 PED AND CURB-LANE CONTROL /MULTILANE UNDIV.
 ALL SPEEDS /OVER 12 HRS. OR NIGHTTIME USE

STANDARD NO.

MD 104.06-05

TEMPORARY TRAFFIC CONTROL TYPICAL APPLICATION FOR SIDEWALK CLOSURE ALTERNATE PEDESTRIAN ROUTE USING ROADWAY LANE OR SHOULDER

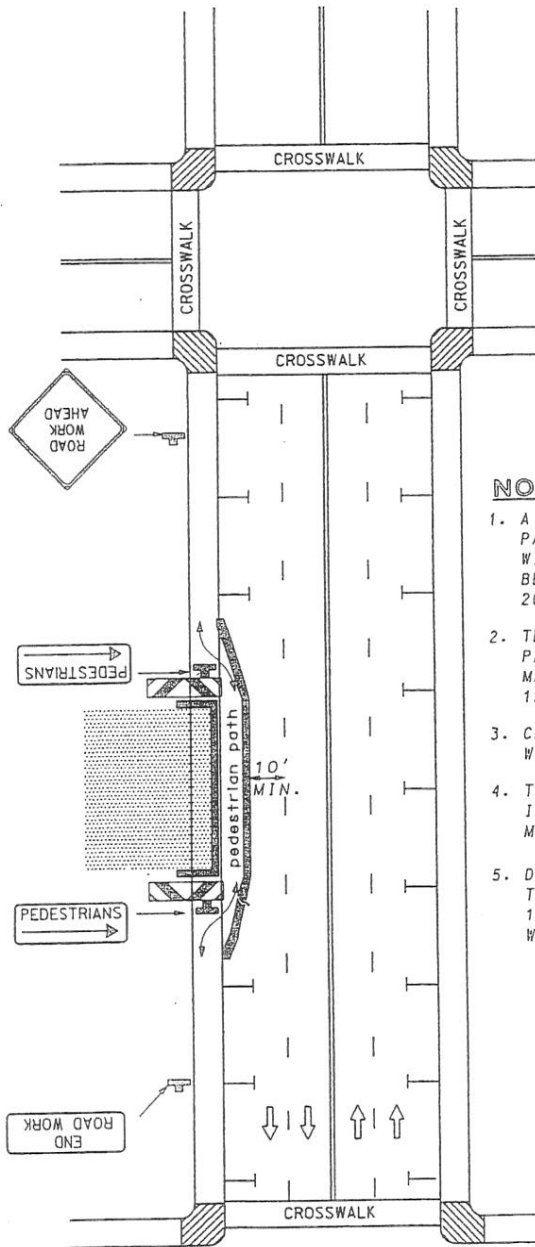









IMPORTANT:
THIS DRAWING SHALL BE USED IN
COMBINATION WITH THE GENERAL
NOTES MD 104.00-01 THROUGH MD 104.00-18 AND
STANDARD DETAILS MD 104.01-01 THROUGH MD 104.01-62

NOTES

1. A 5 FOOT MINIMUM WIDTH PEDESTRIAN PATH / ALTERNATE PEDESTRIAN PATH SHALL BE MAINTAINED WHERE POSSIBLE. WHERE A 5 FOOT MIN WIDTH CANNOT BE ACHIEVED, A MINIMUM WIDTH OF 36 INCHES SHALL BE PROVIDED WITH PASSING ZONES (60 IN X 60 IN) AT LEAST EVERY 200FT.
2. TEMPORARY RAMPS SHALL HAVE A SLOPE OF 12:1 MAX. THE PEDESTRIAN PATH AND RAMP SHALL BE CONSTRUCTED OF HOT MIX ASPHALT OR OTHER MATERIAL THAT CAN PROVIDE SMOOTH, HARD SURFACE & WILL MAINTAIN 12:1 SLOPE.
3. CHANNELIZING DEVICES SHALL BE TEMPORARY CONCRETE BARRIERS WITH THE ADDITION OF CONTINUOUS DETECTABLE EDGING.
4. THE CONTINUOUS DETECTABLE EDGINGS SHALL PROTRUDE AT LEAST 6 INCHES ABOVE THE PATHWAY WITH THE BOTTOM OF THE EDGING NO MORE THAN 1 1/2 INCHES ABOVE THE PATHWAY.
5. DETECTABLE BARRICADES SHALL EXTEND AT LEAST 36" ABOVE THE PATHWAY WITH THE BOTTOM OF THE BARRICADE NO MORE THAN 1 1/2 INCHES ABOVE THE PATHWAY, AND SHALL EXTEND THE FULL WIDTH OF THE CLOSURE

KEY:

-  SIGN
-  CHANNELIZING DEVICES WITH DETECTABLE EDGING
-  DETECTABLE BARRICADE
-  DIRECTION OF TRAFFIC
-  WORK SITE
-  PARKING SPACES / SHOULDER AREA
-  TEMPORARY RAMP (WITH DETECTABLE SURFACE WARNING)
-  EXISTING CURB RAMP

SPECIFICATION 104	CATEGORY CODE ITEMS										
APPROVED	DIRECTOR - OFFICE OF TRAFFIC AND SAFETY										
SHA State Highway Administration	<table> <tr> <td>APPROVAL • SHA REVISIONS</td><td>APPROVAL • FEDERAL HIGHWAY ADMINISTRATION</td></tr> <tr> <td>APPROVAL 7-14-08</td><td>APPROVAL 7-3-08</td></tr> <tr> <td>REVISED</td><td>REVISED</td></tr> <tr> <td>REVISED</td><td>REVISED</td></tr> <tr> <td>REVISED</td><td>REVISED</td></tr> </table>	APPROVAL • SHA REVISIONS	APPROVAL • FEDERAL HIGHWAY ADMINISTRATION	APPROVAL 7-14-08	APPROVAL 7-3-08	REVISED	REVISED	REVISED	REVISED	REVISED	REVISED
APPROVAL • SHA REVISIONS	APPROVAL • FEDERAL HIGHWAY ADMINISTRATION										
APPROVAL 7-14-08	APPROVAL 7-3-08										
REVISED	REVISED										
REVISED	REVISED										
REVISED	REVISED										

Maryland Department of Transportation
STATE HIGHWAY ADMINISTRATION
STANDARDS FOR HIGHWAYS AND INCIDENTAL STRUCTURES
PED AND CURB-LANE CONTROL/MULTILANE
UNDIV. SPEED LESS THAN OR EQUAL TO
40 MPH /OVER 12 HRS. OR NIGHTTIME USE
STANDARD NO. MD 104.06-05A

TEMPORARY TRAFFIC CONTROL TYPICAL APPLICATION ALTERNATE PEDESTRIAN DETOUR ROUTE AT INTERSECTION

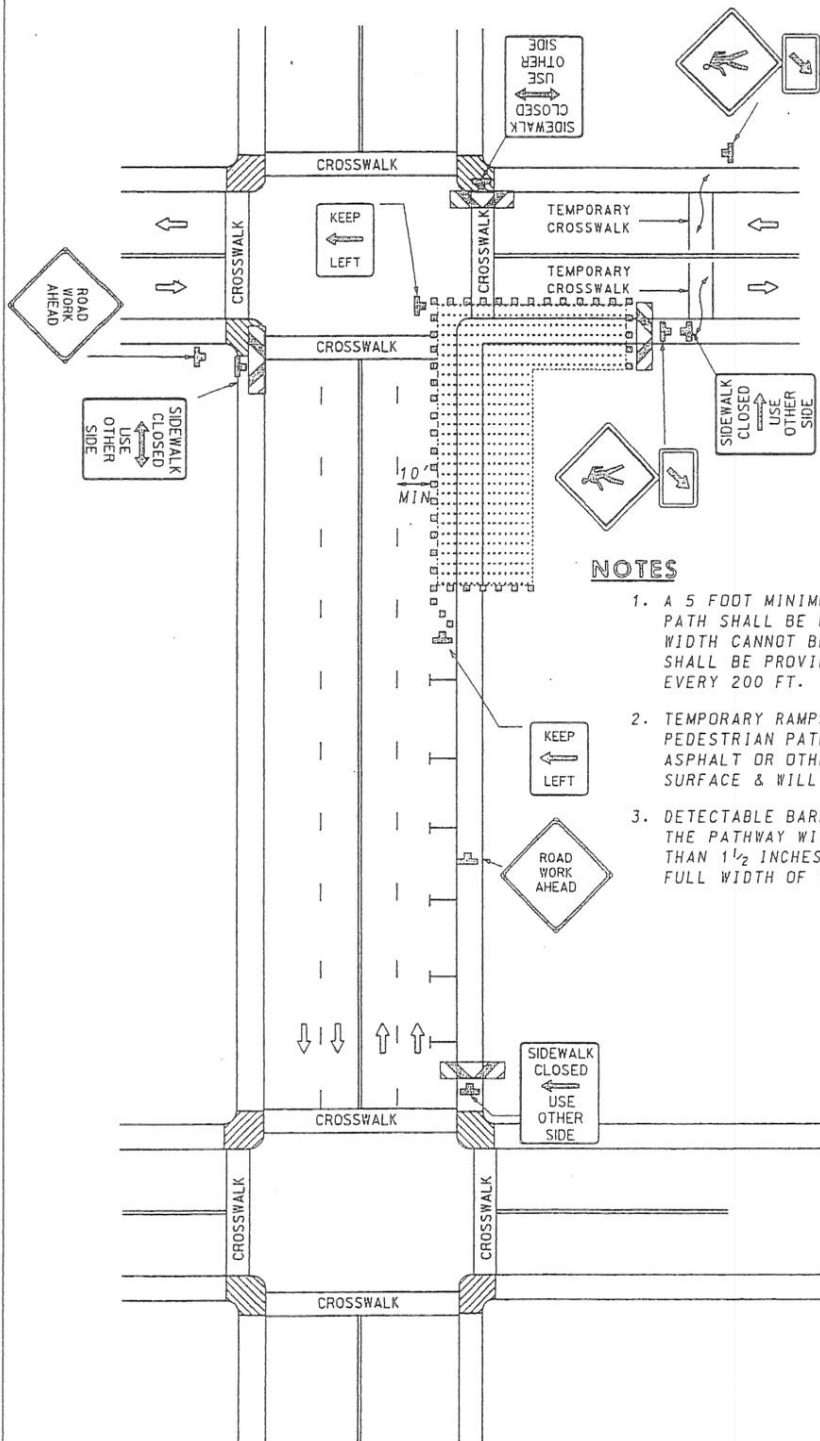

IMPORTANT:
THIS DRAWING SHALL BE USED IN
COMBINATION WITH THE GENERAL
NOTES MD 104.00-01 THROUGH MD
104.00-18 AND STANDARD DETAILS
MD 104.01-01 THROUGH MD 104.01-62

NOTES

1. A 5 FOOT MINIMUM WIDTH PEDESTRIAN PATH / ALTERNATE PEDESTRIAN PATH SHALL BE MAINTAINED WHERE POSSIBLE. WHERE A 5 FOOT MIN. WIDTH CANNOT BE ACHIEVED, A MINIMUM WIDTH OF 36 INCHES SHALL BE PROVIDED WITH PASSING ZONES (60 IN X 60 IN) AT LEAST EVERY 200 FT.
2. TEMPORARY RAMPS SHALL HAVE A SLOPE OF 12:1 MAX. THE PEDESTRIAN PATH AND RAMP SHALL BE CONSTRUCTED OF HOT MIX ASPHALT OR OTHER MATERIAL THAT CAN PROVIDE A SMOOTH, HARD SURFACE & WILL MAINTAIN 12:1 SLOPE.
3. DETECTABLE BARRICADES SHALL EXTEND AT LEAST 36" ABOVE THE PATHWAY WITH THE BOTTOM OF THE BARRICADE NO MORE THAN 1 1/2 INCHES ABOVE THE PATHWAY, AND SHALL EXTEND THE FULL WIDTH OF THE CLOSURE.

KEY:

- ↑ DIRECTION OF TRAFFIC
- ▨ WORK SITE
- ↗ TEMPORARY RAMP (WITH DETECTABLE SURFACE WARNING)
- ⬮ SIGN
- ▩ DETECTABLE BARRICADE
- └─ PARKING SPACES / SHOULDER AREA
- ▨ EXISTING CURB RAMPS
- □ □ CHANNELIZING DEVICES

SPECIFICATION
104

CATEGORY CODE ITEMS

APPROVED

DIRECTOR - OFFICE OF TRAFFIC AND SAFETY



APPROVAL • SHA REVISIONS	APPROVAL • FEDERAL HIGHWAY ADMINISTRATION
APPROVAL 7-14-08	APPROVAL 7-3-08
REVISED	REVISED
REVISED	REVISED
REVISED	REVISED

Maryland Department of Transportation
STATE HIGHWAY ADMINISTRATION
STANDARDS FOR HIGHWAYS AND INCIDENTAL STRUCTURES
PED AND CURB-LANE CONTROL / MULTILANE
UNDIV. FOR SPEEDS GREATER THAN 40MPH /
OVER 12 HRS. OR NIGHTTIME USE

STANDARD NO.

MD 104.06-05B

TEMPORARY TRAFFIC CONTROL TYPICAL APPLICATION FOR SIDEWALK CLOSURE ALTERNATE PEDESTRIAN DETOUR ROUTE FOR FULL BLOCK CLOSURE

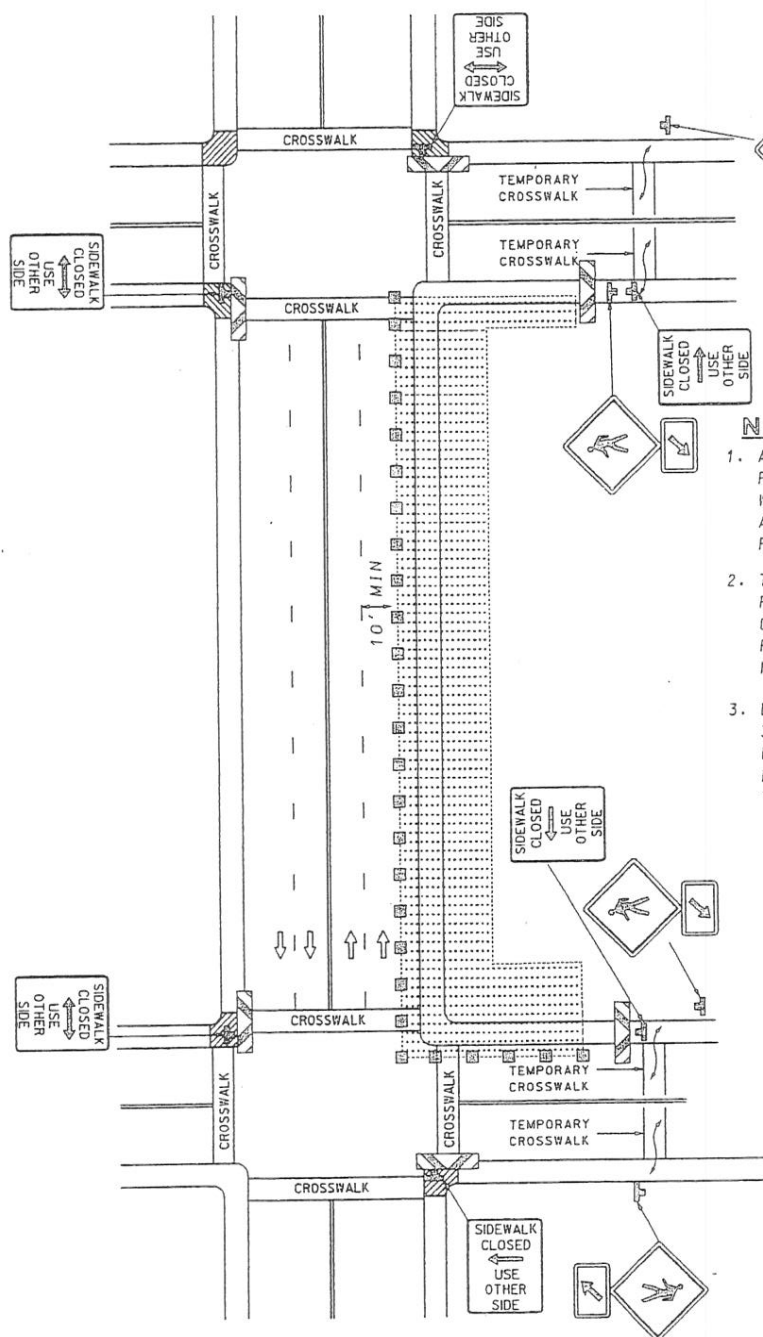

IMPORTANT:
THIS DRAWING SHALL BE USED IN
COMBINATION WITH THE GENERAL
NOTES MD 104.00-01 THROUGH MD 104.00-18 AND
STANDARD DETAILS MD 104.01-01 THROUGH
MD 104.01-62

NOTES

1. A 5 FOOT MINIMUM WIDTH PEDESTRIAN PATH / ALTERNATE PEDESTRIAN PATH SHALL BE MAINTAINED WHERE POSSIBLE. WHERE A 5 FOOT MINIMUM WIDTH CANNOT BE ACHIEVED, A MINIMUM WIDTH OF 36 INCHES SHALL BE PROVIDED WITH PASSING ZONES (60 IN X 60 IN) AT LEAST EVERY 200 FT.
2. TEMPORARY RAMPS SHALL HAVE A SLOPE OF 12:1 MAX. PEDESTRIAN PATH AND RAMP SHALL BE CONSTRUCTED OF HOT MIX ASPHALT OR OTHER MATERIAL THAT CAN PROVIDE A SMOOTH, HARD SURFACE & WILL MAINTAIN 12:1 SLOPE.
3. DETECTABLE BARRICADES SHALL EXTEND AT LEAST 36" ABOVE THE PATHWAY WITH THE BOTTOM OF THE BARRICADE NO MORE THAN 1 1/2 INCHES ABOVE THE PATHWAY, AND SHALL EXTEND THE FULL WIDTH OF THE CLOSURE.

KEY:

- SIGN
- DIRECTION OF TRAFFIC
- WORK SITE
- TEMPORARY RAMP (WITH DETECTABLE SURFACE WARNING)
- DETECTABLE BARRICADE
- EXISTING CURB RAMPS
- CHANNELIZING DEVICES

SPECIFICATION
104

CATEGORY CODE ITEMS

APPROVED

DIRECTOR - OFFICE OF TRAFFIC AND SAFETY



APPROVAL • SHA REVISIONS	APPROVAL • FEDERAL HIGHWAY ADMINISTRATION
APPROVAL 7-14-08	APPROVAL 7-3-08
REVISED	REVISED
REVISED	REVISED
REVISED	REVISED

Maryland Department of Transportation
STATE HIGHWAY ADMINISTRATION
STANDARDS FOR HIGHWAYS AND INCIDENTAL STRUCTURES
PED AND CURB-LANE CONTROL/MULTILANE
UNDIV. AND SPEED /OVER 12 HRS.
OR NIGHTTIME USE

STANDARD NO.

MD-104.06-05C

TEMPORARY TRAFFIC CONTROL TYPICAL APPLICATION ALTERNATE PEDESTRIAN DETOUR ROUTE USING OPPOSITE SIDEWALK

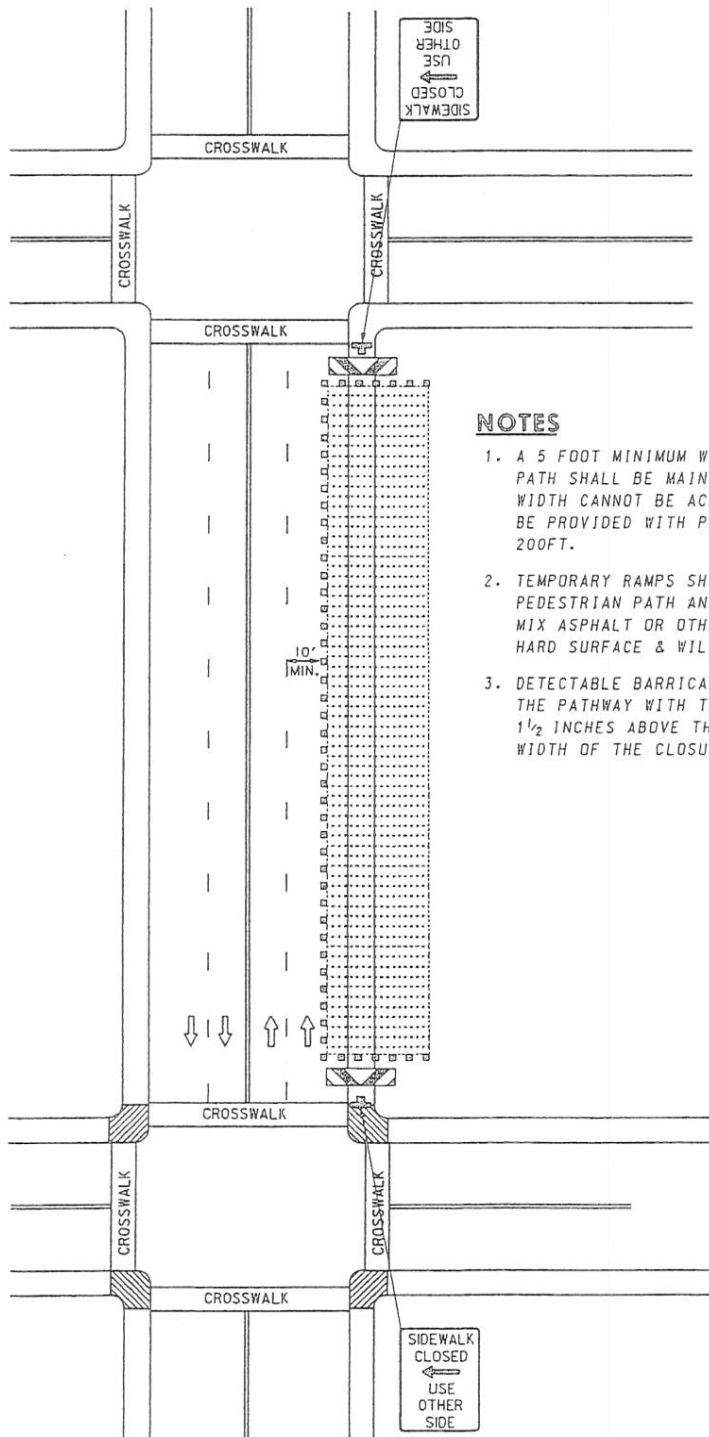

IMPORTANT:
THIS DRAWING SHALL BE USED IN
COMBINATION WITH THE GENERAL
NOTES MD 104.00-01 THROUGH MD 104.00-18 AND
STANDARD DETAILS MD 104.01-01 -
MD 104.01-62

NOTES

1. A 5 FOOT MINIMUM WIDTH PEDESTRIAN PATH / ALTERNATE PEDESTRIAN PATH SHALL BE MAINTAINED WHERE POSSIBLE. WHERE A 5 FOOT MINIMUM WIDTH CANNOT BE ACHIEVED, A MINIMUM WIDTH OF 36 INCHES SHALL BE PROVIDED WITH PASSING ZONES (60 IN X 60 IN) AT LEAST EVERY 200FT.
2. TEMPORARY RAMPS SHALL HAVE A SLOPE OF 12:1 MAX. THE PEDESTRIAN PATH AND RAMP SHALL BE CONSTRUCTED OF HOT MIX ASPHALT OR OTHER MATERIAL THAT CAN PROVIDE A SMOOTH, HARD SURFACE & WILL MAINTAIN 12:1 SLOPE.
3. DETECTABLE BARRICADES SHALL EXTEND AT LEAST 36" ABOVE THE PATHWAY WITH THE BOTTOM OF THE BARRICADE NO MORE THAN 1 1/2 INCHES ABOVE THE PATHWAY, AND SHALL EXTEND THE FULL WIDTH OF THE CLOSURE.

KEY:

- DIRECTION OF TRAFFIC
- WORK SITE
- SIGN
- DETECTABLE BARRICADE
- EXISTING CURB RAMPS
- CHANNELIZING DEVICES

SPECIFICATION
104

CATEGORY CODE ITEMS

APPROVED

DIRECTOR - OFFICE OF TRAFFIC AND SAFETY



APPROVAL	SHA REVISIONS	APPROVAL	FEDERAL HIGHWAY ADMINISTRATION
APPROVAL	7-14-08	APPROVAL	7-3-08
REVISED		REVISED	
REVISED		REVISED	
REVISED		REVISED	

Maryland Department of Transportation
STATE HIGHWAY ADMINISTRATION
STANDARDS FOR HIGHWAYS AND INCIDENTAL STRUCTURES
PED AND CURB-LANE CONTROL / MULTILANE
UNDIV. FOR SPEEDS GREATER THAN 40MPH /
OVER 12 HRS. OR NIGHTTIME USE
STANDARD NO. MD 104.06-05D

