

Updates From WABA

Garrett Hennigan
Community Organizer

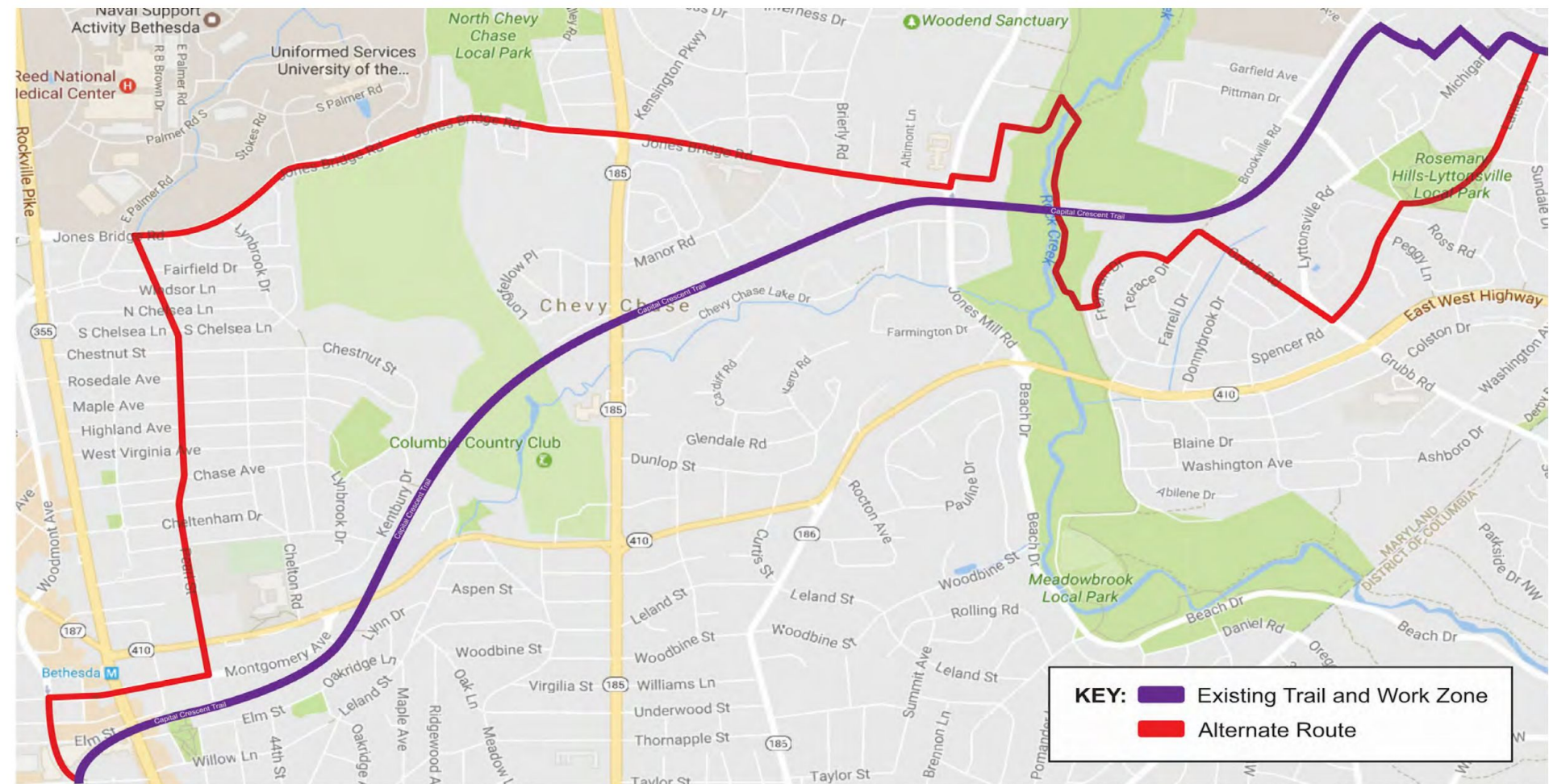



KEY:

- Existing Trail and Work Zone
- Alternate Route

The signed detour route on Woodmont, Montgomery, Pearl, Maryland & Jones Bridge Rd

Solutions in the Bethesda Master Plan

Create great GBT alternatives and build out the Bethesda bicycle network



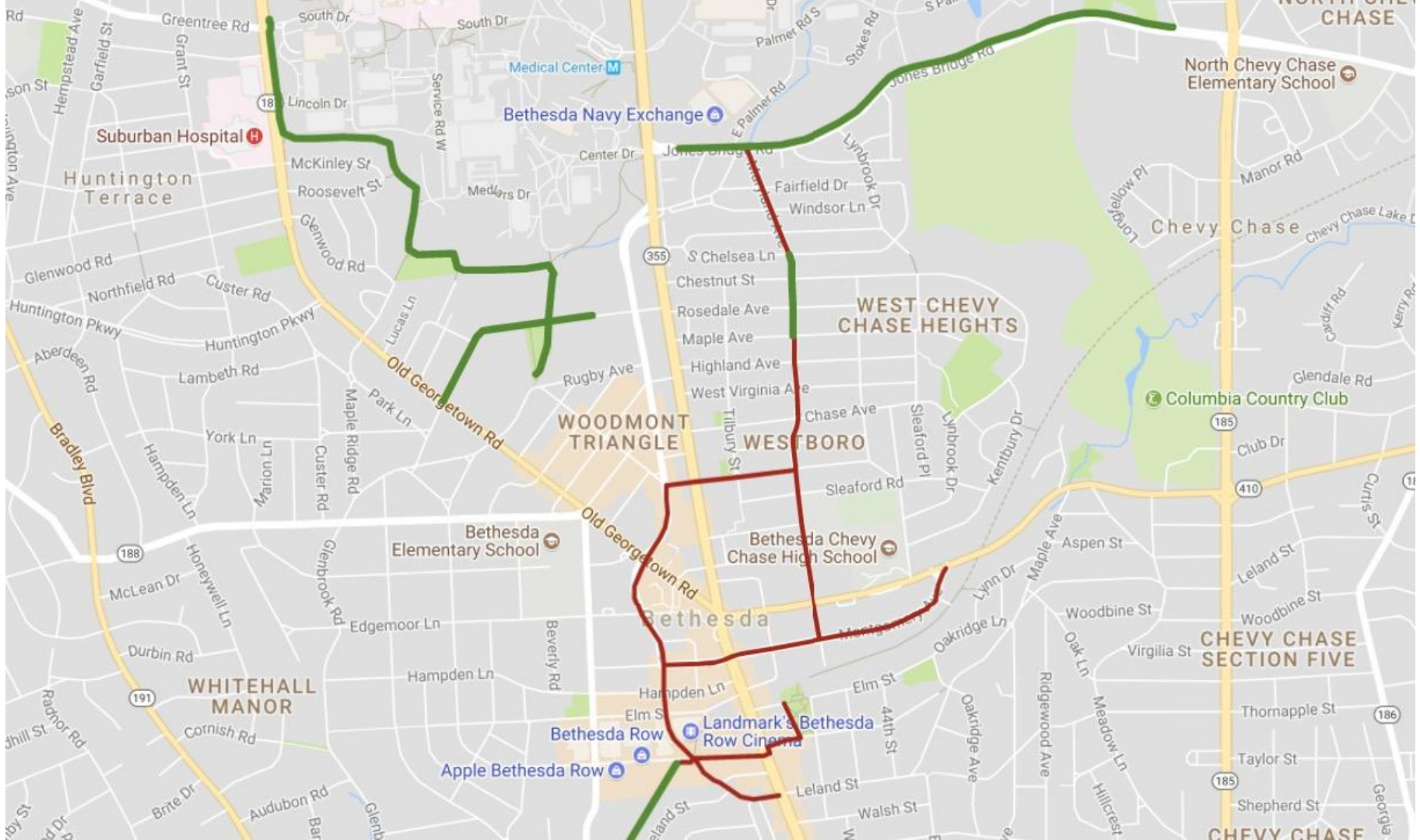

The Core Bethesda Network

- **Woodmont Ave** – 2-way protected bike lane from Wisconsin Ave at Leland St to Norfolk Ave
- **Montgomery Ln / Ave** – 2-way protected bike lane from Woodmont Ave to Pearl St. and East West Highway
- **Pearl St / Maryland Ave Bikeway** – bike lanes and traffic calming
- **Norfolk Ave / Cheltenham Dr. Bikeway** – bike lanes and traffic-calmed neighborhood streets from Woodmont to Pearl St.
- **Capital Crescent Trail Surface Route** – a 2-way protected bike lane crossing Wisconsin Ave. from Woodmont Ave to Elm St via Bethesda Ave, Willow Ln and 47th St.



Commitments

- 750 petition signatures
- County Executive budgeted \$3 million to plan and build the network
- County Council adopted the budget this morning
- Planning is underway
- Construction begins next year on Woodmont Ave

Woodmont Ave Pop-Up Protected Bike Lane

MCDOT installed a pop-up lane for
Bike to Work Day

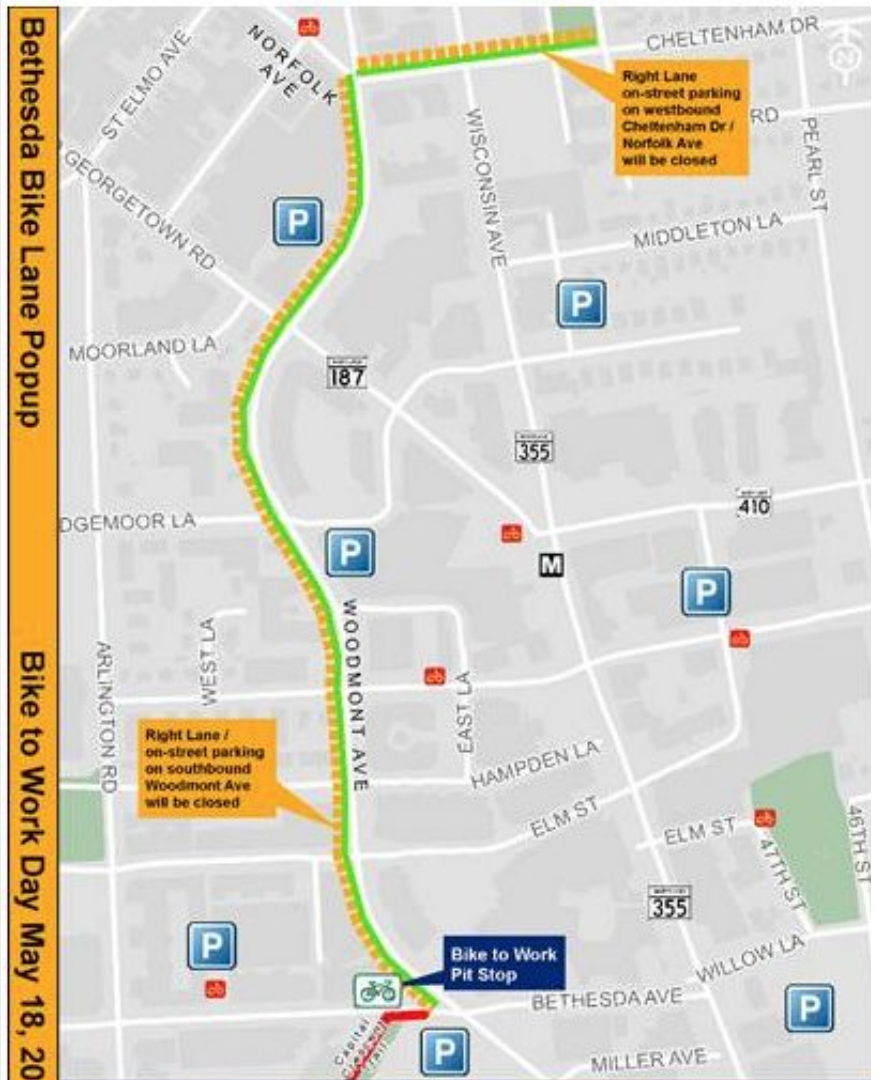









Elm St
4800 BLK 4900 BLK

ONLY

DETOUR
AHEAD

BIKE
LANE
ONLY

P

HT
SED

USE
PED
SIGNAL

ELM STREET
TURNING
VEHICLES
TO

- Protected Bike Lane
- Other Bikeway
- Trail



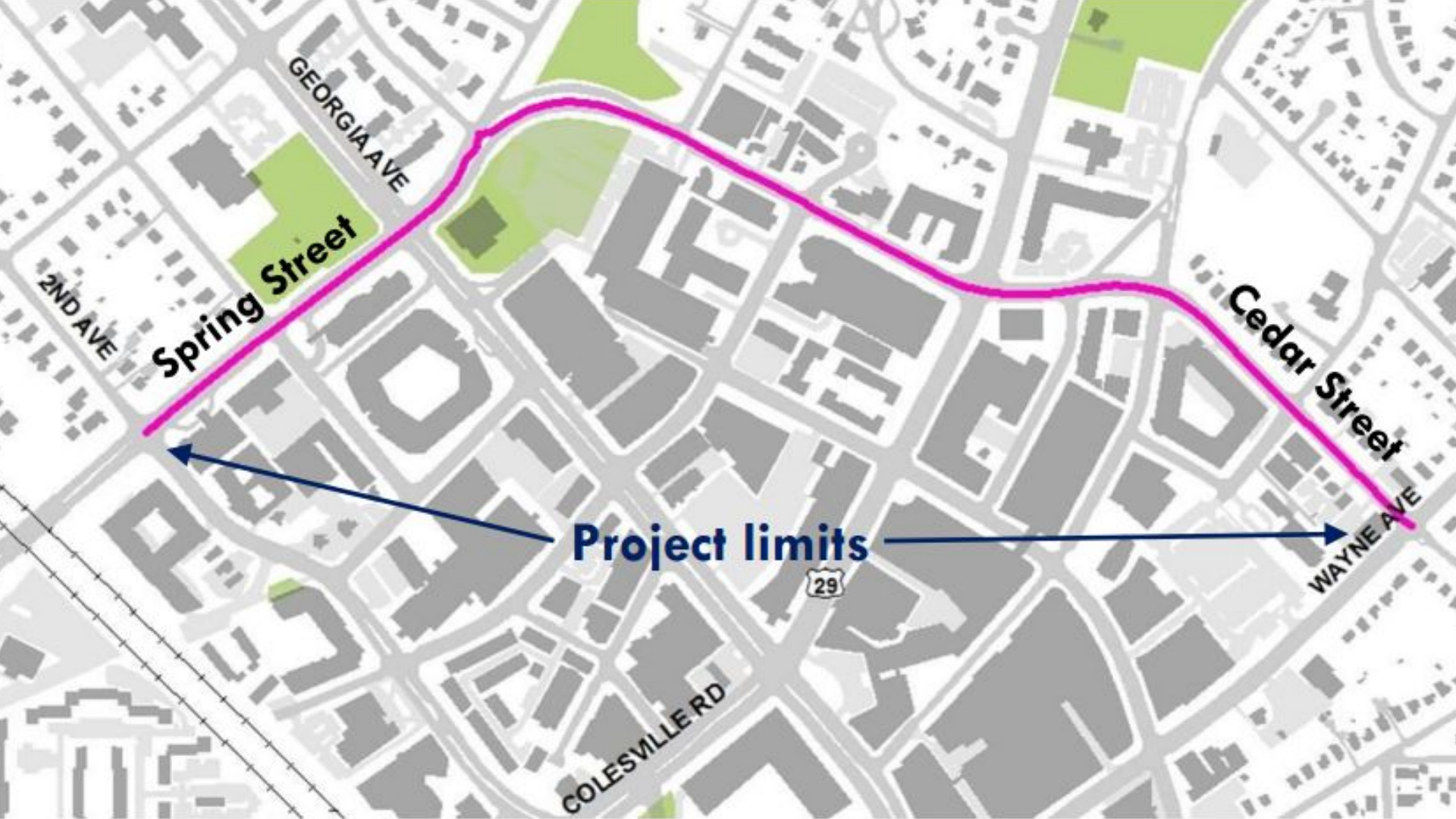

GEORGIA AVE

2ND AVE

Spring Street

Cedar Street

WAYNE AVE

Project limits

29

COLESVILLE RD



WABA
WASHINGTON AREA
BICYCLIST ASSOCIATION





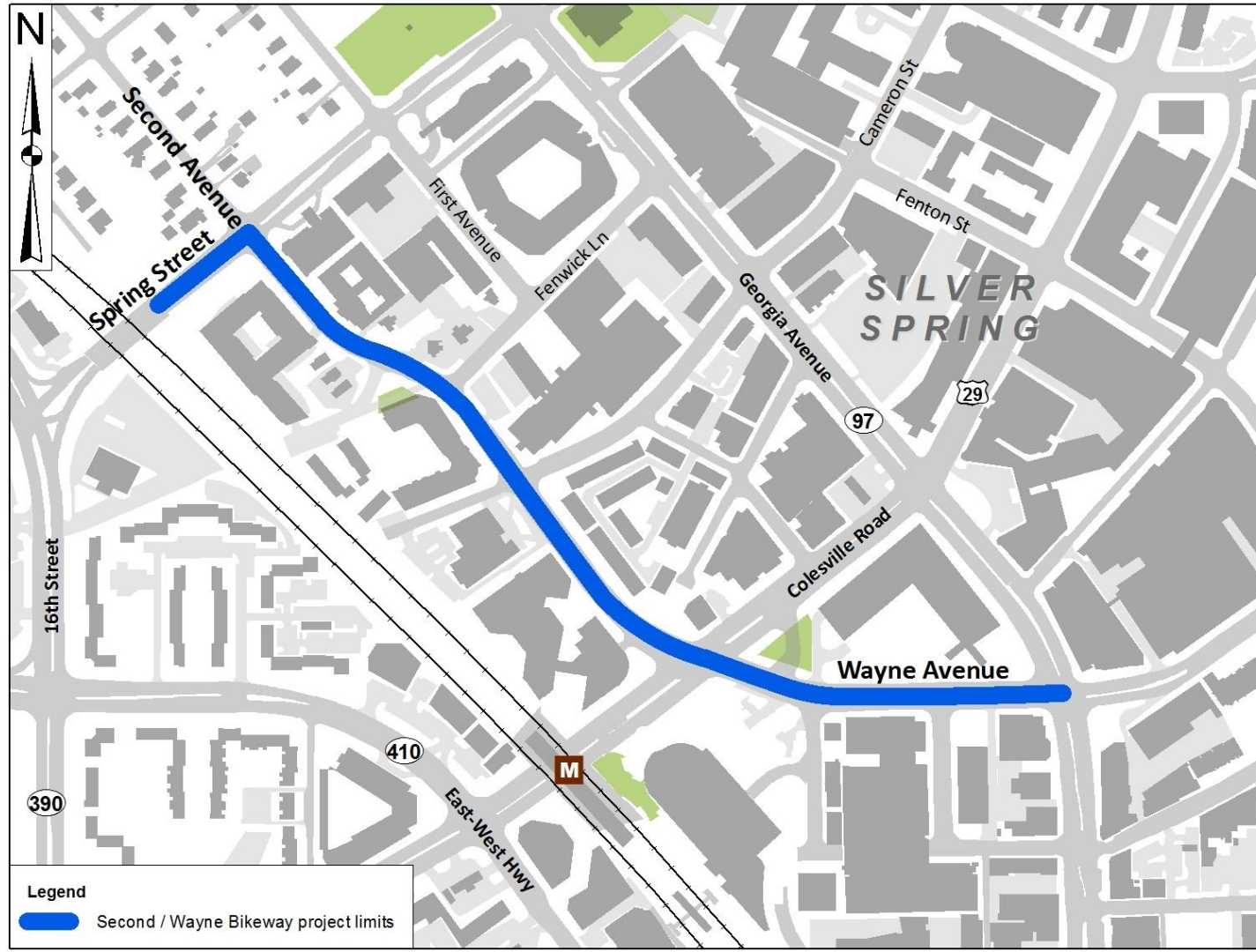

WABA
WASHINGTON AREA
BICYCLIST ASSOCIATION

Silver Spring Social Rides

Planning Department sponsoring a series of rides

- Past Rides: Kruise to Kensington, Earth Day Ride, Silver Spring Art Ride
- **Memorial Day – Monday, May 28**
- **A Sweet Ride - Saturday, June 9**
- **Zoo Ride - Saturday June 23**

Register & Learn More: waba.org/silverspringrides

