

* ONLY PROVIDE QUICK CRETE AS REQUIRED BY INSPECTOR. INSTALL BOLLARD SO AS TO MINIMIZE ROOT IMPACTS.

NOTE: OFFSITE PLANTING AREA: 16201 BATSON ROAD, SPENCERVILLE RD, MD 20868 (PROPOSED LOCATION IS OWNED BY APPLICANT)

FOREST RETENTION AREA SIGNAGE

FOREST CONSERVATION AREA
 DO NOT DISTURB
 UNDER PENALTY OF LAW
 NO DUMPING
 NO MOTORIZED VEHICLES

M-NCPPC
 Environmental Planning
 (301) 495-4540

NOTE:
 SIGNAGE FOR FOREST RETENTION AREA TO BE PLACED 50' O.C. WHEN PLACED ON FENCE
 1. Attachment of signs to trees is prohibited.
 2. Signs should be properly maintained.
 3. Avoid injury to roots when placing posts for the signs.

PLANTING SCHEDULE

TASKS	MONTHS											
	JAN	FEB	MAR	APR	MAY	JUNE	JULY	AUG	SEPT	OCT	NOV	DEC
TRANSPLANT OF DBH OR GREATER	XXXXXX											XXXXXX
PLANTING SEEDINGS, WHIPS												XXXXXX
MINIMUM MONITORING	*					*						*
FERTILIZER + (IF NEEDED)												XXXXXX
WATER **												XXXXXX
PRUNING												XXXXXX

KEY:
 * ACTIVITIES DURING THESE MONTHS ARE DEPENDENT UPON GROUND CONDITIONS
 ** GREATLY RECOMMENDED
 *** DEPENDENT UPON SITE CONDITIONS
 **** DEPENDENT UPON SITE CONDITIONS WEEKLY WATERING IS GREATLY RECOMMENDED FROM MAY THROUGH OCTOBER UNLESS WEEKLY RAINFALL EQUALS 1"

NOTES:
 The planting and care of trees is most successful when coordinated with the local climatic conditions. This calendar summarizes some of the recommended time frames for basic reforestation and stress reduction activities.

- SITE PLANTING & REFORESTATION GENERAL NOTES**
- DRAWINGS ARE FOR TREE CONSERVATION AND REFORESTATION PURPOSES ONLY. AS-BUILT CONDITIONS MAY VARY. THE CONTRACTOR SHALL VERIFY ALL EXISTING CONDITIONS AND UTILITY LOCATIONS SHOWN AND DESCRIBED ON THE DRAWINGS, AND SHALL INFORM NORTON LAND DESIGN, TEL NO. 443-542-9199 OF ANY DISCREPANCIES OR POTENTIAL PROBLEMS PRIOR TO COMMENCING WORK.
 - IN REFORESTATION AREAS ALL BRANCHED DECIDUOUS TREES SHALL BE PLANTED WITH RANDOM SPACING 20.9' ON CENTER. SHRUBS AND CONTAINER GROWN EVERGREENS NOT IN PLANTING BEDS SHALL BE PLANTED IN RANDOM SPACING 33.0' ON CENTER.
 - DO NOT PLANT TREES OR SHRUBS WITHIN 3'-0" OF THE CENTERLINE OF SWALES OR DITCHES.
 - "MISS UTILITY" (1-800-257-7777) MUST BE CONTACTED A MINIMUM OF 48 HOURS PRIOR TO PROCEEDING WITH ANY EXCAVATION FOR PLANT MATERIAL INSTALLATION.
 - NO PLANT MATERIAL SHALL BE PLANTED DIRECTLY IN FRONT OF ROADWAY SIGN SIGHT LINES.
 - PLANT MATERIALS AND PLANTING MEASURES SHALL CONFORM WITH THE "LANDSCAPE SPECIFICATION GUIDELINES FOR THE BALTIMORE-WASHINGTON METROPOLITAN AREAS", LATEST EDITION.
 - ALL PLANTS SHALL BE WATERED FOR A TWO YEAR PERIOD AS REQUIRED. THE CONTRACTOR SHALL PROVIDE SUFFICIENT MANPOWER AND EQUIPMENT TO COMPLETE THE WATERING AS REQUIRED.
 - THE FOLLOWING LIST OF PLANTS SHALL BE PLANTED ONLY DURING THE SPRING PLANTING SEASON: ACER RUBRUM AND QUERCUS SPP. (ALL OAK SPECIES).
 - ALL EXISTING TRASH AND IMPERVIOUS AREAS SHOWN ON THE PLAN TO BE REMOVED MUST BE REMOVED AND ANY DISTURBED SOIL MUST BE STABILIZED AND SEEDDED. IT MAY BE NECESSARY TO SCARIFY AND/OR AERATE THE SOIL.
 - PLANTS SHALL BE INSPECTED BY THE CONTRACTOR AND ANY MATERIAL THAT IS EITHER DAMAGED OR WHICH HAS ROOT BALL COMPACTION, J-ROOTED OR KINKED ROOT SYSTEMS WILL BE REPLACED. NO PLANTS WILL BE STORED ON SITE. PLANTS WILL BE PLANTED IMMEDIATELY ONCE RECEIVED FROM THE NURSERY.
 - STOCK WILL BE PLANTED IN RANDOM ORDER TO REFLECT NATURAL GROWTH OF THE FOREST.
 - PLANTING FIELD SHOULD BE 2X ROOT BALL DIAMETER. NATIVE SOIL MATERIAL WILL BE USED TO BACKFILL PLANT SITE AND AREA WILL BE PACKED TO REMOVE AIR POCKETS. RAKE SOIL EVENLY OVER THE PLANTING FIELD AND COVER HOLE WITH THREE INCHES OF MULCH. WATER TO SETTLE SOIL AND PROVIDE MOISTURE AS NEEDED.
 - DEER PROTECTION MEASURES TO BE PROVIDED FOR ALL PLANTED TREES. SPECIFIC MEASURES TO BE DETERMINED AS PART OF THE PRE-PLANTING MEETING.

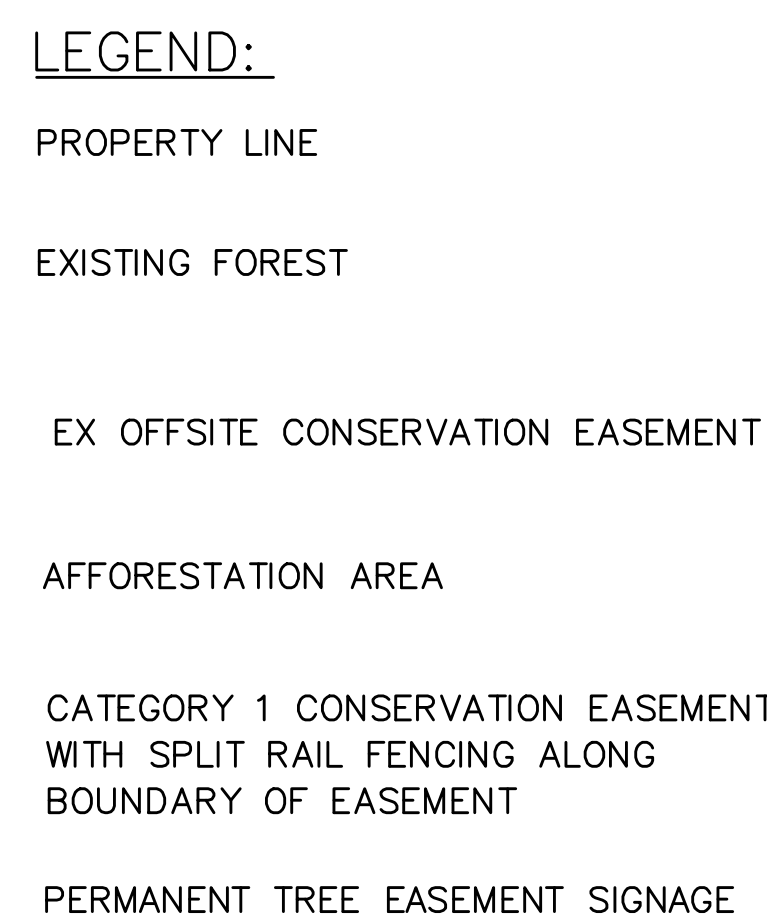

PLANTING AREA 0.42 AC	PROPOSED AFFORESTATION PLANT MATERIALS					SPACING	FORM
	BOTANICAL NAME	COMMON NAME	SIZE	UNIT/ROOT			
11	Platanus occidentalis	American Sycamore	2" Caliper	B&B	Randomly 20.9' O.C.	Tree	
11	Nyssa sylvatica	Black Gum	2" Caliper	B&B	Randomly 20.9' O.C.	Tree	
11	Acer rubrum	Red Maple	2" Caliper	B&B	Randomly 20.9' O.C.	Tree	
10	Cornus nigra	Flower Dogwood	2" Caliper	B&B	Randomly 20.9' O.C.	Tree	
8	Lindera benzoin	Spicebush	12" Height	Cont.	Randomly 33' O.C.	Shrub	
7	Hamamelis virginiana	Witch Hazel	24" Height	Cont.	Randomly 33' O.C.	Shrub	
35 LBS	-	Slyvia Field and Forest Mix or Earnest Native Upland Wildlife Forage and Cover Meadow Mix: or equivalent	-	-	80 LBS. PER ACRE	SEED	
15 LBS	-	Companion Seed Mix of 50% Annual Ryegrass 25% Redtop Grass 25% sheep Fescue	-	-	8 LBS. PER 10,000 SF	SEED	

INSPECTIONS

All field inspections must be requested by the applicant. Inspections must be conducted as follows:

Tree Save Plans and Forest Conservation Plans without Planting Requirements

- After the limits of disturbance have been staked and flagged, but before any clearing or grading begins.
- After necessary stress reduction measures have been completed and protection measures have been installed, but before any clearing and grading begin.
- After completion of all construction activities, but before removal of tree protection fencing, to determine the level of compliance with the provision of the forest conservation.

Additional Requirements for Plans with Planting Requirements

- Before the start of any required reforestation and afforestation planting.
- After necessary reforestation and afforestation planting has been completed to verify that the planting is acceptable and prior to the start of the maintenance period.
- At the end of the maintenance period to determine the level of compliance with the provisions of the planting plan, and if appropriate, release of the performance bond.

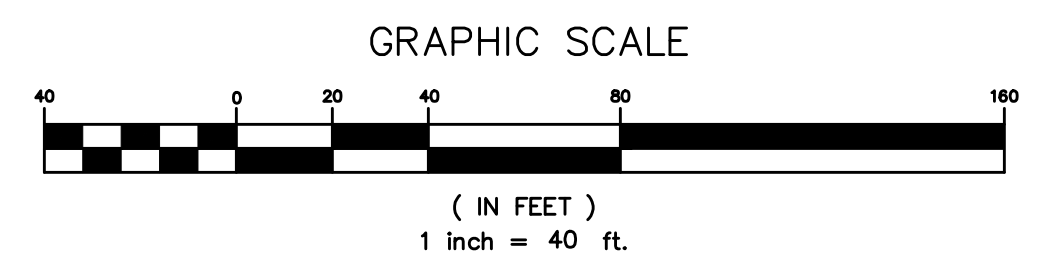

DEVELOPER'S CERTIFICATE

The Undersigned agrees to execute all the features of the Approved Final Forest Conservation Plan No. **F20240190** including, financial bonding, forest planting, maintenance, and all other applicable agreements.

Developer's Name: **Jose Polanco**
 Printed Company Name

Contact Person or Owner: **Jose Polanco**
 Printed Name

Address: **16201 Batson Road, Spencerville, MD 20868**

Phone and Email: **240.353.0444 treemaninc@gmail.com**

Signature: _____

CERTIFICATION OF QUALIFIED PROFESSIONAL

I HEREBY CERTIFY THAT THE PLAN SHOWN HEREON HAS BEEN PREPARED IN ACCORDANCE WITH MARLAND STATE, MNCPPC AND MONTGOMERY COUNTY FOREST CONSERVATION LAWS.

1.29.2024
 DATE

MICHAEL A. NORTON
 MDCR / COMAR 08.19.06.01
 QUALIFIED PROFESSIONAL

PRELIMINARY/FINAL FOREST CONSERVATION PLAN OFFSITE FOREST PLANTING F20240190

PROJECT: **TREEMAN PROPERTY 2230 SPENCERVILLE ROAD SPENCERVILLE, MD 20868 PARCEL 319 MONTGOMERY COUNTY, MD ELECTION DISTRICT 5**

PREPARED FOR: **JOSE & NELSY POLANCO 16201 BATSON ROAD SPENCERVILLE, MD 20868 240.353.0444 treemaninc@gmail.com**

nld LAND DESIGN 5146 DORSEY HALL DRIVE 2ND FLOOR ELLICOTT CITY, MD 21042
 0.443.542.9199 NORTONLANDDESIGN.COM
 LANDSCAPE ARCHITECTURE & ENVIRONMENTAL PLANNING

REVISIONS:

VICINITY MAP 1"=2000'

SITE

SPENCERVILLE BATSON ROAD THOMPSON ROAD ORCHARD ROAD PEACH STREET RAINBOW DRIVE

WATER CLASS	IP/IIIP	WATERSHED	LOWER PATUXENT	REMA FLOODPLAIN
TRIBUTARY	UNNAMED		UPPER PAINT BRANCH	PANEL #
TAX MAP	KS342	200 SHEET	221NE03	ADC MAP #
SCALE	AS SHOWN	DATE	MARCH 2022	PRGJ. NO.
				21-139
				SHEET NO.
				L-4.3