

Existing Conditions Plan

NAEEM SADIA
7404 NEW HAMPSHIRE AVE
TAKOMA PARK 20912



Property Information

Acct# 13-03176058
Lot 6, Block 1
WSSC Grid: 209NE01
Tax Map: JN562
Property Size: 5376 Square Feet
Watershed: Sligo Creek

Project Information

Daycare 13-30 CU Application

Inspection Notes

All field inspections must be requested by the applicant. Field Inspections must be conducted as follows:

1. After the limits of disturbance have been staked and flagged, but before any clearing or grading begins.
2. After necessary stress reduction measures have been completed and protection measures have been installed, but before any clearing and grading begin and before release of the building permit.
3. After completion of all construction activities, but before removal of tree protection fencing, to determine the level of compliance with the provision of the forest conservation.

Plan Requirements - Please show these items on the map

- Proposed Limits of Disturbance (LOD)
- Construction access and staging areas within the LOD
- Location of proposed improvements
- All significant and specimen trees (24" DBH or greater) within 50 feet of the LOD

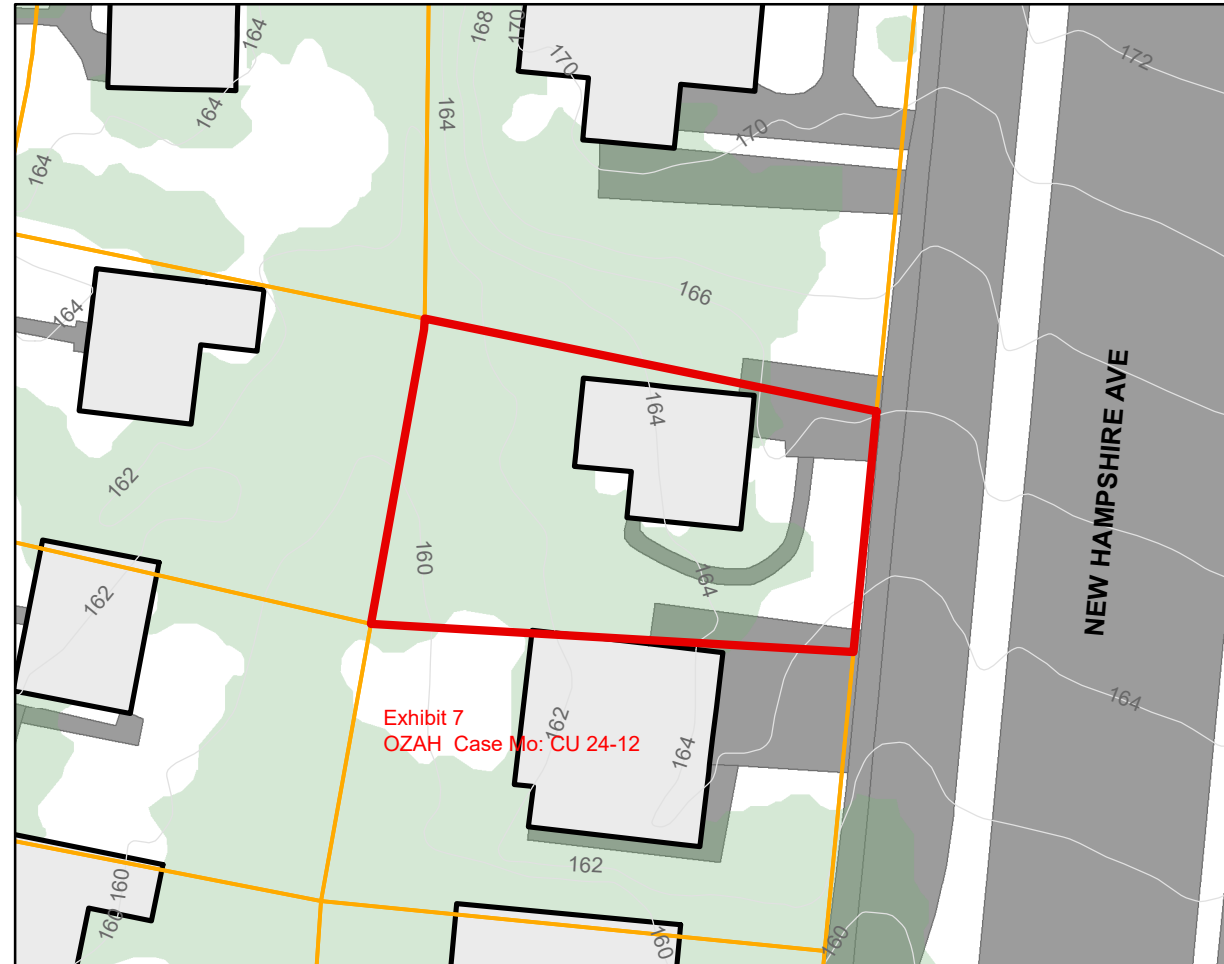

0 20 40 80 Feet

1 in = 40 ft

- | | |
|----------------|------------------|
| Property Lines | Wetlands |
| Paved areas | Floodplains |
| Buildings | Tree Canopy |
| Water Areas | Forests |
| Stream Buffers | 350 2ft Contours |
| Streams | Railroads |