

- LEGEND:
- POTENTIAL STREAM
 - STREAM VALLEY BUFFER
 - EX RAILROAD
 - PROPERTY
 - EXISTING PAVEMENT/ROAD
 - ZONING
 - EXISTING FOREST
 - PROPOSED ROAD
 - LIMITS OF DISTURBANCE

SCALE: 1" = 300'

Exhibit # 15



ROCKVILLE OFFICE
2 Research Place, Suite 100
Rockville, MD 20850
P. 301.948.2750 F. 301.948.9067
www.solteszco.com

Engineering
Surveying
Planning
Environmental Sciences

NO. REVISIONS BY DATE

MISS UTILITY NOTE
INFORMATION CONCERNING EXISTING UNDERGROUND UTILITIES WAS OBTAINED FROM AVAILABLE RECORDS. THE CONTRACTOR MUST DETERMINE THE EXACT LOCATION AND ELEVATION OF ALL EXISTING UTILITIES AND VERIFY CROSSINGS BY PENETRATION TESTS BY HAND, WELL IN ADVANCE OF THE START OF EXCAVATION. CONTACT THE UTILITY AT 48 HOURS PRIOR TO THE START OF EXCAVATION. IF CLEARANCES ARE LESS THAN SHOWN ON THE PLAN OR THE UTILITY COMPANY, THE CONTRACTOR MUST CONTACT THE ENGINEER AND THE UTILITY COMPANY BEFORE PROCEEDING WITH CONSTRUCTION. CLEARANCES LESS THAN NOTED MAY REQUIRE REVISIONS TO THE PLAN.

OWNER / DEVELOPER / APPLICANT

TERRAINNOVATIONS
904-206-8770
JEFF@TERRAINNOVATIONS.COM
JEFF FERREL

PROFESSIONAL CERTIFICATION

HEREBY CERTIFY THAT THESE DOCUMENTS WERE PREPARED OR APPROVED BY ME AND THAT I AM A FULLY LICENSED PROFESSIONAL ENGINEER UNDER THE LAWS OF THE STATE OF MARYLAND.
LICENSE NO. _____ EXPIRATION DATE: _____

ROADWAY EXHIBIT

DICKERSON POWER PLANT
21200 MARTINSBURG RD, DICKERSON, MD 20842
LOTS 2, 3, 7, 8 AND 9
POOLESVILLE (04) ELECTION DISTRICT, MONTGOMERY COUNTY, MARYLAND

TAX MAP NO. BV ZONING CATEGORY: H-AR

DATE: 9/7/2023
DESIGNED: TR
CHECKED: CWV
DATE: 9/7/2023
DRAWN: JS
DATE: 9/7/2023
PROJECT NO. 40250002

DATE: 9/7/2023
DESIGNED: TR
CHECKED: CWV
DATE: 9/7/2023
DRAWN: JS
DATE: 9/7/2023
PROJECT NO. 40250002

DATE: 9/7/2023
DESIGNED: TR
CHECKED: CWV
DATE: 9/7/2023
DRAWN: JS
DATE: 9/7/2023
PROJECT NO. 40250002

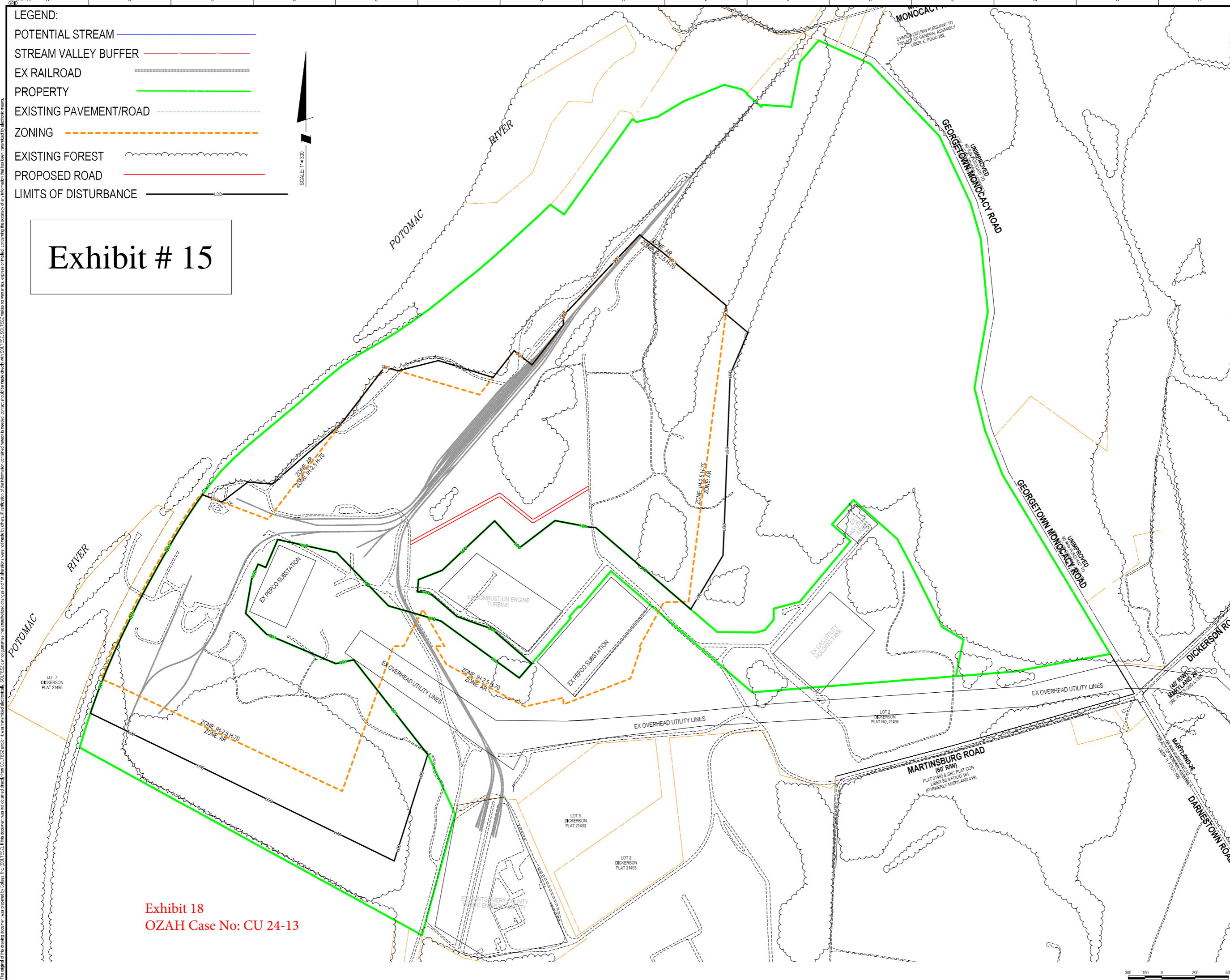

Exhibit 18
OZAH Case No: CU 24-13

The original of this drawing document was created by Soltesz, Inc. SOLTESZ, INC. cannot guarantee the accuracy of any information that has been transmitted by electronic means. If verification of this information contained herein is required, contact should be made directly with SOLTESZ, INC. SOLTESZ, INC. does not warrant, express or implied, the accuracy of any information that has been transmitted by electronic means.