

**AT&T NETXTEND BATTERY CABINET SPECS**  
SCALE: 3/4"=1'-0"

NOTE: CABINET WEIGHT: 616 LBS

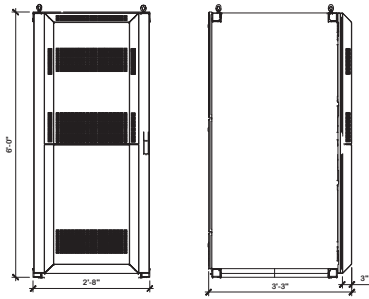

**AT&T NETSURE 512 DC POWER CABINET SPECS**  
SCALE: 3/4"=1'-0"

NOTE: CABINET WEIGHT: 752 LBS

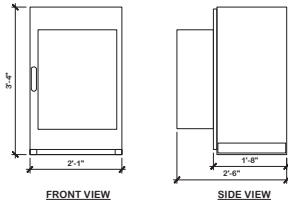

**AT&T FLX21-250 EQUIPMENT CABINET SPECS**  
SCALE: 3/4"=1'-0"

NOTE: CABINET WEIGHT: 150LBS

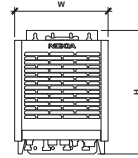
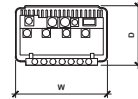

SIZE & WEIGHT TABLE				
MODEL NO.	HEIGHT ("H")	WIDTH ("W")	DEPTH ("D")	TECHNOLOGY
4T4R B5	13.3"	11.6"	6.5"	850 MHz
RRH WEIGHT: 35.3 LBS				

**NOKIA AIRSCALE RRH 4T4R B5 160W AHCA RRH DETAIL**  
NOT TO SCALE

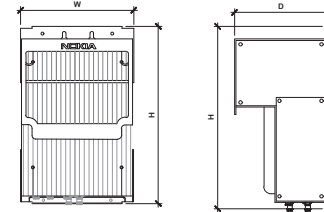
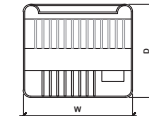

SIZE & WEIGHT TABLE				
MODEL NO.	HEIGHT ("H")	WIDTH ("W")	DEPTH ("D")	TECHNOLOGY
B12/14/29 AHLBBA	24.0"	14.9"	12.7"	LOW BAND
RRH WEIGHT: <100 LBS				

**NOKIA AIRSCALE DUAL RRH 4T4R B12/14/29 1330W AHLBBA DETAIL**  
NOT TO SCALE

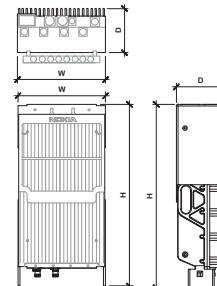

SIZE & WEIGHT TABLE				
MODEL NO.	HEIGHT ("H")	WIDTH ("W")	DEPTH ("D")	TECHNOLOGY
B25/66 AHFII	25.1"	13.5"	4.6"	HIGH BAND
RRH WEIGHT: 70.5 LBS				

**NOKIA AIRSCALE DUAL RRH 4T4R B25/66 480W AHFII DETAIL**  
NOT TO SCALE

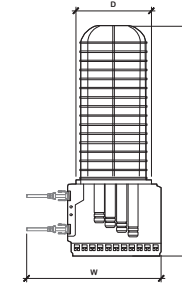

SIZE & WEIGHT TABLE				
MODEL NO.	HEIGHT ("H")	WIDTH ("W")	DEPTH ("D")	TECHNOLOGY
DC9-48-60-24-8C-EV (SQUID)	31.4"	18.28"	10.24"	SURGE PROTECTION UNIT
EQUIPMENT WEIGHT: 26.2 LBS				

**RAYCAP DC9-48-60-24-8C-EV (SQUID) SURGE PROTECTOR DETAIL**  
NOT TO SCALE



7150 STANDARD DRIVE  
HANOVER, MD 21076



**MORRIS & RITCHE ASSOCIATES, INC.**  
Civil/Structural Engineers  
1225 St. Paul Street, Suite 400R  
Towson, Maryland 21286  
Office: (410) 521-6300  
Fax: (410) 521-1748



1997 ANNAPOLIS EXCHANGE PARKWAY, SUITE 200  
ANNAPOLIS, MD 21401  
PHONE: (410) 283-8465  
FAX: (410) 220-2962

SITE ID: SIMD010145  
SITE NAME: DUNAVANT RELO FOR BOYER PLACE (YESHIVA TEMP) (FA NUMBER: 12573579)  
SITE ADDRESS: 2010 LINDEN LANE SILVER SPRING, MD 20910 MONTGOMERY COUNTY

REVISION BLOCK		
NO.	DESCRIPTION	DATE
	COUNTY COMMENTS	08/15/23
	COUNTY COMMENTS	07/20/23
	PERMIT DWGS	07/13/23



**PROFESSIONAL CERTIFICATION**  
I HEREBY CERTIFY THAT THESE DOCUMENTS WERE PREPARED OR APPROVED BY ME, AND THAT I AM A DULY LICENSED PROFESSIONAL ENGINEER UNDER THE LAWS OF THE STATE OF MARYLAND, LICENSE NO. 32384, EXPIRATION DATE: 11/10/2023.

DRAWN BY: AJL  
DESIGNED BY: AJL  
REVIEWED BY: RJD  
ORIGINAL DATE: 06/22/2023  
MRA PROJECT #: 18291.213



**Know what's below. Call before you dig.**  
PROTECT YOURSELF. OWE THREE MINUTES EVERY DAY.  
THIS DRAWING DOES NOT INCLUDE NECESSARY CONSIDERATIONS FOR PROTECTION SAFETY. ALL OPERATIONS MUST BE IN COMPLIANCE WITH THE OCCUPATIONAL SAFETY AND HEALTH ACT OF 1970 AND ALL RULES AND REGULATIONS THERE TO APPLICABLE.

**SHEET TITLE**  
Equipment Details

**SHEET NUMBER**  
C-7