



MONTGOMERY COUNTY EXECUTIVE ORDER

Offices of the County Executive • 101 Monroe Street • Rockville, Maryland 20850

Subject Fire Lane Establishment Order for Seventh-day Adventist General Conference World Headquarters	Executive Order No. 238-18	Subject Suffix
Originating Department Montgomery County Department of Permitting Services	Department Number MCDPS 46-18	Effective Date 11/26/2018

Fire Lane Establishment Order

Pursuant to Section 22 - 33, Montgomery County Code, 1971, as amended, you are hereby notified that a Fire Lane has been established as described in this order. You are hereby ordered to post fire lane signs and paint curbs/pavement (painting optional) as identified below. When signs and paint work (painting optional) have been completed, this order will authorize the enforcement of this Fire Lane by appropriate police and fire officials. Compliance with this order must be achieved within 30 days of receipt.

LOCATION: 12501 Old Columbia Pike

All areas where indicated by signs and paint.

☒ SIGNS -- (See attached diagram for location of sign placement)



\$250 FINE

FIRE LANE

Signs must be posted so that it is not possible to park a vehicle without being in sight of a sign. Signs may be no further apart than 100 feet

(Red letters on white background)

☒ PAINT -- (See attached diagram if painting).

Paint must be traffic yellow with lines of sufficient width to be readily identifiable/readable by motor vehicle operators.

A handwritten signature in black ink, appearing to be "M. J. [unclear]".

Fire Marshal, Montgomery County Department of Permitting Services

FIRE LANE SIGNAGE PLAN - 1 OF 4

PREPARED BY: BDA



NOTES:

1. SIGNS AND EDGE OF PAVEMENT PAINT TO BE CONSISTENT WITH MONTGOMERY COUNTY FIRE AND RESCUE (MCFR) GUIDELINES.
2. SIGNAGE IS TO BE ALL-SEASON DURABLE WITH RED REFLECTIVE LETTERING ON A WHITE BACKGROUND.
3. SIGNS MUST BE POSTED SO THAT IT IS NOT POSSIBLE TO PARK A VEHICLE WITHOUT BEING IN SIGHT OF A SIGN. SIGNS MAY BE NO FURTHER APART THAN 100 FEET.
4. PAINT MUST BE TRAFFIC YELLOW WITH LINES OF SUFFICIENT WIDTH TO BE READILY IDENTIFIABLE / READABLE BY MOTOR VEHICLE OPERATORS.

INDEX MAP

NOT TO SCALE

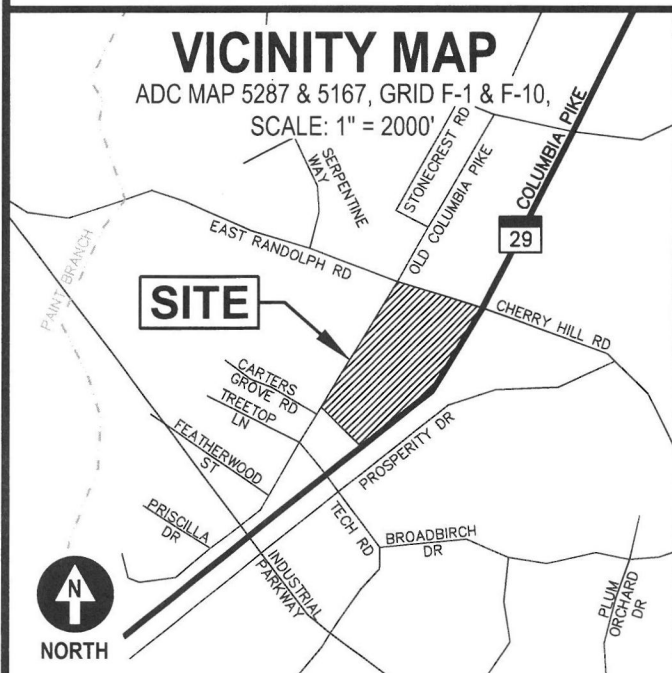
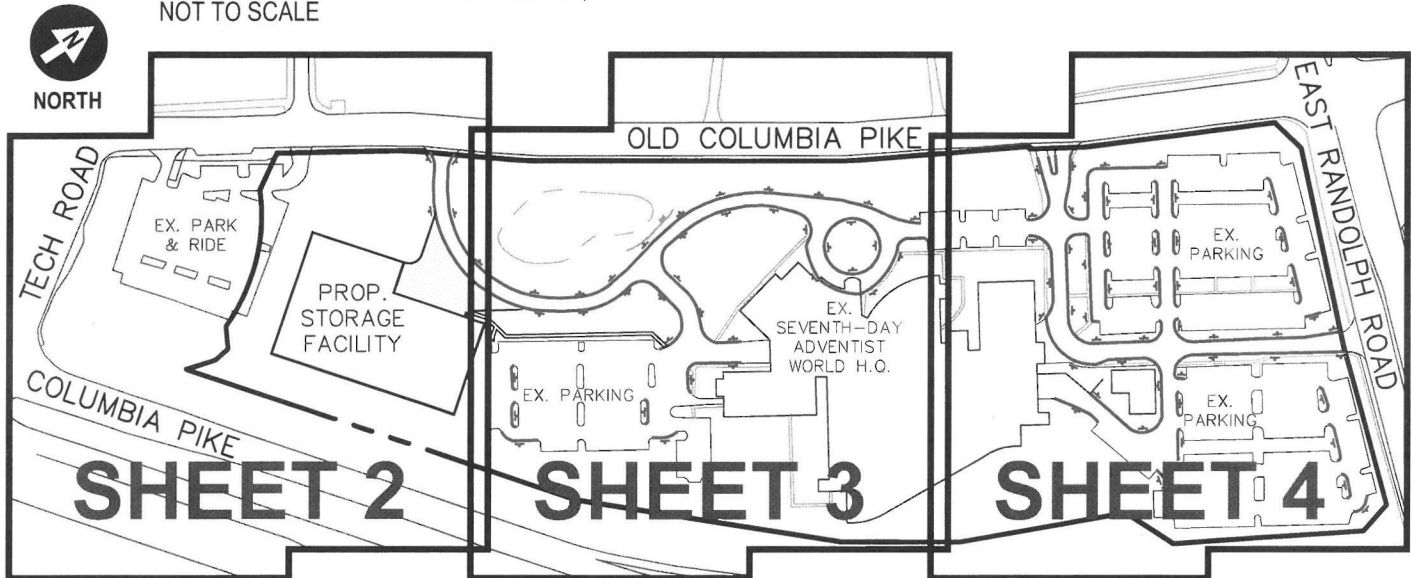

FIRE LANE SIGNS

NOT TO SCALE

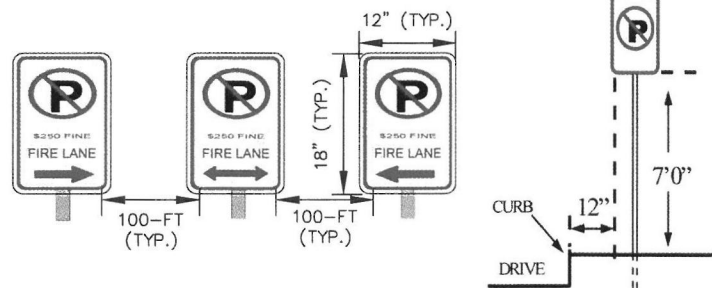

FIRE LANE SIGN PLAN PART OF PARCEL "E" FAIRLAND

MDSHA PLAT NO.: 56431

COLESVILLE (5TH) ELECTION DISTRICT
MONTGOMERY COUNTY, MARYLAND

SCALE: N.T.S.

JOB NO.: 17-005

DATE: NOVEMBER, 2018

DRAWN BY: BDA



10 South Bentz Street
Frederick, Maryland 21701
301-607-8031 office
301-607-8045 fax
www.casengineering.com
info@casengineering.com

FIRE LANE SIGNAGE PLAN - 2 OF 4

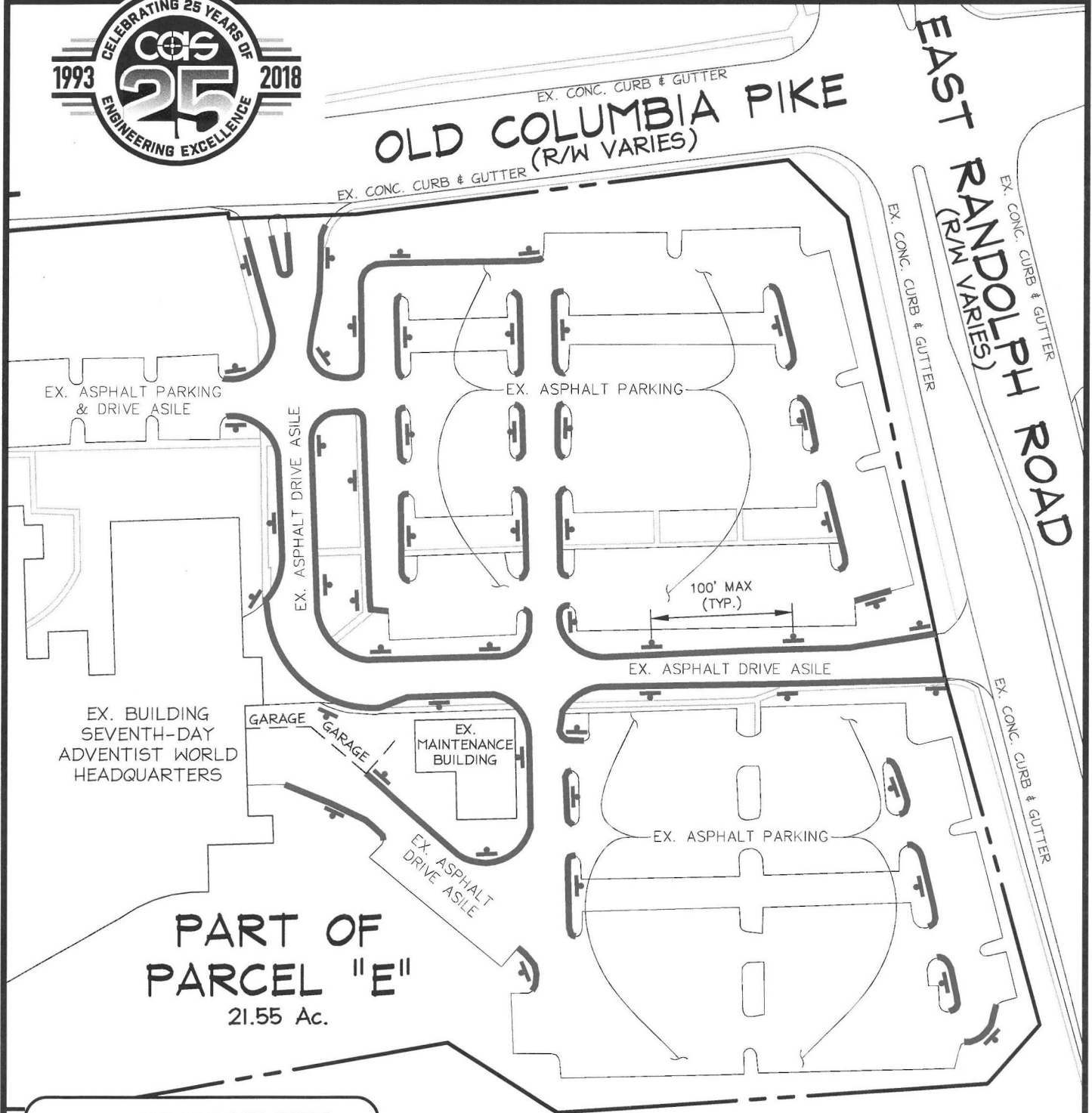

**PART OF
PARCEL "E"**
21.55 Ac.



FIRE LANE SIGN SYMBOL

PAINTED CURB OR EDGE OF
PAVEMENT

FIRE LANE SIGN PLAN PART OF PARCEL "E" FAIRLAND

MDSHA PLAT NO.: 56431

COLESVILLE (5TH) ELECTION DISTRICT
MONTGOMERY COUNTY, MARYLAND

SCALE: N.T.S.

JOB NO.: 17-005

DATE: NOVEMBER, 2018

DRAWN BY: BDA



10 South Bentz Street
Frederick, Maryland 21701
301-607-8031 office
301-607-8045 fax
www.casengineering.com
info@casengineering.com

FIRE LANE SIGNAGE PLAN - 3 OF 4



EX. CONC. CURB & GUTTER

OLD COLUMBIA PIKE
(R/W VARIES)

EX. CONC. CURB & GUTTER

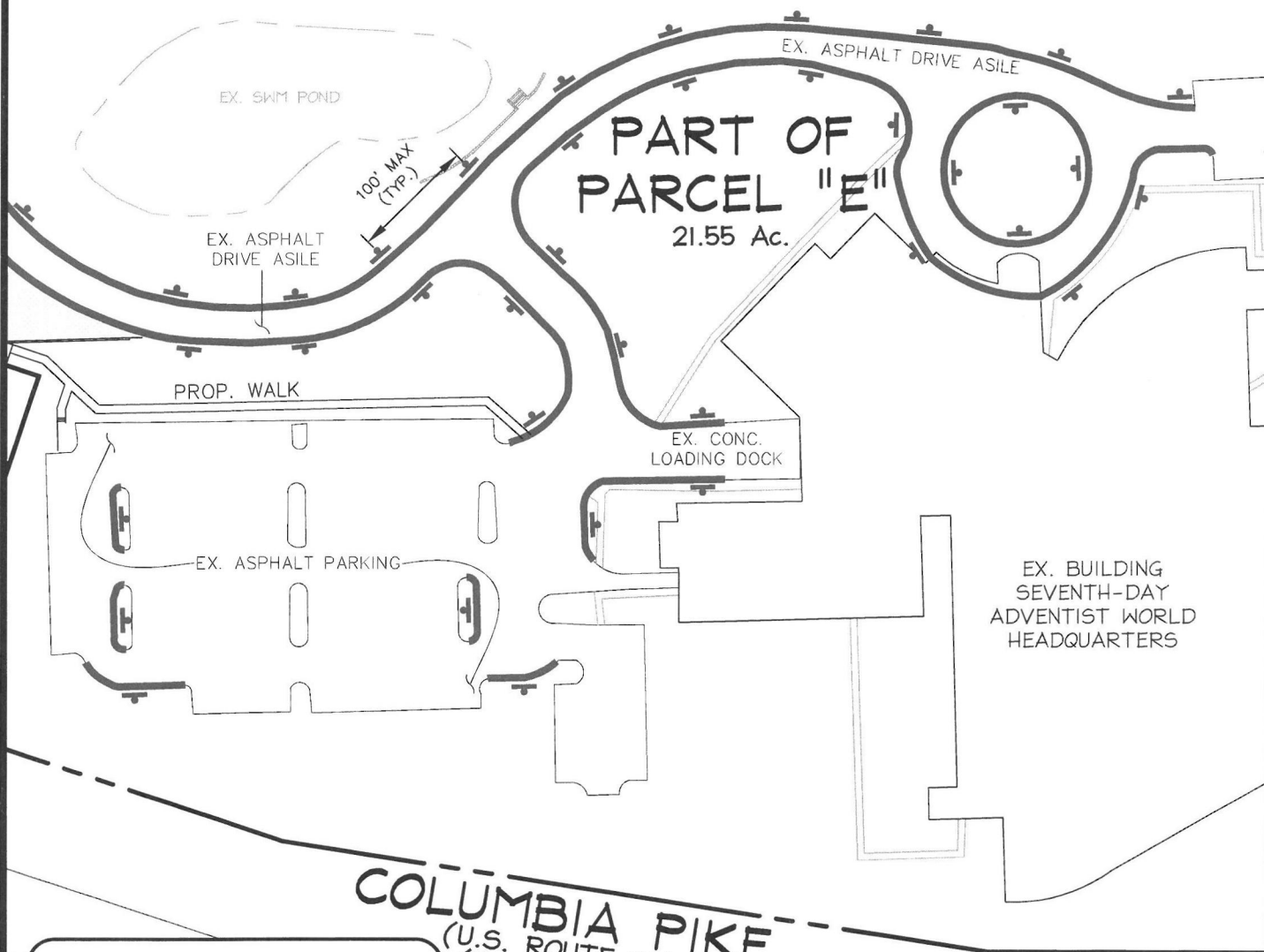

FIRE LANE SIGN SYMBOL

PAINTED CURB OR EDGE OF
PAVEMENT

COLUMBIA PIKE
(U.S. ROUTE 29)
(R/W VARIES)
SOUTH BOUND

FIRE LANE SIGN PLAN
PART OF PARCEL "E"
FAIRLAND

MDSHA PLAT NO.: 56431

COLESVILLE (5TH) ELECTION DISTRICT
MONTGOMERY COUNTY, MARYLAND

SCALE: N.T.S.
JOB NO.: 17-005

DATE: NOVEMBER, 2018
DRAWN BY: BDA



10 South Bentz Street
Frederick, Maryland 21701
301-607-8031 office
301-607-8045 fax
www.casengineering.com
info@casengineering.com

FIRE LANE SIGNAGE PLAN - 4 OF 4



TECH ROAD
(R/W VARIES)

OLD COLUMBIA PIKE
(R/W VARIES)

EX. CONC. CURB & GUTTER

EX. CONC. CURB & GUTTER

EX. ASPHALT
DRIVE ASILE

PART OF
PARCEL "E"
21.55 Ac.

100'
MAX
(TYP.)

EX. ASPHALT
PARK & RIDE

PROP
STORAGE
FACILITY

COLUMBIA PIKE
(U.S. ROUTE 29) (R/W VARIES) SOUTH BOUND
EX. EDGE OF PAVEMENT

COLUMBIA PIKE
(U.S. ROUTE 29) (R/W VARIES) NORTH BOUND
EX. EDGE OF PAVEMENT

EX. EDGE OF PAVEMENT



FIRE LANE SIGN SYMBOL

PAINTED CURB OR EDGE OF
PAVEMENT

FIRE LANE SIGN PLAN
PART OF PARCEL "E"
FAIRLAND

MDSHA PLAT NO.: 56431

COLESVILLE (5TH) ELECTION DISTRICT
MONTGOMERY COUNTY, MARYLAND

SCALE: N.T.S.
JOB NO.: 17-005

DATE: NOVEMBER, 2018
DRAWN BY: BDA

CAS
ENGINEERING

10 South Bentz Street
Frederick, Maryland 21701
301-607-8031 office
301-607-8045 fax
www.casengineering.com
info@casengineering.com