

Rain Barrel Assembly



MONTGOMERY COUNTY DEPARTMENT OF ENVIRONMENTAL PROTECTION

RAINSCAPES

During the past several years, the Rainscapes Program staff have worked with a number of designs to develop a basic, long-lasting, and easy-to-assemble rain barrel, using parts readily found at most home improvement centers. The following instructions reflect the most recent model.

If you have picked up your rain barrel through one of our "Make and Take" workshops, many of the preliminary steps have been completed for you. Skip to the appropriate instructions for guidance in finishing your rain barrel.

The following listing provides the name and model number of the parts used to make our Rain Barrel. The cost for all parts at a standard hardware store is approximately 15 dollars.

Rain Barrel Hardware

Overflow:

1-1/4" Adapter Insert MPT (SWP151)
Size 24 25-50mm Metal Hose Clamp
1-1/4" Sump Pump Hose (Flotec FP0012-6F)
Silicone sealer or teflon tape (opt.)

Inlet Grate:

6" NDS Green Grate
6-7" Metal Clamp #10
12" square Window Screen

Hose Bibb/Sillcock:

Brass Sillcock/Hose Bibb 3/4" MPT
Silicone sealer or teflon tape (opt.)

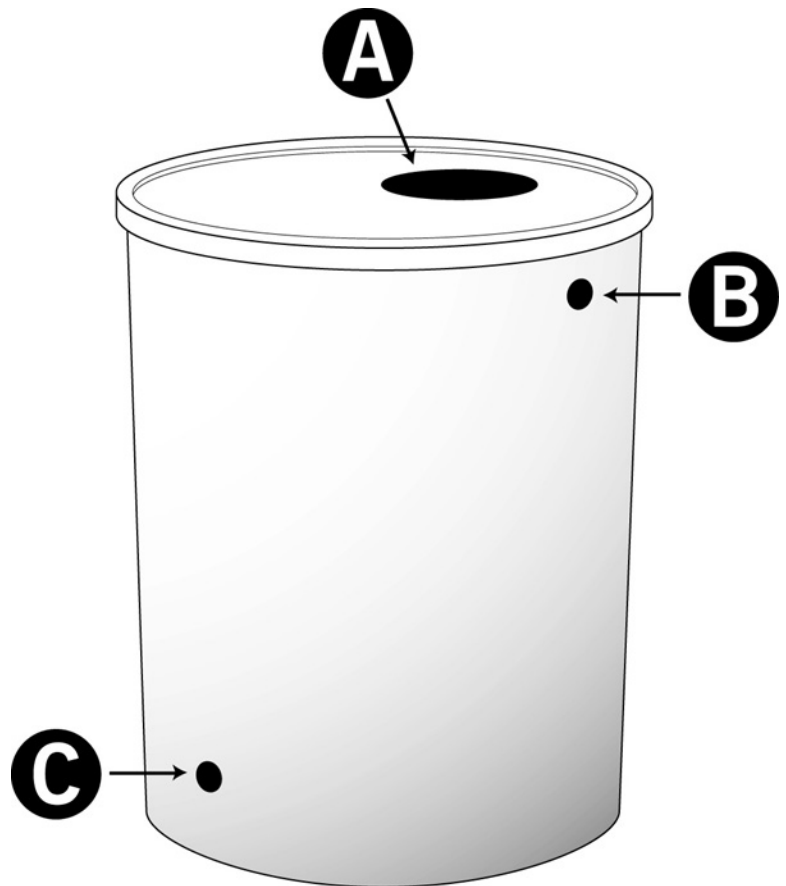

Basic Instructions

Step A: Cut a hole in the top of your barrel for the inlet drain. The hole should only be large enough to allow the grate to rest on its flange. Cut the hole using either a RotoZip™ drill or carefully measure and mark the area to be cut, start a pilot hole, and cut out the marked area with a jigsaw.

Step B: Use a 1-1/2 inch keyhole bit to cut a hole to accommodate the 1-1/4 inch Overflow Adapter. You may need to rasp or sand the hole somewhat larger to screw in the Adapter. Expect a snug fit.

Step C: Use a 15/16 inch drill bit to cut a hole for the 3/4-inch Brass Hose Bibb.

Rainscapes

For more information, visit
www.montgomerycountymd.gov/rainscapes



**Montgomery County
Department of
Environmental Protection**

255 Rockville Pike, Suite 120
Rockville, MD 20850
240.777.7700 fax 240.777.7765

Step D: Insert the threaded end of the Overflow Adapter Insert into the overflow hole. Keep the adapter straight as you screw it into the barrel.

Step E: Insert the threaded Hose Bibb into the already drilled hole. Keep the hose bibb straight as you screw it into the barrel. You may also apply a bead of silicone caulk or wrap teflon tape around the bibb before inserting it to ensure a tight, drip-free connection.

Step F: Use the larger #10 Metal Clamp to firmly attach the window screen to the bottom of the Green Grate. Tighten the clamp with a screwdriver or nut-driver. Place the Inlet Assembly into the barrel.

Step G: Slide the smaller size 25 Metal Hose Clamp over the barbed section of the Adapter Insert. Slide one end of the Sump Pump Hose over the Adapter and use the Hose Clamp to firmly attach the Hose to the Adapter.

Step H: Attach a garden hose or soaker hose to your Hose Bibb.

Step I: Use cinderblocks or similar pavers to elevate the completed Rain Barrel off the ground to ensure easier access to the Hose Bibb, and to facilitate gravity-fed drainage.

Notes: Be sure to use/drain your rain barrel at regular intervals, and before the winter season. Keep rain gutters clean of debris to prevent mosquito eggs and larvae from entering your barrel. Check connections routinely; clean debris from the Grate Assembly when needed.

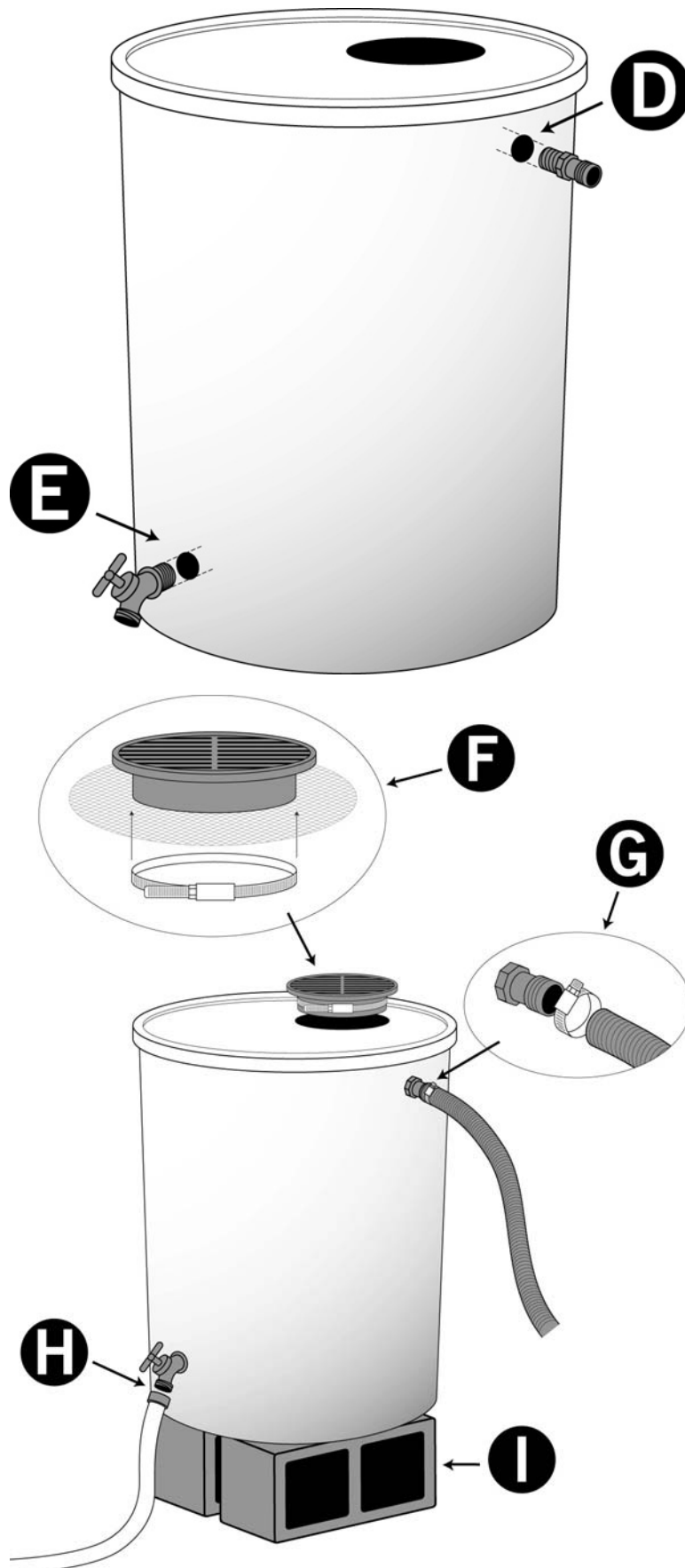

**Local sources for
barrels and hard-
ware kits**

Plastic, food-grade barrels:
JAMES T. WARRING SONS INC.
4545 'S' STREET
CAPITOL HEIGHTS, MD.20743
www.warringbarrels.com
Phone 301-322-5400
Fax. 301-925-8874

Hardware and tool kit:
(different from list shown on this
fact sheet, but comes with own
set of instructions)
AQUABARREL
878 Muddy Branch Road #25
Gaithersburg, MD 20878
www.aquabarrel.com/
240-683-RAIN (7246)
206-202-1487 FAX and
voice mail only