



DEPARTMENT OF ENVIRONMENTAL PROTECTION

Isiah Leggett
County Executive

Lisa Feldt
Director

E-MAIL TRANSMITTAL

Interagency Water/Sewer Map Amendment Review

October 12, 2016

TO: Beth Kilbourne, Rufus Leeth, and Luis Tapia, Development Services Group
Washington Suburban Sanitary Commission

Kipling Reynolds, Area 3 Planning Team, M-NCPPC
Maryland – National Capital Park and Planning Commission

Geoffrey Mason, Parks Planning & Stewardship Division
Maryland – National Capital Park and Planning Commission

Gene von Gunten, Well and Septic Section
Department of Permitting Services

FROM: George Dizelos, Planner II, Water and Wastewater Policy Group
Department of Environmental Protection 

SUBJECT: WATER/SEWER CATEGORY CHANGE REQUEST REVIEW – **2017-Q1 REVIEW GROUP**

Attached with this message and posted to www.montgomerycountymd.gov/waterworks is a PDF that includes three (3) new individual water/sewer service area category change requests (WSCCRs) for your review and comment. These requests will be considered as proposed amendments to the County's *Comprehensive Water Supply and Sewerage Systems Plan*. I would greatly appreciate receiving your review comments on these requests no later than Monday, November 14, 2016. Please notify me before November 9th if this schedule is not feasible.

DEP will develop and announce a schedule for administrative delegation hearing AD 2017-1, which will include all eligible FY 2017 first quarter requests. We will provide a notice of that hearing 30 days prior to the hearing date. At this time DEP has not identified any requests in this review packet anticipated for County Council consideration, although one requests—as noted below—is pending an anticipated path. Part of DEP's recommendation process for this one request, and any other requests for that matter, will be based in part on the review comments your agencies provide.

Note that the listing of the following requests under the administrative process versus the Council process is a preliminary determination and certainly subject to change as they proceed through the review process.

Anticipated Administrative Action WSCCRs
17-TRV-03A Liu

Anticipated Council Action WSCCRs
17-TRV-02A.....Smart

Anticipated Action Not Yet Determined
17-TRV-01A..... Simmons

Note that with this review packet, DEP-WWPG is working to reestablish a quarterly review schedule. Please do not hesitate to contact me at George.Dizelos@montgomerycountymd.gov or at 240-777-7755 if you have any questions concerning these category change requests or the review schedules.

GJD: gjd

R:\Programs\Water_and_Sewer\CCRs\CCR-Review-Process\2017CCR-review-process\2017-Q1\2017-q1--review-pckt--_memo-tables-only.docx

cc: Agencies

Dave Lake and Alan Soukup, DEP-WWPG
Keith Levchenko, County Council
Katherine Nelson, Area 3 Planning, M-NCPPC
Pam Dunn, Functional Planning, M-NCPPC
Mark Pfefferle & Cathy Conlon, Development Applications & Regulatory Coordination, M--NCPPC
Ray Chicca, Development Services, WSSC
Daniel Laird, Water Management Administration, MDE
Steven Allan, MDP

Category Change Applicants & Interested Parties

17-TRV-01AGeorge & Janet Simmons
.....Steve Crum, Macris Hendricks & Glascock, P.A.
17-TRV-02AKevin & K.L. Smart
.....Steve Crum, Macris Hendricks & Glascock, P.A.
17-TRV-03AJingen Liu
..... Eric Tidd & Phillip Long, CAS Engineering

Civic Organizations and Other Public Interest Groups

Audubon Naturalist Society
West Montgomery County Citizens' Association
The Glen Preservation Foundation

Adjacent and Confronting Property Owners

DEP will send a notice to each owner of properties adjacent to and confronting these category change request sites advising them about the filing of these requests.

WSSCR 17-TRV-01A: George & Janet Simmons

Anticipated Action Path: Undetermined

Property Information and Location Property Development	Applicant's Request: Service Area Categories & Justification										
<ul style="list-style-type: none"> • 12911 Circle Dr., Rockville • Parcel P721, Wickham & Pottinger (acct. no. 00054605) • Map tile: WSSC – 217NW10; MD –FR41 • Northwest corner, intersection of Ridge Dr. and Circle Dr. • RE-1 Zone; 3.41 acres • Travilah Planning Area Potomac Subregion Master Plan (2002) • Watts Branch Watershed (MDE Use I) • <u>Existing use</u>: Unimproved, Wooded • <u>Proposed use</u>: One New Single Family House 	<table border="1" style="width: 100%; border-collapse: collapse;"> <tr> <th colspan="2" style="text-align: center; border-bottom: 1px solid black;">Existing – Requested – Service Area Categories</th> </tr> <tr> <td style="width: 50%;">W-1</td> <td style="width: 50%;">W-1 (No Change)</td> </tr> <tr> <td>S-6</td> <td>S-1</td> </tr> <tr> <th colspan="2" style="text-align: center; border-bottom: 1px solid black;">Applicant's Explanation</th> </tr> <tr> <td colspan="2" style="padding: 5px;">"Construct single family dwelling, adjacent to abutting sewer main."</td> </tr> </table>	Existing – Requested – Service Area Categories		W-1	W-1 (No Change)	S-6	S-1	Applicant's Explanation		"Construct single family dwelling, adjacent to abutting sewer main."	
Existing – Requested – Service Area Categories											
W-1	W-1 (No Change)										
S-6	S-1										
Applicant's Explanation											
"Construct single family dwelling, adjacent to abutting sewer main."											

Agency Review Comments

DPS:

M-NCPPC – Planning Dept.:

M-NCPPC – Parks Planning:

WSSC - Water: *(not requested)*

WSSC - Sewer:

DEP Note to WSSC: Can this property be served directly from the nearby 8" sewer main (#1989-8060A), or is a non-abutting connection approval required?

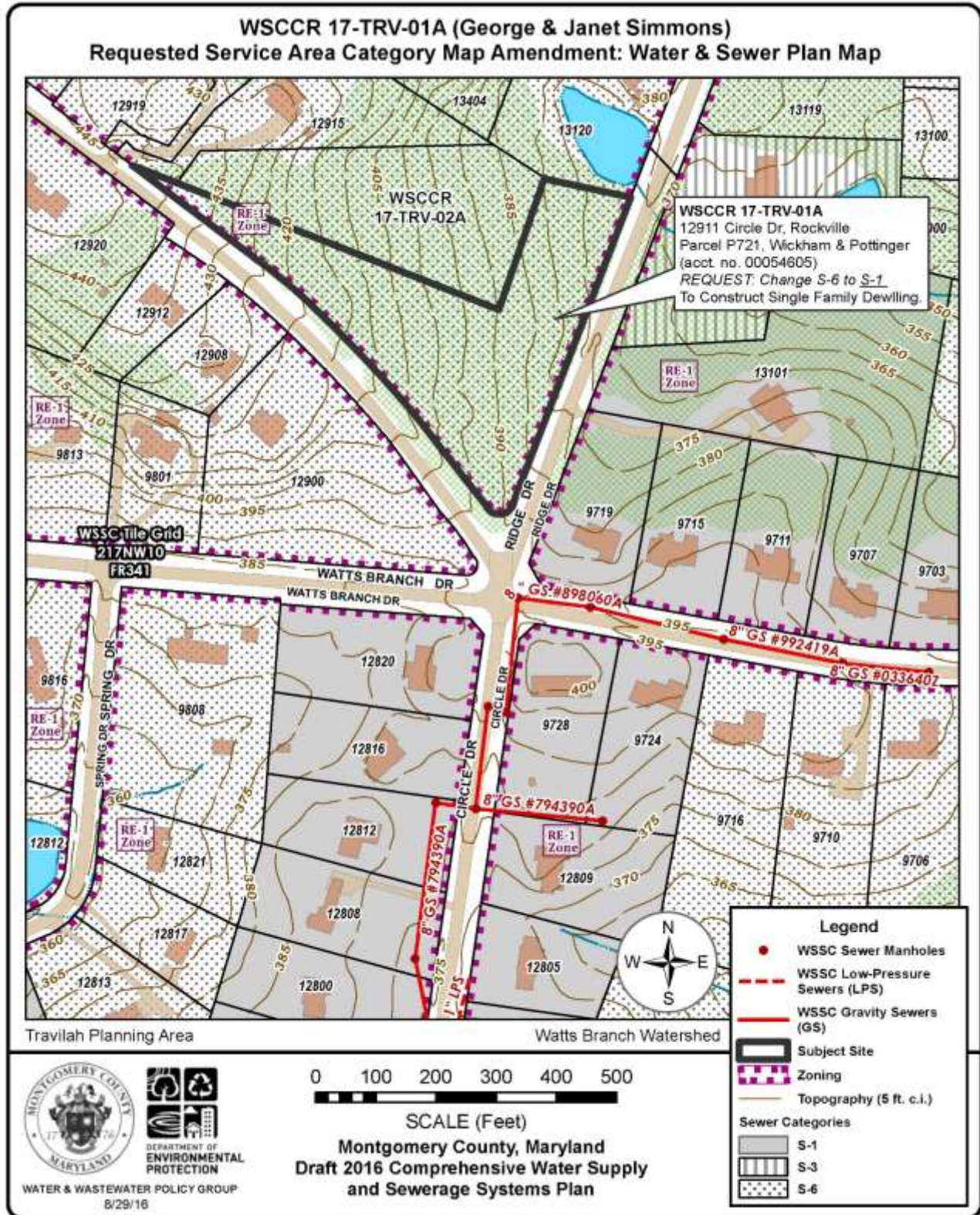

WSSCR 17-TRV-01A: Kevin & K.L. Smart

Anticipated Action Path: Council

Property Information and Location Property Development	Applicant's Request: Service Area Categories & Justification										
<ul style="list-style-type: none"> • 12913 Circle Dr., Rockville • OUTLOT "A", Block 7, NORTH GLEN HILLS (acct. no. 02827206) • Map tile: WSSC – 217NW10; MD –FR41 • Circle Dr. near intersection of Ridge Dr. • RE-1 Zone; 2.28 acres • Travilah Planning Area Potomac Subregion Master Plan (2002) • Watts Branch Watershed (MDE Use I) • <u>Existing use</u>: Unimproved, Wooded <u>Proposed use</u>: One New Single Family House 	<table border="1" style="width: 100%; border-collapse: collapse;"> <tr> <td colspan="2" style="text-align: center;"><u>Existing – Requested – Service Area Categories</u></td> </tr> <tr> <td style="width: 50%;">W-1</td> <td style="width: 50%;">W-1 (No Change)</td> </tr> <tr> <td>S-6</td> <td>S-3</td> </tr> <tr> <td colspan="2"><u>Applicant's Explanation</u></td> </tr> <tr> <td colspan="2">"Build Single Family House."</td> </tr> </table>	<u>Existing – Requested – Service Area Categories</u>		W-1	W-1 (No Change)	S-6	S-3	<u>Applicant's Explanation</u>		"Build Single Family House."	
<u>Existing – Requested – Service Area Categories</u>											
W-1	W-1 (No Change)										
S-6	S-3										
<u>Applicant's Explanation</u>											
"Build Single Family House."											

Agency Review Comments

DPS:

M-NCPPC – Planning Dept.:

M-NCPPC – Parks Planning:

WSSC - Water: *(not requested)*

WSSC - Sewer:

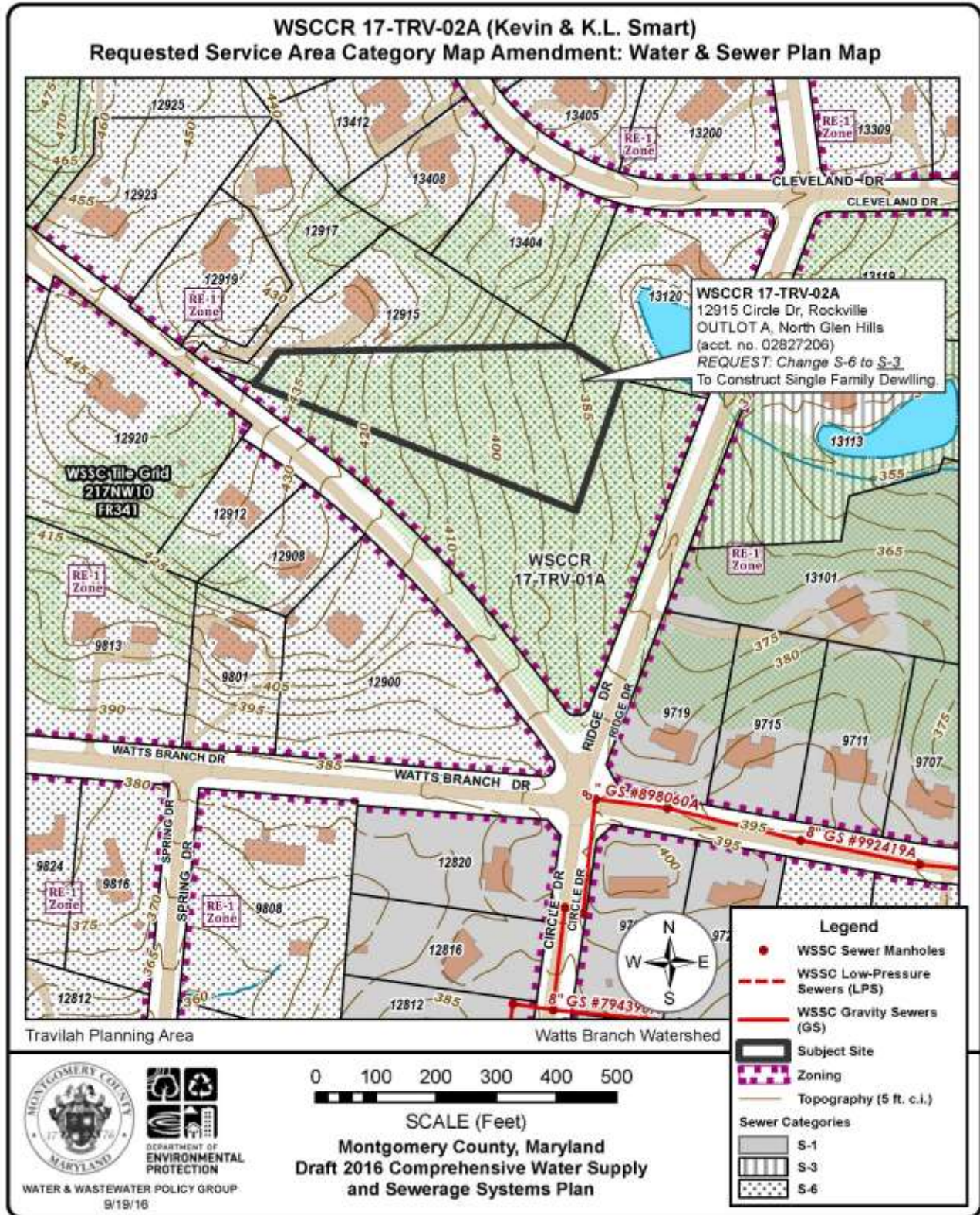

WSSCR 17-TRV-03A: Jingen Liu

Anticipated Action Path: AD-2016-2

Property Information and Location Property Development	Applicant's Request: Service Area Categories & Justification										
<ul style="list-style-type: none"> • 11801 Stoney Creek Rd, Potomac • Parcel 493, Beall Mount Big Pines (acct. no. 00388933) • Map tile: WSSC – 215NW12; MD –EQ562 • Stoney Creek Rd near intersection of Stoney Creek Way. • RE-2 Zone; 5.0 acres • Travilah Planning Area Potomac Subregion Master Plan (2002) • Watts Branch Watershed (MDE Use I) • <u>Existing use</u>: Improved, Single Family House (Built 1959) • <u>Proposed use</u>: One New Single Family House 	<table border="1" style="width: 100%; border-collapse: collapse;"> <tr> <th colspan="2" style="text-align: left; border-bottom: 1px solid black;">Existing – Requested – Service Area Categories</th> </tr> <tr> <td style="width: 50%;">W-1</td> <td style="width: 50%;">W-1 (No Change)</td> </tr> <tr> <td>S-6</td> <td>S-1</td> </tr> <tr> <th colspan="2" style="text-align: left; border-bottom: 1px solid black;">Applicant's Explanation</th> </tr> <tr> <td colspan="2" style="padding: 5px;">"New Construction of Single Family Home."</td> </tr> </table>	Existing – Requested – Service Area Categories		W-1	W-1 (No Change)	S-6	S-1	Applicant's Explanation		"New Construction of Single Family Home."	
Existing – Requested – Service Area Categories											
W-1	W-1 (No Change)										
S-6	S-1										
Applicant's Explanation											
"New Construction of Single Family Home."											

Agency Review Comments

DPS:

M-NCPPC – Planning Dept.:

M-NCPPC – Parks Planning:

WSSC - Water: *(not requested)*

WSSC - Sewer:

