

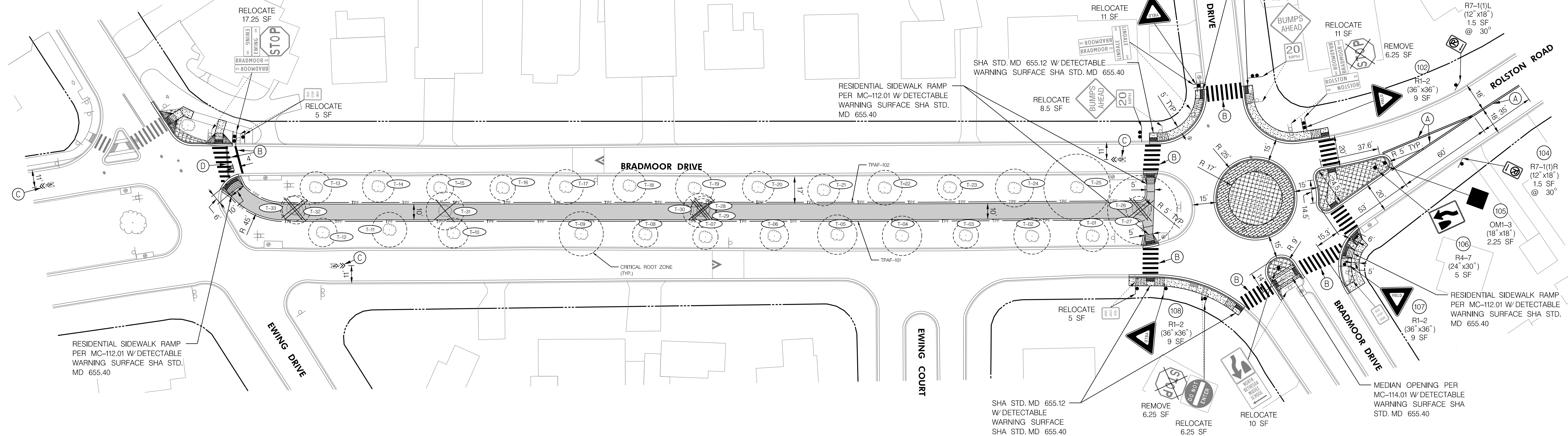

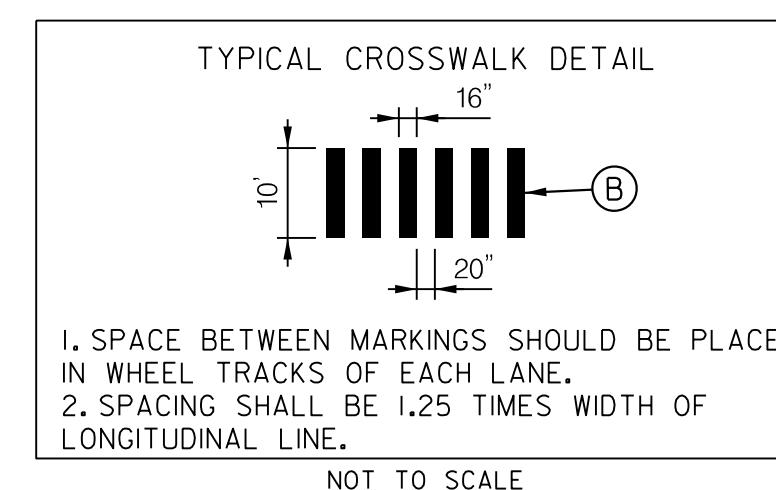

TREE PRESERVATION AREA FENCE (TPAF)	
603 L.F.	TPAF-101
596 L.F.	TPAF-102



1. MAINTENANCE OF TRAFFIC WILL BE HANDLED BY THE CONTRACTOR UTILIZING MONTGOMERY COUNTY STANDARD TYPICALS FOR TRAFFIC CONTROL.
2. RIGHT OF WAY LINES SHOWN ARE NOT OFFICIAL RIGHT OF WAY AND EASEMENT INFORMATION. SEE APPROPRIATE RIGHT OF WAY PLATS.
3. ALL PAVEMENT MARKINGS SHALL BE INSTALLED IN ACCORDANCE WITH MDSHA STANDARDS.
4. THE CONTRACTOR SHALL CENTER THE PROPOSED CROSSWALKS ON THE PROPOSED SIDEWALK RAMPS.
5. THE CONTRACTOR SHALL REFER TO FIGURE 9C-9 OF THE 2011 MARYLAND MUTCD FOR THE SHARED LANE PAVEMENT MARKING DETAIL.
6. PROPOSED GEOMETRIC IMPROVEMENTS ARE BASED OFF AVAILABLE GIS MAPPING. THE CONTRACTOR SHALL LAYOUT THE PROPOSED GEOMETRIC IMPROVEMENTS PRIOR TO CONSTRUCTION. IF ANY CONFLICTS ARISE, THE CONTRACTOR SHALL NOTIFY THE PROJECT ENGINEER.

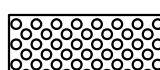
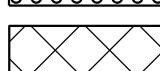
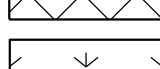

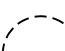
- | <u>LEGEND</u> | |
|---|----------------------------|
|  | ASPHALT SHARED USE PATH |
|  | CONCRETE SIDEWALK |
|  | DETECTABLE WARNING SURFACE |
|  | PAVEMENT/SIDEWALK REMOVAL |
|  | TURFGRASS |
|  | EXISTING TREE |
|  | REMOVAL OF EXISTING TREE |
|  | CRITICAL ROOT ZONE |

TPP-01

DEPARTMENT OF TRANSPORTATION
DIVISION OF TRAFFIC ENGINEERING & OPERATIONS
MONTGOMERY COUNTY, MARYLAND

TREE PROTECTION PLAN

BRADMOOR DRIVE
INTERSECTION IMPROVEMENTS

SCALE 1"= 30'

FINAL REVIEW

PLOTTED: 5/16/2024
FILE: I:\Projects\4019356\4019356_0018\90_CAD Models and Sheets\04_CT_Transportation\Bradmoor Drive Intersection Improvements\pLD-P001_Bradmoor_SUP.dgn

Alternative B: All-Way Stop
with Sidewalk down center median

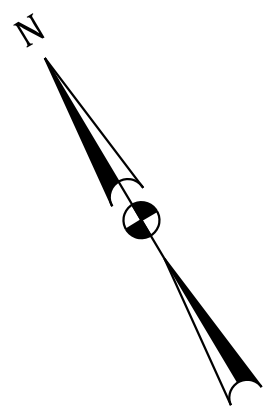

BRADMOOR DRIVE INTERSECTION IMPROVEMENTS ALL WAY STOP CONCEPT

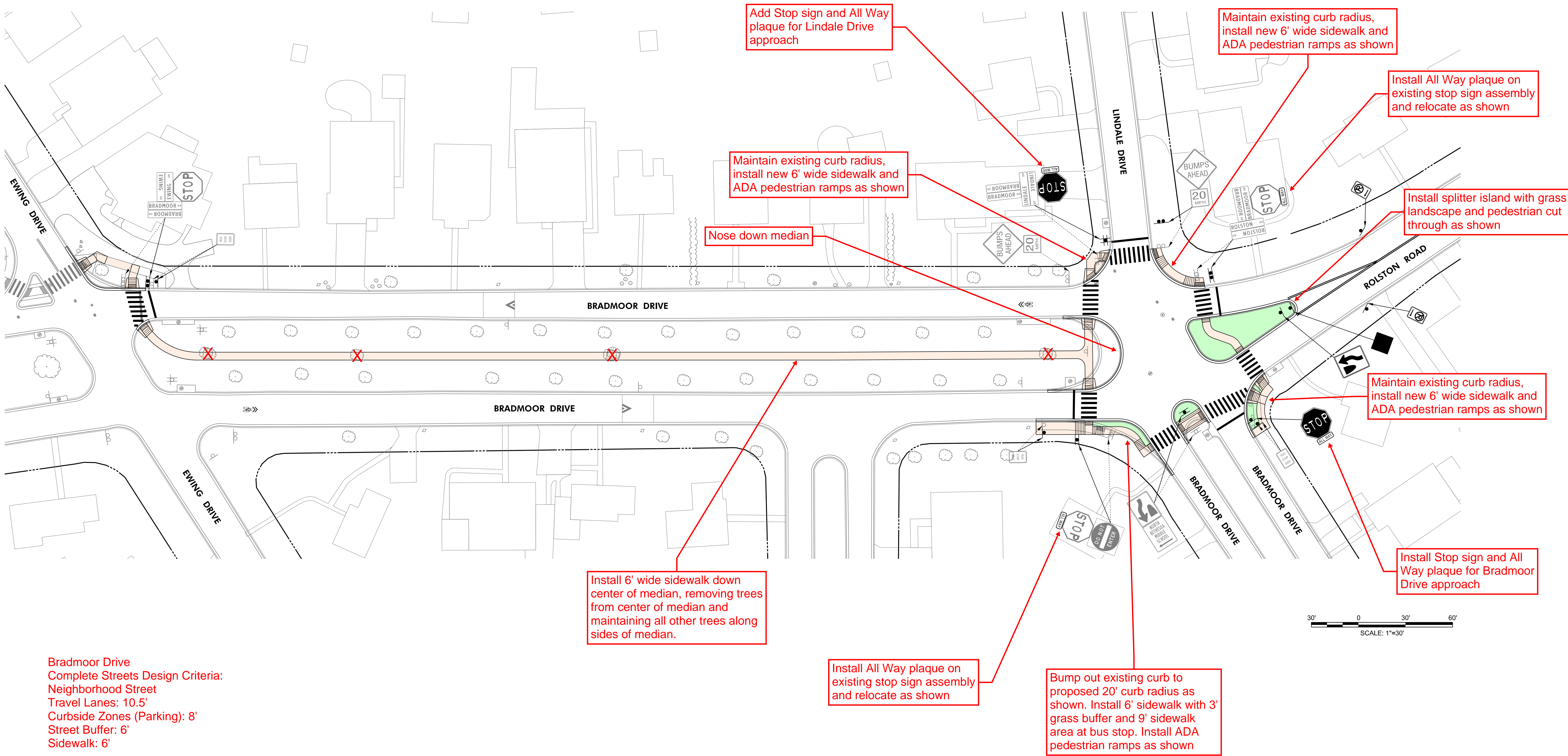

Alternative B: All-Way Stop
with Sidewalk on south side of Bradmoor Drive

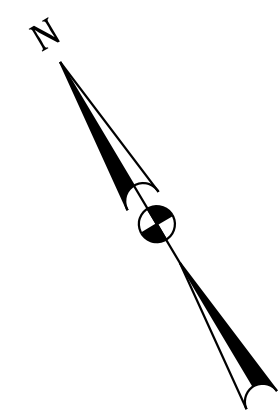

BRADMOOR DRIVE INTERSECTION IMPROVEMENTS ALL WAY STOP WITH ALTERNATE SIDEWALK CONCEPT

Note that alternate sidewalk design would require removal of a minimum of 8 existing trees and may impact additional trees resulting in their removal as well.

