

EV-1 MID-COUNTY COMMUNITY RECREATION CENTER – NO ELECTIONEERING ZONE



EV-2 EXECUTIVE OFFICE BUILDING – NO ELECTIONEERING ZONE



Executive Office Building
101 Monroe Street
Executive Office Building



NOTICE AVISO
ELECTIONEERING BEYOND THIS POINT PROHIBITED BY LAW
LA LEY PROHIBE HACER CAMPAÑA ELECTORAL MAS ALLA DE ESTE PUNTO

NOTICE AVISO
ELECTIONEERING BEYOND THIS POINT PROHIBITED BY LAW
LA LEY PROHIBE HACER CAMPAÑA ELECTORAL MAS ALLA DE ESTE PUNTO

NOTICE AVISO
ELECTIONEERING BEYOND THIS POINT PROHIBITED BY LAW
LA LEY PROHIBE HACER CAMPAÑA ELECTORAL MAS ALLA DE ESTE PUNTO

EV-2 EXECUTIVE OFFICE BUILDING – NO ELECTIONEERING ZONE (REAR)



EV-4 MARILYN J. PRAISNER COMM RECREATION CENTER – NO ELECTIONEERING ZONE



EV-4 MARILYN J. PRAISNER COMM RECREATION CENTER – NO ELECTIONEERING ZONE



NOTICE AVISO
El Ayuntamiento
de San José
prohibe la campaña
de campaña de
campaña de
campaña de

NOTICE AVISO
El Ayuntamiento
de San José
prohibe la campaña
de campaña de
campaña de
campaña de

Marilyn Praisner
Community Center
Marilyn Praisner
Community Center
Marilyn Praisner
Community Center



EV-3 GERMANTOWN COMMUNITY RECREATION CENTER – NO ELECTIONEERING ZONE



EV-5 SILVER SPRING CIVIC BUILDING – NO ELECTIONEERING ZONE



EV-5 SILVER SPRING CIVIC BUILDING – NO ELECTIONEERING ZONE

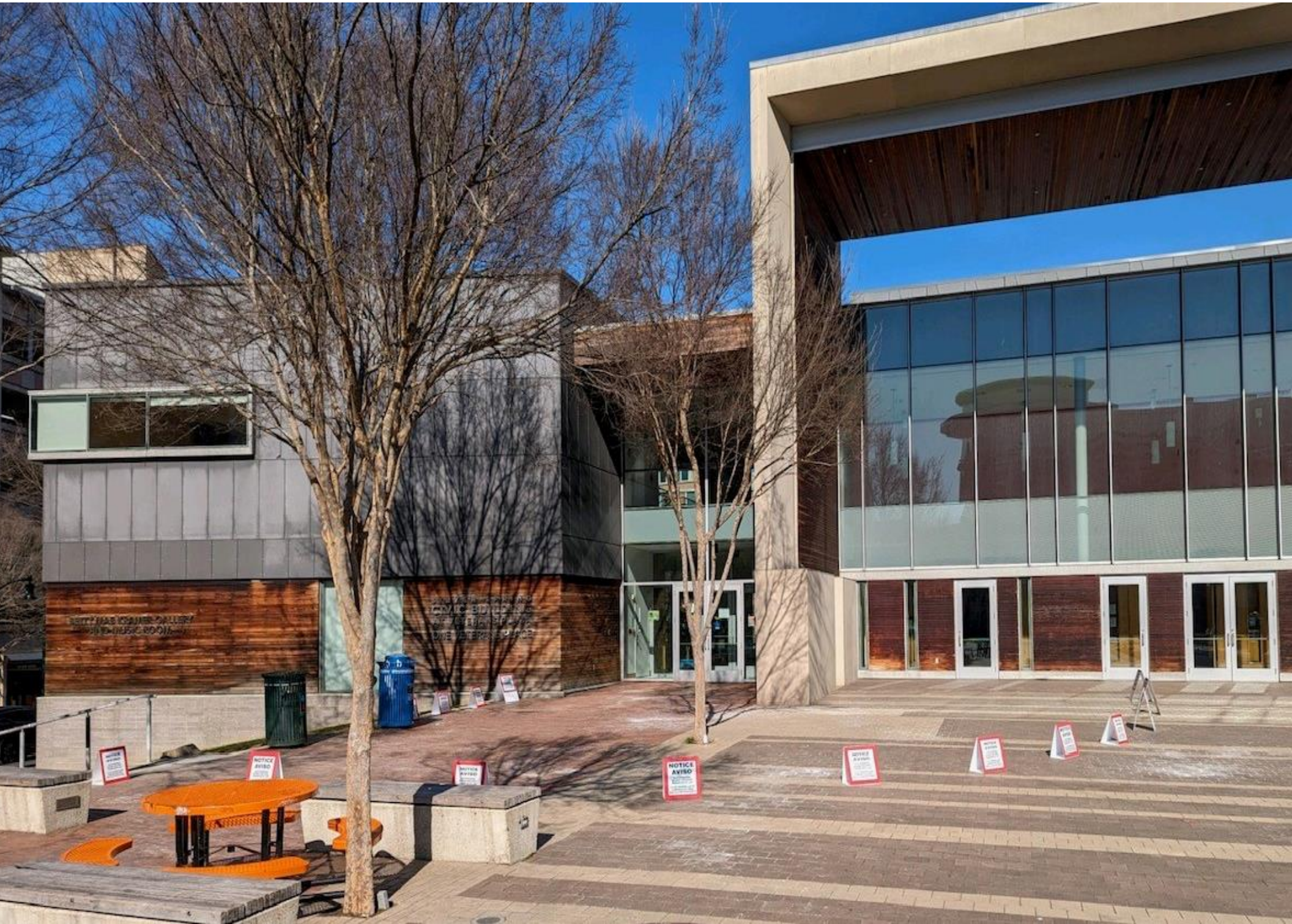

EV-5 SILVER SPRING CIVIC BUILDING – NO ELECTIONEERING ZONE



EV-5 SILVER SPRING CIVIC BUILDING – NO ELECTIONEERING ZONE



EV-6 ACTIVITY CENTER AT BOHRER PARK – NO ELECTIONEERING ZONE



EV-6 ACTIVITY CENTER AT BOHRER PARK – NO ELECTIONEERING ZONE



NOTICE AVISO
ELECTIONEERING BEYOND THIS POINT PROHIBITED BY LAW
LA LEY PROHIBE HACER CAMPAÑA ELECTORAL MAS ALLA DE ESTE PUNTO

NOTICE AVISO
ELECTIONEERING BEYOND THIS POINT PROHIBITED BY LAW
LA LEY PROHIBE HACER CAMPAÑA ELECTORAL MAS ALLA DE ESTE PUNTO

EV-7 DAMASCUS COMMUNITY RECREATION CENTER – NO ELECTIONEERING ZONE



EV-8 JANE E. LAWTON COMM RECREATION CENTER – NO ELECTIONEERING ZONE



JANE E. LAWTON
COMMUNITY RECREATION CENTER

NO SMOKING
NO OPENING
FIRE EXITS ON
THIS PROPERTY

NOTICE
AVISO

NOTICE
AVISO

NOTICE
AVISO

NOTICE
AVISO

**NOTICE
AVISO**
ELECTIONEERING
BEYOND THIS POINT
PROHIBITED BY LAW
LA LEY PROHIBE HACER
CAMPANA ELECTORAL
MAS ALLA DE ESTE PUNTO

**NOTICE
AVISO**
ELECTIONEERING
BEYOND THIS POINT
PROHIBITED BY LAW
LA LEY PROHIBE HACER
CAMPANA ELECTORAL
MAS ALLA DE ESTE PUNTO

EV-9 WHEATON LIBRARY & RECREATION COMM CENTER – NO ELECTIONEERING ZONE



NOTICE AVISO
ELECTIONEERING
BEYOND THIS POINT
PROHIBITED BY LAW
LA LEY PROHIBE NACEO
CENTRAL ELECTORAL
MAS ALLA DE ESTE PUNTO

NOTICE AVISO
ELECTIONEERING
BEYOND THIS POINT
PROHIBITED BY LAW
LA LEY PROHIBE NACEO
CENTRAL ELECTORAL
MAS ALLA DE ESTE PUNTO

NOTICE AVISO
ELECTIONEERING
BEYOND THIS POINT
PROHIBITED BY LAW
LA LEY PROHIBE NACEO
CENTRAL ELECTORAL
MAS ALLA DE ESTE PUNTO

NOTICE AVISO
ELECTIONEERING
BEYOND THIS POINT
PROHIBITED BY LAW
LA LEY PROHIBE NACEO
CENTRAL ELECTORAL
MAS ALLA DE ESTE PUNTO

NOTICE AVISO
ELECTIONEERING
BEYOND THIS POINT
PROHIBITED BY LAW
LA LEY PROHIBE NACEO
CENTRAL ELECTORAL
MAS ALLA DE ESTE PUNTO

EV-9 WHEATON LIBRARY & RECREATION COMM CENTER – NO ELECTIONEERING ZONE



EV-9 WHEATON LIBRARY & RECREATION COMM CENTER – NO ELECTIONEERING ZONE (GEORGIA AVE ENTRANCE)



EV-9 WHEATON LIBRARY & RECREATION COMM CENTER – NO ELECTIONEERING ZONE



NOTICE AVISO
ELECTIONEERING BEYOND THIS POINT PROHIBITED BY LAW
LA LEY PROHIBE HACER CAMPAÑA ELECTORAL MAS ALLA DE ESTE PUNTO

NOTICE AVISO
ELECTIONEERING BEYOND THIS POINT PROHIBITED BY LAW
LA LEY PROHIBE HACER CAMPAÑA ELECTORAL MAS ALLA DE ESTE PUNTO

NOTICE AVISO
ELECTIONEERING BEYOND THIS POINT PROHIBITED BY LAW
LA LEY PROHIBE HACER CAMPAÑA ELECTORAL MAS ALLA DE ESTE PUNTO

ELEVATOR

NOTICE
PRIVATE PROPERTY

CAUTION

EXIT

EV-9 WHEATON LIBRARY & RECREATION COMM CENTER – NO ELECTIONEERING ZONE (GARAGE)



EV-9 WHEATON LIBRARY & RECREATION COMM CENTER – NO ELECTIONEERING ZONE



Left side facing elevator

EV-9 WHEATON LIBRARY & RECREATION COMM CENTER – NO ELECTIONEERING ZONE



EV-10 POTOMAC COMMUNITY RECREATION CENTER – NO ELECTIONEERING ZONE



**NOTICE
AVISO**
ELECTIONEERING
BEYOND THIS POINT
PROHIBITED BY LAW
LA LEY PROHIBE HACER
CAMPAÑA ELECTORAL
MAS ALLA DE ESTE PUNTO

**NOTICE
AVISO**
ELECTIONEERING
BEYOND THIS POINT
PROHIBITED BY LAW
LA LEY PROHIBE HACER
CAMPAÑA ELECTORAL
MAS ALLA DE ESTE PUNTO

EV-11 SANDY SPRING, VFD, THE BALLROOM – NO ELECTIONEERING ZONE



EV-11 SANDY SPRING, VFD, THE BALLROOM – NO ELECTIONEERING ZONE



EV-12 WHITE OAK COMMUNITY RECREATION CENTER- NO ELECTIONEERING ZONE



EV-13 DACEK N. POTOMAC COMM RECREATION CENTER – NO ELECTIONEERING ZONE



EV-14 BAUER DRIVE COMMUNITY RECREATION CENTER – NO ELECTIONEERING ZONE



**NOTICE
AVISO**
ELECTIONEERING
BEYOND THIS POINT
IS PROHIBITED BY LAW.
LA LEY PROHIBE HACER
CAMPAÑA ELECTORAL
MAS ALLA DE ESTE PUNTO

**NOTICE
AVISO**
ELECTIONEERING
BEYOND THIS POINT
IS PROHIBITED BY LAW.
LA LEY PROHIBE HACER
CAMPAÑA ELECTORAL
MAS ALLA DE ESTE PUNTO