

Montrose Parkway East -- No. 500717

Category
Subcategory
Administering Agency
Planning Area

Transportation
Roads
Transportation
North Bethesda-Garrett Park

Date Last Modified
Required Adequate Public Facility
Relocation Impact
Status

January 03, 2011
No
Yes.
Final Design Stage

EXPENDITURE SCHEDULE (\$000)

Cost Element	Total	Thru FY10	Rem. FY10	Total 6 Years	FY11	FY12	FY13	FY14	FY15	FY16	Beyond 6 Years
Planning, Design, and Supervision	9,032	1,322	510	7,200	800	800	1,000	1,000	1,600	2,000	0
Land	12,453	2,006	1,567	8,880	1,890	3,990	3,000	0	0	0	0
Site Improvements and Utilities	2,700	0	0	2,700	0	0	0	0	2,700	0	0
Construction	95,310	10	0	95,300	0	0	20,300	24,800	26,200	24,000	0
Other	0	0	0	0	0	0	0	0	0	0	0
Total	119,495	3,338	2,077	114,080	2,690	4,790	24,300	25,800	30,500	26,000	0

FUNDING SCHEDULE (\$000)

EDAET	504	504	0	0	0	0	0	0	0	0	0
G.O. Bonds	102,493	2,117	2,077	98,299	2,690	2,461	21,673	23,645	21,860	25,970	0
Impact Tax	10,818	717	0	10,101	0	2,329	2,627	2,155	2,990	0	0
Intergovernmental	30	0	0	30	0	0	0	0	0	30	0
Recordation Tax Premium	5,650	0	0	5,650	0	0	0	0	5,650	0	0
Total	119,495	3,338	2,077	114,080	2,690	4,790	24,300	25,800	30,500	26,000	0

DESCRIPTION

This project provides for a new four-lane divided parkway as recommended in the North Bethesda/Garrett Park and Aspen Hill Master Plans. The roadway will be a closed section with a 11-foot wide lanes, a 10-foot wide bikepath on the north side, and 5-foot wide sidewalk on the south side. The project includes a 350-foot bridge over Rock Creek. The roadway limit is between the eastern limit of the MD355/Montrose interchange on the west and the intersection of Veirs Mill Road and Parkland Road on the east. The project includes a bridge over CSX, a grade-separated interchange with Parklawn Drive, and a tie-in to Veirs Mill Road. Appropriate stormwater management facilities and landscaping will be included.

CAPACITY

Average daily traffic is projected to be 42,800 vehicles per day by 2020.

ESTIMATED SCHEDULE

Design and right-of-way acquisition phase is expected to be complete in the spring of 2012 followed by a construction period of approximately 3 1/2 years.

JUSTIFICATION

This project will relieve traffic congestion on roadways in the area through increased network capacity. The project also provides improved safety for motorists, pedestrians, and bicyclists, as well as a greenway. The North Bethesda/Garrett Park Master Plan classifies this roadway as A-270. At the completion of the Phase I Facility Planning process, a project prospectus was completed in June 2004. This project will connect to the Montrose Parkway West and SHA MD 355/Randolph Road Relocation project.

OTHER

Design of this project will take into consideration the future Veirs Mill Road Bus Rapid Transit (BRT) service.

FISCAL NOTE

Shift expenditures and funding from FY13 and FY14 to FY16 to reflect current implementation plan.

Reduce Impact Taxes in FY12 through FY15 and increase GO Bonds to offset.

\$9 million for the design of the segment between MD 355/Montrose interchange and Parklawn Drive is in the State Transportation Participation project. Intergovernmental revenue represents Washington Suburban Sanitary Commission's (WSSC) share of the water and sewer relocation costs.

OTHER DISCLOSURES

- A pedestrian impact analysis has been completed for this project.

APPROPRIATION AND EXPENDITURE DATA	COORDINATION	MAP
Date First Appropriation	Department of Fire and Rescue Services	See Map on Next Page
First Cost Estimate	Department of Transportation	
Current Scope	Department of Permitting Services	
Last FY's Cost Estimate	Maryland-National Capital Park and Planning Commission	
Appropriation Request	Maryland State Highway Administration	
Supplemental Appropriation Request	Maryland Department of Environment	
Transfer	Washington Suburban Sanitary Commission	
Cumulative Appropriation	Washington Gas	
Expenditures / Encumbrances	PEPCO	
Unencumbered Balance	Verizon	
Partial Closeout Thru	State Transportation Participation Project No. 500722	
New Partial Closeout	Special Capital Projects Legislation [Bill No. 16-08] was adopted by Council June 10, 2008.	
Total Partial Closeout		

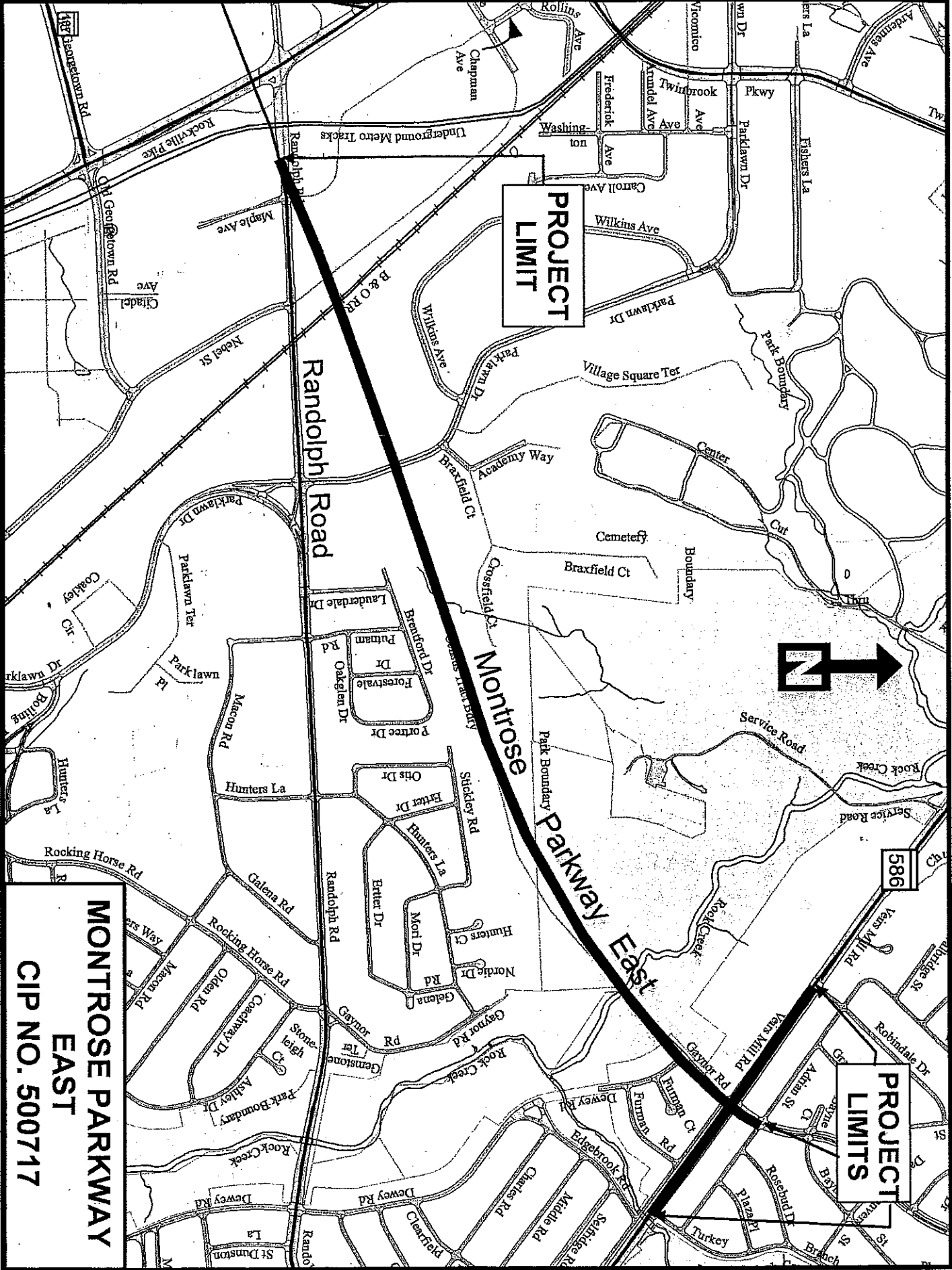

**PROJECT
LIMIT**

**PROJECT
LIMITS**

**MONTROSE PARKWAY
EAST
CIP NO. 500717**



586