

\\15244\Draw\FC_24_01.dwg, 1 of 2 - 2x638, 5/1/2020 11:13:23 AM. Copyright © 2017 Macris, Hendricks & Glascock, P.A.

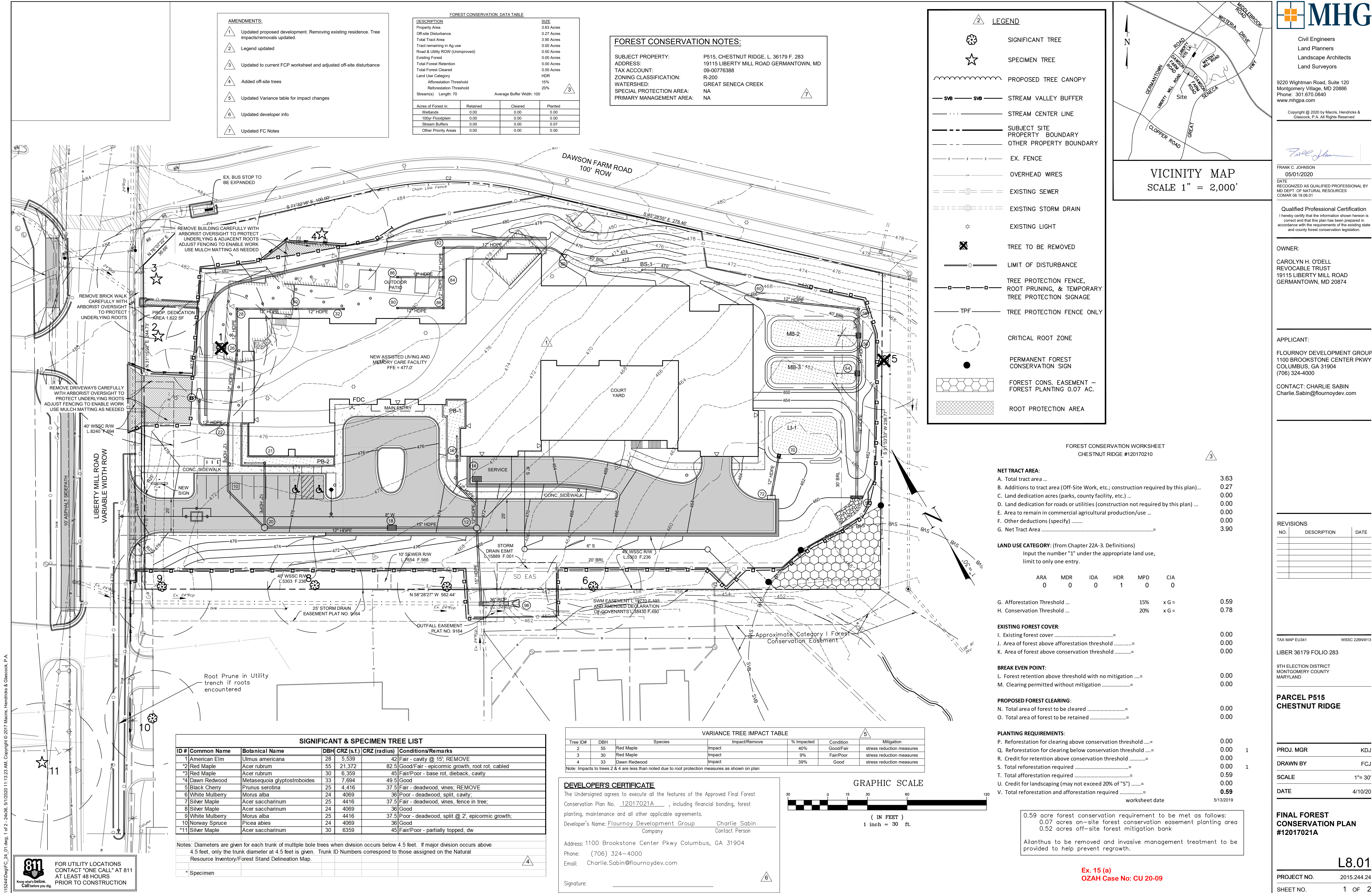

Civil Engineers
Land Planners
Landscape Architects
Land Surveyors

9220 Wightman Road, Suite 120
Montgomery Village, MD 20886
Phone: 301.670.0840
www.mhga.com

Copyright © 2020 by Macris, Hendricks & Glascock, P.A. All Rights Reserved

FRANK C. JOHNSON
05/01/2020

DATE
RECOGNIZED AS QUALIFIED PROFESSIONAL BY
MD DEPT. OF NATURAL RESOURCES
COMAR 08.19.06.01

Qualified Professional Certification
I hereby certify that the information shown hereon is correct and that this plan has been prepared in accordance with the requirements of the existing state and county forest conservation legislation.

OWNER:
CAROLYN H. O'DELL
REVOCABLE TRUST
19115 LIBERTY MILL ROAD
GERMANTOWN, MD 20874

APPLICANT:
FLOURNOY DEVELOPMENT GROUP
1100 BROOKSTONE CENTER PKWY
COLUMBUS, GA 31904
(706) 324-4000
CONTACT: CHARLIE SABIN
Charlie.Sabin@flournoydev.com

REVISIONS		
NO.	DESCRIPTION	DATE

TAX MAP EU341 WSSC 226NW13

LIBER 36179 FOLIO 283

9TH ELECTION DISTRICT
MONTGOMERY COUNTY
MARYLAND

PARCEL P515
CHESTNUT RIDGE

PROJ. MGR KDJ

DRAWN BY FCJ

SCALE 1" = 30'

DATE 4/10/20

FINAL FOREST CONSERVATION PLAN
#12017021A

PROJECT NO. 2015.244.24

SHEET NO. 1 OF 2

L8.01

