

**FOREST STAND SUMMARY CHART**

STAND	EXTENT (ACRES)	SPECIES	TREES PER ACRES	AVERAGE DIAMETER (INCHES)	FOREST STRUCTURE VALUE	PRIORITY RATING
A	+/-1.1	TULIP POPLAR	120	18-29.9	PRIORITY	HIGH
B	+/-6.0	NOTE: NO SAMPLE POINTS TAKEN; LOCATED IN BUFFER AREA				HIGH
C	+/-12.9	TULIP POPLAR	160	10-17.9	PRIORITY	MOD-HIGH
D	+/-1.0	NOTE: NO SAMPLE POINTS TAKEN; NO CONSTRUCTION PROP. IN THE AREA				
TOTAL +/-21.0 FOREST COVER						

**LEGEND**

- EXISTING 2' TOPOGRAPHY
- EXISTING STREAM
- EXISTING TREE LINES
- EXISTING 100 YEAR FLOODPLAIN AND 25' B.R.L.
- STREAM VALLEY BUFFER
- WETLANDS AND 25' BUFFER
- SOILS
- STEEP SLOPES (~25%)
- EXISTING BUILDINGS
- TREE STANDS
- SAMPLE PLOT POINTS
- SPECIES OF PLANTS ON THE WATCHLIST

**GENERAL NOTES**

- TOTAL SITE AREA +/- 58.5 ACRES (TAX MAP 0843 - 8624 PARCEL 2) R-200 +/- 38.5 ACRES R-90 +/- 20.0 ACRES
- TOTAL FORESTED AREA +/- 21.0 ACRES
- BOUNDARY, 5' TOPOGRAPHY AND TREELINE FROM H-NCPPC WETLANDS BY MCCARTHY & ASSOCIATES, INC. FLOODPLAIN FROM SHEETS 28 & 29 FLOODPLAIN INFORMATION PLANS STREAM VALLEY BUFFER INTERPRETED BY GREENHORNE & O'MARA, INC. FLOODPLAIN Labeled (RECORD PLAT) IS INTERPRETED FROM THE EXISTING RECORD PLAT. THIS FLOODPLAIN IS OF UNKNOWN ORIGIN, AND IS SHOWN FOR INFORMATIONAL PURPOSES ONLY.
- SOILS FROM U.S.D.A. NATURAL RESOURCE CONSERVATION SERVICE 1995 SOIL SURVEY OF MONTGOMERY COUNTY, MARYLAND (PLATE 26) 28 - GLENELG SILT LOAM, 3-8% 2C - GLENELG SILT LOAM, 8-15% 16D - BRINLOH-BLOCKTOWN CHANNERY SILT LOAM, 15-25% 53A - CODORUS SILT LOAM, 0-3% (HYDRIC) 116D - BLOCKTOWN CHANNERY SILT LOAM, 15-25% 116E - BLOCKTOWN CHANNERY SILT LOAM, 25-45%
- SITE LOCATED WITHIN THE CABIN JOHN CREEK WATERSHED ON-SITE STREAM - BOOZE CREEK
- HARRON MELIC-GRASS (MELICA MITICA), A STATE THREATENED PLANT POPULATION, WAS DISCOVERED ON THE SITE. IN ADDITION, THREE STATE WATCHLIST SPECIES, SHOWY SKULLCAP (SCUTELLARIA SEBASTIA), SHINING BEDSTRAW (GALLIUM CONCINNUM), AND SHINGLE OAK (QUERCUS IMBERICARIA), WERE DISCOVERED ON THE SITE. A SWAMP WHITE OAK (QUERCUS BICOLOR) WAS ALSO FOUND ON SITE, A SPECIES THAT IS CURRENTLY UNDER REVIEW FOR INCLUSION ON THE HERITAGE LIST. NO OTHER RARE, THREATENED, OR ENDANGERED SPECIES ARE KNOWN TO BE ON THE SITE.
- NO KNOWN HISTORIC FEATURES ON SITE.

**SIGNIFICANT TREES (>= 24" DBH)**

TAG #	SIZE/SPECIES
32	32" OAK
242	24" POPLAR
243	25" POPLAR
244	24" POPLAR
245	28" POPLAR
246	27" POPLAR
247	24" POPLAR
248	36" OAK
249	38" POPLAR
250	POPLAR
251	30" POPLAR
252	33" OAK
253	25" BEECH
254	26" BEECH
255	25" OAK
256	33" OAK
258	25" POPLAR
259	24" POPLAR
260	25" OAK
261	34" OAK
262	40" POPLAR
263	30" POPLAR
264	28" PINE
265	29" OAK
266	26" TREE
267	30" BEECH
269	25" POPLAR
291	20" D.L. QUINT. POPLAR
704	40" BEECH
705	30" OAK
706	28" OAK
707	30" POPLAR
708	40" POPLAR
709	36" OAK
712	40" OAK
713	30" POPLAR
715	28" POPLAR
716	30" OAK
717	30" OAK
NO TAG	44" SWAMP WHITE OAK

THE MARYLAND NATIONAL CAPITAL PARK AND PLANNING COMMISSION  
NR/FSD PLAN  
**APPROVED**  
NR/FSD No. 4-99132  
*Scott R. Wolford* 2/5/01  
SIGNATURE DATE

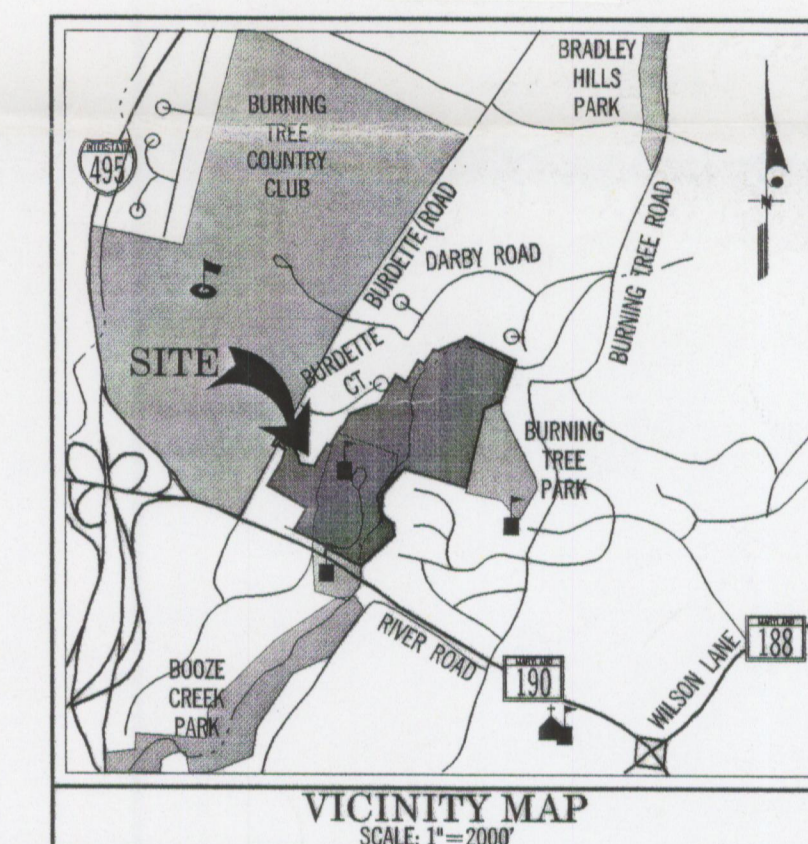

PRINTED  
FEB 2 2001  
GREENHORNE & O'MARA, INC.  
RECORDING SERVICE

Rec 2/5/2001

**INSET OF SHINING BEDSTRAW AND NARROW MELIC GRASS AREA**

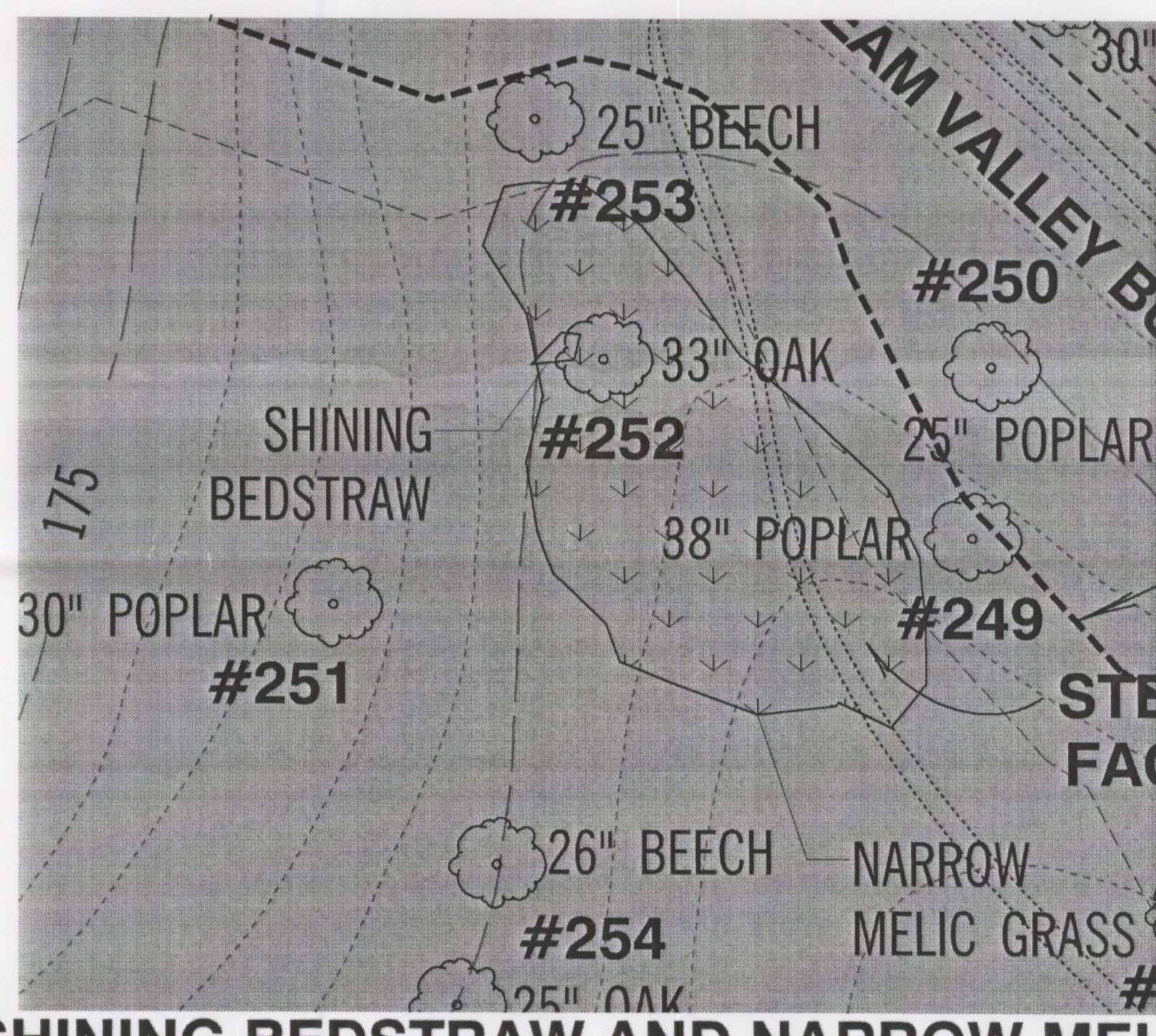

SCALE: 1" = 30'

OWNER:  
HOLTON-ARMS SCHOOL  
7303 RIVER ROAD  
BETHESDA, MARYLAND 20817-4697  
301-365-5300

I hereby certify that this Natural Resources Inventory/Forest Stand Delineation Map has been prepared in accordance with the Maryland Forest Conservation Act of 1991 and the Montgomery County Trees Technical Manual, effective September, 1992

Signature: *Scott R. Wolford*  
Scott R. Wolford, RLA  
Registered Landscape Architect, No. 797



No.	REVISION	DATE	BY
1	ADJUST STREAM VALLEY BUFFER AND SHOW WETLAND BUFFER	12/28/98	DNR
2	SHOW THREATENED AND "WATCHLIST" SPECIES	10/04/00	HG
3	REVISE STREAM VALLEY BUFFER, ENVIRONMENTAL BUFFER PER HNCPPC	02/02/01	HG

GENERAL CIVIL TRANSPORTATION ENVIRONMENTAL GEOGRAPHIC SCIENCES  
**GREENHORNE & O'MARA, INC.** 20410 CENTURY BOULEVARD, SUITE 200, GERMANTOWN, MARYLAND 20874  
PHONE: (301) 444-8282 FAX: (301) 444-8181  
www.g-and-o.com  
FLORIDA • GEORGIA • MARYLAND • NORTH CAROLINA • PENNSYLVANIA • VIRGINIA • WEST VIRGINIA

NATURAL RESOURCES INVENTORY/FOREST STAND DELINEATION MAP

**HOLTON-ARMS SCHOOL**

DRAWN	SCALE	1" = 100'
CHECKED	SHEET	1 OF 1
DATE	PROJ. No.	MAY 1998 7993-000
		R-3755-W

7th ELECTION DISTRICT  
MONTGOMERY COUNTY, MARYLAND