

LINE	BEARING	DISTANCE
1	N 89° 17' 21" E	15.95
2	N 89° 17' 21" E	15.95
3	N 89° 17' 21" E	15.95
4	N 89° 17' 21" E	15.95
5	N 89° 17' 21" E	15.95
6	N 89° 17' 21" E	15.95
7	N 89° 17' 21" E	15.95
8	N 89° 17' 21" E	15.95
9	N 89° 17' 21" E	15.95
10	N 89° 17' 21" E	15.95
11	N 89° 17' 21" E	15.95
12	N 89° 17' 21" E	15.95
13	N 89° 17' 21" E	15.95
14	N 89° 17' 21" E	15.95
15	N 89° 17' 21" E	15.95
16	N 89° 17' 21" E	15.95
17	N 89° 17' 21" E	15.95

CURVE	RADIUS	ARC LENGTH	CHORD LENGTH	CHORD BEARING	DELTA ANGLE
1	100.00	1.5708	1.0000	N 89° 17' 21" E	27.0000
2	100.00	1.5708	1.0000	N 89° 17' 21" E	27.0000
3	100.00	1.5708	1.0000	N 89° 17' 21" E	27.0000
4	100.00	1.5708	1.0000	N 89° 17' 21" E	27.0000
5	100.00	1.5708	1.0000	N 89° 17' 21" E	27.0000
6	100.00	1.5708	1.0000	N 89° 17' 21" E	27.0000
7	100.00	1.5708	1.0000	N 89° 17' 21" E	27.0000
8	100.00	1.5708	1.0000	N 89° 17' 21" E	27.0000
9	100.00	1.5708	1.0000	N 89° 17' 21" E	27.0000
10	100.00	1.5708	1.0000	N 89° 17' 21" E	27.0000
11	100.00	1.5708	1.0000	N 89° 17' 21" E	27.0000
12	100.00	1.5708	1.0000	N 89° 17' 21" E	27.0000
13	100.00	1.5708	1.0000	N 89° 17' 21" E	27.0000
14	100.00	1.5708	1.0000	N 89° 17' 21" E	27.0000
15	100.00	1.5708	1.0000	N 89° 17' 21" E	27.0000
16	100.00	1.5708	1.0000	N 89° 17' 21" E	27.0000
17	100.00	1.5708	1.0000	N 89° 17' 21" E	27.0000

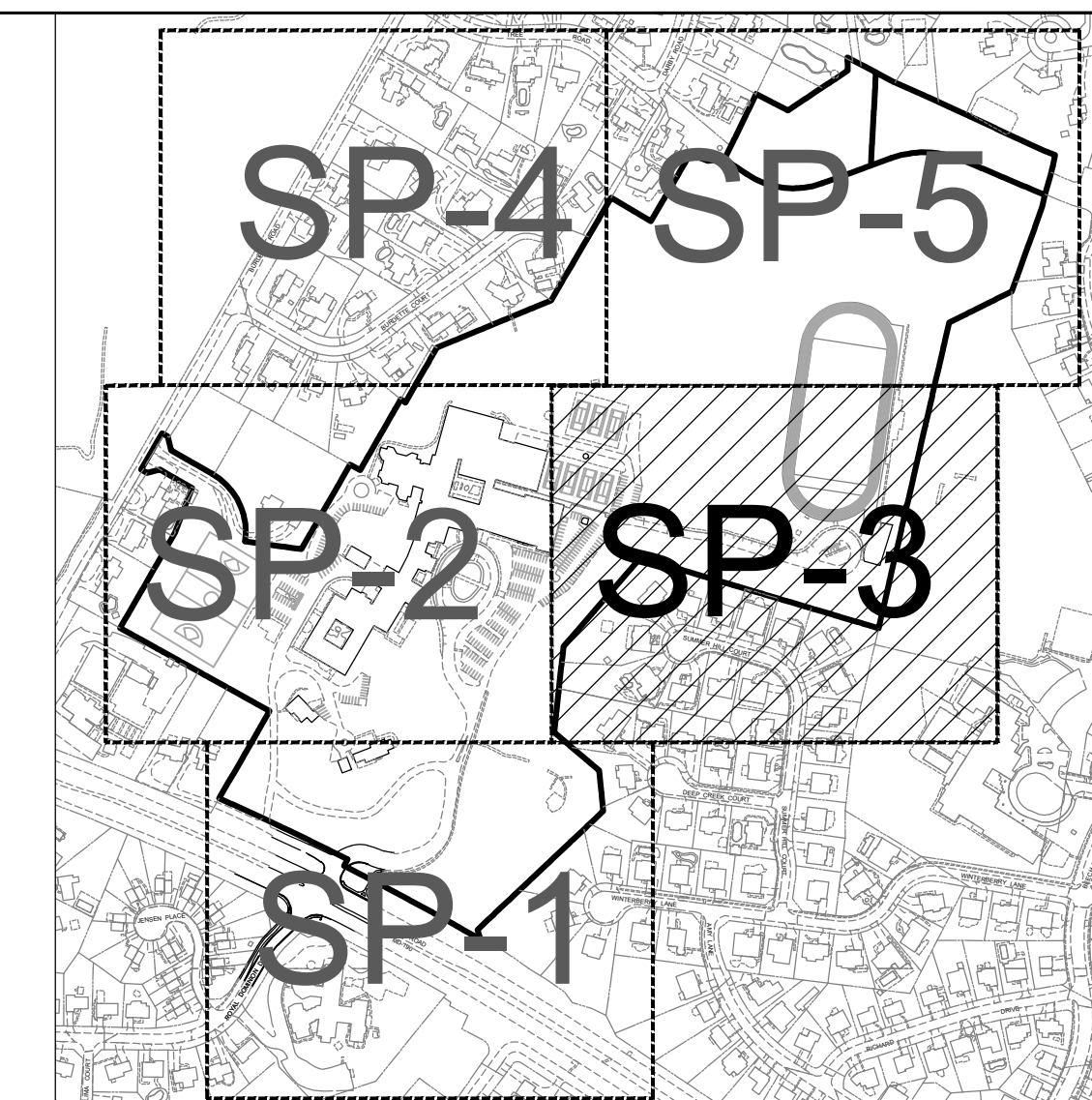

DRAWING KEY

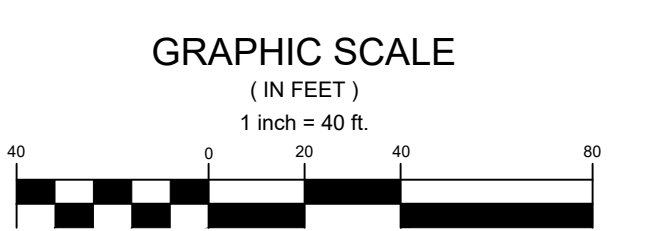
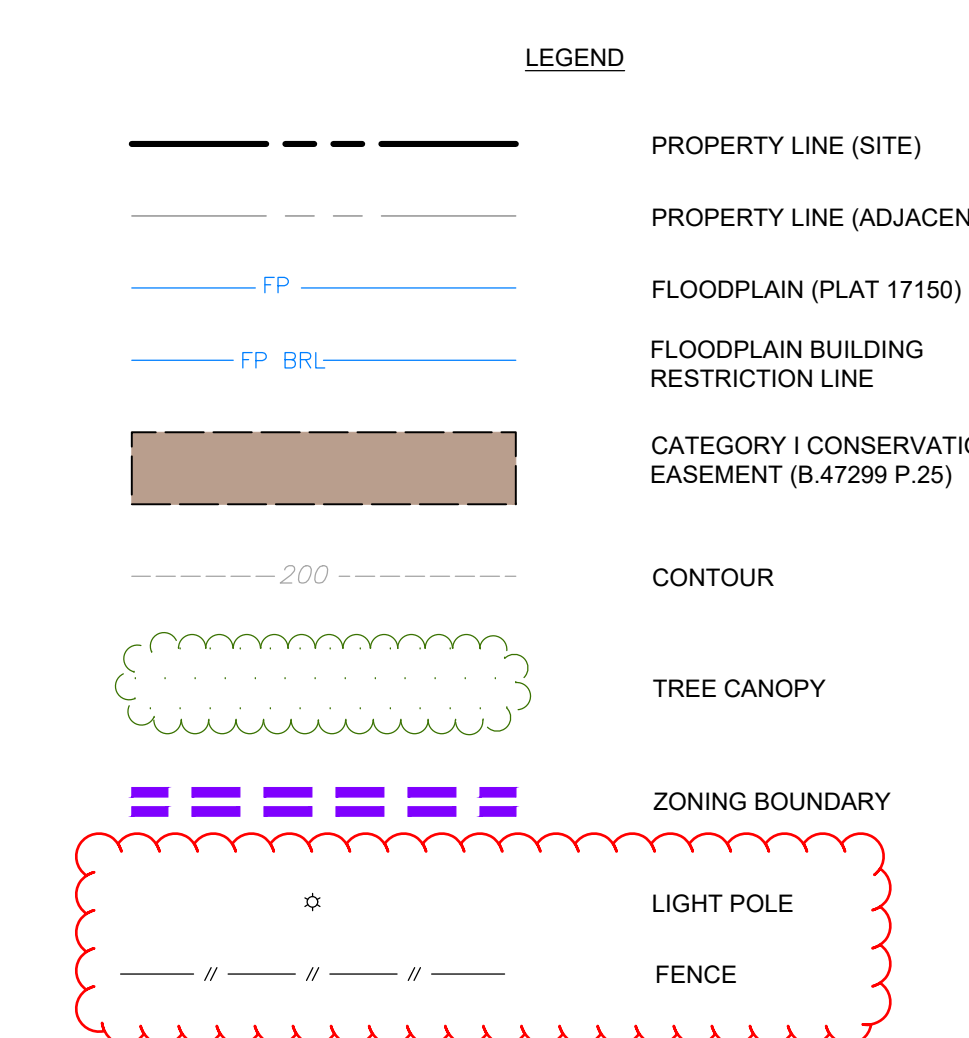

TAX MAP GNS3 WSSC 210R07

PLAT 24741

7TH ELECTION DISTRICT
MONTGOMERY COUNTY
MARYLAND

**PARCEL 4
BURNING TREE VALLEY
HOLTON-ARMS SCHOOL &
PARCELS 1 & 2
B.15417 P.146**

PROJ. MGR PGL
DRAWN BY PGL
SCALE 1" = 150'
DATE 03.31.2026

EXISTING CONDITIONS
SITE PLAN

SP1.03
PROJECT NO. 05.133.21
SHEET NO. 3 OF 5

I:\05133\05133\SP_1_01.dwg, SP_1.03, 4/10/2025 2:05:37 PM, Jengap, Copyright © 2025 Macris, Hendricks & Geisock, P.A.