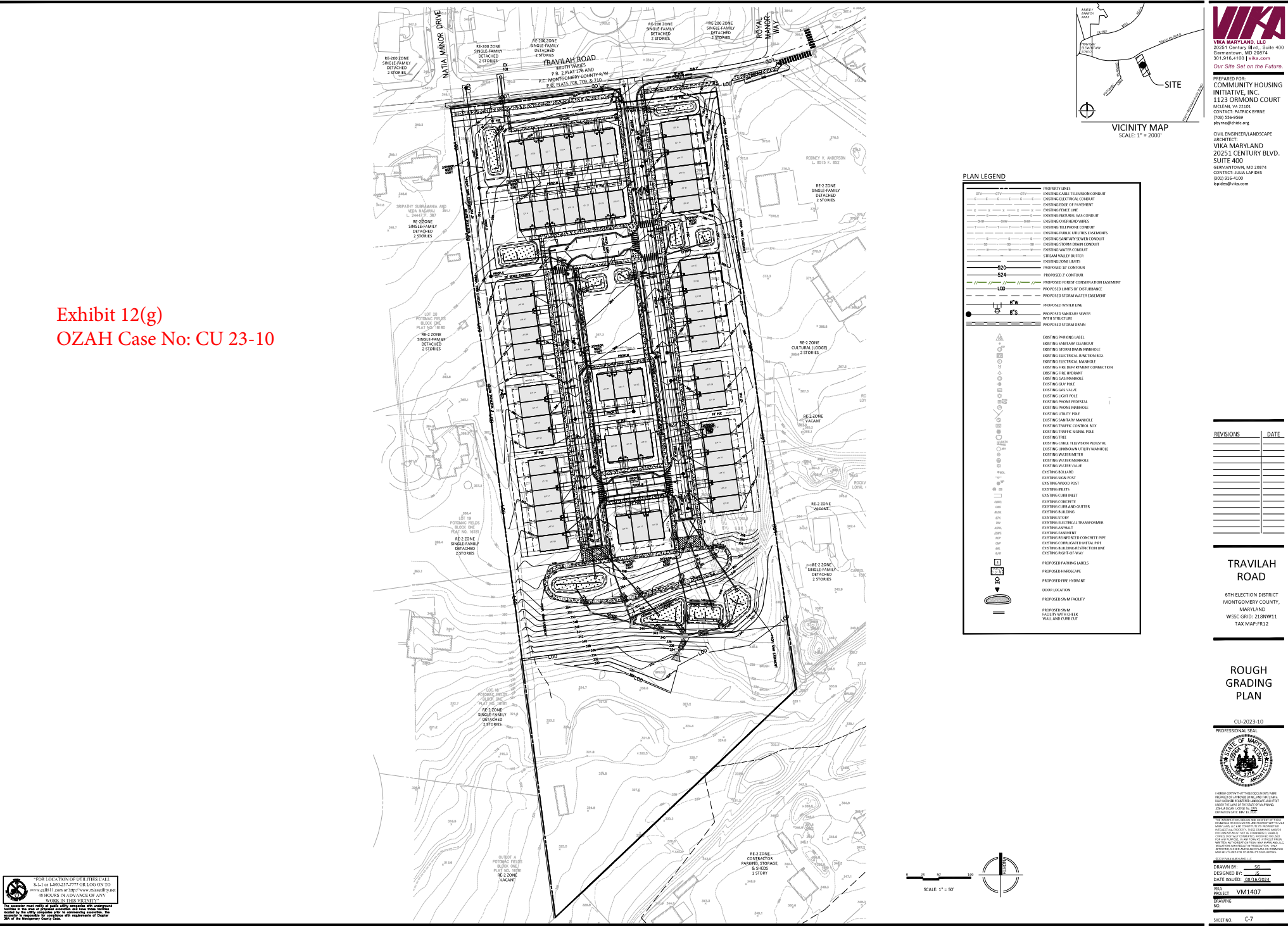

 "FOR LOCATION OF UTILITIES CALL
8-1-1 or 1-800-257-7777 OR LOG ON TO
www.call811.com or <http://www.thisutility.net>
48 HOURS IN ADVANCE OF ANY
WORK IN THIS VICINITY"

The excavator must notify all public utility companies with underground facilities in the area of proposed excavation and have these facilities located by the utility companies prior to commencing excavation. The excavator is responsible for compliance with requirements of Chapter 36A of the Montgomery County Code.

[illegible]

**TRAVILAH
ROAD**

6TH ELECTION DISTRICT
MONTGOMERY COUNTY,
MARYLAND
WSSC GRID: 218NW11
TAX MAP:FR12

ROUGH GRADING PLAN

CU-2023-10



I HEREBY CERTIFY THAT THESE DOCUMENTS WERE
PREPARED OR APPROVED BY ME, AND THAT I AM A
FULLY LICENSED-REGISTERED LANDSCAPE ARCHITECT
UNDER THE LAWS OF THE STATE OF MARYLAND.
JOSHUA SAGAN LICENSE NO. 2239
EXPIRATION DATE: MAY 31, 2015

THE INFORMATION CONTAINED HEREIN IS UNCLASSIFIED. IT IS THE PROPERTY OF WEA MARK, L.L.C. AND CONSTITUTES ITS PROPRIETARY INTELLECTUAL PROPERTY. THESE DRAWINGS AND/OR DOCUMENTS MUST NOT BE REPRODUCED, SHARED, COPIED, DIGITALLY CONVERTED, REPRODUCED OR USED FOR ANY PURPOSE, IN ANY FORMAT, WITHOUT WRITTEN AUTHORIZATION FROM WEA MARK, L.L.C. VIOLATIONS MAY RESULT IN PROSECUTION. ONLY APPROVED, SIGNED AND SEALED PLANS OR DRAWINGS MAY BE UTILIZED FOR CONSTRUCTION PURPOSES.

DRAWN BY: SG
DESIGNED BY: JS
DATE ISSUED: 08/15/2024
VIA PROJECT VM1407
DRAWING NO.
SHEET NO. C-7