

MATCHLINE L-0.3

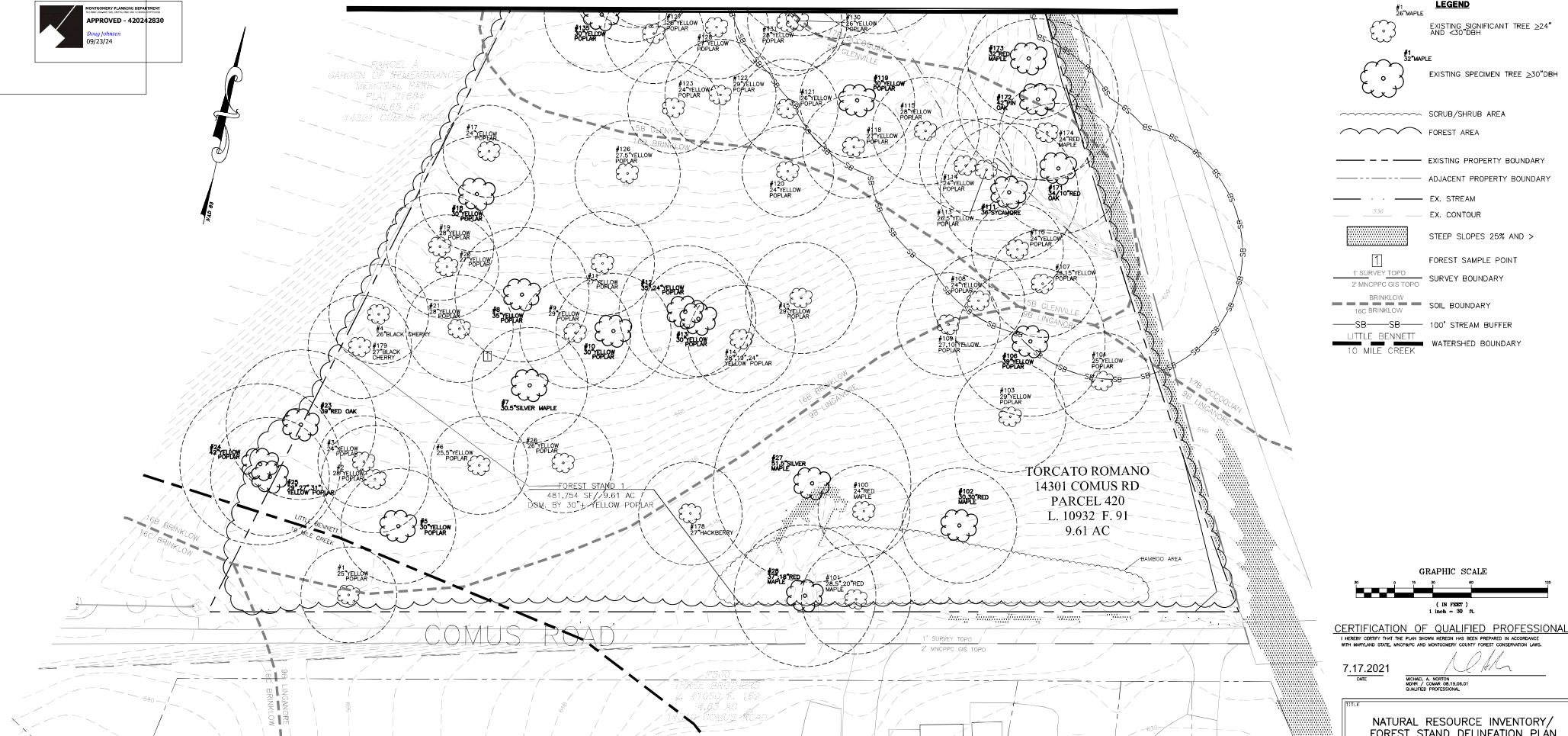

- LEGEND**
- EXISTING SIGNIFICANT TREE ≥24" AND <30'DBH
  - EXISTING SPECIMEN TREE ≥30'DBH
  - SCRUB/SHRUB AREA
  - FOREST AREA
  - EXISTING PROPERTY BOUNDARY
  - ADJACENT PROPERTY BOUNDARY
  - EX. STREAM
  - EX. CONTOUR
  - STEEP SLOPES 25% AND >
  - FOREST SAMPLE POINT
  - SURVEY BOUNDARY
  - SOIL BOUNDARY
  - 100' STREAM BUFFER
  - WATERSHIP BOUNDARY

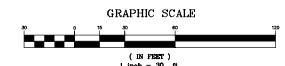

CERTIFICATION OF QUALIFIED PROFESSIONAL

I HEREBY CERTIFY THAT THE PLAN BOOK HEREON HAS BEEN PREPARED IN ACCORDANCE WITH MARYLAND STATE, MONTGOMERY AND MONTGOMERY COUNTY FOREST CONSERVATION LAWS.

7.17.2021

DATE

MICHAEL A. NORTON  
NORTON LAND DESIGN LLC  
REGISTERED PROFESSIONAL

GENERAL NRI/FSD NOTES

1. THIS PROPERTY IS ZONED AR.
2. THE TAX IDENTIFICATION NUMBER ASSOCIATED WITH THIS PLAN IS: 00023661.
3. THE TOTAL TRACT AREA IS 9.61 ACRES.
4. SITE FIELD WORK WAS PERFORMED IN DECEMBER 2019 & JUNE 2020 AND UPDATED JULY 2024 BY MICHAEL NORTON, NORTON LAND DESIGN LLC.
5. THIS PROPERTY IS NOT WITHIN A PMA OR SPA.
6. THE PROPERTY LIES WITHIN THE LITTLE BENNETT AND 10 MILE CREEK WATERSHEDS, USE LP.
7. FEMA FLOODPLAIN MAP PANEL #24031C0160C AND MNCPPC UTMATE FLOODPLAIN MAP NOTES NC FLOODPLAIN ON-SITE.
8. ACCORDING TO MD MERLIN ONLINE, US FISH & WILDLIFE SERVICE, NM, AND FIELD OBSERVATION, THERE ARE NO WETLANDS OR ASSOCIATED BUFFERS WITHIN 100' OF THE PROPERTY.
9. THERE ARE NO PRIME AGRICULTURAL, HYDRIC, HIGHLY EROSIIVE, OR SERPENTINE SOILS ON THE PROPERTY (SEE SOIL TABLE).
10. 1" TOPOGRAPHY AND BOUNDARY SURVEY FROM O'CONNELL & LAWRENCE.
11. THERE IS NO PRIME AGRICULTURAL SOILS ON THE PROPERTY (SEE SOIL TABLE).
12. ALL TREES 24" AND GREATER ON THE PROPERTY ARE SURVEY LOCATED AND MEASURED WITH A FORESTERS DIAMETER TAPE MEASURE.
13. ALL TREES 24" AND GREATER OFFSITE ARE LOCATED AND MEASURED BY OCULAR ESTIMATE ONLY. ALL MANMADE STRUCTURES OFFSITE ARE LOCATED BY AVAILABLE AERIAL PHOTOGRAPHS AND/OR OCULAR ESTIMATE.
14. ALL TREES 24" AND GREATER ON THE SUBJECT PROPERTY ARE SURVEYED AND MEASURED WITH A FORESTERS DIAMETER TAPE MEASURE.
15. ALL TREES 24" AND GREATER OFFSITE ARE LOCATED AND MEASURED BY OCULAR ESTIMATE ONLY. ALL MANMADE STRUCTURES OFFSITE ARE LOCATED BY AVAILABLE AERIAL PHOTOGRAPHS AND/OR OCULAR ESTIMATE.
16. NO RARE, THREATENED OR ENDANGERED SPECIES WERE OBSERVED ON OR OFFSITE AT THE TIME OF THE FIELD INVESTIGATION. A REQUEST LETTER WAS SENT TO MD-DNR JULY 11<sup>th</sup>, 2024 AND WE ARE AWAITING RESPONSE.
17. NO TREES OCCUR WITHIN THE STUDY AREA WHICH ARE RECOGNIZED AS CURRENT NATIONAL, STATE, OR COUNTY CHAMPION TREES, OR TREES THAT ARE AT LEAST 75% OF THE CURRENT STATE CHAMPION.
18. THE SUBJECT PROPERTY IS NOT LISTED AS INDIVIDUAL HISTORIC SITES AS FOUND IN THE MNCPPC HISTORIC PROPERTIES INTERACTIVE MAP.

NRI/FSD TABULATION TABLE

ACREAGE OF TRACT(S):	9.61
ACREAGE OF EX. FOREST:	3.61
ACREAGE OF EXISTING WETLANDS	0.00
ACREAGE OF FORESTED WETLANDS	0.00
ACREAGE OF WETLAND BUFFERS	0.00
ACREAGE OF STREAM BUFFERS	3.10
ACREAGE OF FORESTED STREAM BUFFER	3.10
ACREAGE OF 100 YEAR FLOODPLAIN	0.00
LINEAR EXTENT OF STREAMS	615
AVERAGE WIDTH OF STREAM BUFFER	200'

SOIL TABLE

SOILS	ERODIBLE	HYDRIC	CONTAINS 15-25% SLOPES	CONTAINS > 25% SLOPES	CAPABILITY SUBCLASS SYMBOL	PRIME AGRICULTURAL SOIL
16B BRINKLOW-BROOKTOWN SILT LOAM 3-8% SLOPES	NO	NO	N/A	NO	e	NO
16C BRINKLOW-BROOKTOWN SILT LOAM 8-15% SLOPES	NO	NO	N/A	NO	e	NO
5B GLENVILLE SILT LOAM 3-8% SLOPES	NO	NO	N/A	YES	e	NO
17B ODOCOOHAN LOAM	NO	NO	N/A	YES	e	NO
5B LINGANORE-HYATTSTOWN CHANNELLY SILT LOAM 3-8% SLOPES	NO	NO	N/A	YES	e	NO

Exhibit 13(b)  
OZAH Case No: CU 25-06

FILE

NATURAL RESOURCE INVENTORY/  
FOREST STAND DELINEATION PLAN  
NO. 420242830

PROJECT

COMUS RD  
PARCEL P420  
14301 COMUS RD  
CLARKSBURG, MD 20871  
ELECTION DISTRICT - 15

PREPARED FOR

TORCATO ROMANO  
15900 WOODS CENTER ROAD  
SILVER SPRING, MD 20906

PREPARED BY

**nld** NORTON LAND DESIGN  
NORTON LAND DESIGN LLC  
LANDSCAPE ARCHITECTURE & ENVIRONMENTAL PLANNING

FILED

WATER CLASS LP WATERSHIP LITTLE BENNETT CREEK & 10 MILE CREEK  
PROPERTY N/A  
TAX MAP EW222  
SCALE AS SHOWN

DATE JULY 2024

PROJECT NO. 17-040

PROJECT NO. L-0.2