

PLANTING NOTES

- THIS PLAN IS FOR PLANTING PURPOSES ONLY.
- CONTRACTOR SHALL BE SOLELY RESPONSIBLE FOR ALL PLANT MAINTENANCE, INCLUDING SHRUBS AND GROUNDCOVER, AND SHALL MAINTAIN AREA IN A WEED AND DEBRIS FREE CONDITION, THROUGHOUT THE ONE YEAR GUARANTEE PERIOD.
- CONTRACTOR SHALL LAY OUT AND CLEARLY STAKE ALL PROPOSED IMPROVEMENTS INCLUDED ON THIS PLAN.
- CONTRACTOR IS RESPONSIBLE FOR CONTACTING MISS UTILITY PRIOR TO BEGINNING CONSTRUCTION FOR LOCATION OF ALL UTILITY LINES. TREES SHALL BE LOCATED A MINIMUM OF 5 FEET FROM SEWER/WATER CONNECTIONS. CONTRACTOR SHALL BE LIABLE FOR DAMAGE TO ANY AND ALL PUBLIC OR PRIVATE UTILITIES.
- QUANTITIES AS SHOWN ON THE PLAN SHALL GOVERN OVER PLANT LIST QUANTITIES. CONTRACTOR TO VERIFY PLANT LIST TOTALS WITH QUANTITIES SHOWN ON PLAN. LANDSCAPE ARCHITECT SHALL BE ALERTED BY CONTRACTOR OF ANY DISCREPANCIES PRIOR TO FINAL BID NEGOTIATION. UNIT PRICES FOR ALL MATERIAL SHALL BE SUPPLIED TO THE OWNER AT BIDDING TIME.
- ALL MATERIALS SHALL BE SUBJECT TO APPROVAL BY THE LANDSCAPE ARCHITECT. OWNER SHALL RECEIVE TAG FROM EACH PLANT SPECIES AND A LIST OF PLANT SUPPLIERS. WHERE ANY REQUIREMENTS ARE OMITTED FROM THE PLANT LIST, THE PLANTS FURNISHED SHALL MEET THE NORMAL REQUIREMENTS FOR THE VARIETY PER THE AMERICAN STANDARD FOR NURSERY STOCK, LATEST EDITION, PUBLISHED BY AMERICANHORT. PLANTS SHALL BE PRUNED PRIOR TO DELIVERY ONLY UPON THE APPROVAL OF THE LANDSCAPE ARCHITECT.
- CONTRACTOR IS RESPONSIBLE FOR SOIL TESTING AND PREPARATION AS OUTLINED IN THE CURRENT EDITION OF THE LANDSCAPE SPECIFICATION GUIDELINES OF THE LANDSCAPE CONTRACTORS ASSOCIATION OF MD-DC-VA (LCA). PREPARATION SHALL INCLUDE, BUT NOT NECESSARILY BE LIMITED TO, THE ADDITION OF SOIL AMENDMENTS, FERTILIZERS AND SUPPLEMENTAL TOPSOIL AS INDICATED BY TESTING; AND SUBGRADE, FINAL GRADE AND FINISH GRADE SOIL PREPARATION.
- WHERE TREES ARE PLANTED IN ROWS, THEY SHALL BE UNIFORM IN SIZE AND SHAPE.
- SIZES SPECIFIED IN THE PLANT LIST ARE MINIMUM SIZES TO WHICH THE PLANTS ARE TO BE JUDGED. FAILURE TO MEET MINIMUM SIZE ON ANY PLANT WILL RESULT IN REJECTION OF THAT PLANT.
- ALL PLANTS SHALL BE FRESHLY DUG, SOUND, HEALTHY, VIGOROUS, WELL BRANCHED, FREE OF DISEASE, INSECT EGGS, AND LARVAE, AND SHALL HAVE ADEQUATE ROOT SYSTEMS.
- ALL CONTAINER GROWN MATERIAL SHALL BE HEALTHY, VIGOROUS, WELL-ROOTED PLANTS AND ESTABLISHED IN THE CONTAINER IN WHICH THEY ARE SOLD. THE PLANTS SHALL HAVE TOPS WHICH ARE GOOD QUALITY AND ARE IN A HEALTHY GROWING CONDITION.
- GROUPS OF SHRUBS SHALL BE PLACED IN A CONTINUOUS MULCH BED WITH SMOOTH CONTINUOUS LINES. ALL MULCHED BED EDGES SHALL BE CURVILINEAR IN SHAPE FOLLOWING THE CONTOUR OF THE PLANT MASS UNLESS OTHERWISE NOTED. TREES LOCATED WITHIN FOUR FEET OF SHRUB BEDS SHALL SHARE SAME MULCH BED.
- NO EXISTING TREES SHALL BE REMOVED WITHOUT WRITTEN AUTHORIZATION FROM THE OWNER EXCEPT WHERE NOTED ON PLANS. NO GRUBBING SHALL OCCUR WITHIN EXISTING TREE AREAS.
- TREES SHALL BE LOCATED A MINIMUM OF 3 FEET FROM WALLS AND WALKS WITHIN THE PROJECT. IF CONFLICTS ARISE BETWEEN ACTUAL SIZE OF AREA AND PLANS, CONTRACTOR SHALL CONTACT LANDSCAPE ARCHITECT FOR RESOLUTION. FAILURE TO MAKE SUCH CONFLICTS KNOWN TO THE OWNER OR LANDSCAPE ARCHITECT WILL RESULT IN CONTRACTOR'S LIABILITY TO RELOCATE MATERIALS.
- LARGE GROWING PLANTS ARE NOT TO BE PLANTED IN FRONT OF WINDOWS, UNDER BUILDING OVERHANGS, OR IN DRAINAGE SWALES. SHRUBS PLANTED NEAR HVAC UNITS TO BE LOCATED SO THAT SHRUBS AT MATURITY WILL MAINTAIN 1-FOOT AIRSPACE BETWEEN UNIT AND PLANT.
- CONTRACTOR TO SLIGHTLY ADJUST PLANT LOCATIONS IN THE FIELD AS NECESSARY TO BE CLEAR OF DRAINAGE SWALES AND UTILITIES. FINISHED PLANTING BEDS SHALL BE GRADED SO AS NOT TO IMPEDE DRAINAGE AWAY FROM BUILDINGS.
- TREE STAKING AND GUYING SHALL BE DONE PER DETAILS. CONTRACTOR SHALL ENSURE THAT TREES REMAIN VERTICAL AND UPRIGHT FOR THE DURATION OF THE GUARANTEE PERIOD.
- ALL TREE PITS, SHRUB BEDS AND PREPARED PLANTING BEDS ARE TO BE COMPLETELY EXCAVATED IN ACCORDANCE WITH THE PLANTING DETAILS.
- MULCH IS TO BE DOUBLE SHREDDED HARDWOOD BARK FOR TREES AND SHRUBS.
- CROWN OF ROOT FLARE SHALL BE 1/2" - 3" HIGHER (AFTER SETTLING) THAN ADJACENT SOIL.
- TAGS AND TWINE ARE TO BE REMOVED AND BURLAP IS TO BE ROLLED BACK ONE-HALF ON ALL B&B PLANT MATERIAL.
- SHRUBS SHALL BE TRIANGULARLY SPACED AT SPACING SHOWN ON PLANTING PLANS WHERE MASSING IS INDICATED.
- SHADE TREES: HEIGHT SHALL BE MEASURED FROM THE CROWN OF THE ROOT FLARE TO THE TOP OF MATURE GROWTH. SPREAD SHALL BE MEASURED TO THE END OF BRANCHING EQUALLY AROUND THE SHRUB MASS. MEASUREMENTS ARE NOT TO INCLUDE ANY TERMINAL GROWTH.
- ALL SUBSTITUTIONS OF PLANT MATERIAL ARE TO BE REQUESTED IN WRITING TO THE LANDSCAPE ARCHITECT AND APPROVED IN WRITING BY THE OWNER AND MANCPC. FAILURE TO OBTAIN SUBSTITUTION APPROVAL IN WRITING MAY RESULT IN LIABILITY TO THE CONTRACTOR.
- ALL CONTRACTORS SHALL BE REQUIRED TO COMPLETELY REMOVE ALL TRASH, DEBRIS AND EXCESS MATERIALS FROM THE WORK AREA AND THE PROPERTY (ESPECIALLY AT ALL CURB, GUTTERS AND SIDEWALKS) DAILY DURING INSTALLATION.
- DEAD PLANTS ARE TO BE REMOVED FROM THE JOB BY THE CONTRACTOR ON A MONTHLY BASIS. CONTRACTOR SHALL MAINTAIN AN UPDATED, COMPREHENSIVE LIST OF ALL DEAD MATERIALS REMOVED AND PRESENT A COPY OF THE LIST TO THE OWNER AT THE END OF EVERY MONTH DURING THE CONTRACT PERIOD.
- CONTRACTOR SHALL BE RESPONSIBLE TO REGRADE, HYDRO-SEED, STRAW MULCH, AND TACK ALL LAWN AREAS DISTURBED AS THE RESULT OF HIS WORK.
- CONTRACTOR SHALL GUARANTEE ALL LANDSCAPE IMPROVEMENTS, INCLUDING SEEDING, FOR ONE FULL YEAR AS REQUIRED BY THE SPECIFICATIONS. CONTRACTOR MUST CONTACT THE OWNER AT LEAST 10 WORKING DAYS IN ADVANCE TO SCHEDULE ACCEPTANCE INSPECTION(S). CONTRACTOR MUST REPLACE ALL DEAD OR UNACCEPTABLE PLANTS DURING THE FOLLOWING RECOMMENDED PLANTING SEASON.
- THE SPECIFICATIONS FOR ALL WORK INCLUDED IN THIS CONTRACT SHALL BE FROM THE LANDSCAPE SPECIFICATION GUIDELINES BY THE LANDSCAPE CONTRACTORS ASSOCIATION MD-DC-VA (LCA), CURRENT EDITION, UNLESS OTHERWISE NOTED ON THESE PLANS.
- ANY PLANTING WHICH IS SHOWN ADJACENT TO CONDENSER UNITS SHALL BE PLANTED AS REQUIRED TO SCREEN THE UNITS. SHOULD THE CONDENSER UNITS BE INSTALLED IN LOCATIONS DIFFERENT FROM THOSE SHOWN ON THE PLAN IT WILL BE THE CONTRACTOR'S RESPONSIBILITY TO INSTALL THE MATERIALS AROUND THE CONDENSERS AND TO ADJUST OTHER ADJACENT PLANTING ACCORDINGLY.
- FOR INFORMATION REGARDING APPROPRIATE PLANTING PERIODS FOR DIFFERENT SPECIES, SEE THE LATEST EDITION OF THE LANDSCAPE SPECIFICATION GUIDELINES FROM THE LANDSCAPE CONTRACTORS ASSOCIATION OF MD-DC-VA PART 1-EXTERIOR LANDSCAPE INSTALLATION, SECTION 1.12 (A-G) AT WWW.LCAMDCCVA.ORG.

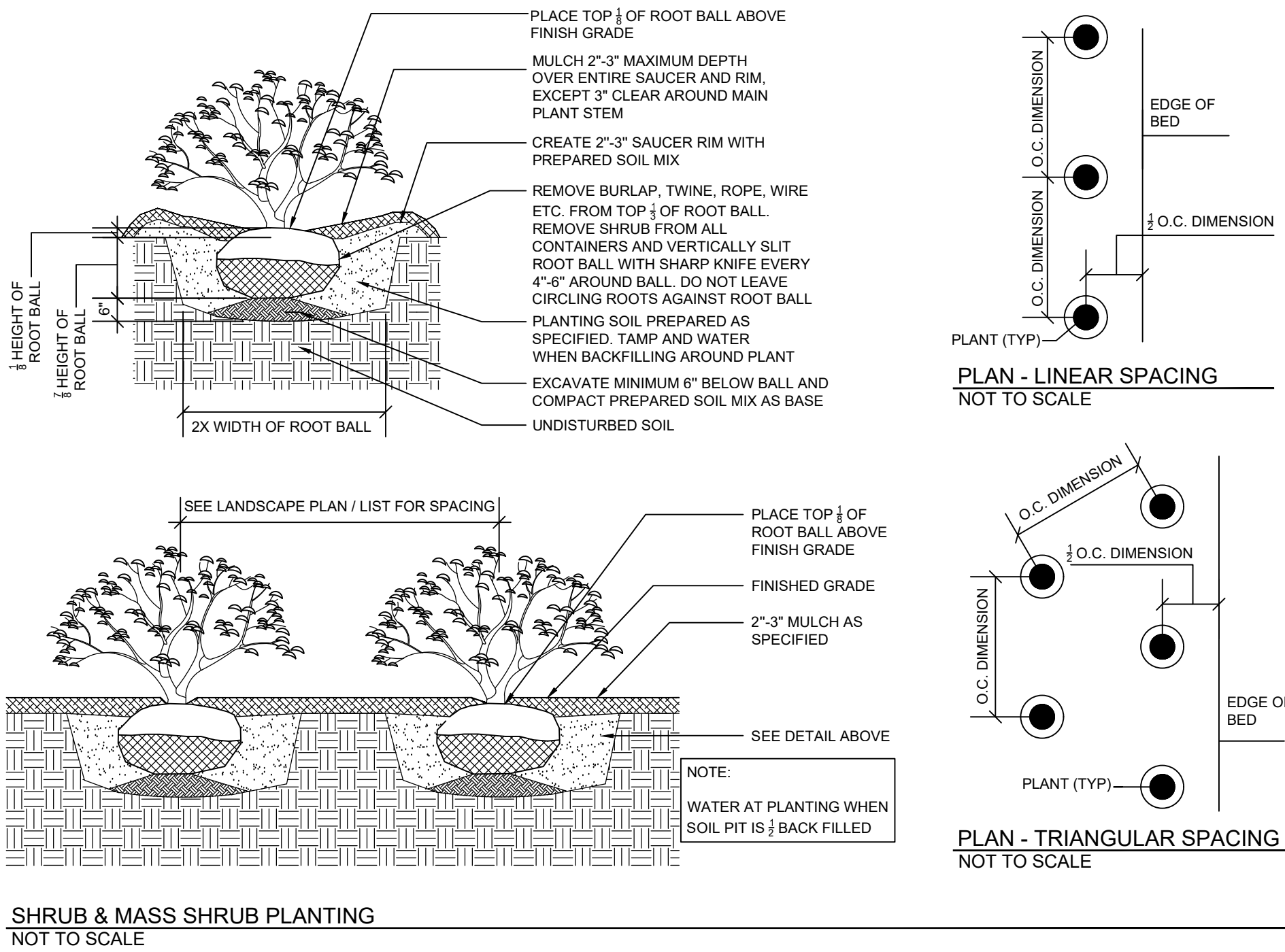
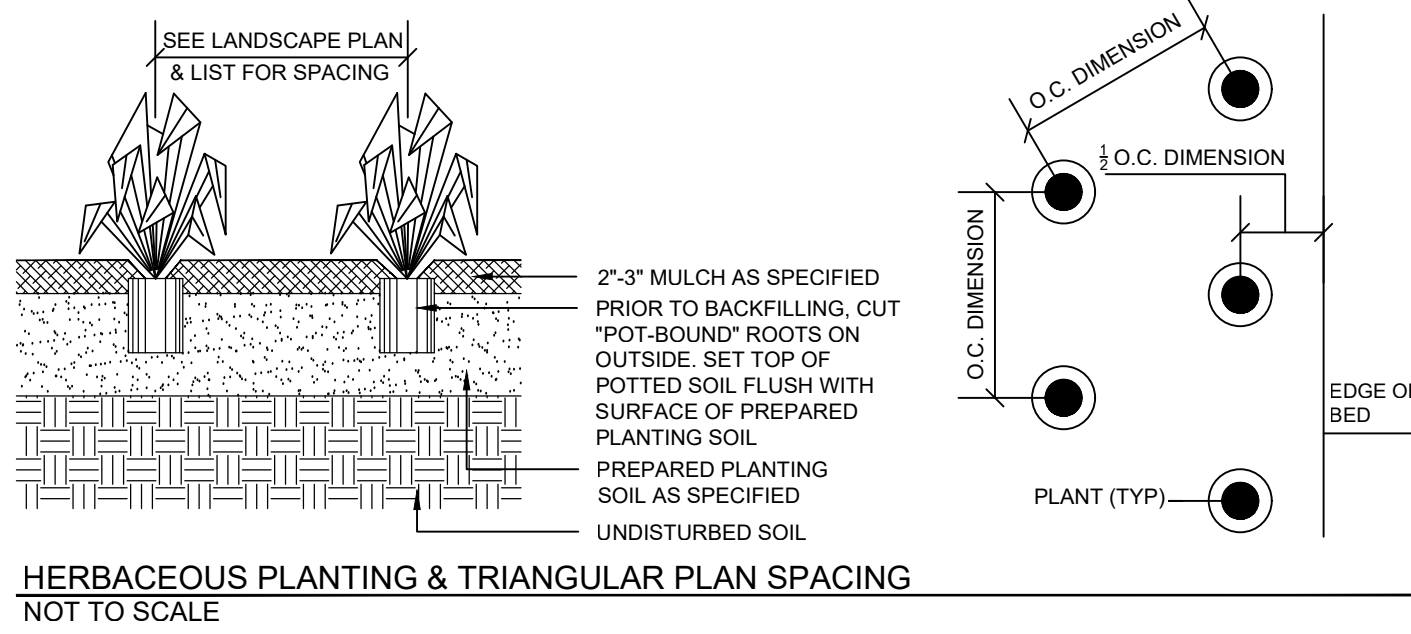
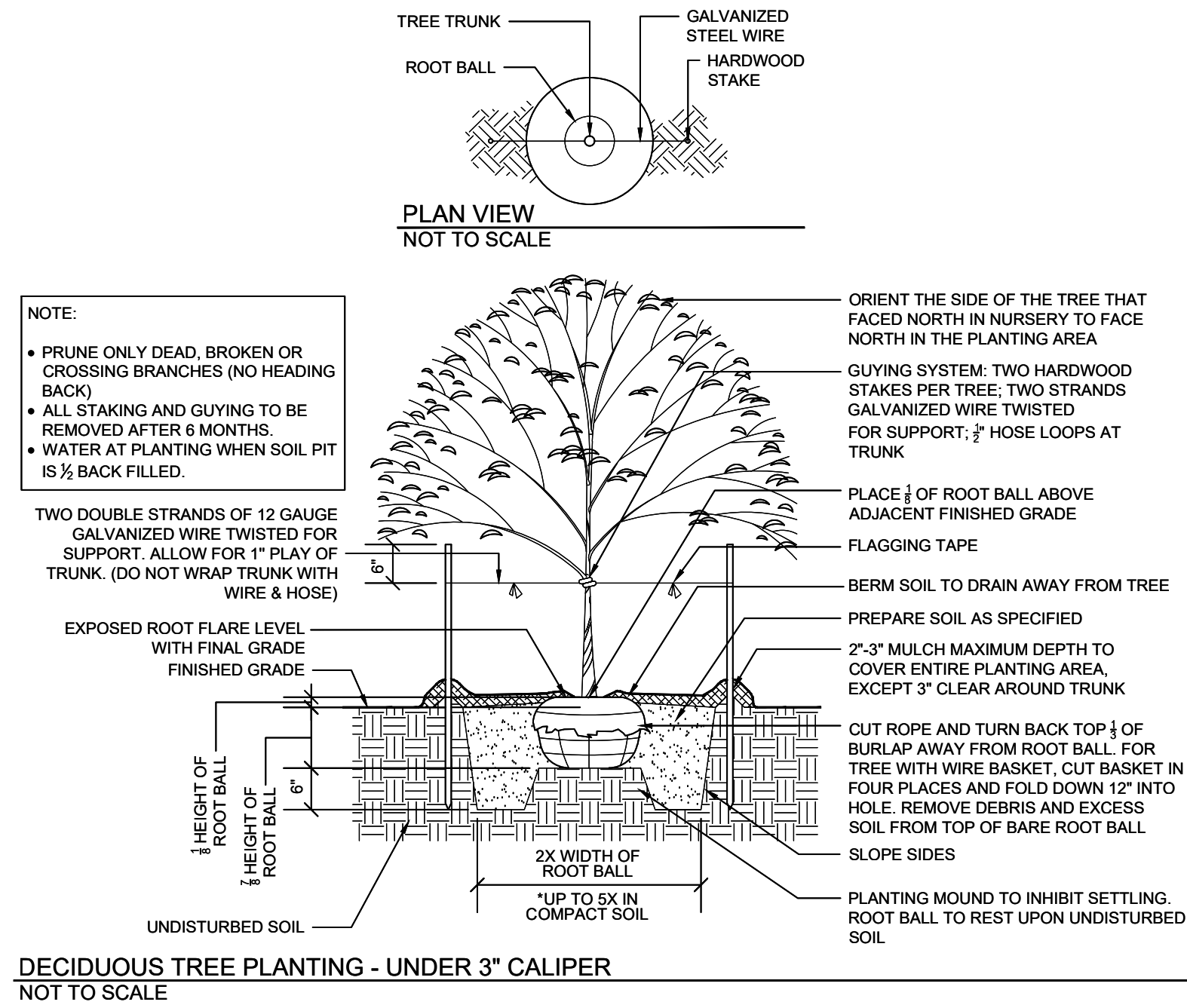

REVISIONS		
NO.	DESCRIPTION	DATE

TAX MAP JP61 WSC 211NE01

PARCEL: P328

13TH ELECTION DISTRICT
MONTGOMERY COUNTY
MARYLAND

HILLS & DALES

PROJ. MGR	TKH
DRAWN BY	MAS
SCALE	NTS
DATE	03.31.2025

LANDSCAPE PLAN

L2.02	
PROJECT NO.	19.155.12
SHEET NO.	2 OF 2