

E-FILE STAMP

LEGEND

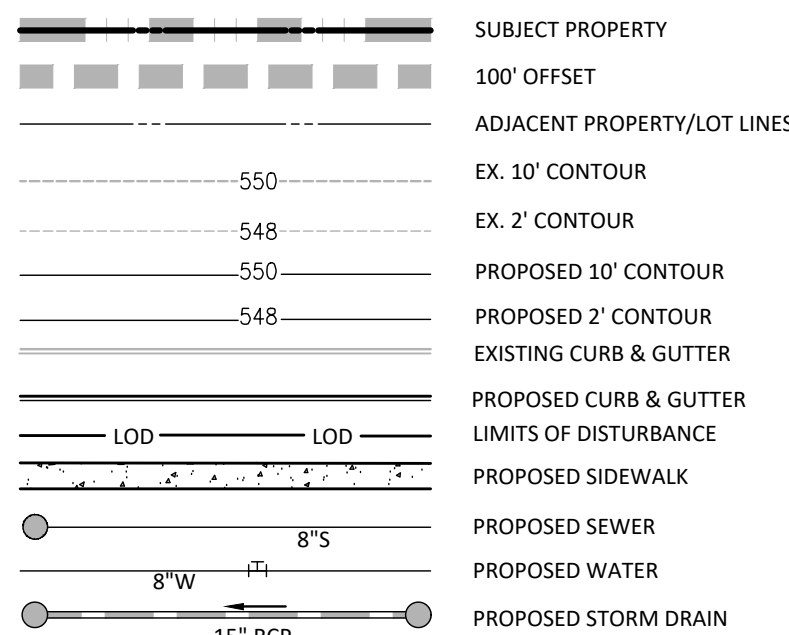

2UC
400

SOILS

PROPOSED BIORETENTION

SLOPES ≥ 15 - 25%

SLOPES ≥ 25%

EXISTING TREE CANOPY (NOT FOREST)

EXISTING TREE < 24" DBH

EXISTING TREE TO BE REMOVED
ROOT PRUNING TRENCH AT CONSTRUCTION
TREE PROTECTION FENCE W/ SIGNS; AT LOD,
SHOWN OFF-SET FOR CLARITY

TP-RP

EXISTING SPECIMEN TREE 30" OR GREATER
DBH W/CRZ SHOWN

EXISTING SIGNIFICANT TREE 24-29.9" DBH
W/CRZ SHOWN

PROPOSED MITIGATION TREE

EXISTING SPECIMEN TREE W/CRZ IMPACT
SHOWN FOR WHICH A TREE VARIANCE
REQUEST TO IMPACT OR REMOVE THE TREE
HAS BEEN SUBMITTED

SITE

VICINITY MAP
SCALE: 1" = 2000'

DESIGN CONSULTANTS:

ATTORNEY
WIRE GILL, LLP
HEATHER DUHOPOLSKY

ARCHITECT & LANDSCAPE ARCHITECT
HORD COPLAN MACHT
MIGUEL IRAOLA

ENVIRONMENTAL PLANNER
VIKA MARYLAND, LLC
JOSHUA SLOAN

TRAFFIC CONSULTANT
WELLS + ASSOCIATES
MICHAEL J. WORKOSKY

REVISIONS
DRC RESPONSE

DATE
10/21/24

PIKE CENTER
4TH ELECTION DISTRICT
MONTGOMERY COUNTY,
MARYLAND
WSSC GRID: 216NW06
TAX MAP: GQ63

PRELIMINARY
FOREST
CONSERVATION
PLAN

F20240990

PROFESSIONAL SEAL

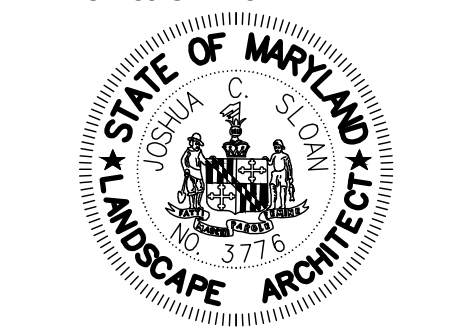

I HEREBY CERTIFY THAT THESE DOCUMENTS
WERE PREPARED OR APPROVED BY ME
AND THAT I AM A DULY LICENSED
REGISTERED LANDSCAPE ARCHITECT UNDER
THE LAWS OF THE STATE OF MARYLAND.
JOSHUA SLOAN LICENSE NO. 33718
EXPIRATION DATE: MAY 15, 2025

THE INFORMATION, DESIGN AND CONTENT OF THIS
DRAWING OR DOCUMENTS ARE PROPRIETARY TO VIKA
MARYLAND, LLC AND CONSTITUTE ITS PROPRIETARY
INTELLECTUAL PROPERTY. THESE DRAWINGS AND/OR
DOCUMENTS MUST NOT BE REPRODUCED, COPIED,
COPIED, DIGITALLY CONVERTED, MODIFIED OR USED
FOR ANY PURPOSE, IN ANY FORM, WITHOUT PRIOR
WRITTEN AUTHORIZATION FROM VIKA MARYLAND, LLC.
VIKA MARYLAND, LLC SHALL NOT BE RESPONSIBLE FOR
ANY REVISIONS OR CORRECTIONS TO THIS DRAWING
MAY BE UTILIZED FOR CONSTRUCTION PURPOSES.

© 2024 VIKA MARYLAND, LLC

DRAWN BY:
DESIGNED BY:
DATE ISSUED: 08/08/2024

VIKA
PROJECT VM50594B
DRAWING
NO. PFCP-003

SHEET NO.

"FOR LOCATION OF UTILITIES CALL
8-1-1 or 1-800-257-7777 OR LOG ON TO
www.call811.com or http://www.missutility.net
48 HOURS IN ADVANCE OF ANY
WORK IN THIS VICINITY"

The excavator must notify all public utility companies with underground
facilities in the area of proposed excavation and have those facilities
located by the utility companies prior to commencing excavation. The
excavator is responsible for compliance with requirements of Chapter
50A of the Montgomery County Code.

Exhibit 30a
H-155

SCALE: 1" = 30'

DEVELOPER'S CERTIFICATE

The undersigned agrees to execute all the features of the Approved
Preliminary Forest Conservation Plan No. F20240990, including financial
bonding, forest planning, maintenance, and all other applicable agreements,
as may be modified by the final forest conservation plan.

Developer's Name: KIMCO REALTY CORPORATION

Contact Person: ABBEY OKLAK

Address: 2080 YORK RD, SUITE 285, TIMONIAN, MD 21093

Phone and Email: 443-257-9589 AOLAK@KIMCOCREALTY.COM

Signature: _____ Date: _____