

COPY OF
PRELIMINARY FOREST CONSERVATION PLAN
NO. F20250680 (SHEET 3)
(SUBMITTED AUGUST 19, 2025)

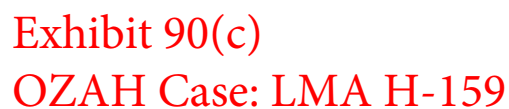

ENLARGEMENT 2

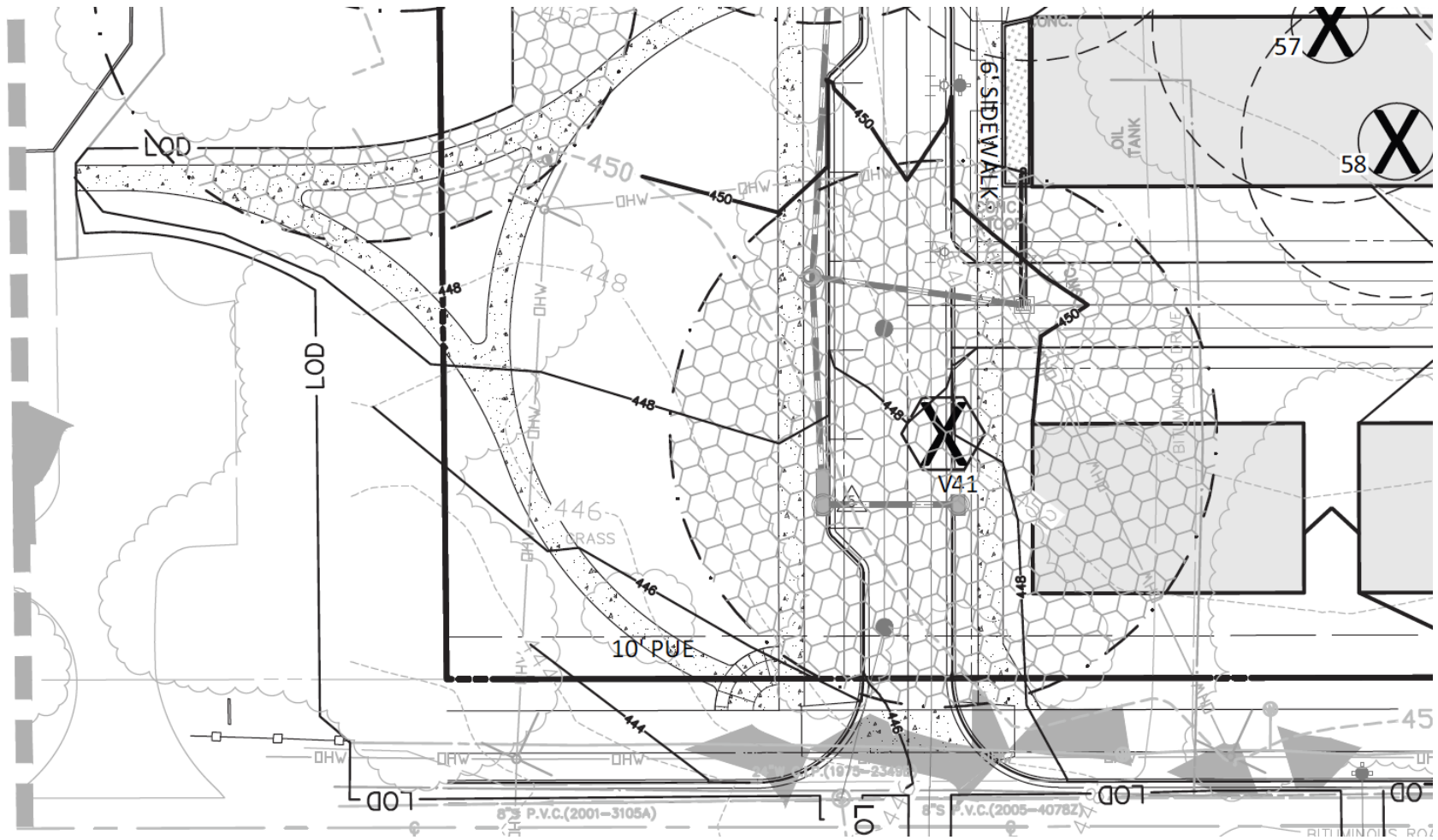

ENLARGEMENT 3



ENLARGEMENT 4

LEGEND

	SUBJECT PROPERTY
	100' OFFSET
	ADJACENT PROPERTY/LOT LINES
	EX. 10' CONTOUR
	EX. 2' CONTOUR
	PROPOSED 10' CONTOUR
	PROPOSED 2' CONTOUR
	EXISTING CURB & GUTTER
	PROPOSED CURB & GUTTER
	LIMITS OF DISTURBANCE
	PROPOSED SIDEWALK
	PROPOSED SEWER

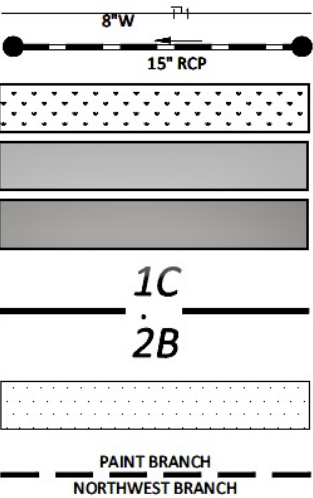

- PROPOSED WATER
- PROPOSED STORM DRAIN
- PROPOSED BIORETENTION
- SLOPES 15-24.9%
- SLOPES ≥ 25% ON HIGHLY ERODIBLE SOILS
- SOILS
- EXISTING FOREST (OFFSITE ONLY)
- WATERSHED BOUNDARY

EXISTING TREE CANOPY
(NOT FOREST)

X

EXISTING TREE TO
BE REMOVED

Attachm

ENLARGEMENT 5

#F20250680

PRELIMINARY FOREST CONSERVATION PLAN

PROFESSIONAL SEAL

I HEREBY CERTIFY THAT THESE DOCUMENTS WERE
PREPARED OR APPROVED BY ME, AND THAT I AM A DULY
LICENSED REGISTERED LANDSCAPE ARCHITECT UNDER THE
LAWS OF THE STATE OF MARYLAND.
CHANDA BEAUFORT, RLA LICENSE No. 3312
EXPIRATION DATE: SEPTEMBER 7, 2025

THE INFORMATION, DESIGN AND CONTENT OF THESE
DRAWINGS OR DOCUMENTS ARE PROPRIETARY TO VIKA
MARYLAND, LLC AND CONSTITUTE ITS PROPRIETARY
INTELLECTUAL PROPERTY. THESE DRAWINGS AND/OR
DOCUMENTS MUST NOT BE FORWARDED, SHARED,
COPIED, DIGITALLY CONVERTED, MODIFIED OR USED
FOR ANY PURPOSE, IN ANY FORMAT, WITHOUT PRIOR
WRITTEN AUTHORIZATION FROM VIKA MARYLAND, LLC.
VIOLATIONS MAY RESULT IN PROSECUTION. ONLY
APPROVED, SIGNED AND SEALED PLANS OR DRAWINGS
MAY BE UTILIZED FOR CONSTRUCTION PURPOSES.

© 2019 VIKA MARYLAND, LLC

DRAWN BY: RS

DESIGNED BY: CSB

DATE ISSUED: 05/01/2025

VIKA
PROJECT VM50728A

DRAWING
NO. FFCP 300

SHEET NO. 3 OF 3

Y:\50501-51000\CADD\PRELIMINARY\50728\50728100_P_PFCP.dwg ~ Tuesday, August 19, 2025 7:28:45 PM