

24

# River Road Study: Whites Ferry Rd to Elmer School Rd



River Road: Whites Ferry Road to Elmer School Road

Exceptional Rural Rustic Road

January 6, 2021

River Road is classified by Montgomery County Department of Transportation as an Exceptional Rustic Road for the segment that runs from Whites Ferry Road to Elmer School Road. The length of the gravel portion of this road is 19,132' long with an average width of 15.52'. This information was verified by placing stations every 200' for the length of the gravel portion of this road. At each station, nominal road width was measured and the information recorded on an offset stake. The road is as wide as 20' coming through the first turn from Whites Ferry Road although much of River Road maintain road widths right around 15'. The narrowest area measured was at station 76+00 where the road width was recorded at 13'.

There are eight culvert pipes that were marked and measured as a part of this survey. Six culverts were staked and two were memorialized on their asphalt abutments using spray paint. Seven of the culverts utilize Corrugated Metal Pipe (CMP) and one Pipe utilizes HDPE (N12). Culvert repair and replacement estimates have been prepared for all eight culvert locations to be replaced with Reinforced Concrete Pipe (RCP) for approximately \$115,000.00.

Each pipe has been surveyed and estimated individually with concurrence from the Contractor. Each location along with the replacement pipe size and estimated cost is below:

Station Number	New Pipe(s) to be Installed	Estimated Cost
11+68	24" RCP	\$13,310.00
58+66	2-36" RCP	\$25,472.00
84+25	24" RCP	\$13,215.00
105+62	24" RCP	\$11,500.00
139+49	2-18" RCP	\$10,546.00
164+45	2-24" RCP	\$18,528.00
171+95	24" RCP	\$12,126.00
188+75	15" RCP	\$9,782.00

The shoulders in the wooded portions of River Road are characterized by shallow drainage ditches and gravel embankments from previous grading operations. The other areas of the road are bordered closely by pasture and agricultural fields. Drainage improvements to ditch-lines and pipe cleaning, repair, and replacement should be analyzed and done prior to any structural improvements to the road to ensure longevity.

The repair strategy for this section of River Road includes full depth reclamation with the addition of Calcium Chloride. The estimates for this repair strategy are included within this report. Full depth reclamation will provide a 2 year service life and dust control so long as that area of the County is not subject to extended periods of drought. Full depth reclamation, with the addition of any needed field engineering/QC services and traffic control while the operation is in process, is projected to cost \$223,000.00.

The estimated costs of the associated construction activities is below:

<b>Construction Activity</b>	<b>Quantity</b>	<b>Unit</b>	<b>Extended Cost</b>
<b>MOT</b>	11UD	Unit Days	\$30,700.50
<b>6" Reclamation</b>	32,560SY	Square Yards	\$129,263.20
<b>Calcium Chloride</b>	32,560Gal/SY	Gallons/Square Yard	\$56,328.80
<b>Mobilization</b>	Each		\$6,400.00

If no reclamation or other surface treatments are performed, Montgomery County Division of Highway Services will continue bi-annual regrading and dust control application. The average annual expense for these operations is currently \$72,000.00 and could go up should road conditions deteriorate.

<b>Cost Center</b>	<b>Average Annual Cost</b>
<b>Equipment</b>	\$30,000.00
<b>Labor</b>	\$36,000.00
<b>Materials</b>	\$6,000.00

Photographs at the end of this report depict the current state of River Road and highlight a few of the common issues found along this segment of road that drainage repairs and road work would help to alleviate.

RIVER ROAD: WHITE'S FERRY ROAD TO ELMER SCHOOL ROAD

STATION NUMBER	ROAD WIDTH	COMMENTS	
0+00	20	~130' in from intersection with Whites Ferry, at 24445 River Rd.	
2+00	18		
4+00	16		
6+00	17		
8+00	18		
10+00	20		
<b>11+68</b>			<b>24" CMP Pipe 11+68 and 11+80 outfalls</b>
12+00	14		
14+00	14		
16+00	14		
18+00	14		
20+00	14		
22+00	14		
24+00	15		
26+00	15		
28+00	15		
30+00	16	<b>Center of Double 36" CMP Pipe</b>	
32+00	16		
34+00	14		
36+00	14		
38+00	15		
40+00	15		
42+00	15		
44+00	15		
46+00	15		
48+00	14		
50+00	15	Couldn't stake at 70+00, d/w on both sides at this station	
52+00	15		
54+00	14		
56+00	14		
58+00	15		
<b>58+66</b>			
60+00	15		
62+00	15		
64+00	15		
66+00	15		
68+00	15		
70+50	15	<b>24" CMP Pipe</b>	
72+00	15		
74+00	14		
76+00	13		
78+00	14		
80+00	14		
82+00	14		
84+00	15		
<b>84+25</b>			
86+00	14		
88+00	14		
90+00	15		
92+00	16		
94+00	15		
96+00	16		
98+00	15		
100+00	16		
102+00	16		
104+00	16		
<b>105+62</b>		<b>24" CMP Pipe, crushed on northern end-still flowing</b>	
106+00	16		

RIVER ROAD: WHITE'S FERRY ROAD TO ELMER SCHOOL ROAD

STATION NUMBER	ROAD WIDTH	COMMENTS
108+00	15	
110+00	16	
112+00	16	
114+00	16	
116+00	16	
118+00	16	
120+00	16	
122+00	16	
124+00	16	
126+00	16	
128+00	16	
130+00	16	
132+00	16	
134+00	16	
136+00	16	
138+00	16	
<b>139+49</b>		18" N12 Pipe stake at 139+59, landowner says needs reset lower, floods field
140+00	17	
142+00	17	
144+00	17	
146+00	17	
148+00	17	
150+00	17	
152+00	17	
154+00	17	
156+00	16	
158+00	15	
160+00	16	
162+00	16	
164+00	15	
<b>164+45</b>		Single to Double barrel CMP Pipe
166+00	15	
168+00	16	
170+00	16	
<b>171+95</b>		18" CMP Pipe, cant see outfall on south side of road
172+00	15	
174+00	15	
176+00	16	
178+00	15	
180+00	17	
182+00	16	
184+00	16	
186+00	17	
188+00	14	
<b>188+75</b>		12" CMP Pipe, stake at 188+80
190+00	15	
191+32	15	End of Gravel ~80' from intersection of Elmer School Rd and River Rd East

<b>Average Road Width</b>	<b>15.52</b>
---------------------------	--------------

# RIVER ROAD EXISTING CULVERT STRUCTURES



11+68 and 11+80  
24" CMP PIPE

7 6 5

58+66 Double 36"  
CMP PIPE

1

84+25  
24" CMP PIPE

2

105+62  
24" CMP PIPE

4

139+49  
18" N12

3

164+45  
Single to Double  
CMP PIPE

8

188+75  
15" CMP PIPE

171+95  
18" CMP PIPE

Potomac

Photos of River Road= #

# RIVER ROAD PROPOSED CULVERT STRUCTURES

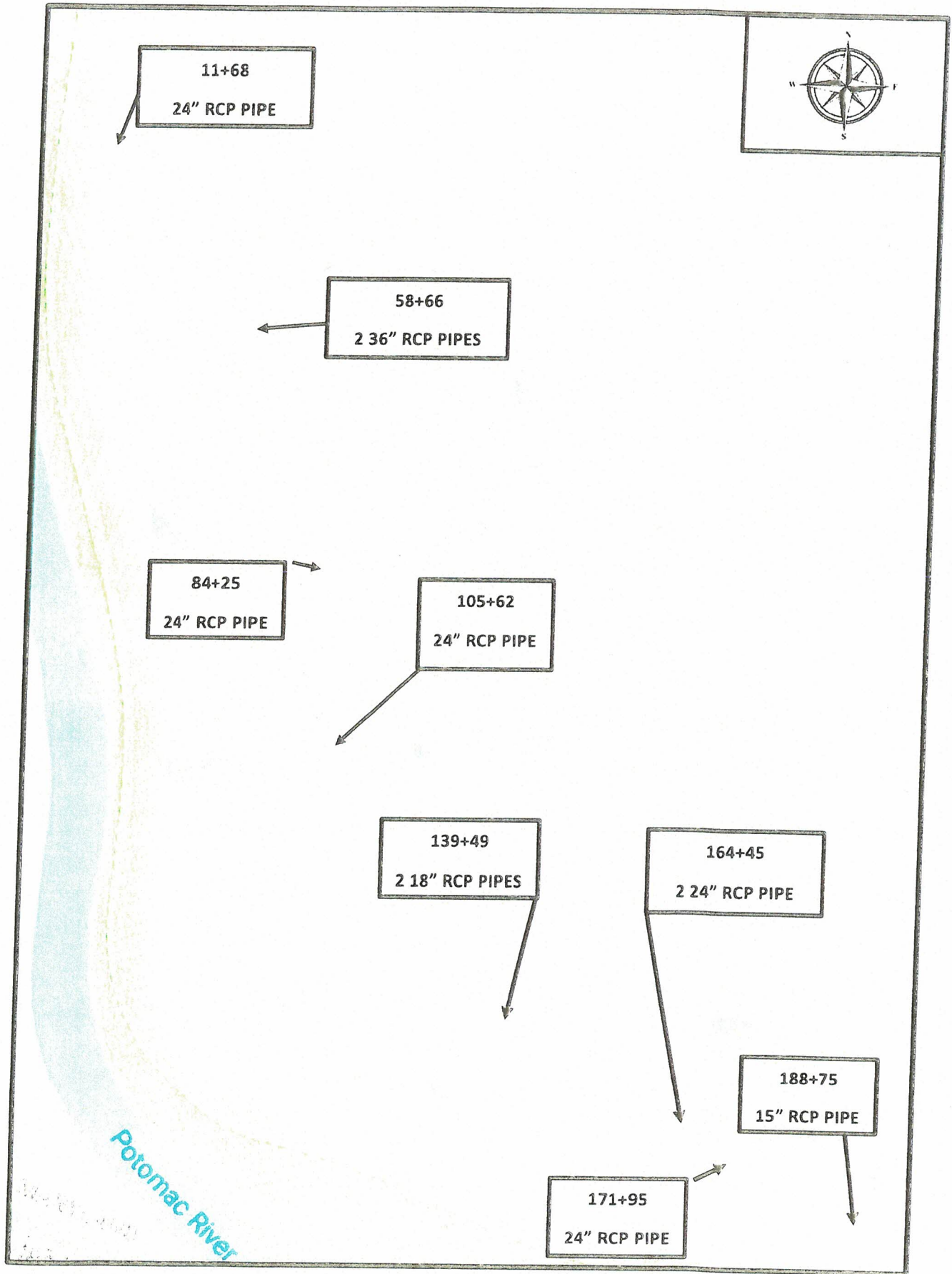



Picture 1: 60400



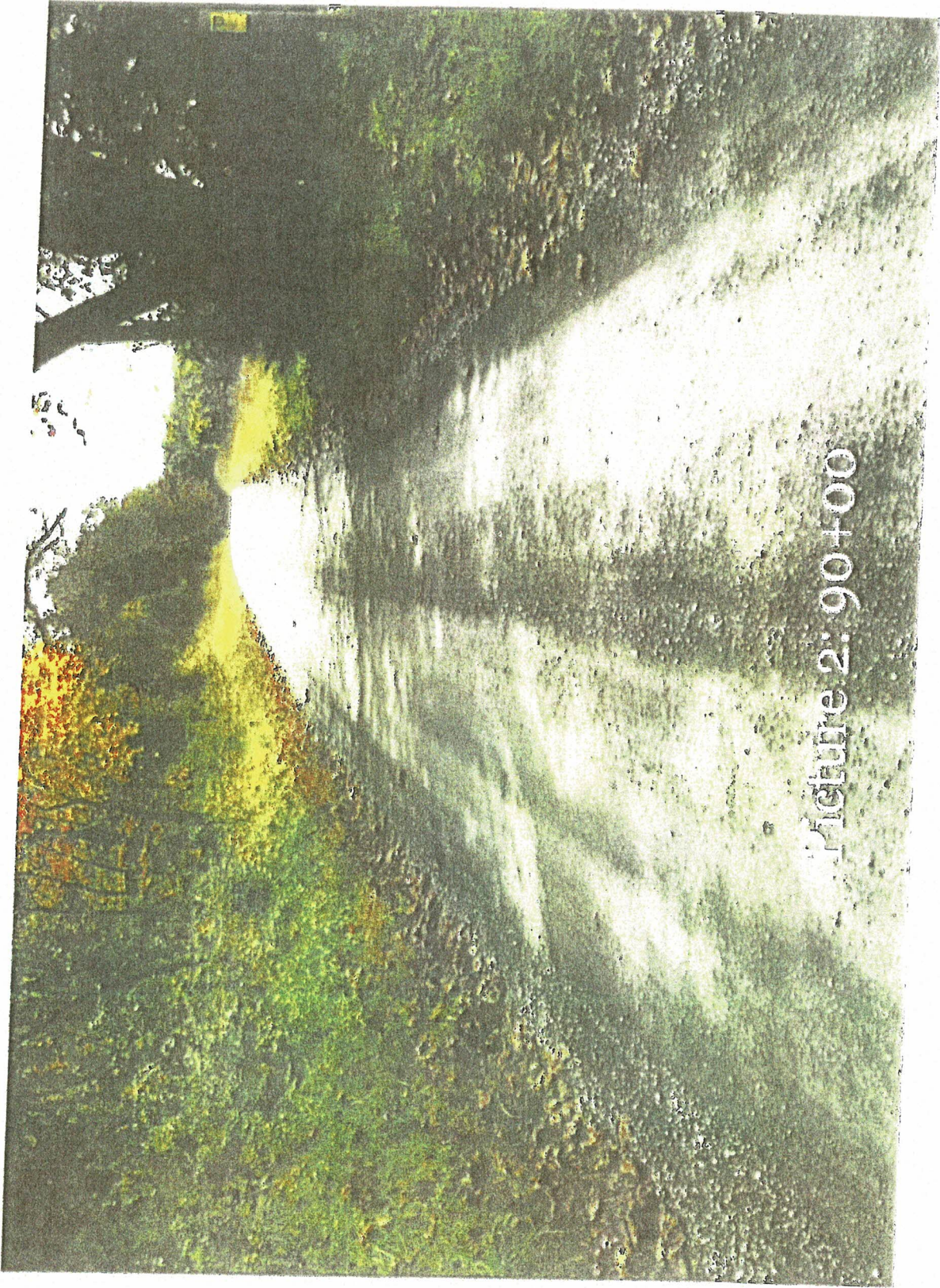



Picture 3:120+00





21168-40719-0





Picture 7 16150



Picture 8:152+00

Fruits & Vegetables by  
Lewis Orchards, LLC  
18901 Peach Tree Rd  
Dickerson, MD 20842  
301-349-4101

June 6, 2019

Montgomery County Executive Marc Elrich  
Executive Office Building  
101 Monroe Street, 2<sup>nd</sup> Floor  
Rockville, MD 20850

Dear Mr. Elrich,

On April 15, 2019, the Montgomery County Farm Bureau sent you a letter expressing concerns about the economically damaging and physically dangerous road conditions along the unpaved portion of River Road. These concerns are shared by at least 19 citizens whose homes and businesses are located along this stretch of road. Lewis Orchards shares these concerns and we are disheartened that your administration has made no action to meet with residents or look into the feasibility of addressing this issue.

Lewis Orchards farms 400 acres along the unpaved portion of River Road, including a mile of road frontage. This represents 10% of the land farmed by our family. Pumpkins grown on the land within about 100 feet of the road (approximately 27 acres!) are a total loss to us because road dust coats surfaces and renders the pumpkins unsalable. The cost associated with manually cleaning them is in excess of the profits we could make from selling them. This represents an economically untenable situation in a County where land prices are high and farm income remains marginally thin.

In addition to our financial losses, we have serious reservations about the safety of operating our farm equipment along River Road. Farm equipment is large and requires caution when driving to and from fields on roads that are paved and have clear visibility. In contrast to these challenging but ideal conditions, the dust generated by the simple passage of a passenger car on River Road can be enough to obstruct visibility for several minutes. This is not safe for our family, our employees, or other drivers.



The intent of the Agricultural Reserve is to promote agriculture as the primary land use. Chapter 48, Article 8 of the County Code, "Rustic Roads Program, Maintenance and Improvements", clearly states that a road's designation as "rustic" or "exceptionally rustic" does not preclude improvements to that road that promote safety and the movement of farm equipment. It is therefore clear to us that improvements to River Road that support the viability of agriculture, the movement of necessary farm equipment, and public safety are in no way incompatible with the intent of the Ag Reserve or the Rustic Roads Program. Any continued delays to address this issue put all those things at risk.

I would like to reissue the invitation first put forward by the Montgomery County Farm Bureau to meet with River Road residents at our Lewis Orchard farm market to discuss options for addressing our concerns. Thank you in advance for taking the time to consider the perspective of County residents who, on a daily basis, are personally affected by the reality of conditions along the unpaved portion of River Road. We look forward to working with you and your staff to arrange a mutually convenient meeting time.

Sincerely,

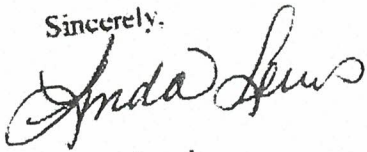

Linda Lewis  
Fruits & Vegetables by  
Lewis Orchards, LLC  
T/A Lewis Orchards

Cc: Andrew Friedson, County Council Member  
Craig Rice, County Council Member  
Michele Cropp, President of Montgomery County Farm Bureau  
Catherine Mathews, Director Upcounty Regional Office  
Jeremy Criss, Office of Agriculture