

## Cattail Road Bridge No. M-0491 Replacement Project

### PUBLIC INFORMATION MEETING March 10, 2025



East Approach  
(looking west) 2024-08-19



Cattail Road Bridge  
M-0491 2024-08-19



West Approach  
(looking east) 2024-08-19

This meeting will be recorded.



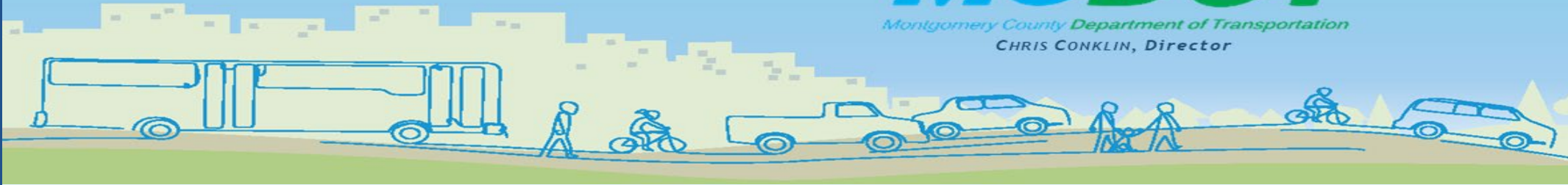

## Cattail Road Bridge No. M-0491 Replacement Project

### PUBLIC INFORMATION MEETING March 10, 2025



East Approach  
(looking west) 2024-08-19



Cattail Road Bridge  
M-0491 2024-08-19



West Approach  
(looking east) 2024-08-19

This meeting is being recorded.

# CATTAIL ROAD BRIDGE NO. M-0491 REPLACEMENT PROJECT

## Zoom Meeting Controls

- All microphones have been muted and cameras turned off.
- **To reduce the bandwidth of tonight's meeting, please do not turn on your video camera.**
- Following tonight's presentation, you will have the opportunity to provide testimony. There will also be a Question-and-Answer session after the testimony portion if time allows. **Please wait until the presentation ends to raise your hand to testify or ask a question.** Alternatively, you may type your question into the chat box any time during tonight's hearing.
- **To raise your hand** following the presentation, please click on the "Reactions" icon at the bottom of your screen, and then click "Raise Hand."
- **If you called into tonight's meeting via telephone, press \*9 to raise your hand and \*6 to unmute yourself.**

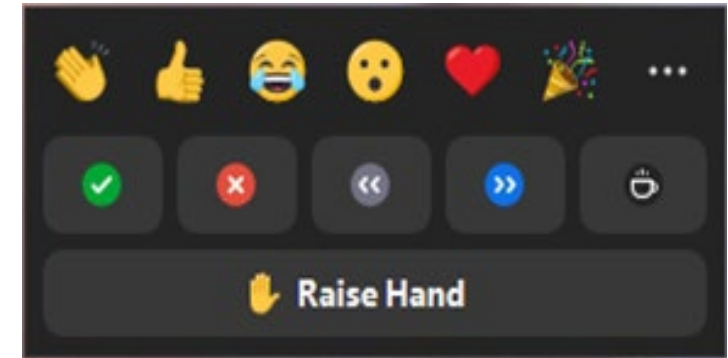

# PURPOSE OF PUBLIC MEETING

- ◆ Introduce project team
- ◆ Present the existing bridge and conditions
- ◆ Present project scope and proposed bridge
- ◆ Present maintenance of traffic during construction
- ◆ Present current project cost estimates, funding and schedule
- ◆ Answer questions and accept feedback





# PROJECT TEAM

## ◆Montgomery County Department of Transportation (MCDOT)

- ❖Brian Copley, P.E. Bridge Unit Manager
- ❖Rashid Abramov, P.E. Capital Projects Manager
- ❖Michelle Haley Contracts Unit Chief
- ❖Doug Baker Utility Coordinator
- ❖Stella Igbinedion Work Zone Program Manager

## ◆M-NCPPC Montgomery Planning

- ❖Sofia Aldrich Transportation Master Planner

## ◆Rustic Roads Advisory Committee

- ❖Chris Van Alstyne Staff Coordinator

## ◆Mercado Consultants, Inc.

- ❖Michael Mercado, P.E. Project Manager



# CATTAIL ROAD BRIDGE NUMBER M-0491 REPLACEMENT PROJECT

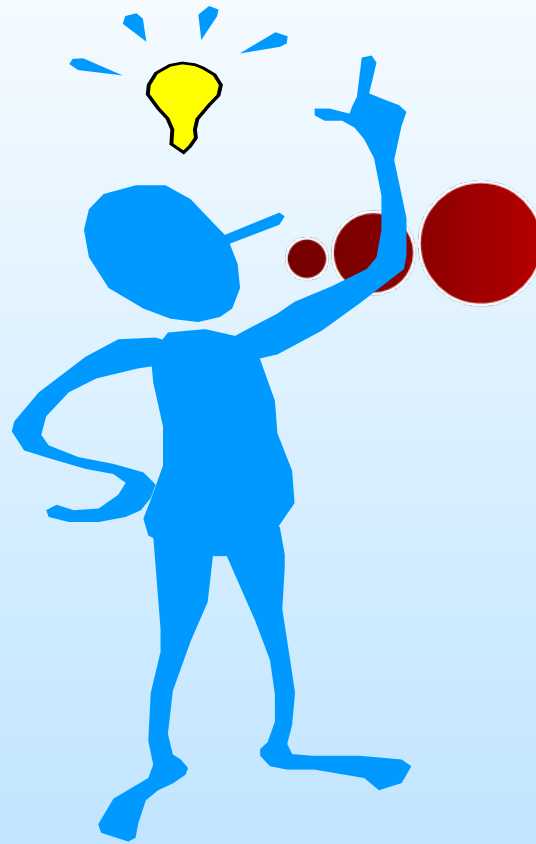

***PLEASE HOLD  
YOUR QUESTIONS  
UNTIL  
THE END***



# PROJECT LOCATION



# LOCAL MASTER PLANS & TRAFFIC DATA

- ◆ **1996 Rustic Roads Functional Master Plan:**
  - ❖ **Rustic Road**
  - ❖ **Improvements limited to maintenance and upkeep**
  - ❖ **Rustic Roads Advisory Committee reviews construction plans**
  
- ◆ **Normal Speed Limit:**
  - ❖ **30 MPH**
  
- ◆ **2024 Traffic Count:**
  - ❖ **Approximately 2686 vehicles/day**





# EXISTING BRIDGE

- ◆ Built in 1975
- ◆ Reinforced Concrete Arch
- ◆ 8'-4" Total Bridge Length (span)
- ◆ 22'-7" Out-to-Out Width & 20'-0" Clear roadway for two-way traffic
- ◆ W-beam railing on both sides



Elevation View (looking south)



Elevation View (looking north)

# EXISTING BRIDGE – A CLOSER LOOK



Intermittent Longitudinal Cracks along the  
Centerline of the Road



General View of the Arch Underside  
(Looking South)



# DETERIORATION OF EXISTING BRIDGE

## 1. Inside of the Concrete Arch

- ❖ Loss of Concrete
- ❖ Concrete Cracks at the top of the Arch



Arch Underside, North End, At the East Abutment Stem, Spalling in the Arch



Arch Underside, North End, Diagonal Crack with Vertical Displacement at Midspan (Looking South)



# DETERIORATION OF EXISTING BRIDGE

## 2. Inside of the Concrete Arch

- ❖ Spalling Concrete
- ❖ Concrete Fracture



East Abutment Stem,  
Spalling at the Southeast Joint



East Abutment Stem,  
Spalling at the Northeast Joint



West Abutment Stem - Arch Centerline,  
Fracture with Vertical Displacement  
(Looking West)

# PROJECT SCOPE

- ◆ Replace the entire arch structure with reinforced concrete box culvert
  - ◆ 3 cell box culvert
- ◆ Raise the elevation of the roadway by 6 inches
  - ◆ To minimize flooding of roadway during storm events
- ◆ Stabilize stream upstream / downstream of bridge
  - ◆ Riprap stone
- ◆ New asphalt paving for bridge and approaches
  - ◆ Full pavement replacement adjacent to bridge
  - ◆ Mill and overlay roadway approaches



Example of Riprap Slope Protection

# PROPOSED BRIDGE

- ◆ Material: Reinforced Concrete Box Culvert
- ◆ Bridge Length (total) 23'-6"
- ◆ Bridge Length (span): 22'-2" (13'-10" longer)

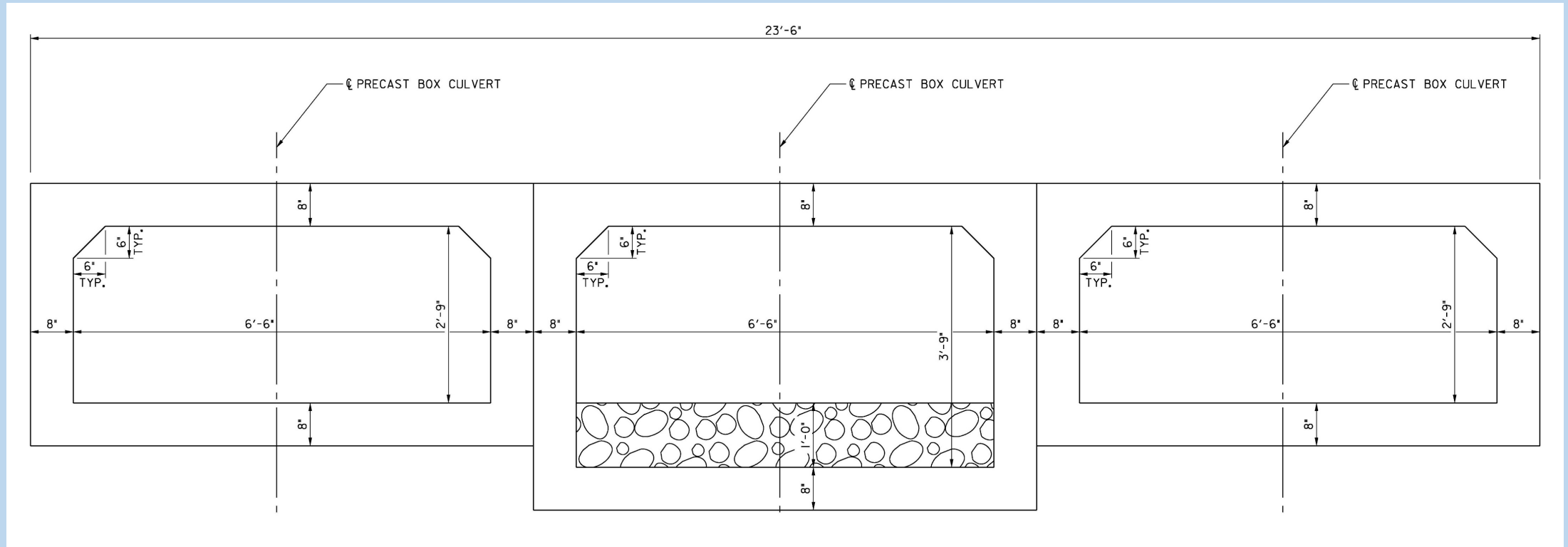

Side View Cross Section of Proposed Bridge



# PROPOSED BRIDGE

- ◆ Out to Out Width: 25'-6" (2'-11" wider)
- ◆ Clear Roadway Width: 20'-8" (8" wider)
- ◆ Safety: Single Face W-Beam Barrier & Approach Guardrail

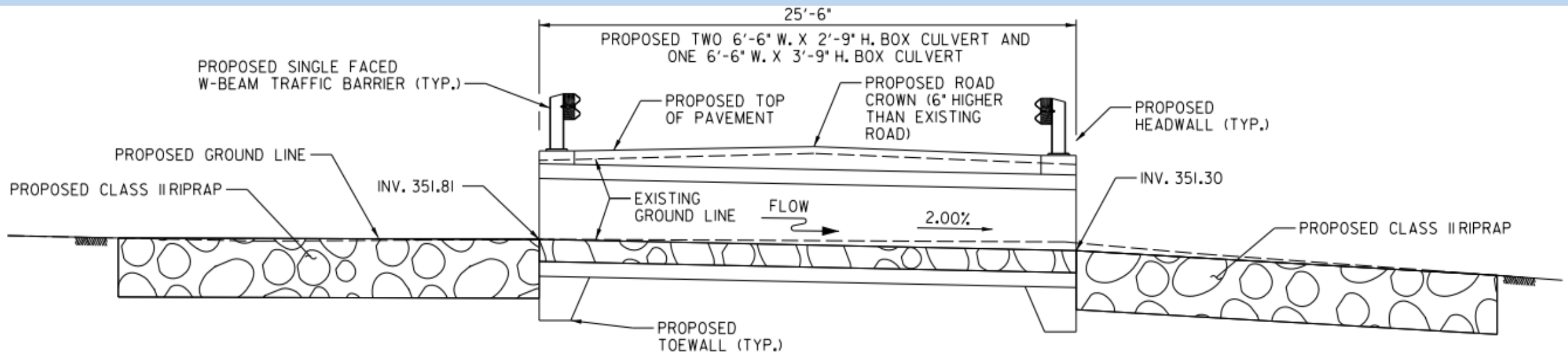

Bridge – Typical Cross Section

# EXISTING ROADWAY ON BRIDGE



Looking East



# PROPOSED BRIDGE

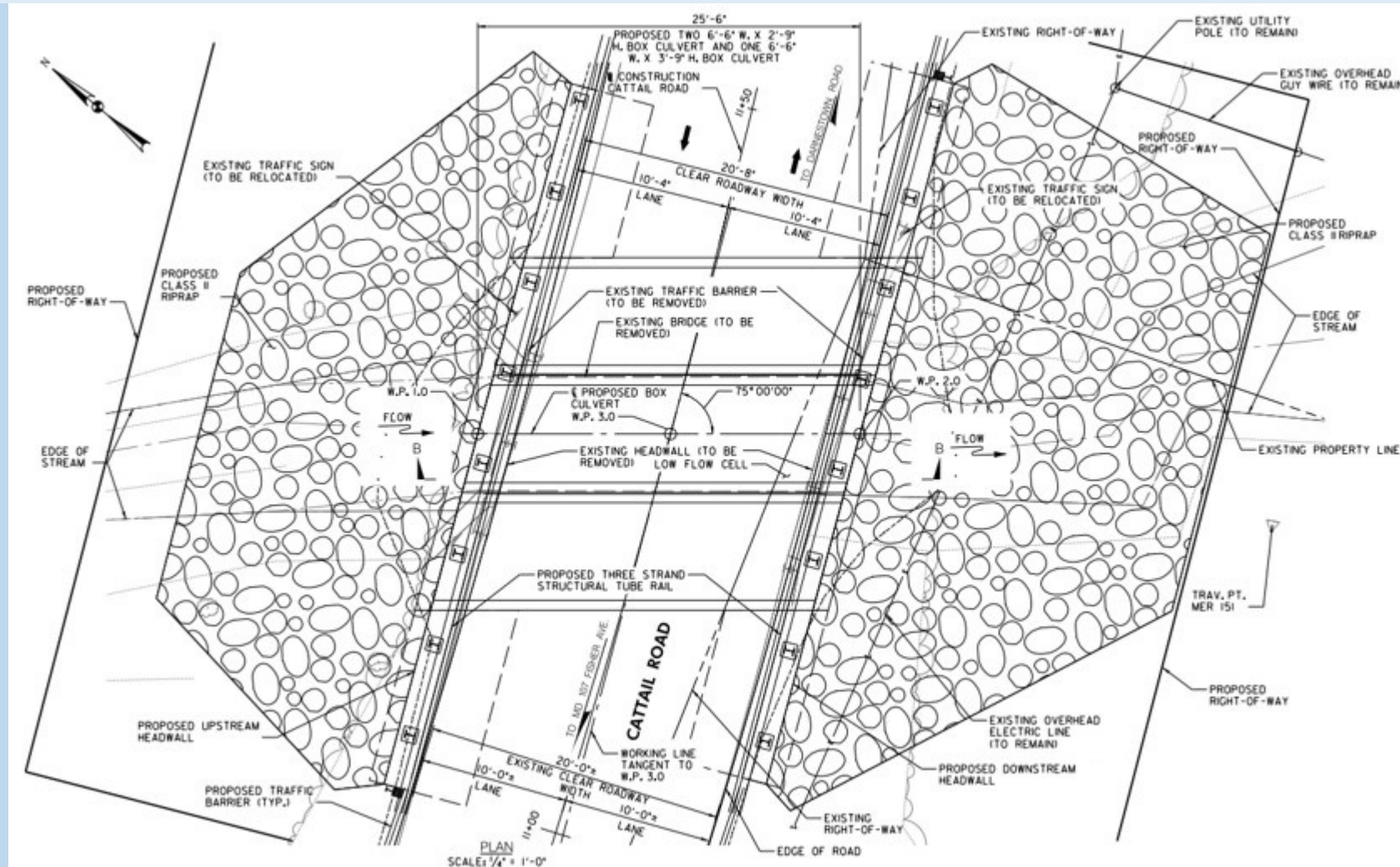

Plan View



# MAINTENANCE OF TRAFFIC DURING CONSTRUCTION

## Planned Detour

**DETOUR PLAN SKETCH**  
(about 4.8 miles)

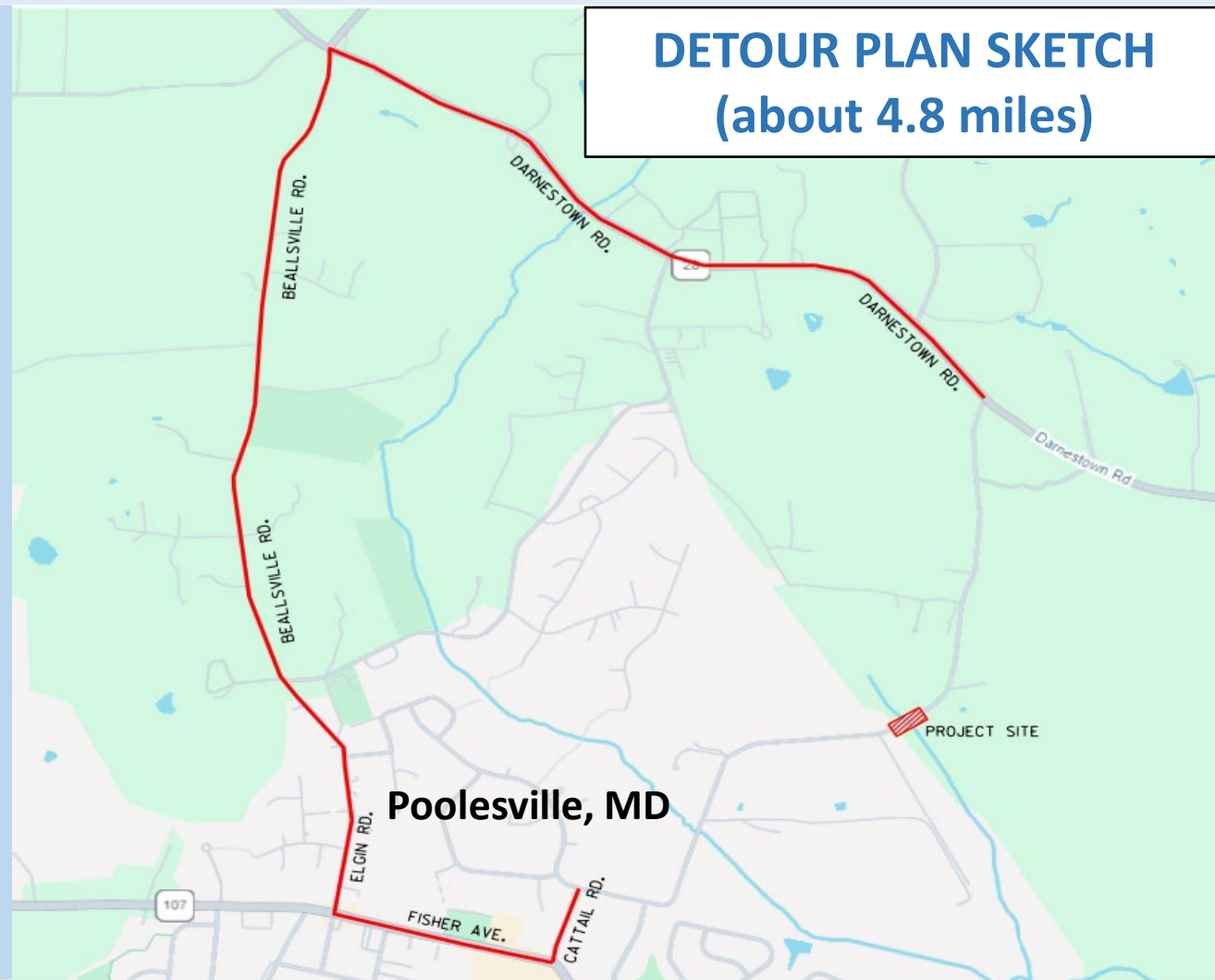

**Darnestown Road (MD 28)**



**Beallsville Road**



**Elgin Road**



**Fisher Ave.**



**Cattail Road**

**MC DOT**

Montgomery County Department of Transportation  
[www.montgomerycountymd.gov/mcdot](http://www.montgomerycountymd.gov/mcdot)



# PROJECT STATUS, FUNDING, COSTS & SCHEDULE

## Project Status:

- ❖ Preliminary Design Stage (30% Level of Completion)

## Project Funding

- ❖ Montgomery County 100%

## Project Costs

- |             |                             |              |
|-------------|-----------------------------|--------------|
| ❖ \$226,000 | Engineering Cost            | (Funded)     |
| ❖ \$1.0M    | Estimated Cost to Construct | (CIP 509753) |

## Project Schedule (tentative)

- |                      |             |
|----------------------|-------------|
| ❖ Design Complete    | Winter 2026 |
| ❖ Begin Construction | Fall 2026   |
| ❖ End Construction   | Fall 2026   |

# NEXT STEPS & COMMUNITY INPUT

## Proceed to Final Design based on comments from permitting agencies:

- ❖ Maryland Department of Environment and U.S. Army Corps of Engineers
- ❖ Maryland-National Capital Park and Planning Commission
- ❖ Montgomery County Rustic Roads Advisory Committee
- ❖ Montgomery County Department of Permitting Services
- ❖ Montgomery County Department of Transportation

## Feedback from the community through **Friday, April 11, 2025**, by:

- ❖ Tonight's Feedback
- ❖ Online Comment on Project Website
- ❖ Email to Project Manager, [Rashid.Abramov@montgomerycountymd.gov](mailto:Rashid.Abramov@montgomerycountymd.gov)

## For Project Information Contact MCDOT's Project Manager:

Rashid Abramov, P.E.

240-777-7207, [Rashid.Abramov@montgomerycountymd.gov](mailto:Rashid.Abramov@montgomerycountymd.gov)

## MCDOT's Project Webpage:

<https://www.montgomerycountymd.gov/dot-dte/projects/Cattail-Rd-Bridge/index.html>





# Comments & Questions?



To Provide Comments or ask a Question . . .

- **Raise your hand by clicking “Reactions” icon** at the bottom of your screen and then click **“raise hand.”**
- **If you dialed in by telephone** this evening, press **\*9** on your telephone keypad to raise your hand. When asked to unmute, press **\*6**.
- Type your question into the chat. If time does not allow for all questions to be answered during this evening’s meeting, all questions in the chat will be answered via email in the coming days.



# CATTAIL ROAD BRIDGE NO. M-0491 REPLACEMENT PROJECT

## THANK YOU FOR ATTENDING

The Project Record will remain open for four weeks to allow any person an opportunity to have their feedback considered.

**Official Closing Date for Submitting Your Feedback**

**Friday, April 11, 2025  
at 5:00 p.m.**

Submissions may be made via:

Email to the Project Manager, Rashid Abramov:

**[Rashid.Abramov@montgomerycountymd.gov](mailto:Rashid.Abramov@montgomerycountymd.gov)**

Or Via the Online Comment Form on the Project Webpage:

**<https://www.montgomerycountymd.gov/dot-dte/projects/Cattail-Rd-Bridge/index.html>**

