

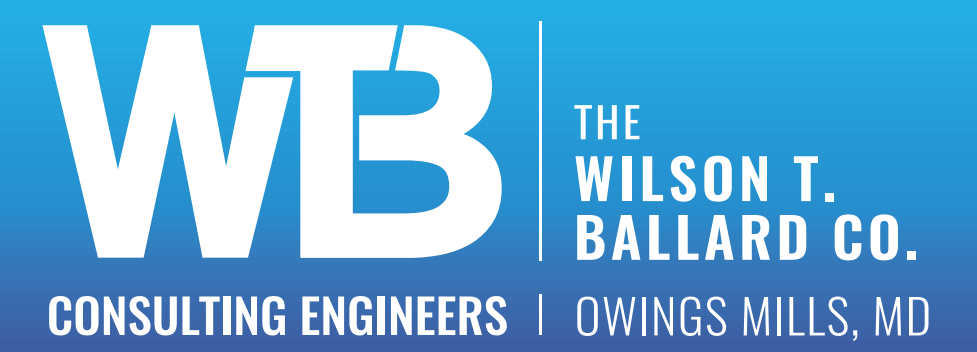

# REPLACEMENT OF BRIDGE No. M-0352 GARRETT PARK ROAD BRIDGE OVER ROCK CREEK



**EXISTING APPROACH**



**PROPOSED APPROACH**



# REPLACEMENT OF BRIDGE No. M-0352 GARRETT PARK ROAD BRIDGE OVER ROCK CREEK

**WTB**  
THE WILSON T. BALLARD CO.  
CONSULTING ENGINEERS | OWINGS MILLS, MD



**EXISTING ELEVATION**



**PROPOSED ELEVATION**



# REPLACEMENT OF BRIDGE No. M-0352 GARRETT PARK ROAD BRIDGE OVER ROCK CREEK

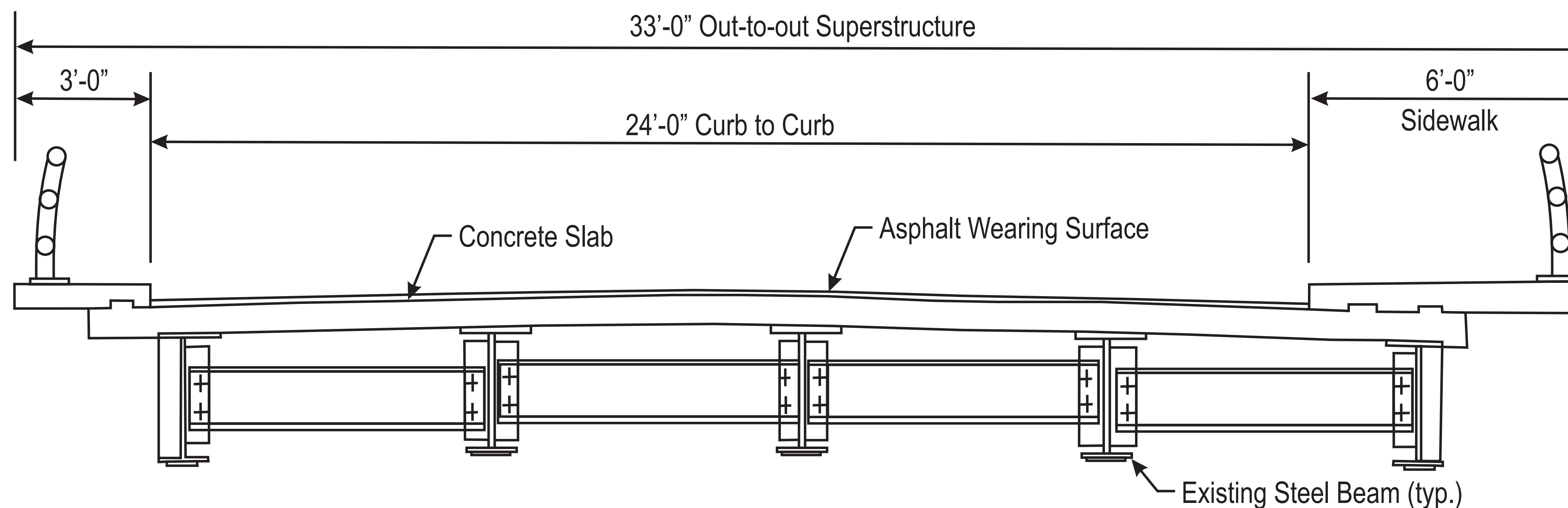

**EXISTING PLAN - TYPICAL SECTION - LOOKING WEST**

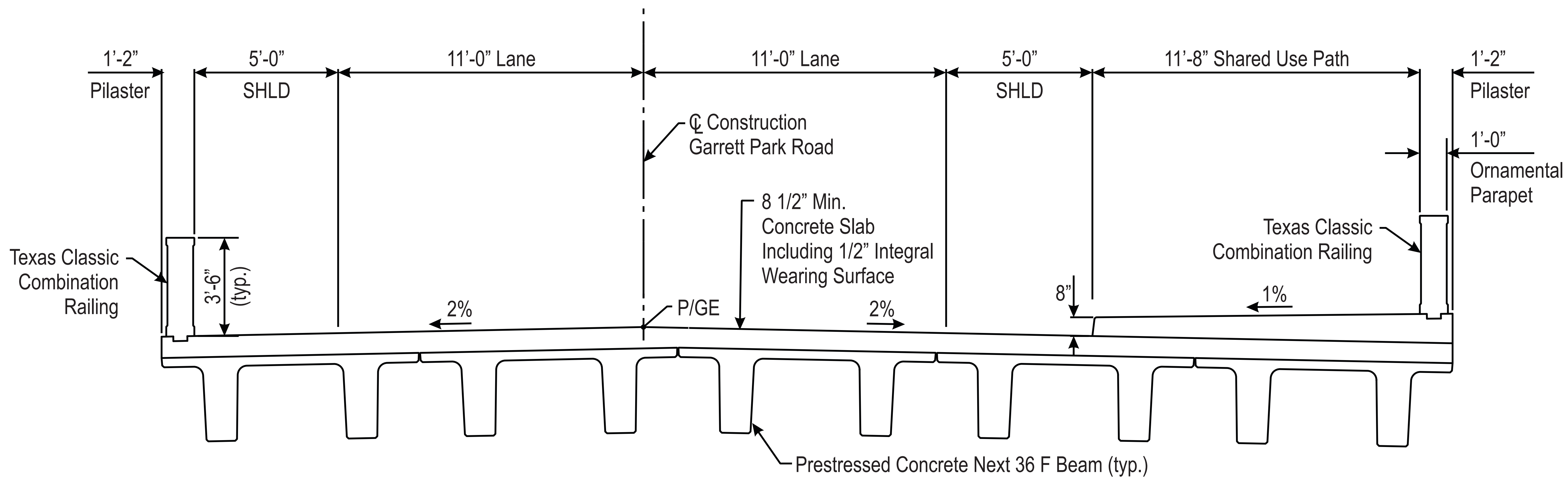

**PROPOSED PLAN - TYPICAL SECTION - LOOKING WEST**



# REPLACEMENT OF BRIDGE No. M-0352 GARRETT PARK ROAD BRIDGE OVER ROCK CREEK



*Steel corrosion and delamination*



*Pier column spalling*



*Pier column cracking*



*Wearing surface spalls and patching*



*Timber blocking repairs*



*Pier bearing pedestal spalls*



# REPLACEMENT OF BRIDGE No. M-0352 GARRETT PARK ROAD BRIDGE OVER ROCK CREEK

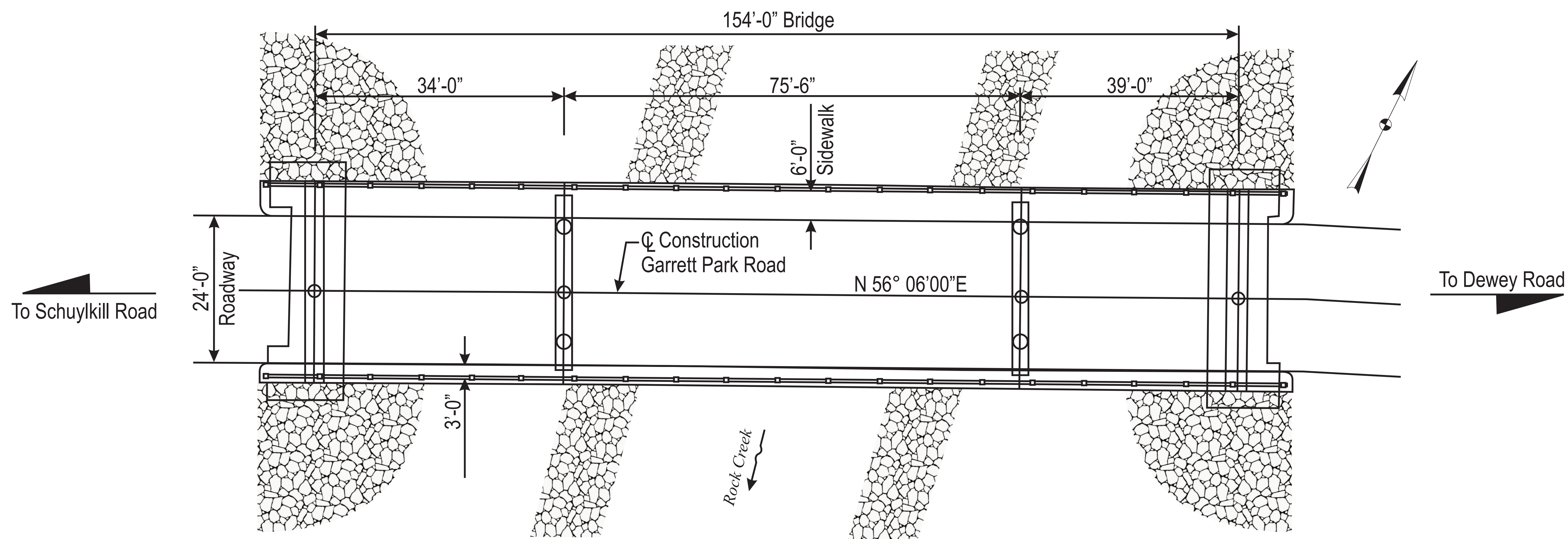

**EXISTING PLAN**

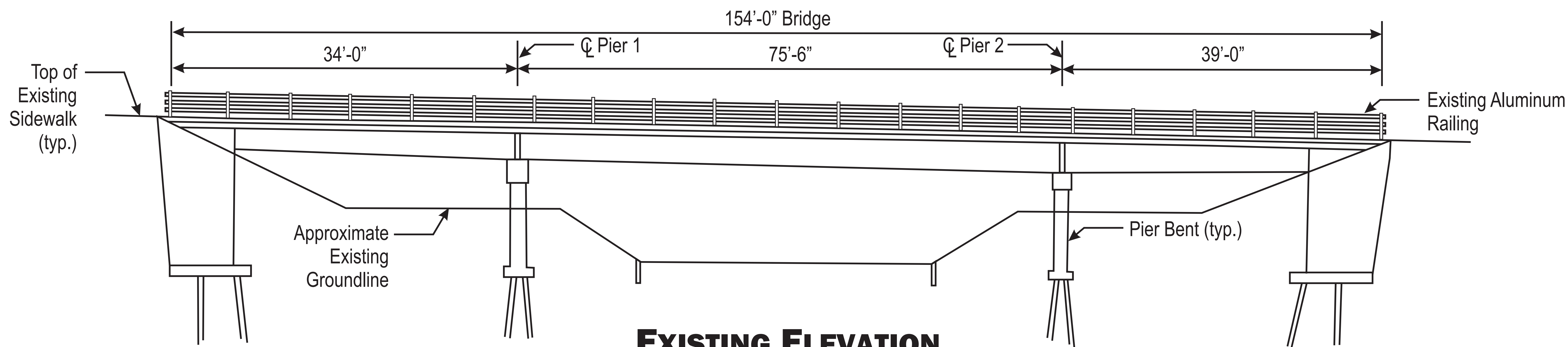

**EXISTING ELEVATION**



# REPLACEMENT OF BRIDGE No. M-0352 GARRETT PARK ROAD BRIDGE OVER ROCK CREEK

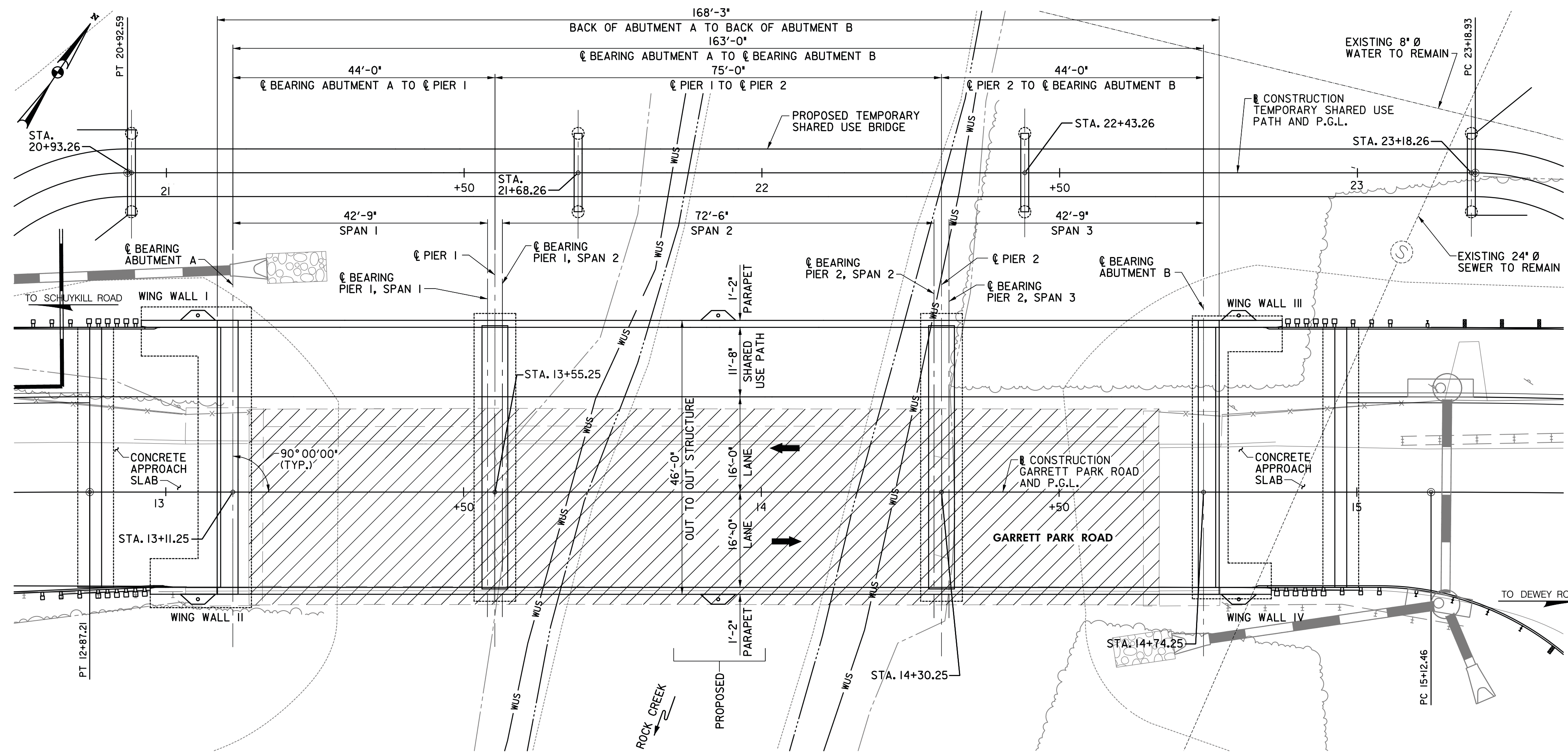

**PROPOSED PLAN**

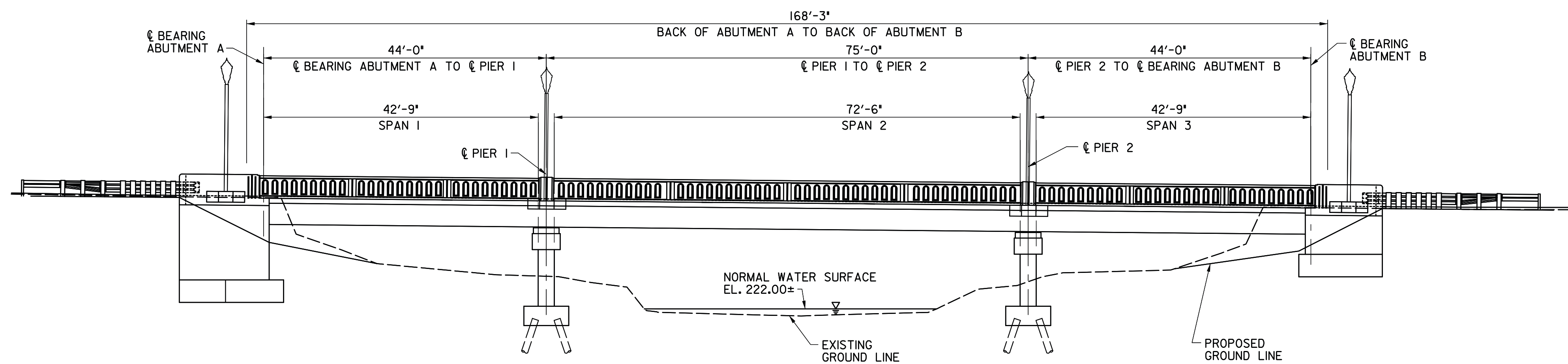

**PROPOSED ELEVATION**



# REPLACEMENT OF BRIDGE No. M-0352 GARRETT PARK ROAD BRIDGE OVER ROCK CREEK

**WB**  
THE WILSON T. BALLARD CO.  
CONSULTING ENGINEERS | OWINGS MILLS, MD

## PROJECT AREA VIEW





# REPLACEMENT OF BRIDGE No. M-0352 GARRETT PARK ROAD BRIDGE OVER ROCK CREEK

## DETOUR ROUTE

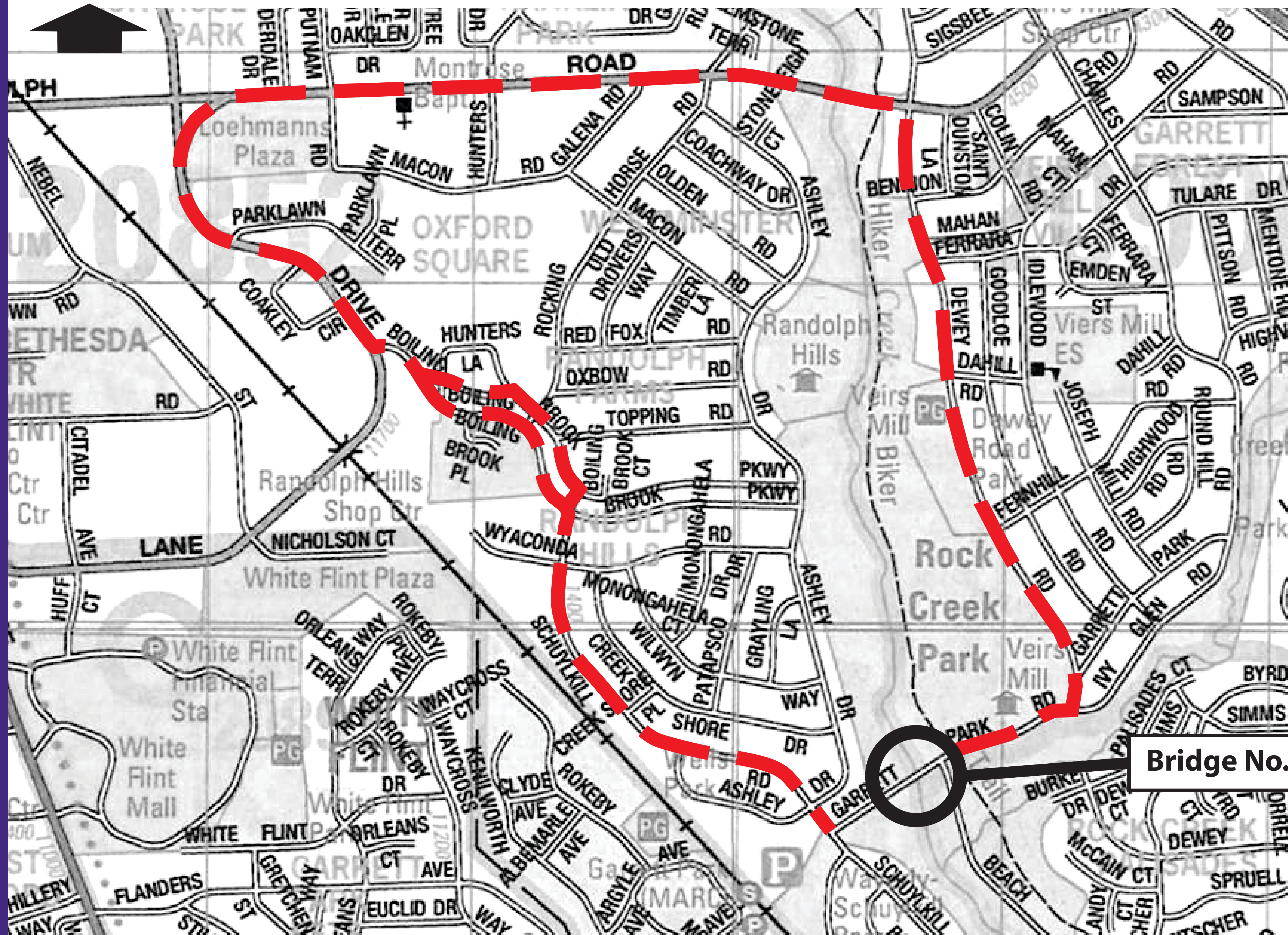

### LEGEND:

  Possible Detour Route

**Bridge No. M-0352**

ADC Street Location: [5285-F-4](#)  
2010 Edition

Copyright ADC The Map People  
Permitted Use Number 20113215





# REPLACEMENT OF BRIDGE No. M-0352 GARRETT PARK ROAD BRIDGE OVER ROCK CREEK

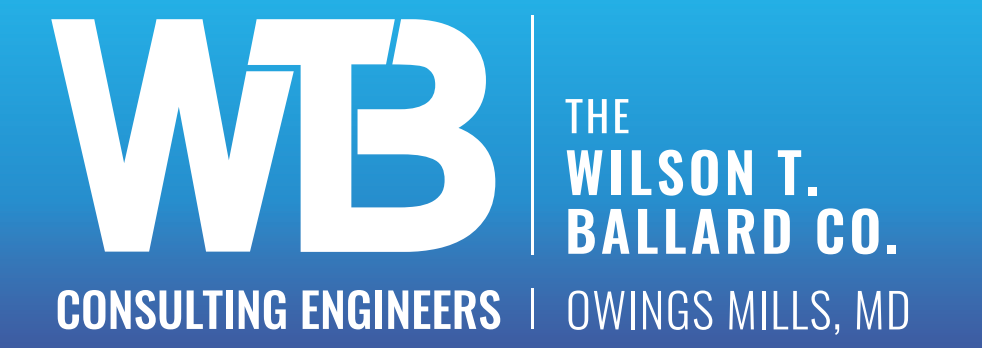

## LOCATION MAP

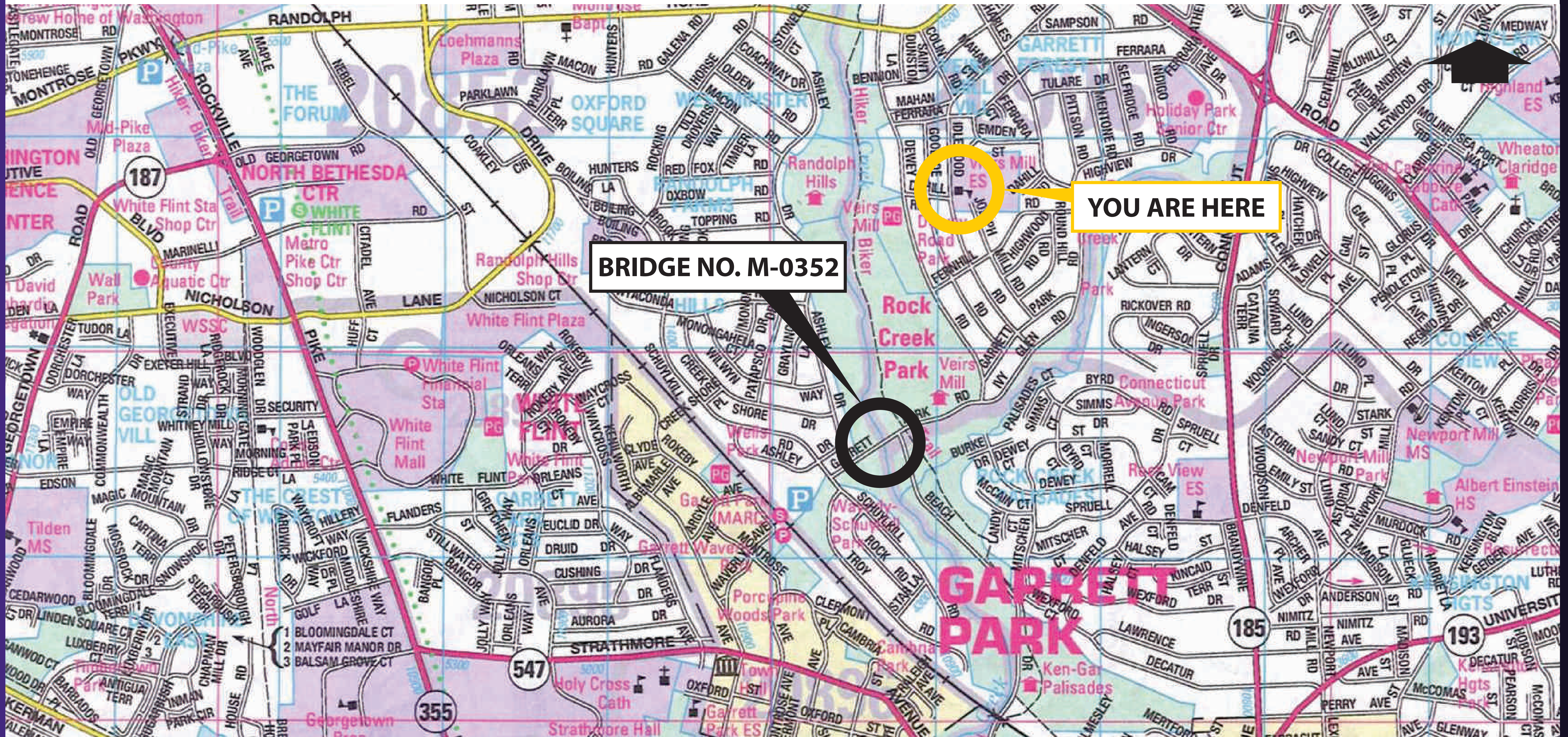

ADC Street Location: 5285-F-4  
2010 Edition

Copyright ADC The Map People  
Permitted Use Number 20113215