

1/3/2024
 UA\2026213125\700 CADD\700 Sheets\pHD-0001.01d Georgetown.dgn

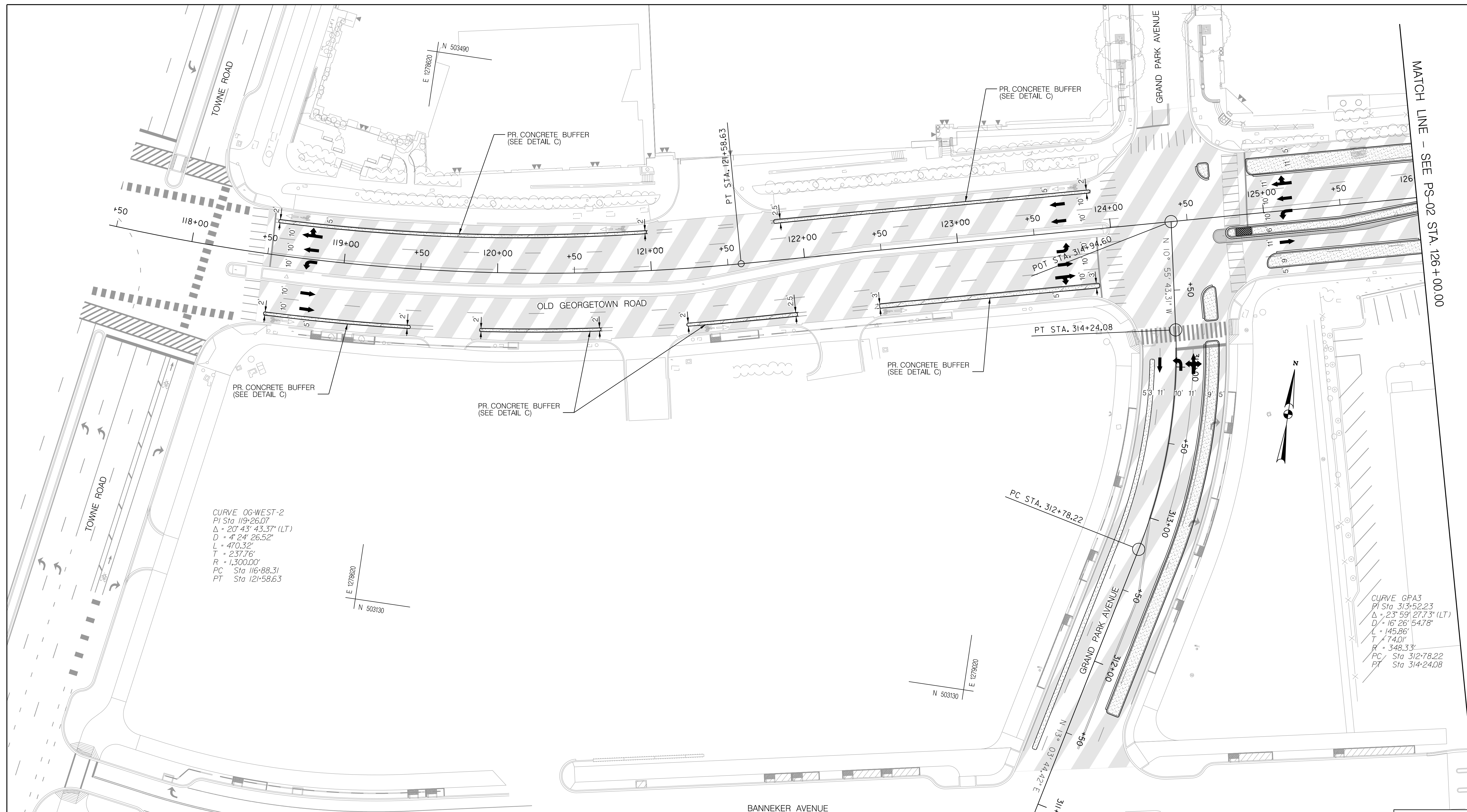

MATCH LINE - SEE PS-02 STA. 126+00.00

CURVE OG-WEST-2
 PI Sta 119+26.07
 $\Delta = 20^\circ 43' 43.37''$ (LT)
 $D = 4^\circ 24' 26.52''$
 $L = 470.32'$
 $T = 237.76'$
 $R = 1,300.00'$
 PC Sta 116+88.31
 PT Sta 121+58.63

CURVE GPA3
 PI Sta 313+52.23
 $\Delta = 23^\circ 59' 27.73''$ (LT)
 $D = 16^\circ 26' 54.78''$
 $L = 145.86'$
 $T = 74.01'$
 $R = 348.33'$
 PC Sta 312+78.22
 PT Sta 314+24.08

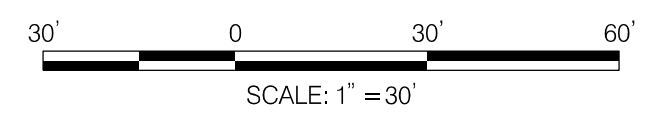

PROFESSIONAL CERTIFICATION:
 I HEREBY CERTIFY THAT THESE DOCUMENTS WERE PREPARED OR APPROVED BY ME AND THAT I AM A DULY LICENSED PROFESSIONAL ENGINEER UNDER THE LAWS OF THE STATE OF MARYLAND.
 LICENSE NO.: 28255 EXPIRATION DATE: 06-30-2024

NO.	REVISION	DATE	BY

SHA TRACKING NO. XXXXXXXXXXXX

MONTGOMERY COUNTY DEPARTMENT OF TRANSPORTATION
 DIVISION OF TRANSPORTATION ENGINEERING
 GAITHERSBURG, MARYLAND

RECOMMENDED FOR APPROVAL

SEE TITLE SHEET FOR SIGNATURES
 Chief, Design Section _____ Date _____

APPROVED

SEE TITLE SHEET FOR SIGNATURES
 Chief, Division of Transportation Engineering _____ Date _____

Designed by: _____ Drawn by: _____ Checked by: _____

PS-01

OLD GEORGETOWN ROAD
 BUFFERED BIKE LANES

ROADWAY PLAN

SCALE : 1" = 30' DATE : AUGUST 2023

Project No. : 502315 SHEET \$PS01\$ of \$TOT\$