



MONTGOMERY COUNTY EXECUTIVE ORDER

Offices of the County Executive • 101 Monroe Street • Rockville, Maryland 20850

Subject Fire Lane Establishment Order ELP Bethesda at Rock Spring	Executive Order No. 013-22	Subject Suffix
Originating Department Montgomery County Department of Permitting Services	Department Number MCDPS 1-22	Effective Date 1/18/2022

Fire Lane Establishment Order

Pursuant to Section 22 - 33, Montgomery County Code, 1971, as amended, you are hereby notified that a Fire Lane has been established as described in this order. You are hereby ordered to post fire lane signs and paint curbs/pavement (painting optional) as identified below. When signs and paint work (painting optional) have been completed, this order will authorize the enforcement of this Fire Lane by appropriate police and fire officials. Compliance with this order must be achieved within 30 days of receipt.

LOCATION: 7051 Rockledge Dr.

All areas where indicated by signs and paint.

- SIGNS - - (See attached diagram for location of sign placement)



\$250 FINE

FIRE LANE

Signs must be posted so that it is not possible to park a vehicle without being in sight of a sign. Signs may be no further apart than 100 feet

(Red letters on white background)

- PAINT - - (See attached diagram if painting).

Paint must be traffic yellow with lines of sufficient width to be readily identifiable/readable by motor vehicle operators.

Richard E Merck

Fire Marshal, Montgomery County Department of Permitting Services



MONTGOMERY COUNTY FIRE AND RESCUE SERVICE

Date: 12/10/2021

Fire Lane Establishment Order

Pursuant to Section 22-33, Montgomery County Code, 1971, as amended, you are hereby notified that a Fire Lane has been established as described in this order. You are hereby ordered to post fire lane signs and paint curbs/pavement as identified below. When signs or paint work has been completed, this order will authorize the enforcement of this Fire Lane by appropriate police or fire officials. Compliance with this order must be achieved within 30 days of receipt when any of the following conditions are met:

- One or more structures addressed from the subject road are occupied;
• The road or accessway is available for use and at least one building permit for an address on the subject road has been issued; or
• The road or accessway is necessary fire department access.

LOCATION: 7051 Rockledge Drive
ELP Bethesda Phase 1A

Delineate all areas where indicated by signs and/or paint.

[X] SIGNS -- (See attached diagram for location of sign placement)



(Red letters on white background)

Signs must be posted so that it is not possible to park a vehicle without being in sight of a sign. Signs may be no further apart than 100 feet.

[] PAINT -- (See attached diagram when painting is required)

Paint must be traffic yellow with lines of Sufficient width to be readily identifiable/ readable by motor vehicle operators.

LS1189

Signature of Order Writer/I.D. #

January 12, 2022

Cc: Fire Code Enforcement Section
Attachment: Fire Lane Diagram

FIRE LANE ESTABLISHMENT FORM

BUILDING OR SUBDIVISION NAME: ELP Bethesda at Rock Spring - Phase 1A

FIRE LANE LOCATION/ADDRESS: 7051 Rockledge Drive
Bethesda, MD 20817

See attached drawing for designated fire lanes:

I have received the drawing and instructions for installing the designated fire lanes on property not owned by state or local government.

NAME AND TITLE OF PROPERTY REPRESENTATIVE

NAME: Priya Prasad TITLE: Senior Director of Development

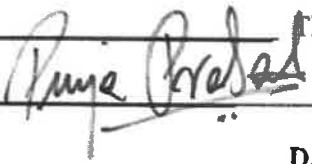
SIGNATURE: 

PHONE: 410-402-1743 DATE: 12/20/21

ADDRESS (where processed order will be mailed):

701 Maiden Choice Lane Baltimore, MD 21228

The designated fire lanes are the minimum necessary for fire/rescue access and are in accordance with Section 22-33 of the Fire Safety Code.

NAME: S Marie LaBaw SIGNATURE: 

STA.#: DPS I.D.#: LS1189 DATE: January 12, 2022

Comments: _____

Fire Lane Installed Per Order

NAME: _____ DATE: _____

The original of this drawing document was prepared by Soltesz, Inc. (SOLTESZ). If this document was not obtained directly from SOLTESZ, Inc. (SOLTESZ) and/or it was transmitted electronically, SOLTESZ cannot guarantee that unauthorized changes and/or alterations were not made by others. If verification of the information contained herein is needed, contact should be made directly with SOLTESZ. SOLTESZ makes no warranties, express or implied, concerning the accuracy of any information that has been transmitted by electronic means.

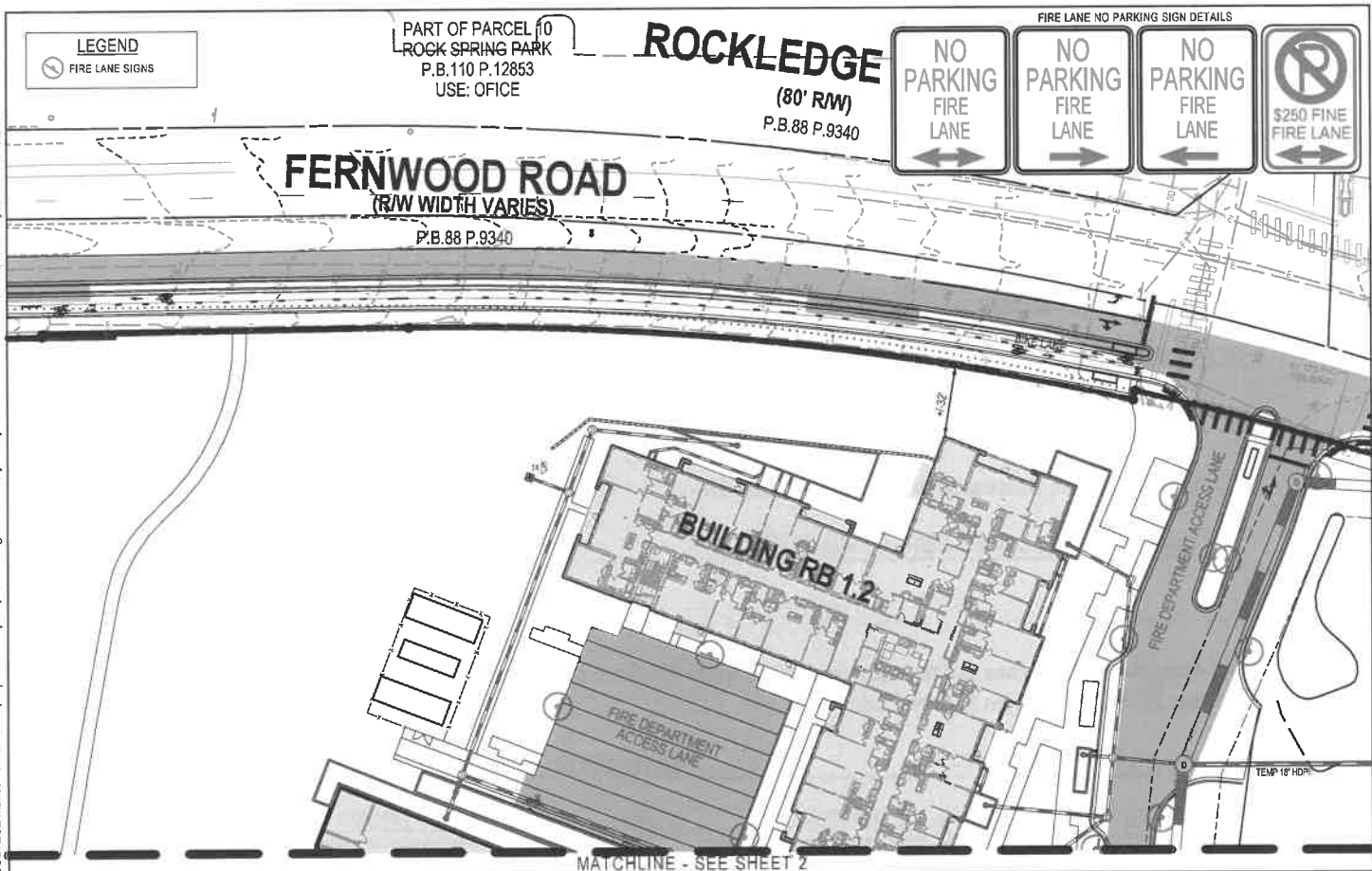

SOLTESZ, INC.
 2 Research Place, Suite 100
 Rockville, MD 20850
 P.301.948.2750 F.301.948.9067
 www.solteszco.com

FIRE LANE SIGN PLAN
ELP BETHESDA AT ROCK SPRING
 PHASE 1A
 7TH ELECTION DISTRICT
 MONTGOMERY COUNTY, MARYLAND

SHEET **1**
 OF **6**

JOB NO. 0693-04-00 SCALE 1" = 60' DATE DEC 2021

The original of this drawing document was prepared by Soltesz, Inc. (SOLTESZ). If this document was not obtained directly from SOLTESZ and/or it was transmitted electronically, SOLTESZ cannot guarantee that unauthorized changes and/or alterations were not made by others. If verification of the information contained hereon is needed, contact should be made directly with SOLTESZ. SOLTESZ makes no warranties, express or implied, concerning the accuracy of any information that has been transmitted by electronic means.



LEGEND
 FIRE LANE SIGNS



SOLTESZ, INC.
 2 Research Place, Suite 100
 Rockville, MD 20850
 P.301.948.2750 F.301.948.9067
 www.solteszco.com

FIRE LANE SIGN PLAN
ELP BETHESDA AT ROCK SPRING
 PHASE 1A
 7TH ELECTION DISTRICT
 MONTGOMERY COUNTY, MARYLAND

SHEET 2
 OF 6

JOB NO. 0693-04-00 SCALE 1" = 60' DATE DEC 2021

The original of this drawing document was prepared by Soltesz, Inc. (SOLTESZ). If this document was not obtained directly from SOLTESZ and/or it was transmitted electronically, SOLTESZ cannot guarantee that unauthorized changes and/or alterations were not made by others. If verification of the information contained herein is needed, contact should be made directly with SOLTESZ. SOLTESZ makes no warranties, express or implied, concerning the accuracy of any information that has been transmitted by electronic means.

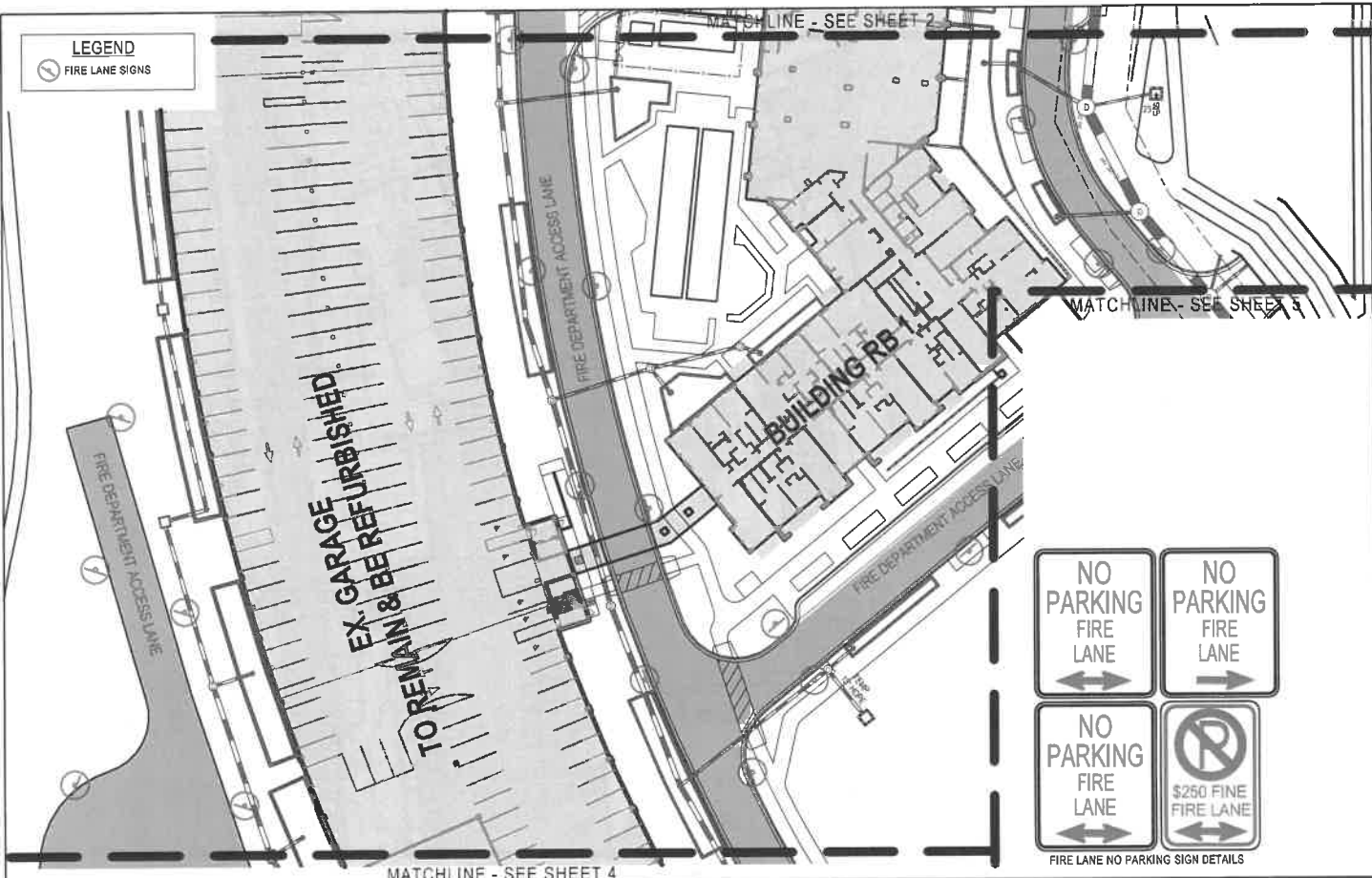

 **SOLTESZ, INC.**
 2 Research Place, Suite 100
 Rockville, MD 20850
 P.301.948.2750 F.301.948.9067
 www.solteszco.com

FIRE LANE SIGN PLAN
ELP BETHESDA AT ROCK SPRING
 PHASE 1A
 7TH ELECTION DISTRICT
 MONTGOMERY COUNTY, MARYLAND

SHEET 3
 OF 6

JOB NO. 0693-04-00 SCALE 1" = 60' DATE DEC 2021

The original of this drawing document was prepared by Soltesz, Inc. (SOLTESZ). If this document was not obtained directly from SOLTESZ and/or it was transmitted electronically, SOLTESZ cannot guarantee that unauthorized changes and / or alterations were not made by others. If verification of the information contained hereon is needed, contact should be made directly with SOLTESZ. SOLTESZ makes no warranties, express or implied, concerning the accuracy of any information that has been transmitted by electronic means.

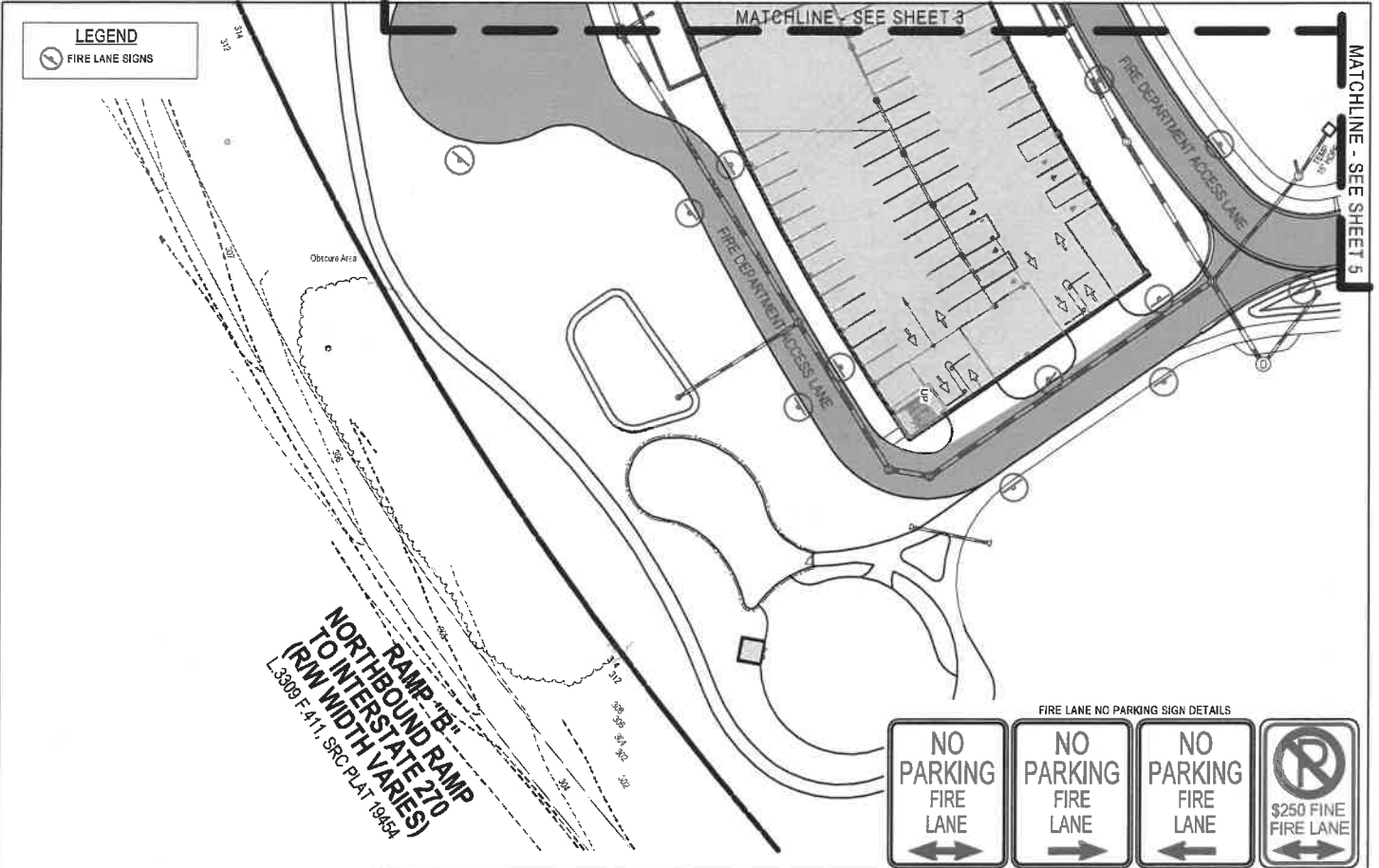

LEGEND
 FIRE LANE SIGNS





SOLTESZ, INC.
 2 Research Place, Suite 100
 Rockville, MD 20850
 P.301.948.2750 F.301.948.9067
 www.solteszco.com

FIRE LANE SIGN PLAN
ELP BETHESDA AT ROCK SPRING
 PHASE 1A
 7TH ELECTION DISTRICT
 MONTGOMERY COUNTY, MARYLAND

SHEET 4
 OF 6

JOB NO. 0693-04-00 SCALE 1"= 60' DATE DEC 2021

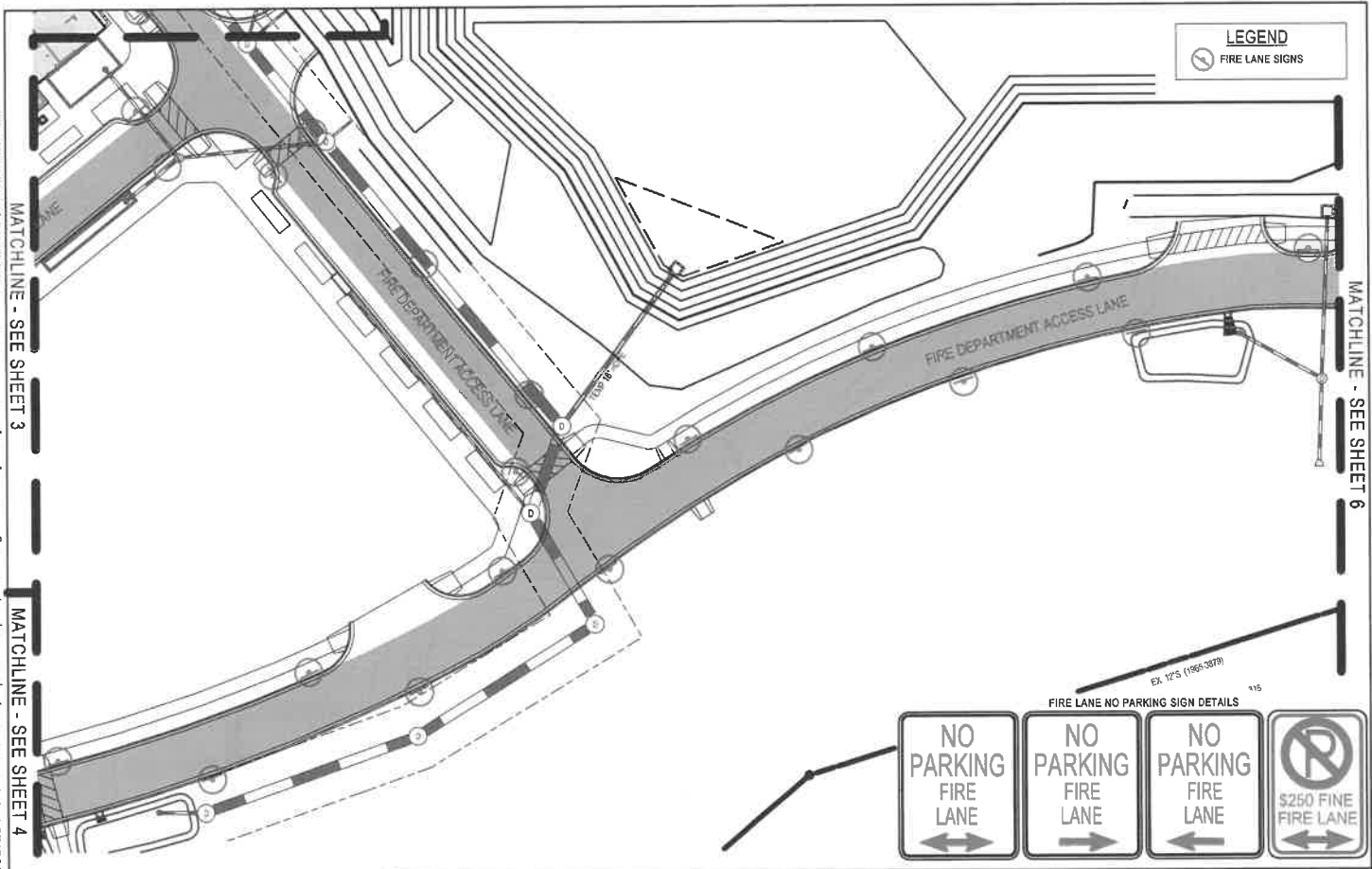
The original of this drawing document was prepared by Soltesz, Inc. (SOLTESZ). If this document was not obtained directly from SOLTESZ, Inc. (SOLTESZ) and/or it was transmitted electronically, SOLTESZ, Inc. (SOLTESZ) makes no warranties, express or implied, concerning the accuracy of any information that has been transmitted by electronic means. SOLTESZ, Inc. (SOLTESZ) makes no warranties, express or implied, concerning the accuracy of any information that has been transmitted by electronic means. SOLTESZ, Inc. (SOLTESZ) makes no warranties, express or implied, concerning the accuracy of any information that has been transmitted by electronic means.



 **SOLTESZ, Inc.**
 2 Research Place, Suite 100
 Rockville, MD 20850
 P.301.948.2750 F.301.948.9067
 www.solteszco.com

FIRE LANE SIGN PLAN
ELP BETHESDA AT ROCK SPRING
 PHASE 1A
 7TH ELECTION DISTRICT
 MONTGOMERY COUNTY, MARYLAND

JOB NO. 0693-04-00 SCALE 1" = 60' DATE DEC 2021

SHEET 5 OF 6

The original of this drawing document was prepared by Soltesz, Inc. (SOLTESZ). If this document was not obtained directly from SOLTESZ and/or it was transmitted electronically, SOLTESZ cannot guarantee that unauthorized changes and/or alterations were not made by others. If verification of the information contained hereon is needed, contact should be made directly with SOLTESZ. SOLTESZ makes no warranties, express or implied, concerning the accuracy of any information that has been transmitted by electronic means.

MATCHLINE - SEE SHEET 5

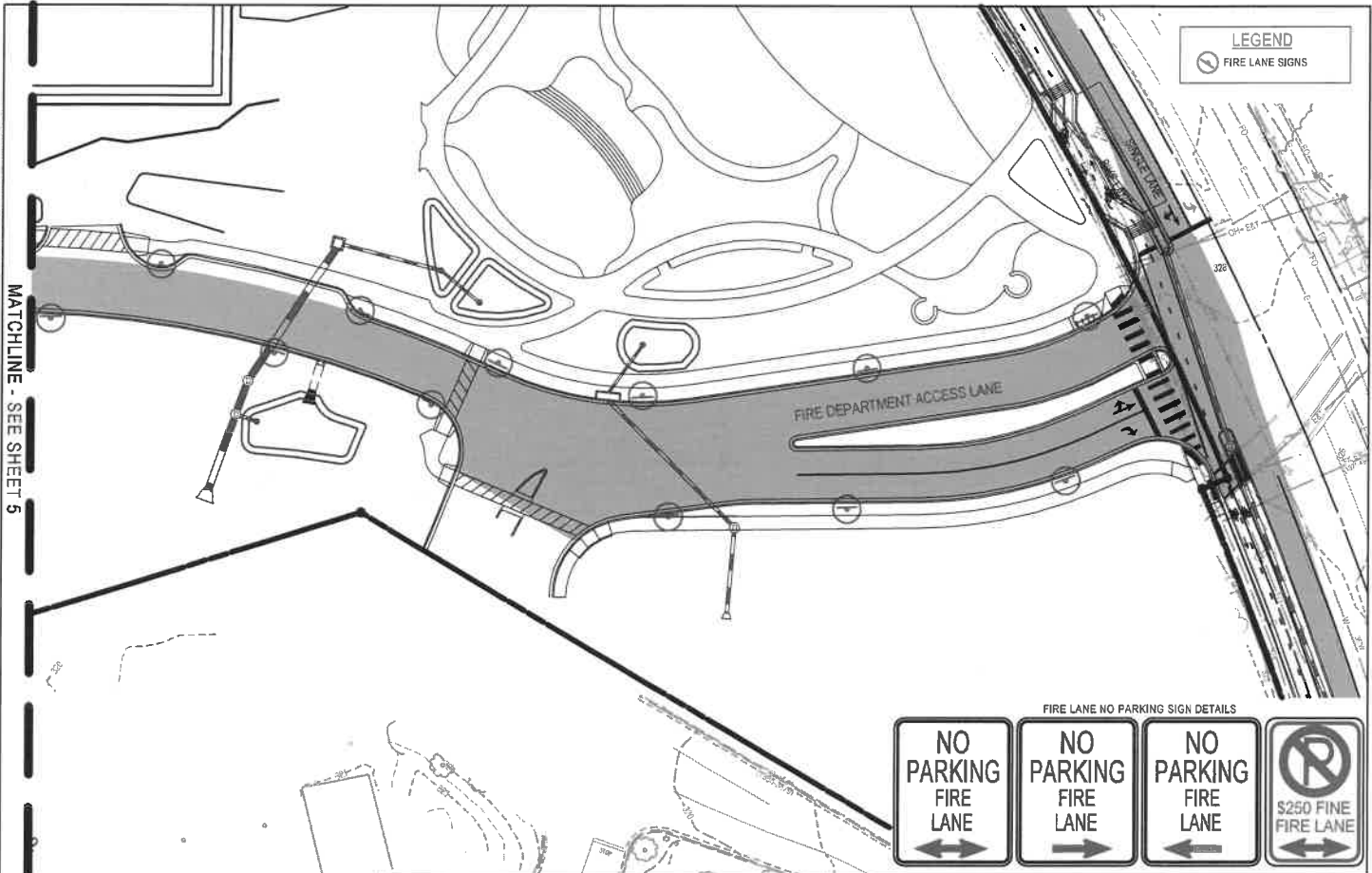

SOLTESZ, INC.
 2 Research Place, Suite 100
 Rockville, MD 20850
 P.301.948.2750 F.301.948.9067
 www.solteszco.com

FIRE LANE SIGN PLAN
ELP BETHESDA AT ROCK SPRING
 PHASE 1A
 7TH ELECTION DISTRICT
 MONTGOMERY COUNTY, MARYLAND

SHEET 6
 OF 6

JOB NO. 0693-04-00 SCALE 1" = 60' DATE DEC 2021

