



# MONTGOMERY COUNTY EXECUTIVE ORDER

Offices of the County Executive • 101 Monroe Street • Rockville, Maryland 20850

Subject Fire Lane Establishment Order Preston Place and Lake Apartments Phase 2	Executive Order No. 029-24	Subject Suffix
Originating Department Montgomery County Department of Permitting Services	Department Number MCDPS 5-24	Effective Date 2/21/2024

### Fire Lane Establishment Order

Pursuant to Section 22 - 33, Montgomery County Code, 1971, as amended, you are hereby notified that a Fire Lane has been established as described in this order. You are hereby ordered to post fire lane signs and paint curbs/pavement (painting optional) as identified below. When signs and paint work (painting optional) have been completed, this order will authorize the enforcement of this Fire Lane by appropriate police and fire officials. Compliance with this order must be achieved within 30 days of receipt.

LOCATION: Farrand Place from Manor Road to terminus at southeast of site except where 8' parallel parking spaces are provided. Feilman Place from Manor Road to intersection with Farrand Place. Alley D & Alley F from intersection of Feilman Place to 150 feet from intersection tangent. Preston Place & Lake Apartments Phase 2

All areas where indicated by signs and paint.

- SIGNS** - - (See attached diagram for location of sign placement)



\$250 FINE  
FIRE LANE

Signs must be posted so that it is not possible to park a vehicle without being in sight of a sign. Signs may be no further apart than 100 feet

(Red letters on white background)

- PAINT** - - (See attached diagram if painting).

Paint must be traffic yellow with lines of sufficient width to be readily identifiable/readable by motor vehicle operators.

*Richard E. Merck*

Fire Marshal, Montgomery County Department of Permitting Services



MONTGOMERY COUNTY FIRE AND RESCUE SERVICE

Date: February 09, 2024

Fire Lane Establishment Order

Pursuant to Section 22-33, Montgomery County Code, 1971, as amended, you are hereby notified that a Fire Lane has been established as described in this order. You are hereby ordered to post fire lane signs and paint curbs/pavement as identified below. When signs or paint work has been completed, this order will authorize the enforcement of this Fire Lane by appropriate police or fire officials. Compliance with this order must be achieved within 30 days of receipt when any of the following conditions are met:

- One or more structures addressed from the subject road are occupied;
• The road or accessway is available for use and at least one building permit for an address on the subject road has been issued; or
• The road or accessway is necessary fire department access.

LOCATION: 1. Farrand Place from Manor Road to terminus at southeast of site except where 8' parallel parking spaces are provided.
2. Feilman Place from Manor Road to intersection with Farrand Place.
3. Alley D & Alley F from intersection of Feilman Place to 150 feet from intersection tangent.

Delineate all areas where indicated by signs and/or paint.

[X] SIGNS -- (See attached diagram for location of sign placement)



(Red letters on white background)

Signs must be posted so that it is not possible to park a vehicle without being in sight of a sign. Signs may be no further apart than 100 feet.

[ ] PAINT -- (See attached diagram when painting is required)

Paint must be traffic yellow with lines of Sufficient width to be readily identifiable/readable by motor vehicle operators.

LS1189

Signature of Order Writer/I.D. #
February 20, 2024

Cc: Fire Code Enforcement Section
Attachment: Fire Lane Diagram

FIRE LANE ESTABLISHMENT FORM

BUILDING OR SUBDIVISION NAME: Preston Place & Lake Apartments Phase 2

FIRE LANE LOCATION/ADDRESS: South side of Manor Road at intersection with Jones Bridge Road.

See attached drawing for designated fire lanes:

I have received the drawing and instructions for installing the designated fire lanes.

NAME AND TITLE OF PROPERTY REPRESENTATIVE

NAME: Jeffery S. Driscoll TITLE: VP, Land Development, DC Metro

SIGNATURE: 

PHONE: 410.381.3263 DATE: February 09, 2024

EMAIL ADDRESS (where processed order will be sent):

sloan@vika.com

-----  
The designated fire lanes are the minimum necessary for fire/rescue access and are in accordance with Section 22-33 of the Fire Safety Code.

NAME: Marie LaBaw SIGNATURE: 

STA.#: DPS I.D.#: LS1189 DATE: February 20, 2024

Comments: \_\_\_\_\_

-----  
Fire Lane Installed Per Order

NAME: \_\_\_\_\_ DATE: \_\_\_\_\_

0092N/23

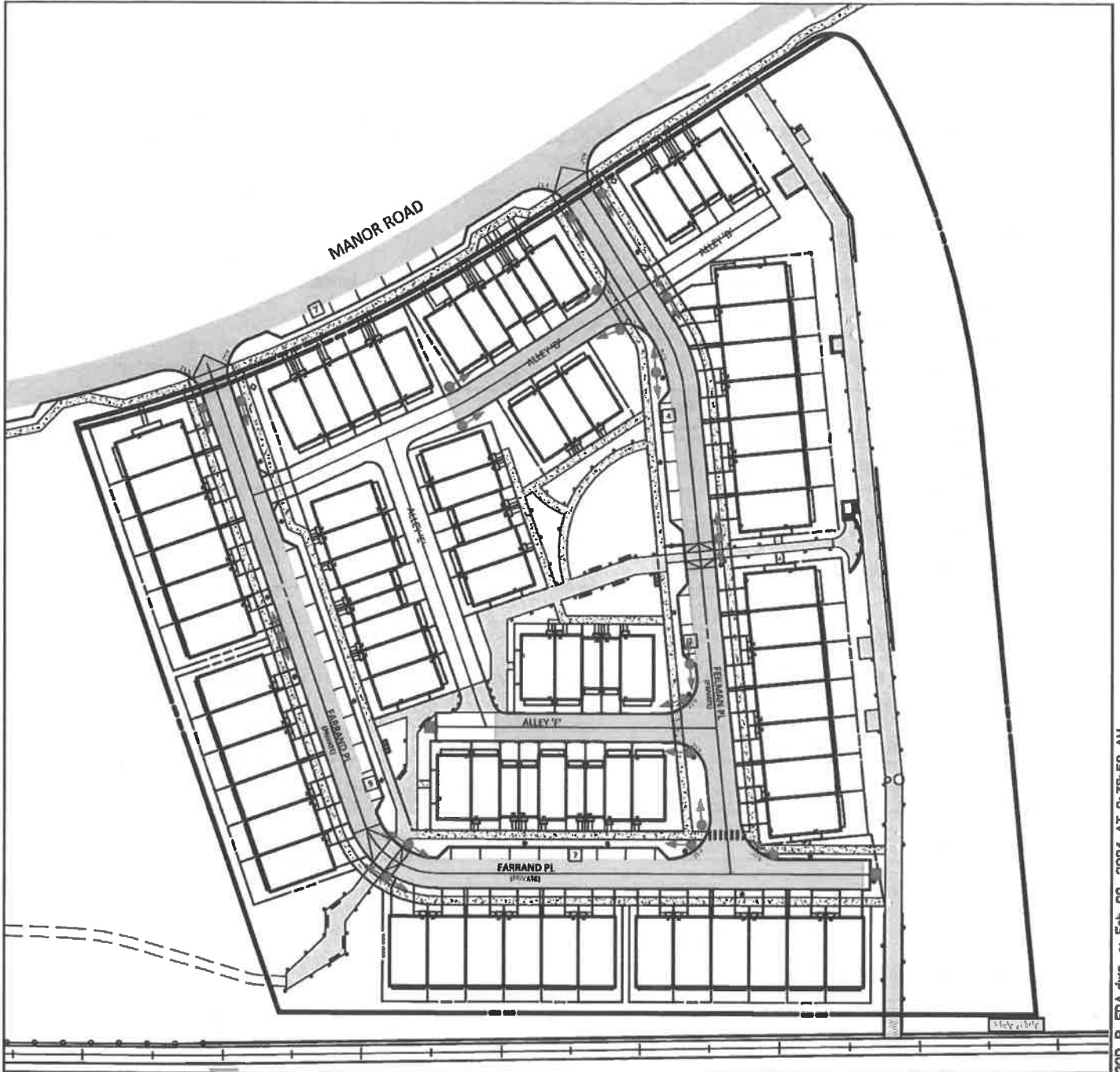

**ORDER FOR TRAFFIC CONTROL SIGNS**  
 Pursuant to Section 31-2 and 31-10, Montgomery County Code, 2004 as amended, you are hereby directed to install the following traffic and or parking control devices at the designated location(s).

**LEGEND**

- Fire Lane Sign/Direction
- Fire Lane Sign (end of alley)
- Fire Access Path



VKA MARYLAND, LLC ■  
 ENGINEERS ■ PLANNERS ■ LANDSCAPE ARCHITECTS ■  
 SURVEYORS ■ 3D LASER SCANNING ■  
 20251 CENTURY BOULEVARD SUITE 400 ■  
 GERMANTOWN, MD 20874 ■  
 (301)918-6100 ■ FAX (301)918-2282 ■  
 WWW.VKA.COM ■

**PRESTON PLACE AND LAKE APARTMENTS**  
 7TH ELECTION DISTRICT MONTGOMERY COUNTY, MARYLAND  
 WSSC GRID: 210NW04  
 TAX MAP: HN43

FIRE LANE ORDER	
DATE: JANUARY 26, 2023	
DRAWN: NT	CHECKED: JS
----	2 OF 2
----	



0    50'    100'    200'

SCALE: 1" = 100'

**PRIVATE ROAD A & PRIVATE ALLEYS B, C & D- PRESTON PLACE APARTMENTS**  
**FIRE LANE ORDER - NO PARKING SIGN LOCATIONS**