



# MONTGOMERY COUNTY EXECUTIVE ORDER

Offices of the County Executive • 101 Monroe Street • Rockville, Maryland 20850

Subject Fire Lane Establishment Order 2811 14 <sup>th</sup> St., NE Gospel Hall Inc. Church	Executive Order No. 042-25	Subject Suffix
Originating Department Montgomery County Department of Permitting Services	Department Number MCDPS 8-25	Effective Date 4/24/2025

## Fire Lane Establishment Order

Pursuant to Section 22 - 33, Montgomery County Code, 1971, as amended, you are hereby notified that a Fire Lane has been established as described in this order. You are hereby ordered to post fire lane signs and paint curbs/pavement (painting optional) as identified below. When signs and paint work (painting optional) have been completed, this order will authorize the enforcement of this Fire Lane by appropriate police and fire officials. Compliance with this order must be achieved within 30 days of receipt.

LOCATION: 211 Ednor Rd.

All areas where indicated by signs and paint.

☒ SIGNS - - (See attached diagram for location of sign placement)



\$250 FINE

FIRE LANE

Signs must be posted so that it is not possible to park a vehicle without being in sight of a sign. Signs may be no further apart than 100 feet

(Red letters on white background)

☐ PAINT - - (See attached diagram if painting).

Paint must be traffic yellow with lines of sufficient width to be readily identifiable/readable by motor vehicle operators.

Pastora Warrick 05/09/2025  
Fire Marshal, Montgomery County Department of Permitting Services



## MONTGOMERY COUNTY FIRE AND RESCUE SERVICE

Date: January 14, 2025

### Fire Lane Establishment Order

Pursuant to Section 22-33, Montgomery County Code, 1971, as amended, you are hereby notified that a Fire Lane has been established as described in this order. You are hereby ordered to post fire lane signs and paint curbs/pavement as identified below. When signs or paint work has been completed, this order will authorize the enforcement of this Fire Lane by appropriate police or fire officials. Compliance with this order must be achieved within 30 days of receipt when any of the following conditions are met:

- One or more structures addressed from the subject road are occupied;
- The road or accessway is available for use and at least one building permit for an address on the subject road has been issued; or
- The road or accessway is necessary fire department access.

LOCATION: 211 Ednor Road, Silver Spring, Maryland 20509

Delineate all areas where indicated by signs and/or paint.

☒ **SIGNS** -- (See attached diagram for location of sign placement)



(Red letters on white background)

Signs must be posted so that it is not possible to park a vehicle without being in sight of a sign. Signs may be no further apart than 100 feet.

☐ **PAINT** -- (See attached diagram when painting is required)

Paint must be traffic yellow with lines of sufficient width to be readily identifiable/readable by motor vehicle operators.

LS1189

Signature of Order Writer/I.D. #

April 18, 2025

Cc: Fire Code Enforcement Section  
Attachment: Fire Lane Diagram

## FIRE LANE ESTABLISHMENT FORM

BUILDING OR SUBDIVISION NAME: 2811 14th Street NE Gospel Hall, Inc. ChurchFIRE LANE LOCATION/ADDRESS: 211 Ednor Road, Silver Spring, Maryland 20905

See attached drawing for designated fire lanes:

I have received the drawing and instructions for installing the designated fire lanes on property not owned by state or local government.

NAME AND TITLE OF PROPERTY REPRESENTATIVENAME: Walter Bowie TITLE: Owner's RepresentativeSIGNATURE: Walt BowiePHONE: 240.319.1341 DATE: 1/14/2025

ADDRESS (where processed order will be mailed):

3909 National Drive, Suite 250, Burtonsville, Maryland 20866

The designated fire lanes are the minimum necessary for fire/rescue access and are in accordance with Section 22-33 of the Fire Safety Code.

NAME: Marie LaBaw SIGNATURE: Marie LaBawSTA.#: DPS I.D.#: LS1189 DATE: April 18, 2025

Comments: \_\_\_\_\_

Fire Lane Installed Per Order

NAME: \_\_\_\_\_ DATE: \_\_\_\_\_

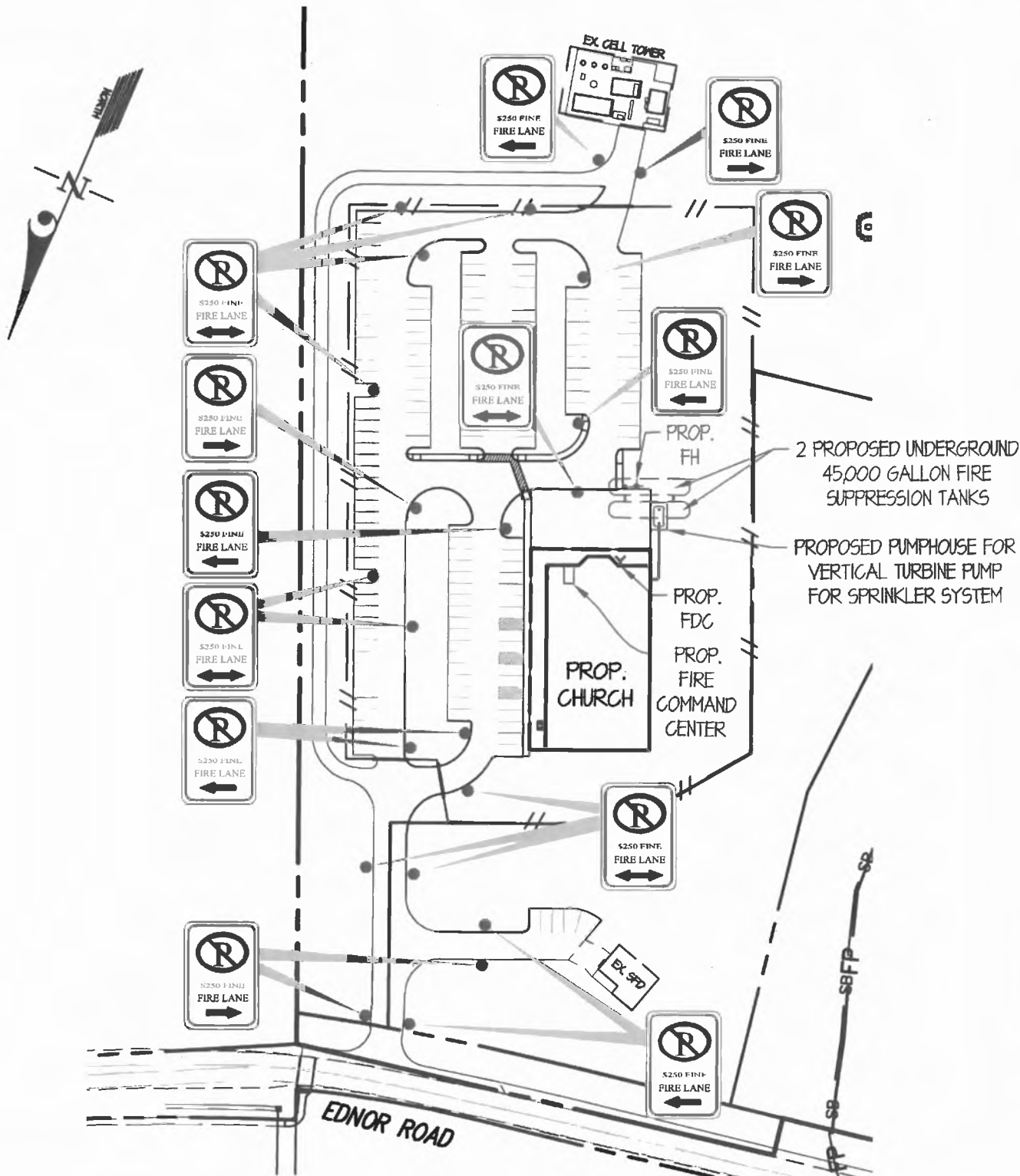

## PRIVATE FIRE LANE ORDER

### LEGEND

- PROPOSED "NO PARKING-FIRE LANE" SIGN
- PROPOSED YELLOW FIRE LANE CURB PAINTING
- PROPOSED PAINTED RED FIRE LANE STRIPING ON PAVEMENT. (WHERE THERE IS NO CURB, AS SHOWN ON THE PLAN ONLY).

2811 14th Street NE Gospel Hall, Inc. Church  
(211 Ednor Road)



**GLW**  
PLANNING | ENGINEERING | SURVEYING

3909 NATIONAL DRIVE | SUITE 250 | BURTONSVILLE, MD 20866 | GLWPA.COM  
PHONE: 301-421-4024 | BALT: 410-890-1820 | DC&VA: 301-989-2524 | FAX: 301-421-4186

DESIGNED BY:

TSZ

DRAWN BY:

TSZ

CHECKED BY:

TML

### PREPARED FOR:

Ednor Road, LLC  
c/o Walter Bowie  
7501 Wisconsin Avenue, #1000NW  
Bethesda, MD 20814

G. L. W. No. 22159

ZONING RE-2

TAX MAP/GRID JS-43

DATE Jan, 2025

SCALE 1"=100'

SHEET F-1

## FIRE LANE ESTABLISHMENT FORM

BUILDING OR SUBDIVISION NAME: 2811 14th Street NE Gospel Hall, Inc. ChurchFIRE LANE LOCATION/ADDRESS: 211 Ednor Road, Silver Spring, Maryland 20905

See attached drawing for designated fire lanes:

I have received the drawing and instructions for installing the designated fire lanes on property not owned by state or local government.

NAME AND TITLE OF PROPERTY REPRESENTATIVENAME: Walter Bowie TITLE: Owner's RepresentativeSIGNATURE: Walt BowiePHONE: 240.319.1341 DATE: 1/14/2025

ADDRESS (where processed order will be mailed):

3909 National Drive, Suite 250, Burtonsville, Maryland 20866

The designated fire lanes are the minimum necessary for fire/rescue access and are in accordance with Section 22-33 of the Fire Safety Code.

NAME: Marie LaBaw SIGNATURE: [Signature]STA.#: DPS I.D.#: LS1189 DATE: April 18, 2025

Comments: \_\_\_\_\_

Fire Lane Installed Per Order

NAME: \_\_\_\_\_ DATE: \_\_\_\_\_

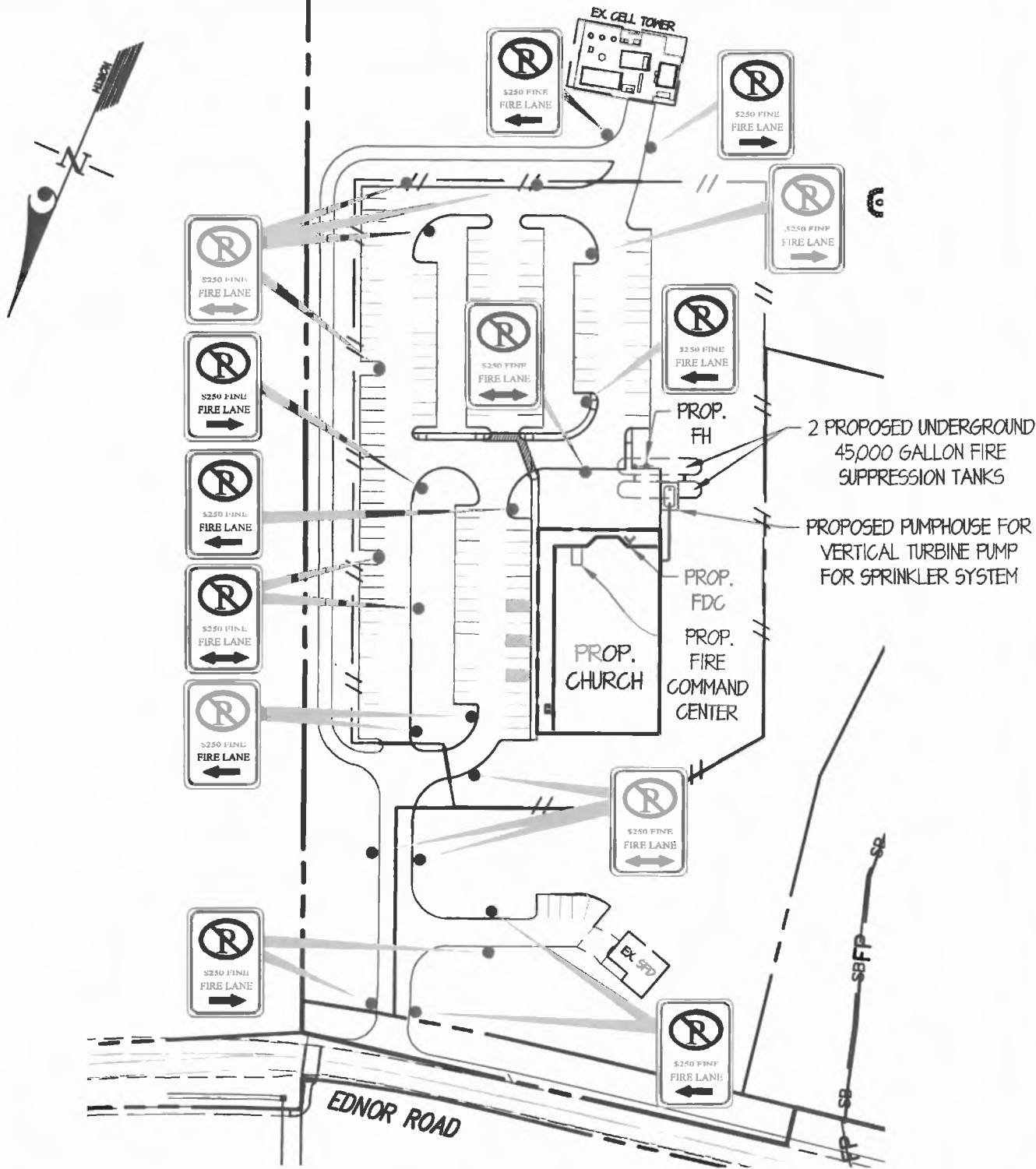

# PRIVATE FIRE LANE ORDER

- LEGEND**
- PROPOSED "NO PARKING-FIRE LANE" SIGN
  - PROPOSED YELLOW FIRE LANE CURB PAINTING
  - PROPOSED PAINTED RED FIRE LANE STRIPING ON PAVEMENT. (WHERE THERE IS NO CURB, AS SHOWN ON THE PLAN ONLY).

2811 14th Street NE Gospel Hall, Inc. Church  
(211 Ednor Road)



3909 NATIONAL DRIVE | SUITE 250 | BURTONSVILLE, MD 20866 | GLWPA.COM  
PHONE: 301-421-4024 | BALT: 410-890-1620 | DC&VA: 301-989-2524 | FAX: 301-421-4186

DESIGNED BY:  
TSZ  
DRAWN BY:  
TSZ  
CHECKED BY:  
TML

PREPARED FOR :  
Ednor Road, LLC  
c/o Walter Bowie  
7501 Wisconsin Avenue, #1000NW  
Bethesda, MD 20814

G. L. W. No.	22159
ZONING	RE-2
TAX MAP/GRID	JS-43
DATE	Jan, 2025
SCALE	1"=100'
SHEET	F-1

## **Letter of Approval to Act on Behalf of the Trust**

### **Introduction**

The 2811 14<sup>th</sup> Street Gospel Halls Trust congregation has about 130 members and currently meets at a congregation hall located on Adelphi Road in College Park, Prince George's County, Maryland. The Church leadership estimates that approximately 70% of this growing congregation lives in Montgomery County, so we have been pursuing a community-oriented location where the Church can house a new congregation hall.

### **Project Purpose**

The subject property (211 Ednor Rd) posed a unique opportunity because it was important to the Church to find a property large enough to house both the primary church building and an administration building along with ample parking. The Church is also excited to find a site that allows it to maintain and leave undisturbed a scenic and bucolic setting for church members and for the public to enjoy. The subject property, which is incidentally currently owned by congregation members, meets those goals.

### **Project Team**

The project has contracted GLW as the land planner to perform all the Surveying and Engineering Tasks needed to subdivide the land and obtain a recorded plat. McMillan Metro Faerber, P.C. will act as counsel on this project, and Walter Bowie from Endor Land LLC will be the project manager, report progress to the development committee chair, and provide updates.

## **Project Authorization**

  
\_\_\_\_\_  
Signature

August 30, 2024  
\_\_\_\_\_  
Date

Approved By: Randall Thomas, Development Chair, 2811 14<sup>th</sup> Street Gospel Halls trust





## **Letter of Approval to Act on Behalf of the Trust**

### **Introduction**

The 2811 14<sup>th</sup> Street Gospel Halls Trust congregation has about 130 members and currently meets at a congregation hall located on Adelphi Road in College Park, Prince George's County, Maryland. The Church leadership estimates that approximately 70% of this growing congregation lives in Montgomery County, so we have been pursuing a community-oriented location where the Church can house a new congregation hall.

### **Project Purpose**

The subject property (211 Ednor Rd) posed a unique opportunity because it was important to the Church to find a property large enough to house both the primary church building and an administration building along with ample parking. The Church is also excited to find a site that allows it to maintain and leave undisturbed a scenic and bucolic setting for church members and for the public to enjoy. The subject property, which is incidentally currently owned by congregation members, meets those goals.

### **Project Team**

The project has contracted GLW as the land planner to perform all the Surveying and Engineering Tasks needed to subdivide the land and obtain a recorded plat. McMillan Metro Faerber, P.C. will act as counsel on this project, and Walter Bowie from Endor Land LLC will be the project manager, report progress to the development committee chair, and provide updates.

## **Project Authorization**

  
\_\_\_\_\_  
Signature

August 30, 2024  
\_\_\_\_\_  
Date

Approved By: Randall Thomas, Development Chair, 2811 14<sup>th</sup> Street Gospel Halls trust



## MONTGOMERY COUNTY FIRE AND RESCUE SERVICE

Date: January 14, 2025

### Fire Lane Establishment Order

Pursuant to Section 22-33, Montgomery County Code, 1971, as amended, you are hereby notified that a Fire Lane has been established as described in this order. You are hereby ordered to post fire lane signs and paint curbs/pavement as identified below. When signs or paint work has been completed, this order will authorize the enforcement of this Fire Lane by appropriate police or fire officials. Compliance with this order must be achieved within 30 days of receipt when any of the following conditions are met:

- One or more structures addressed from the subject road are occupied;
- The road or accessway is available for use and at least one building permit for an address on the subject road has been issued; or
- The road or accessway is necessary fire department access.

LOCATION: 211 Ednor Road, Silver Spring, Maryland 20509

Delineate all areas where indicated by signs and/or paint.

☒ **SIGNS** -- (See attached diagram for location of sign placement)



(Red letters on white background)



Signs must be posted so that it is not possible to park a vehicle without being in sight of a sign. Signs may be no further apart than 100 feet.

☐ **PAINT** -- (See attached diagram when painting is required)

Paint must be traffic yellow with lines of sufficient width to be readily identifiable/readable by motor vehicle operators.

LS1189

Signature of Order Writer/I.D. #

April 18, 2025

Cc: Fire Code Enforcement Section

Attachment: Fire Lane Diagram