



MONTGOMERY COUNTY EXECUTIVE ORDER

Offices of the County Executive • 101 Monroe Street • Rockville, Maryland 20850

Subject Fire Lane Establishment Order for Forest Glen Park	Executive Order No. 44-18	Subject Suffix
Originating Department Montgomery County Department of Permitting Services	Department Number MCDPS 11-18	Effective Date 3/01/2018

Fire Lane Establishment Order

Pursuant to Section 22 - 33, Montgomery County Code, 1971, as amended, you are hereby notified that a Fire Lane has been established as described in this order. You are hereby ordered to post fire lane signs and paint curbs/pavement (painting optional) as identified below. When signs and paint work (painting optional) have been completed, this order will authorize the enforcement of this Fire Lane by appropriate police and fire officials. Compliance with this order must be achieved within 30 days of receipt.

LOCATION: Hume Dr

All areas where indicated by signs and paint.

SIGNS - - (See attached diagram for location of sign placement)



\$250 FINE

FIRE LANE

Signs must be posted so that it is not possible to park a vehicle without being in sight of a sign. Signs may be no further apart than 100 feet

(Red letters on white background)

PAINT - - (See attached diagram if painting).

Paint must be traffic yellow with lines of sufficient width to be readily identifiable/readable by motor vehicle operators.

Fire Marshal, Montgomery County Department of Permitting Services

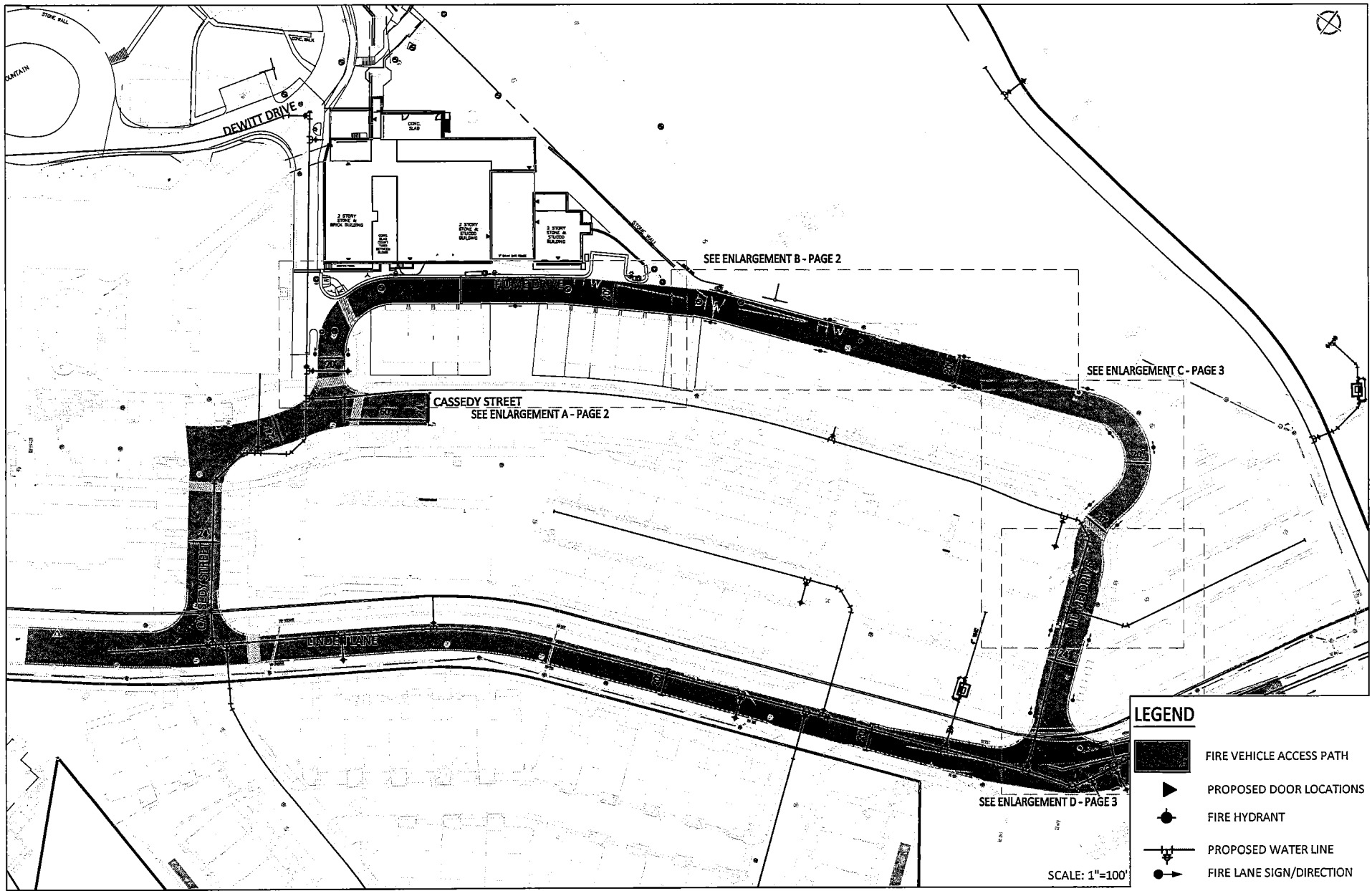

National Park Seminary - Power Plant Building

MONTGOMERY COUNTY, MARYLAND SUBMISSION: FEBRUARY 2018
 WSSC MAP: 212 NW 03
 TAX MAP: HP562

**FIRE LANE
 ESTABLISHMENT ORDER**

PAGE 1 of 3



VIKA MARYLAND, LLC ■
 ENGINEERS ■ PLANNERS ■ LANDSCAPE ARCHITECTS ■
 SURVEYORS ■ SUSTAINABLE DESIGN ■
 20251 CENTURY BOULEVARD SUITE 400 ■
 GERMANTOWN, MD 20874 ■
 (301)916-4100 ■ FAX (301)916-2262 ■
 WWW.VIKA.COM ■

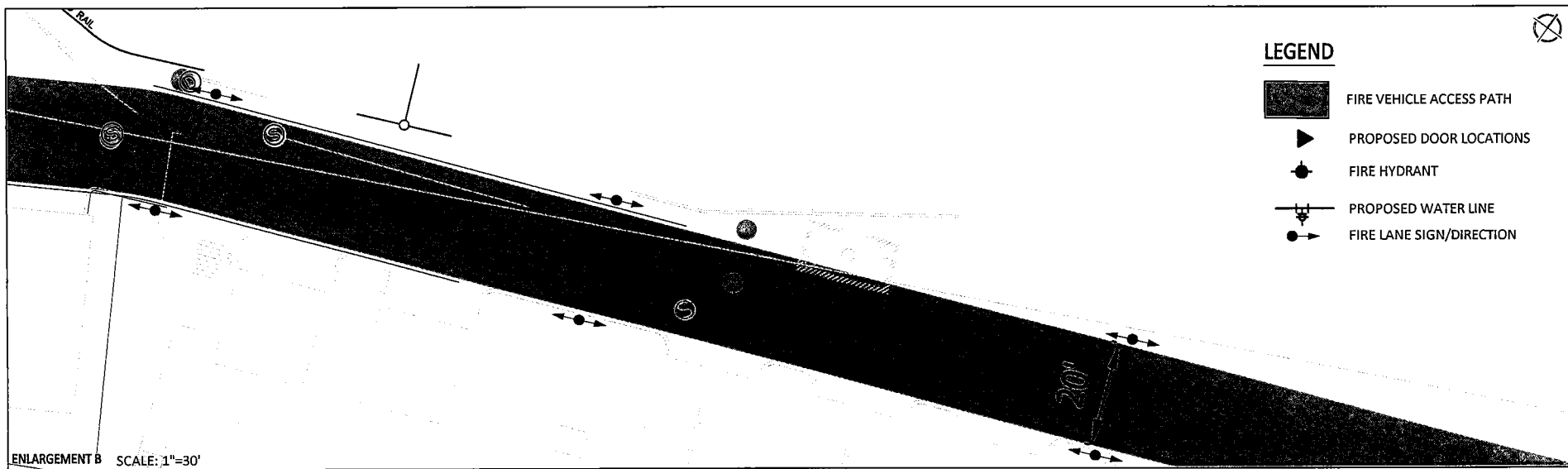
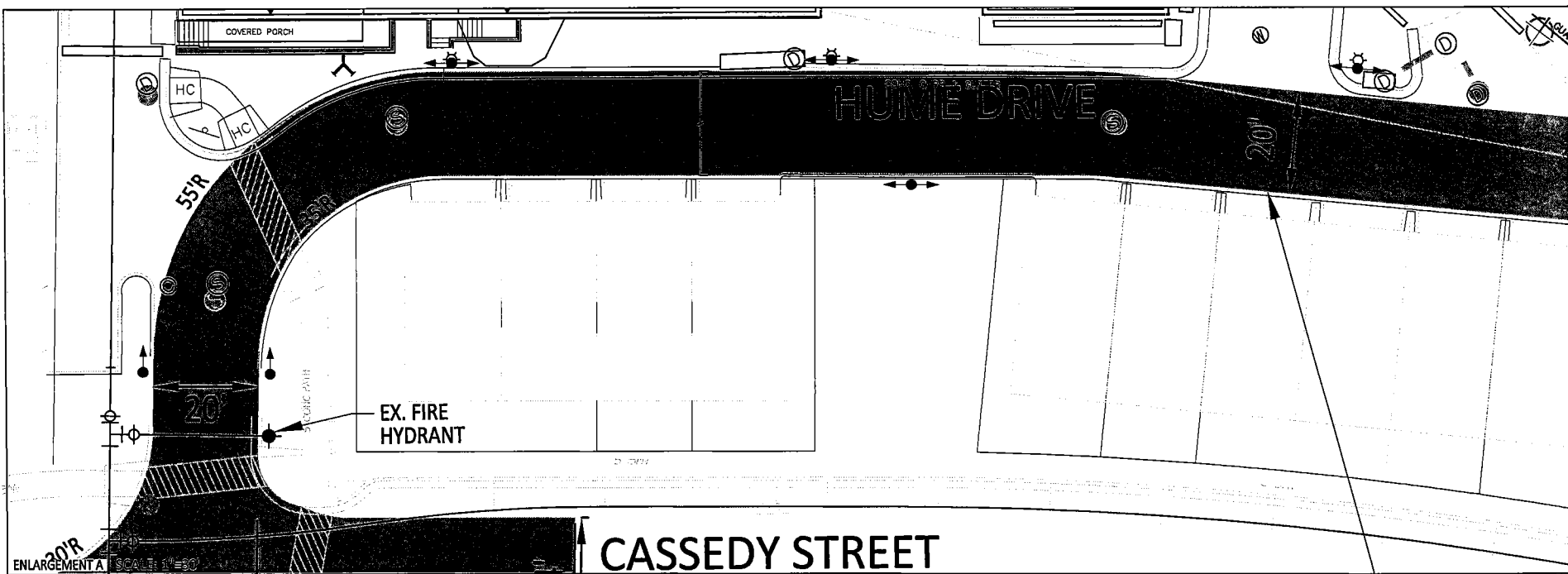

National Park Seminary - Power Plant Building

MONTGOMERY COUNTY, MARYLAND SUBMISSION: FEBRUARY 2018
 WSSC MAP: 212 NW 03
 TAX MAP: HP562

**FIRE LANE
 ESTABLISHMENT ORDER**

PAGE 2 of 3



VIKA MARYLAND, LLC ■
 ENGINEERS ■ PLANNERS ■ LANDSCAPE ARCHITECTS ■
 SURVEYORS ■ SUSTAINABLE DESIGN ■
 20251 CENTURY BOULEVARD SUITE 400 ■
 GERMANTOWN, MD 20874 ■
 (301)916-4100 ■ FAX (301)916-2262 ■
 WWW.VIKA.COM ■

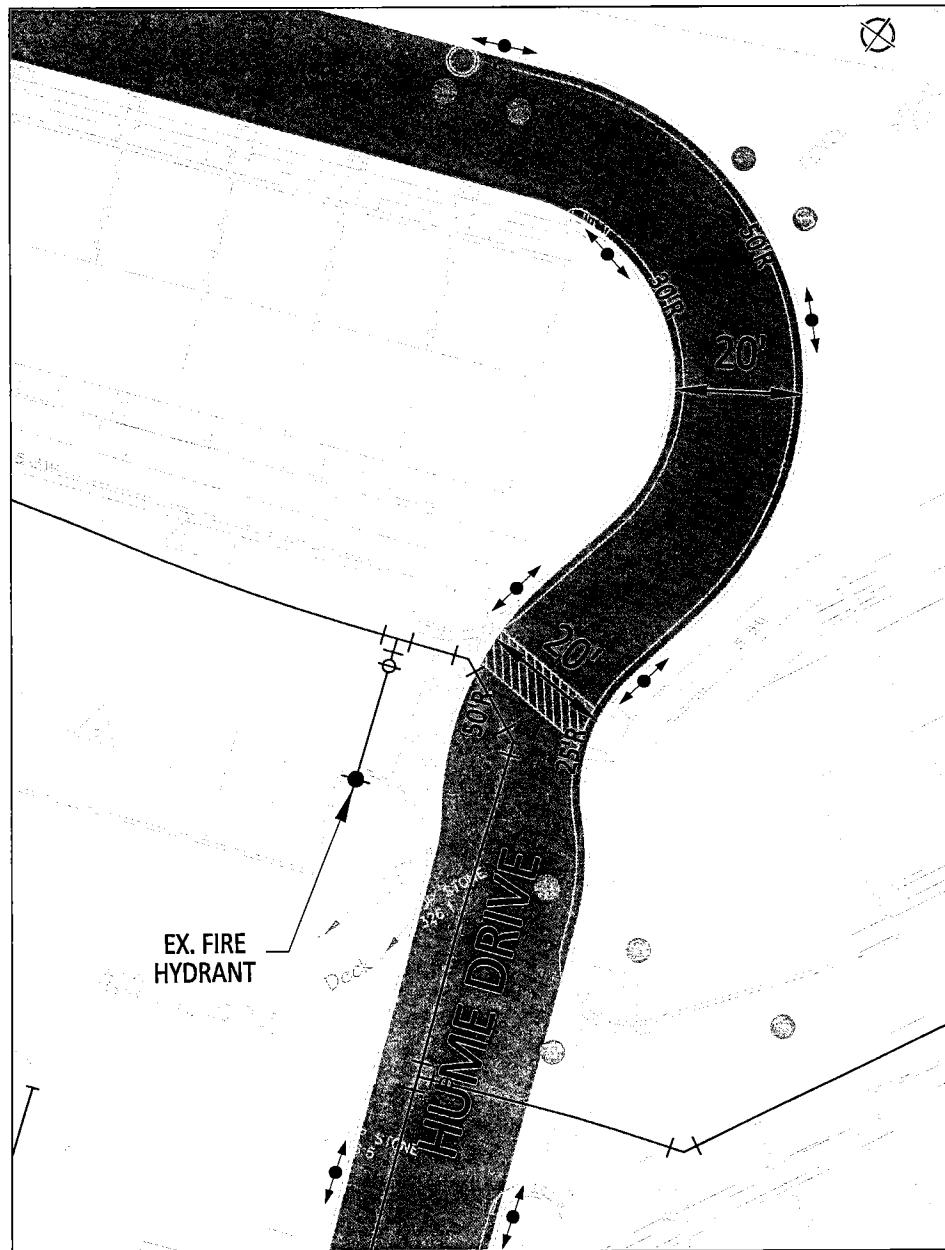

ENLARGEMENT C SCALE: 1"=30'

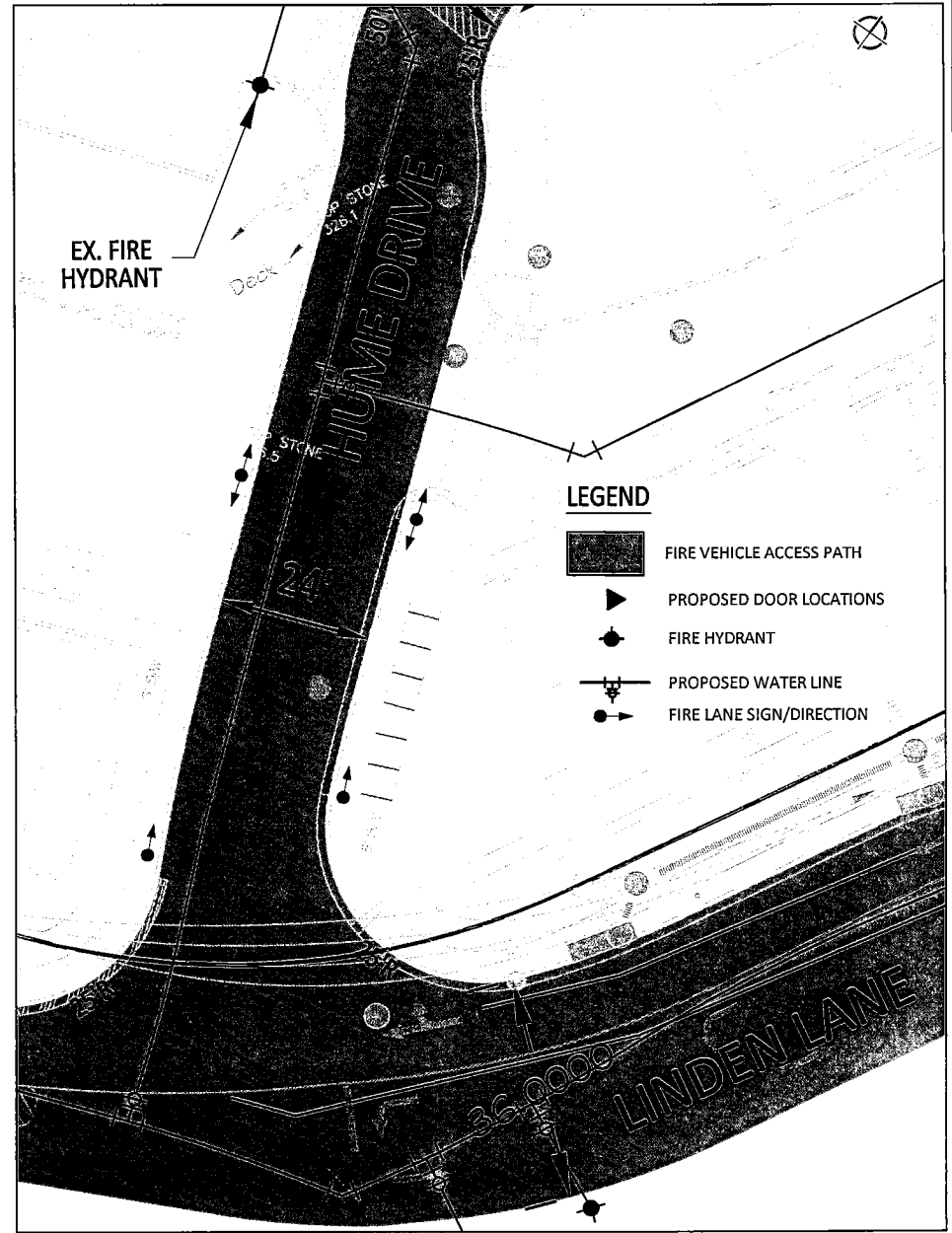

ENLARGEMENT D SCALE: 1"=30'

National Park Seminary - Power Plant Building

MONTGOMERY COUNTY, MARYLAND SUBMISSION: FEBRUARY 2018
 WSSC MAP: 212 NW 03
 TAX MAP: HP562

**FIRE LANE
 ESTABLISHMENT ORDER**

PAGE 3 of 3



VKA MARYLAND, LLC ■
 ENGINEERS ■ PLANNERS ■ LANDSCAPE ARCHITECTS ■
 SURVEYORS ■ SUSTAINABLE DESIGN ■
 20251 CENTURY BOULEVARD SUITE 400 ■
 GERMANTOWN, MD 20874 ■
 (301)916-4100 ■ FAX (301)916-2262 ■
 WWW.VKA.COM ■