



MONTGOMERY COUNTY EXECUTIVE ORDER

Offices of the County Executive • 101 Monroe Street • Rockville, Maryland 20850

Subject Fire Lane Establishment Order for New Birmingham Manor	Executive Order No. 58-18	Subject Suffix
Originating Department Montgomery County Department of Permitting Services	Department Number MCDPS 13-18	Effective Date 3/16/2018

Fire Lane Establishment Order

Pursuant to Section 22 - 33, Montgomery County Code, 1971, as amended, you are hereby notified that a Fire Lane has been established as described in this order. You are hereby ordered to post fire lane signs and paint curbs/pavement (painting optional) as identified below. When signs and paint work (painting optional) have been completed, this order will authorize the enforcement of this Fire Lane by appropriate police and fire officials. Compliance with this order must be achieved within 30 days of receipt.

LOCATION: 15304 Riding Stable Rd.

All areas where indicated by signs and paint.

SIGNS - - (See attached diagram for location of sign placement)



\$250 FINE

FIRE LANE

Signs must be posted so that it is not possible to park a vehicle without being in sight of a sign. Signs may be no further apart than 100 feet

(Red letters on white background)

PAINT - - (See attached diagram if painting).

Paint must be traffic yellow with lines of sufficient width to be readily identifiable/readable by motor vehicle operators.

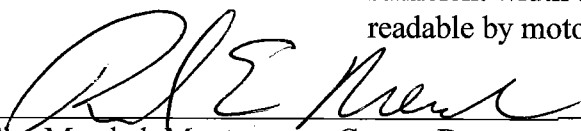

Fire Marshal, Montgomery County Department of Permitting Services

FIRE LANE SIGNAGE & PAINTING PLAN - 1 OF 2

PREPARED BY: BDA



NOTES:

1. SIGNS AND EDGE OF PAVEMENT PAINT TO BE CONSISTENT WITH MONTGOMERY COUNTY FIRE AND RESCUE (MCFR) GUIDELINES.
2. THE SIGNS ARE TO BE ALL-SEASON DURABLE WITH RED REFLECTIVE LETTERING ON A WHITE BACKGROUND.
3. SIGNS MUST BE POSTED SO THAT IT IS NOT POSSIBLE TO PARK A VEHICLE WITHOUT BEING IN SIGHT OF A SIGN. SIGNS MAY BE NO FURTHER APART THAN 100 FEET.
4. PAINT MUST BE TRAFFIC YELLOW WITH LINES OF SUFFICIENT WIDTH TO BE READILY IDENTIFIABLE / READABLE BY MOTOR VEHICLE OPERATORS.
5. PAINTED "NO PARKING" TO BE 3" MINIMUM BLOCK LETTERING IN TRAFFIC YELLOW.

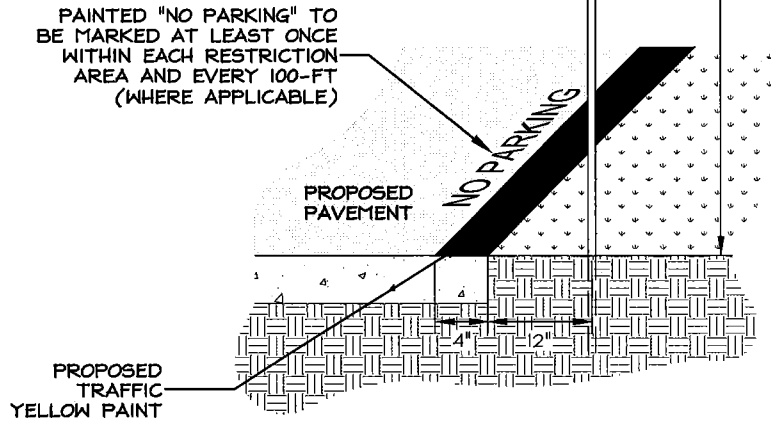

VICINITY MAP

ADC MAP 5168, GRID E-3, SCALE: 1" = 2000'

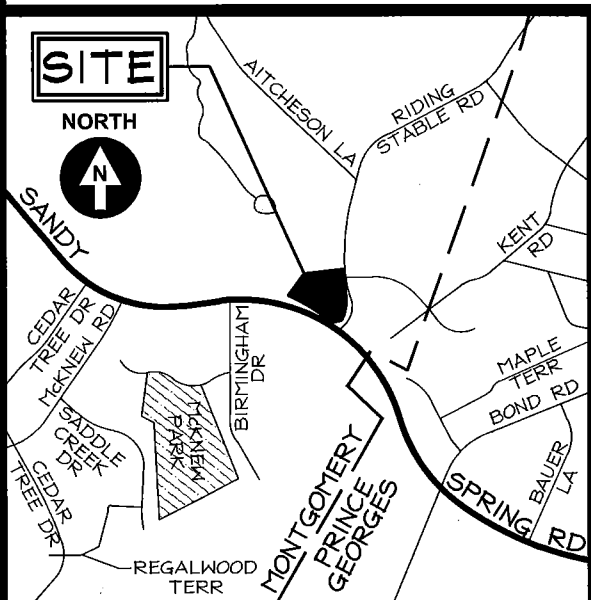

FIRE LANE SIGN PLAN LOT 1, BLOCK F NEW BIRMINGHAM MANOR PLAT NO. 24804

COLESVILLE (5TH) ELECTION DISTRICT
MONTGOMERY COUNTY, MARYLAND

SCALE: N.T.S.
JOB NO.: 09-191

DATE: FEBRUARY, 2018
DRAWN BY: BDA



10 South Bentz Street
Frederick, Maryland 21701
301-607-8031 office
301-607-8045 fax
www.casengineering.com
info@casengineering.com

P:\2009-2009\2009\09191_4800 Sandy Spring Road\6 drawings\09191_SCP & FCP.dwg, 2/9/2018 10:59:24 AM, © 2018 CAS Engineering and CAS Engineering-DC, LLC

FIRE LANE SIGNAGE & PAINTING PLAN - 2 OF 2

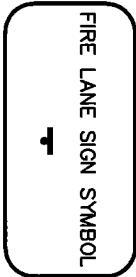

PROP. NO
PARKING SIGN (TYP.)

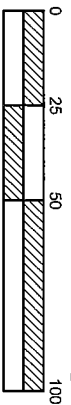
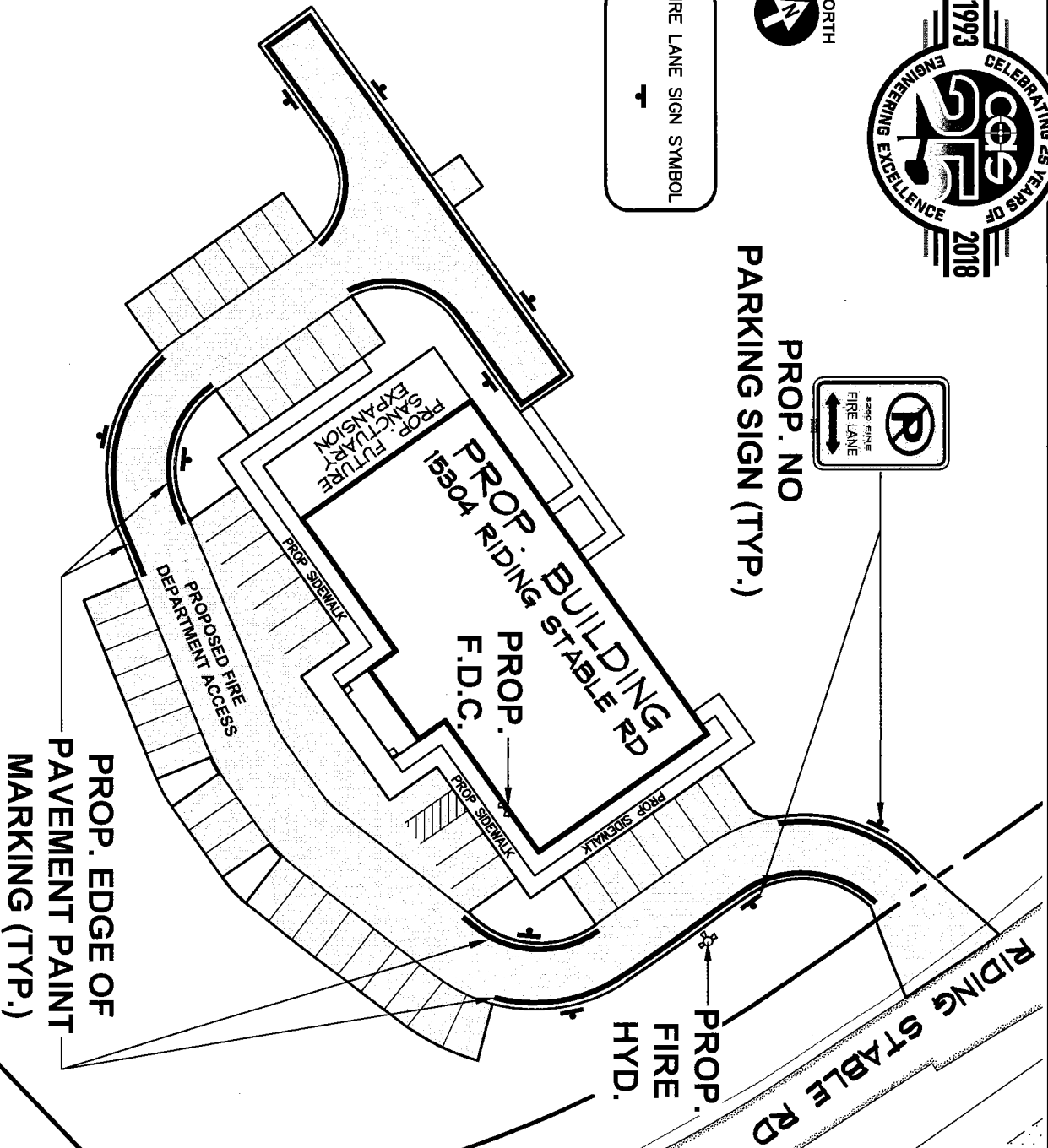

GRAPHIC SCALE
1 INCH = 50 FEET

SANDY SPRING ROAD
MD ROUTE 198

FIRE LANE ORDER FOR
15304 RIDING STABLE ROAD

LOT 1, BLOCK F

NEW BIRMINGHAM MANOR
PLAT NO. 24804

COLESVILLE (5TH) ELECTION DISTRICT
MONTGOMERY COUNTY, MARYLAND

SCALE: 1"=50'
DATE: FEBRUARY, 2018
JOB NO.: 04-191
DRAWN BY: BDA



10 South Bentz Street
Frederick, Maryland 21701
301-607-8031 office
301-607-8045 fax
www.casengineering.com
info@casengineering.com