



MONTGOMERY COUNTY EXECUTIVE ORDER

Offices of the County Executive • 101 Monroe Street • Rockville, Maryland 20850

Subject Fire Lane Establishment Order Jim Coleman Nissan of Silver Spring	Executive Order No. 084-23	Subject Suffix
Originating Department Montgomery County Department of Permitting Services	Department Number MCDPS 9-23	Effective Date 5/1/2023

Fire Lane Establishment Order

Pursuant to Section 22 - 33, Montgomery County Code, 1971, as amended, you are hereby notified that a Fire Lane has been established as described in this order. You are hereby ordered to post fire lane signs and paint curbs/pavement (painting optional) as identified below. When signs and paint work (painting optional) have been completed, this order will authorize the enforcement of this Fire Lane by appropriate police and fire officials. Compliance with this order must be achieved within 30 days of receipt.

LOCATION: 19501 – 19555 Sol Pl
Intersection of Stewartown Rd. & Sol Pl. to end of street

All areas where indicated by signs and paint.

- SIGNS - - (See attached diagram for location of sign placement)



\$250 FINE

FIRE LANE

Signs must be posted so that it is not possible to park a vehicle without being in sight of a sign. Signs may be no further apart than 100 feet

(Red letters on white background)

- PAINT - - (See attached diagram if painting).

Paint must be traffic yellow with lines of sufficient width to be readily identifiable/readable by motor vehicle operators.

Richard E. Merck

Fire Marshal, Montgomery County Department of Permitting Services



MONTGOMERY COUNTY FIRE AND RESCUE SERVICE

Date: April 10, 2023

Fire Lane Establishment Order

Pursuant to Section 22-33, Montgomery County Code, 1971, as amended, you are hereby notified that a Fire Lane has been established as described in this order. You are hereby ordered to post fire lane signs and paint curbs/pavement as identified below. When signs or paint work has been completed, this order will authorize the enforcement of this Fire Lane by appropriate police or fire officials. Compliance with this order must be achieved within 30 days of receipt when any of the following conditions are met:

- One or more structures addressed from the subject road are occupied;
- The road or accessway is available for use and at least one building permit for an address on the subject road has been issued; or
- The road or accessway is necessary fire department access.

LOCATION: Intersection of Stewartown Road and Sol Place to ends of street.
19501 Sol Place - 19555 Sol Place

Delineate all areas where indicated by signs and/or paint.

SIGNS -- (See attached diagram for location of sign placement)



(Red letters on white background)

Signs must be posted so that it is not possible to park a vehicle without being in sight of a sign. Signs may be no further apart than 100 feet.

PAINT -- (See attached diagram when painting is required)

Paint must be traffic yellow with lines of Sufficient width to be readily identifiable/readable by motor vehicle operators.

LS1189

Signature of Order Writer/I.D. #

April 24, 2023

Cc: Fire Code Enforcement Section
Attachment: Fire Lane Diagram

FIRE LANE ESTABLISHMENT FORM

BUILDING OR SUBDIVISION NAME: Bloom MV Area 6A

FIRE LANE LOCATION/ADDRESS: 19501 Sol Place - 19555 Sol Place

See attached drawing for designated fire lanes:

I have received the drawing and instructions for installing the designated fire lanes on property not owned by state or local government.

NAME AND TITLE OF PROPERTY REPRESENTATIVE

NAME: F. Russell Hines TITLE: Authorized Signatory of Monument Realty LLC, Authorized Agent of Property Owner

SIGNATURE: 

PHONE: 202.777.2010 DATE: April 10, 2023

ADDRESS (where processed order will be mailed):

750 17th Street, NW; Suite 1100; Washington, DC 20006

The designated fire lanes are the minimum necessary for fire/rescue access and are in accordance with Section 22-33 of the Fire Safety Code.

NAME: Marie LaBaw SIGNATURE: 

STA.#: DPS I.D.#: LS1189 DATE: April 24, 2023

Comments: _____

Fire Lane Installed Per Order

NAME: _____ DATE: _____

ORDER FOR TRAFFIC CONTROL SIGNS

Pursuant to Section 31-2 and 31-10, Montgomery County Code, 2004 as amended, you are hereby directed to install the following traffic and or parking control devices at the designated location(s).

- | ID# | Signs to Install | Location |
|-----|----------------------|--|
| 1 | No Parking Fire Lane | In Montgomery Village: on the north and south side of proposed Nature Trail, located at the intersection of Nature Trail & Montgomery Village Avenue, and every 200' continuing down the road. |
| 2 | No Parking Fire Lane | In Montgomery Village: on the north and south side of proposed Sol Place, located at the intersection of Sol Place & Stewartown Road, and every 200' continuing down the road. |
| 3 | No Parking Fire Lane | In Montgomery Village: on the west side of the proposed Sol Place, located 444' from the intersection of Sol Place & Stewartown Road, and every 200' along the road. |

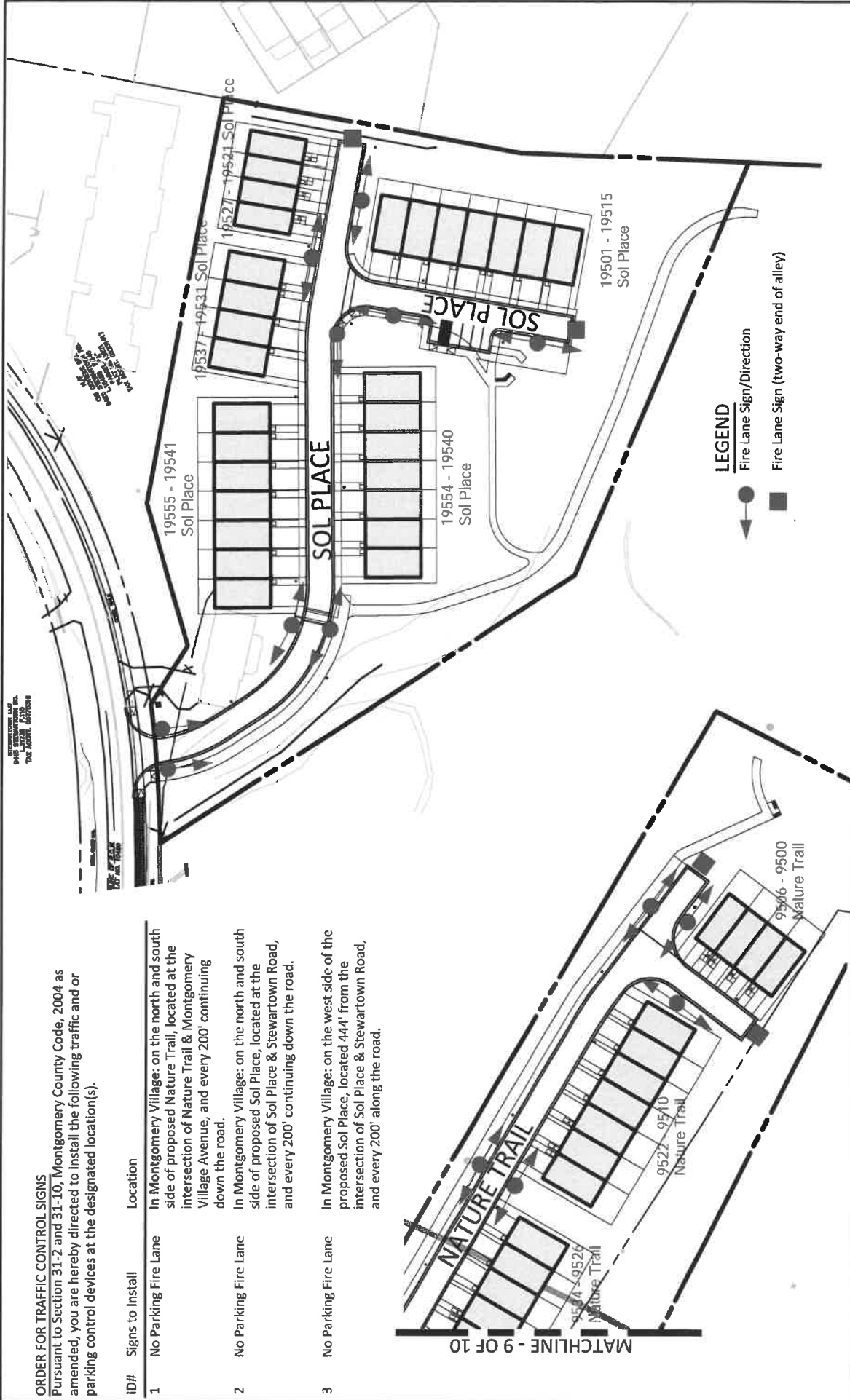

VMA MARYLAND, LLC ■
 ENGINEERS ■ PLANNERS ■ LANDSCAPE ARCHITECTS ■
 SURVEYORS ■ 3D LASER SCANNING ■
 20251 CENTURY BOULEVARD SUITE 400 ■
 GERMANTOWN, MD 20874 ■
 (301) 916-4100 ■ FAX (301) 916-2382 ■
 WWW.VMA.COM ■



BLOOM MV	
WSSC GRID: 227NW09	
TAX MAP: FU342	
9TH ELECTION DISTRICT	
MONTGOMERY COUNTY, MARYLAND	
FIRE LANE ORDER	
DATE: APRIL 10, 2023	
DRAWN: LWA	CHECKED: JS
	10 OF 10

**NATURE TRAIL & SOL PLACE- AREA #6
 FIRE LANE ORDER - NO PARKING SIGN LOCATIONS**