



MONTGOMERY COUNTY EXECUTIVE ORDER

Offices of the County Executive • 101 Monroe Street • Rockville, Maryland 20850

Subject Fire Lane Establishment Order for Jackson Road Elementary School	Executive Order No. 95-17	Subject Suffix
Originating Department Montgomery County Department of Permitting Services	Department Number MCDPS 22-17	Effective Date 06/06/2017

Fire Lane Establishment Order

Pursuant to Section 22 - 33, Montgomery County Code, 1971, as amended, you are hereby notified that a Fire Lane has been established as described in this order. You are hereby ordered to post fire lane signs and paint curbs/pavement (painting optional) as identified below. When signs and paint work (painting optional) have been completed, this order will authorize the enforcement of this Fire Lane by appropriate police and fire officials. Compliance with this order must be achieved within 30 days of receipt.

LOCATION: 900 Jackson Rd

All areas where indicated by signs and paint.

SIGNS -- (See attached diagram for location of sign placement)



\$250 FINE

FIRE LANE

Signs must be posted so that it is not possible to park a vehicle without being in sight of a sign. Signs may be no further apart than 100 feet

(Red letters on white background)

PAINT -- (See attached diagram if painting).

Paint must be traffic yellow with lines of sufficient width to be readily identifiable/readable by motor vehicle operators.

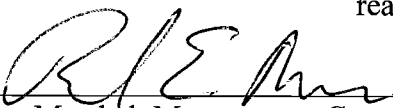

Fire Marshal, Montgomery County Department of Permitting Services

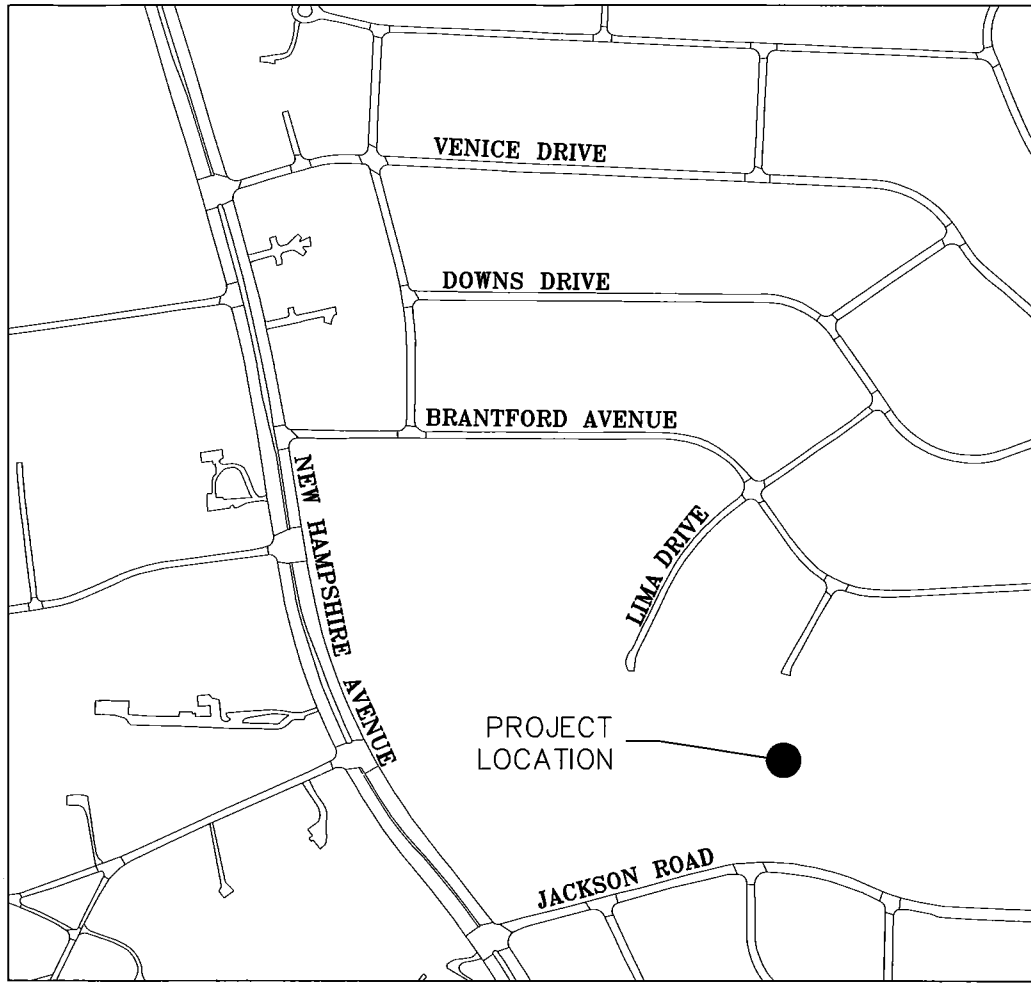

VICINITY MAP

SCALE: 1"=2000'

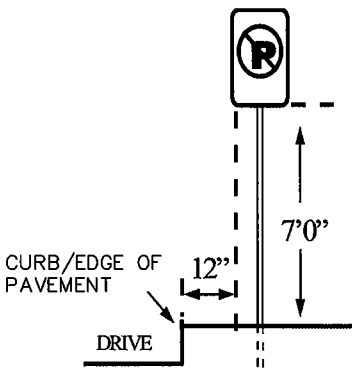

SIGN PLACEMENT DIAGRAM



FIRE LANE SIGNS

GENERAL NOTES:

- SIGNS TO BE CONSISTENT WITH THE MONTGOMERY COUNTY FIRE AND RESCUE (MCFR) GUIDELINES
- FIRE LANE SIGNS TO BE 12" WIDE BY 18" HIGH



Nobis Engineering, Inc.
 20410 Century Blvd Suite 230
 Germantown, MD 20874
 T(301) 528-2010
 www.nobiseng.com
 Client - Focused, Employee - Owned

JACKSON ROAD ELEMENTARY SCHOOL
 900 JACKSON ROAD
 SILVER SPRING, MARYLAND 20904
 FIRE LANE ACCESS PLAN

JOB NO.: 86980.71
 SCALE: 1"=2000'

DATE: JUNE 2017

SHEET NO:
 1 OF 2

300VILLIC, MD 20880
 07/15/2014, MD 20904
 EC

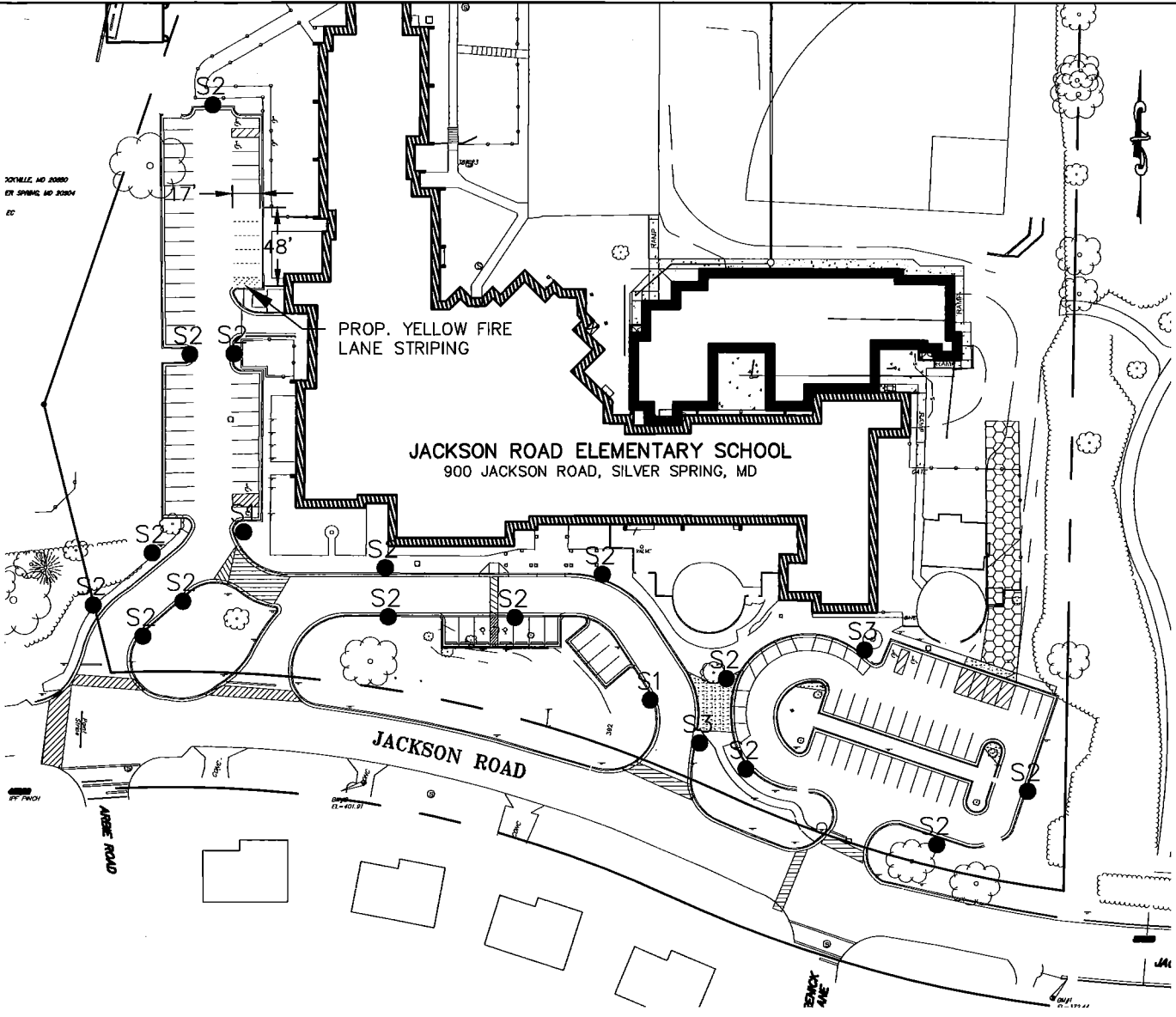

JACKSON ROAD ELEMENTARY SCHOOL
 900 JACKSON ROAD, SILVER SPRING, MD

JACKSON ROAD

FIRE LANE PLAN
 1"=100'

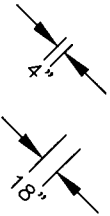

YELLOW, 4" WIDTH, 18"
 SPACING, 45 DEGREE ANGLE

LEGEND

● FIRE LANE SIGN (TYP)

FIRE LANE
 STRIPING DETAIL
 N.T.S.



Engineering a Sustainable Future
 Nobis Engineering, Inc.
 20410 Century Blvd Suite 230
 Germantown, MD 20874
 T(301) 528-2010
 www.nobiseng.com
 Client - Focused, Employee - Owned

JACKSON ROAD ELEMENTARY SCHOOL
 900 JACKSON ROAD
 SILVER SPRING, MARYLAND 20904
 FIRE LANE ACCESS PLAN

JOB NO.: 86980.71

SCALE: 1"=100'

DATE: JUNE 2017

SHEET NO:

2 OF 2