



# MONTGOMERY COUNTY EXECUTIVE ORDER

Offices of the County Executive • 101 Monroe Street • Rockville, Maryland 20850

Subject Fire Lane Establishment Order for Topgolf	Executive Order No. 100-17	Subject Suffix
Originating Department Montgomery County Department of Permitting Services	Department Number MCDPS 25-17	Effective Date 06/16/2017

### Fire Lane Establishment Order

Pursuant to Section 22 - 33, Montgomery County Code, 1971, as amended, you are hereby notified that a Fire Lane has been established as described in this order. You are hereby ordered to post fire lane signs and paint curbs/pavement (painting optional) as identified below. When signs and paint work (painting optional) have been completed, this order will authorize the enforcement of this Fire Lane by appropriate police and fire officials. Compliance with this order must be achieved within 30 days of receipt.

LOCATION: 20051 Century Blvd  
\_\_\_\_\_  
\_\_\_\_\_

All areas where indicated by signs and paint.

SIGNS - - (See attached diagram for location of sign placement)



\$250 FINE

FIRE LANE

Signs must be posted so that it is not possible to park a vehicle without being in sight of a sign. Signs may be no further apart than 100 feet

(Red letters on white background)

PAINT - - (See attached diagram if painting).

Paint must be traffic yellow with lines of sufficient width to be readily identifiable/readable by motor vehicle operators.

  
\_\_\_\_\_  
Fire Marshal, Montgomery County Department of Permitting Services

I:\06158\dwg\FM\_21\_01.dwg, Copyright © 2017 Macris, Hendricks & Glascock, P.A.

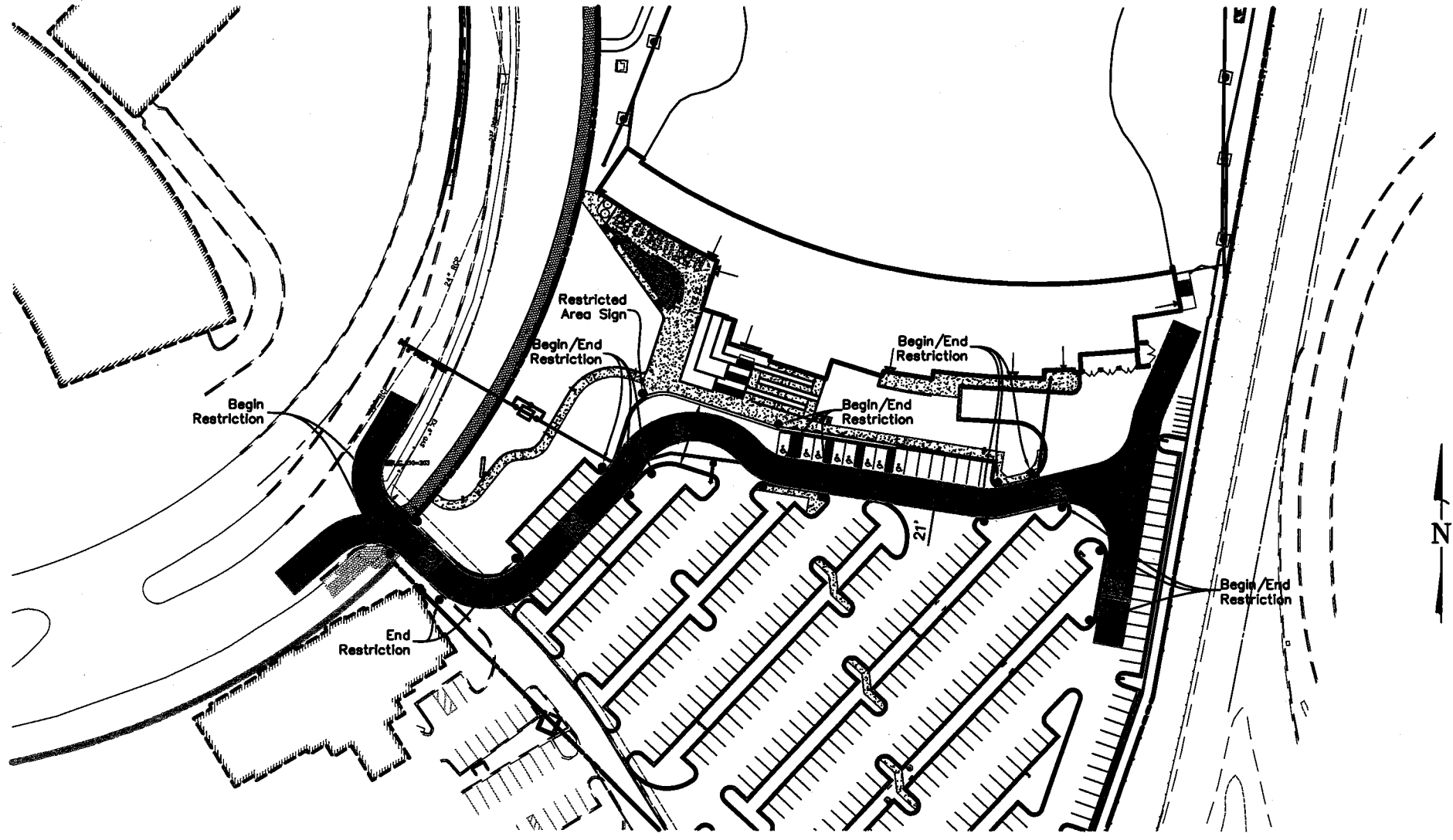

FIRE SIGNAGE PLAN

LEGEND	
FIRE LANE SIGN	●

**MHG** Macris, Hendricks & Glascock, P.A.  
 Engineers • Planners  
 Landscape Architects • Surveyors  
 9220 Wightman Road, Suite 120 Phone 301.670.0840  
 Montgomery Village, Maryland Fax 301.948.0593  
 20886-1279 www.mhnga.com

JOB NO. 2006.158.21

**TOPGOLF-GERMANTOWN**  
**PARCEL X, CENTURY XXI**  
 SCALE: 1"=100' DATE 5/26/17  
 MONTGOMERY COUNTY, MARYLAND

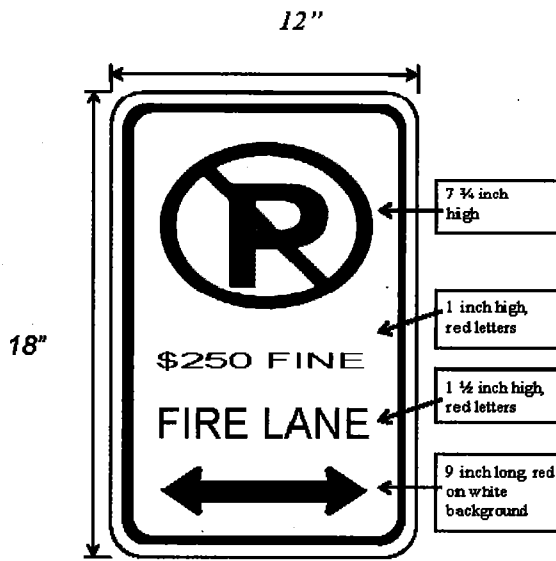

Either type may be used provided the same type is used consistently.

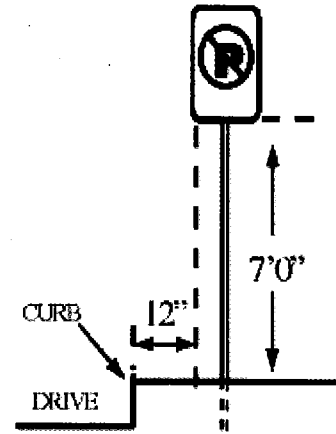
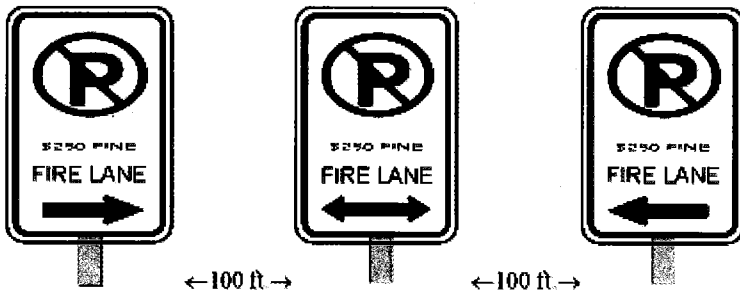

FIRE SIGNAGE DETAILS

I:\06158\dwg\FM\_21\_01.dwg, Copyright © 2017 Macris, Hendricks & Glascock, P.A.