



MONTGOMERY COUNTY EXECUTIVE ORDER

Offices of the County Executive • 101 Monroe Street • Rockville, Maryland 20850

Subject Fire Lane Establishment Order for 4900 Nicholson Court	Executive Order No. 110-18	Subject Suffix
Originating Department Montgomery County Department of Permitting Services	Department Number MCDPS 27-18	Effective Date 5/18/2018

Fire Lane Establishment Order

Pursuant to Section 22 - 33, Montgomery County Code, 1971, as amended, you are hereby notified that a Fire Lane has been established as described in this order. You are hereby ordered to post fire lane signs and paint curbs/pavement (painting optional) as identified below. When signs and paint work (painting optional) have been completed, this order will authorize the enforcement of this Fire Lane by appropriate police and fire officials. Compliance with this order must be achieved within 30 days of receipt.

LOCATION: 4900 Nicholson Ct.

All areas where indicated by signs and paint.

SIGNS -- (See attached diagram for location of sign placement)



\$250 FINE

FIRE LANE

Signs must be posted so that it is not possible to park a vehicle without being in sight of a sign. Signs may be no further apart than 100 feet

(Red letters on white background)

PAINT -- (See attached diagram if painting).

Paint must be traffic yellow with lines of sufficient width to be readily identifiable/readable by motor vehicle operators.

David Borchart

Fire Marshal, Montgomery County Department of Permitting Services

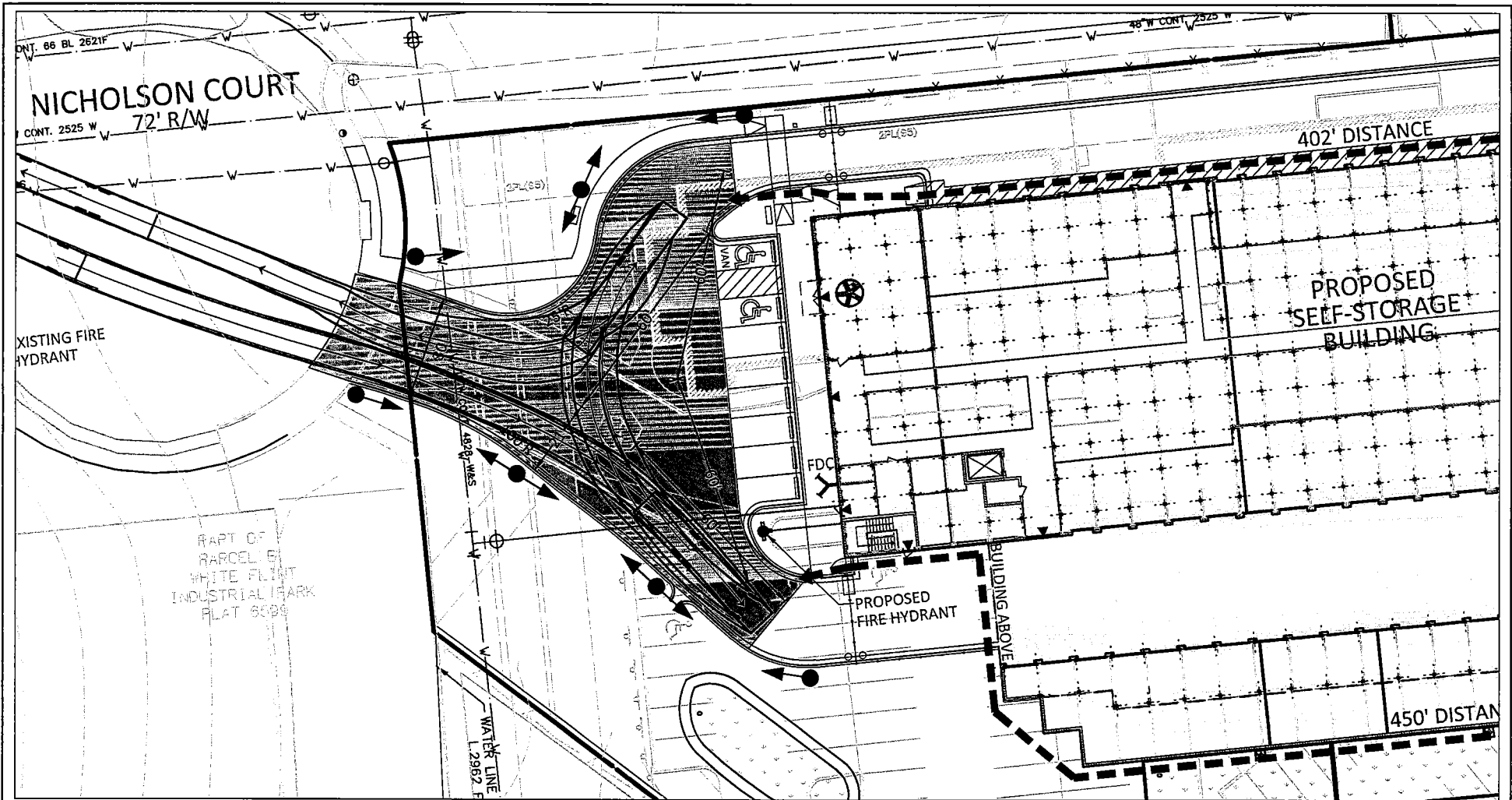

LEGEND
 Fire Lane Sign/Direction



VKA MARYLAND, LLC ■
 ENGINEERS ■ PLANNERS ■ LANDSCAPE ARCHITECTS ■
 SURVEYORS ■ 3D LASER SCANNING ■
 20251 CENTURY BOULEVARD SUITE 400 ■
 GERMANTOWN, MD 20874 ■
 (301)916-4100 ■ FAX (301)916-2262 ■
 WWW.VKA.COM ■

4900 NICHOLSON COURT

WSSC GRID: 215NW05
 TAX MAP: HQ22
 4TH ELECTION DISTRICT
 MONTGOMERY COUNTY, MARYLAND

FIRE LANE ORDER

DATE: MAY 7, 2018

DRAWN: KO

CHECKED: CB

1 OF 1



0 20 40 80

SCALE: 1" = 40'

FIRE LANE ORDER - NO PARKING SIGN LOCATIONS