



MONTGOMERY COUNTY EXECUTIVE ORDER

Offices of the County Executive • 101 Monroe Street • Rockville, Maryland 20850

Subject Fire Lane Establishment Order for Qiagen Campus at Germantown	Executive Order No. 114-13	Subject Suffix
Originating Department Montgomery County Fire and Rescue Service	Department Number MCFRS 18-13	Effective Date 6/21/2013

Fire Lane Establishment Order

Pursuant to Section 22 - 33, Montgomery County Code, 1971, as amended, you are hereby notified that a Fire Lane has been established as described in this order. You are hereby ordered to post fire lane signs and paint curbs/pavement (painting optional) as identified below. When signs and paint work (painting optional) have been completed, this order will authorize the enforcement of this Fire Lane by appropriate police and fire officials. Compliance with this order must be achieved within 30 days of receipt.

LOCATION: 19300 Germantown Rd.

All areas where indicated by signs and paint.

- SIGNS - - (See attached diagram for location of sign placement)



\$250 FINE

FIRE LANE

Signs must be posted so that it is not possible to park a vehicle without being in sight of a sign. Signs may be no further apart than 100 feet





(Red letters on white background)

- PAINT - - (See attached diagram if painting).

Paint must be traffic yellow with lines of sufficient width to be readily identifiable/readable by motor vehicle operators.

Fire Chief, Montgomery County Fire and Rescue Service

LEGEND

-  PROPOSED FIRE LANE SIGN (DOUBLE ARROW)
-  PROPOSED FIRE LANE SIGN (ARROW POINTING LEFT)
-  PROPOSED FIRE LANE SIGN (ARROW POINTING RIGHT)
-  PROPOSED FIRE LANE SIGN (NO ARROW)

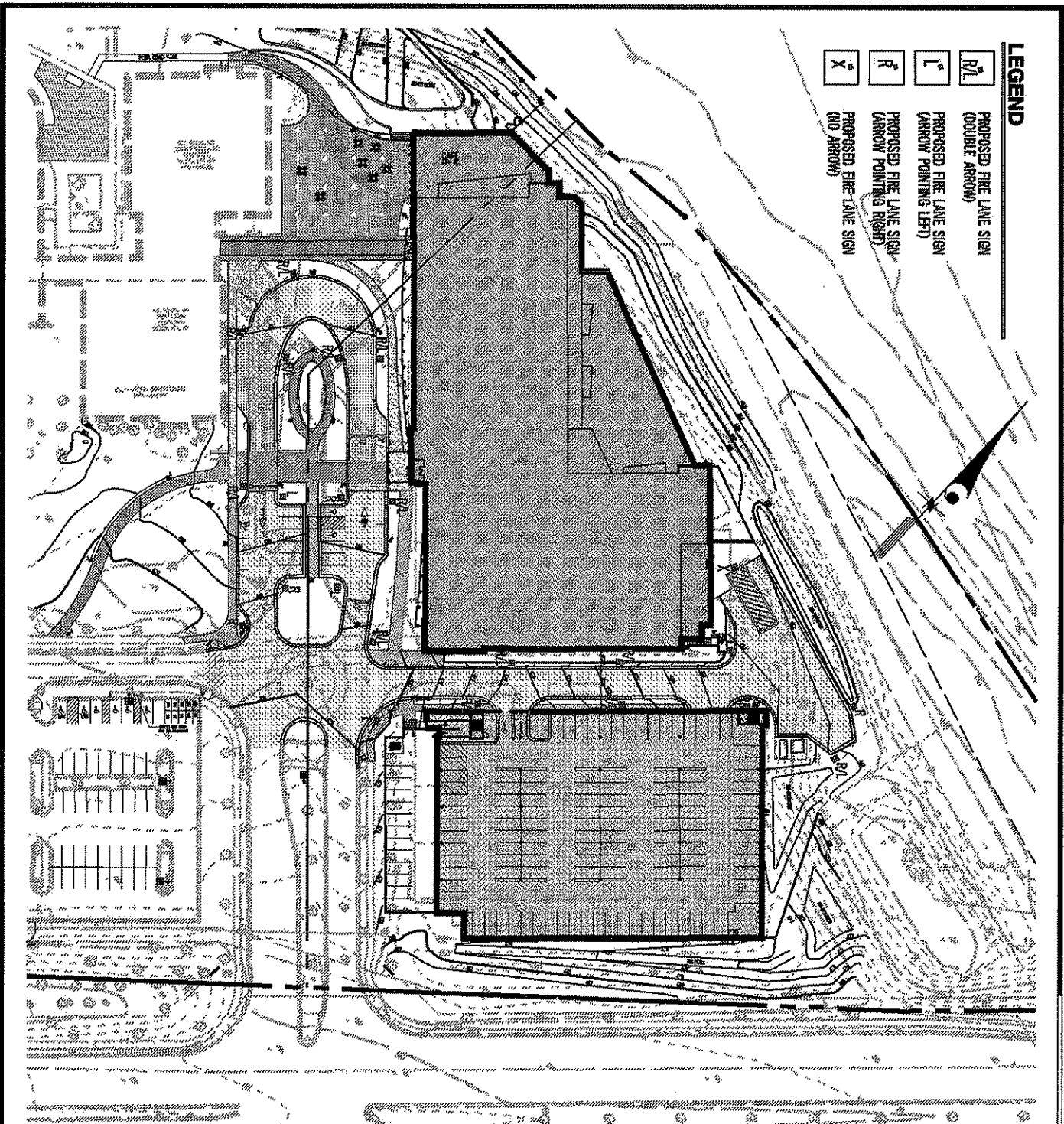

GERMANTOWN ROAD (MD. ROUTE 118)



SCALE: 1" = 100'



GREENHORNE & O'MARA
 CONSULTING ENGINEERS
 20410 CENTURY BOULEVARD, SUITE 200
 GERMANTOWN, MARYLAND 20874
 PHONE: (301) 444-8282 FAX: (301) 444-8181
 www.g-and-o.com

MC-F&R SIGNAGE PLAN

OLIGEN
 CAMPUS AT GERMANTOWN
 LOTS 5 & 6

MONTGOMERY COUNTY, MARYLAND

DESIGN	SCALE	1" = 100'	
DK	1	OF 2	
DRAWN			
CHECKED	SHEET		
JUNE 2013	0721-89	PROJ No.	FILE No.
DATE			

		GREENHORNE & O'MARA CONSULTING ENGINEERS 20410 CENTURY BOULEVARD, SUITE 200 GERMANTOWN, MARYLAND 20874 PHONE (301) 444-8382 FAX (301) 444-8181 WWW.G-and-O.com	MONTGOMERY COUNTY, MARYLAND CAMPUS AT GERMANTOWN LOTS 5 & 6 OLIAGEN MC-F&R SIGNAGE PLAN
DESIGN DATE HEREIN JUNE 2013	CHECKED DATE JUNE 2013	FILE NO. 0721-89	SCALE NOT TO SCALE
DRAWN 7 OF 7	SHEET 7 OF 7		

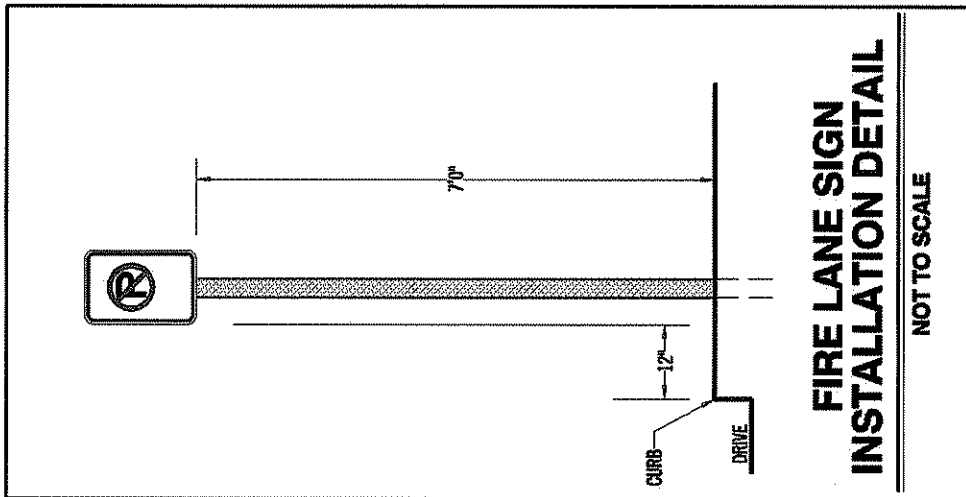
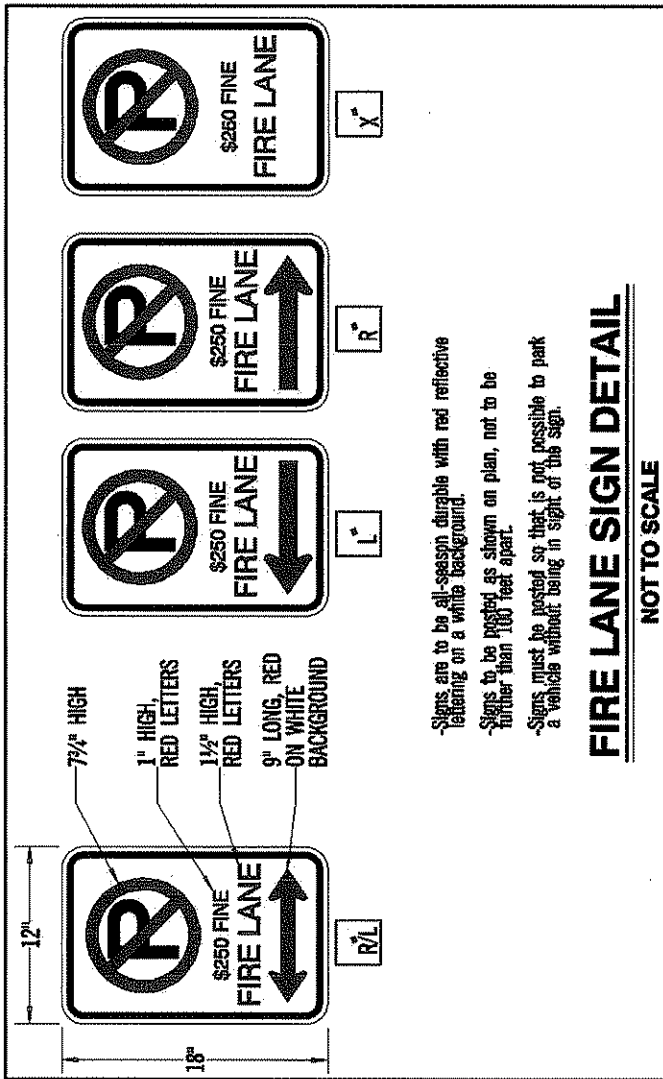
FIRE LANE SIGN DETAIL

NOT TO SCALE

Signs are to be all-season durable with red reflective lettering on a white background.

Signs to be posted as shown on plan, not to be further than 100 feet apart.

Signs must be posted so that is not possible to park a vehicle without being in sight of this sign.

7/8" HIGH
 1" HIGH, RED LETTERS
 1 1/2" HIGH, RED LETTERS
 9" LONG, RED ON WHITE BACKGROUND