



MONTGOMERY COUNTY EXECUTIVE ORDER

Offices of the County Executive • 101 Monroe Street • Rockville, Maryland 20850

Subject Fire Lane Establishment Woodward High School	Executive Order No. 117-23	Subject Suffix
Originating Department Montgomery County Department of Permitting Services	Department Number MCDPS 12-23	Effective Date 7/11/2023

Fire Lane Establishment Order

Pursuant to Section 22 - 33, Montgomery County Code, 1971, as amended, you are hereby notified that a Fire Lane has been established as described in this order. You are hereby ordered to post fire lane signs and paint curbs/pavement (painting optional) as identified below. When signs and paint work (painting optional) have been completed, this order will authorize the enforcement of this Fire Lane by appropriate police and fire officials. Compliance with this order must be achieved within 30 days of receipt.

LOCATION: 11211 Old Georgetown Rd.
Supersedes fire lane order 034-22

All areas where indicated by signs and paint.

- SIGNS -- (See attached diagram for location of sign placement)



Signs must be posted so that it is not possible to park a vehicle without being in sight of a sign. Signs may be no further apart than 100 feet

(Red letters on white background)

- PAINT -- (See attached diagram if painting).

Paint must be traffic yellow with lines of sufficient width to be readily identifiable/readable by motor vehicle operators.

Richard E. Merck

Fire Marshal, Montgomery County Department of Permitting Services



MONTGOMERY COUNTY FIRE AND RESCUE SERVICE

Date: 12/22/20

Fire Lane Establishment Order

Pursuant to Section 22-33, Montgomery County Code, 1971, as amended, you are hereby notified that a Fire Lane has been established as described in this order. You are hereby ordered to post fire lane signs and paint curbs/pavement as identified below. When signs or paint work has been completed, this order will authorize the enforcement of this Fire Lane by appropriate police or fire officials. Compliance with this order must be achieved within 30 days of receipt when any of the following conditions are met:

- One or more structures addressed from the subject road are occupied;
- The road or accessway is available for use and at least one building permit for an address on the subject road has been issued; or
- The road or accessway is necessary fire department access.

LOCATION: 11211 Old Georgetown Road
Rockville Maryland 20852

Delineate all areas where indicated by signs and/or paint.

SIGNS -- (See attached diagram for location of sign placement)



(Red letters on white background)

Signs must be posted so that it is not possible to park a vehicle without being in sight of a sign. Signs may be no further apart than 100 feet.

PAINT -- (See attached diagram when painting is required)

Paint must be traffic yellow with lines of Sufficient width to be readily identifiable/readable by motor vehicle operators.

LS1189

Signature of Order Writer/I.D. #

July 2, 2023

Cc: Fire Code Enforcement Section
Attachment: Fire Lane Diagram

FIRE LANE ESTABLISHMENT FORM

BUILDING OR SUBDIVISION NAME: Woodward High School

FIRE LANE LOCATION/ADDRESS: 11211 Old Georgetown Road
Rockville Maryland 20852

See attached drawing for designated fire lanes:

I have received the drawing and instructions for installing the designated fire lanes on property not owned by state or local government.

NAME AND TITLE OF PROPERTY REPRESENTATIVE

NAME: Gary Mosesman TITLE: Director, Division of Design and Construction

SIGNATURE: 

PHONE: 240 314 1000 DATE: 12/22/20

ADDRESS (where processed order will be mailed):

45 West Gude Drive, Suite 4300, Rockville MD 20850

The designated fire lanes are the minimum necessary for fire/rescue access and are in accordance with Section 22-33 of the Fire Safety Code.

NAME: Marie LaBaw SIGNATURE: 

STA.#: DPS I.D.#: LS1189 DATE: July 2, 2023

Comments: _____

Fire Lane Installed Per Order

NAME: _____ DATE: _____

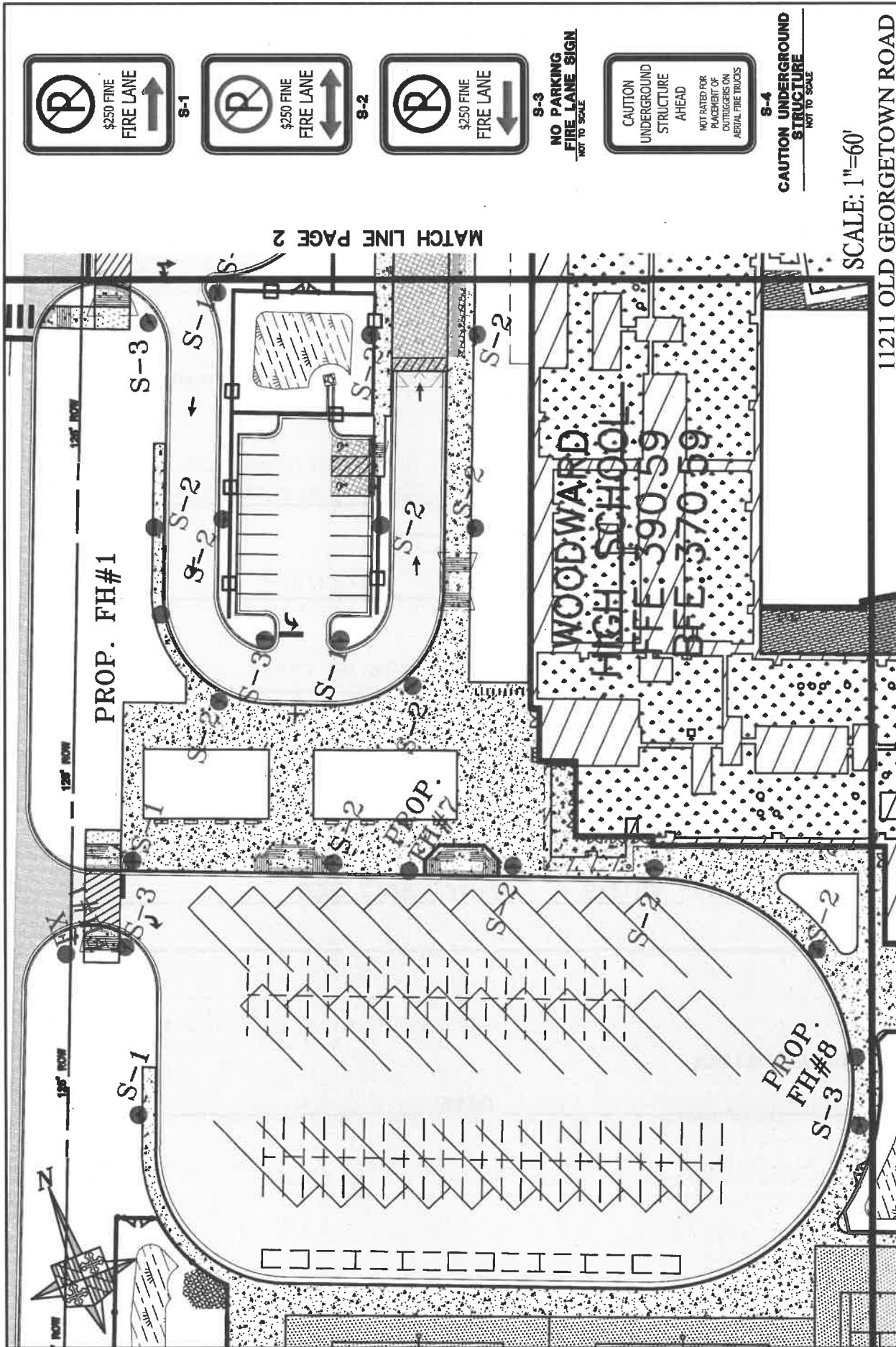

MATCH LINE PAGE 3

- SIGNING AND STRIPING NOTES:**
1. ALL SIGNS SHOWN HEREON SHALL BE FIRE MARSHALL APPROVED SIGNS. SEE DETAIL THIS SHEET.
 2. FIRE LANE SIGNS SHALL BE 12" WIDE AND 18" HIGH.

11211 OLD GEORGETOWN ROAD
ROCKVILLE, MD 20852

SCALE: 1"=60'

**FIRELANE
ORDER 1 OF 4**



S-1



S-2



S-3

**NO PARKING
FIRE LANE SIGN
NOT TO SCALE**



S-4

**CAUTION UNDERGROUND
STRUCTURE
AHEAD**
NOT TO SCALE

MATCH LINE PAGE 2

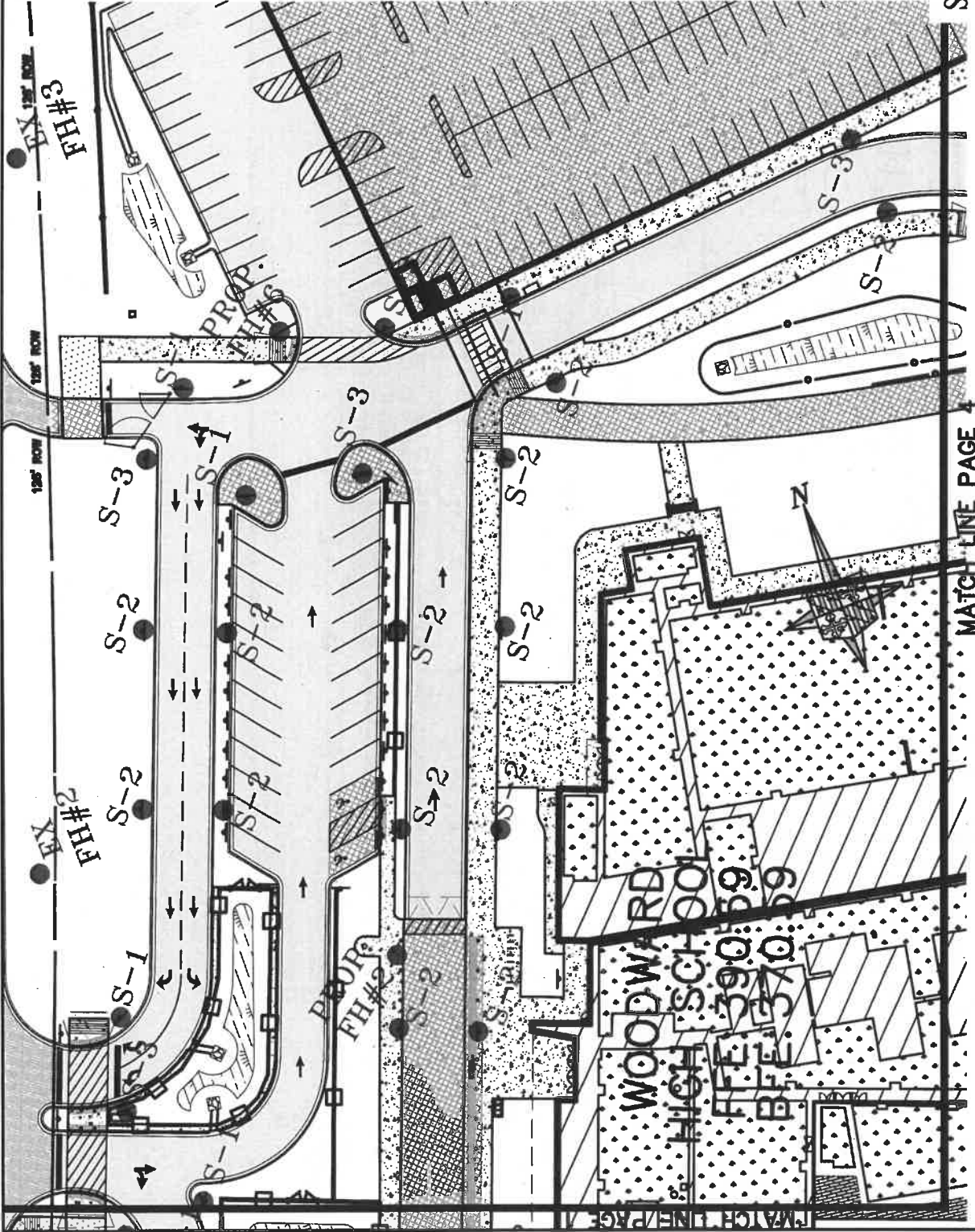

S-1



S-2



S-3

NO PARKING
FIRE LANE SIGN
NOT TO SCALE



S-4

CAUTION UNDERGROUND
STRUCTURE
AHEAD
NOT RATED FOR
PLACEMENT OF
COURTESERS ON
ASPHALT FIRE TRUCKS

SCALE: 1"=60'

11211 OLD GEORGETOWN ROAD
ROCKVILLE, MD 20852

**FIRELANE
ORDER 2 OF 4**

- SIGNING AND STRIPING NOTES:**
1. ALL SIGNS SHOWN HEREON SHALL BE FIRE MARSHALL APPROVED SIGNS. SEE DETAIL THIS SHEET.
 2. FIRE LANE SIGNS SHALL BE 12" WIDE AND 18" HIGH.

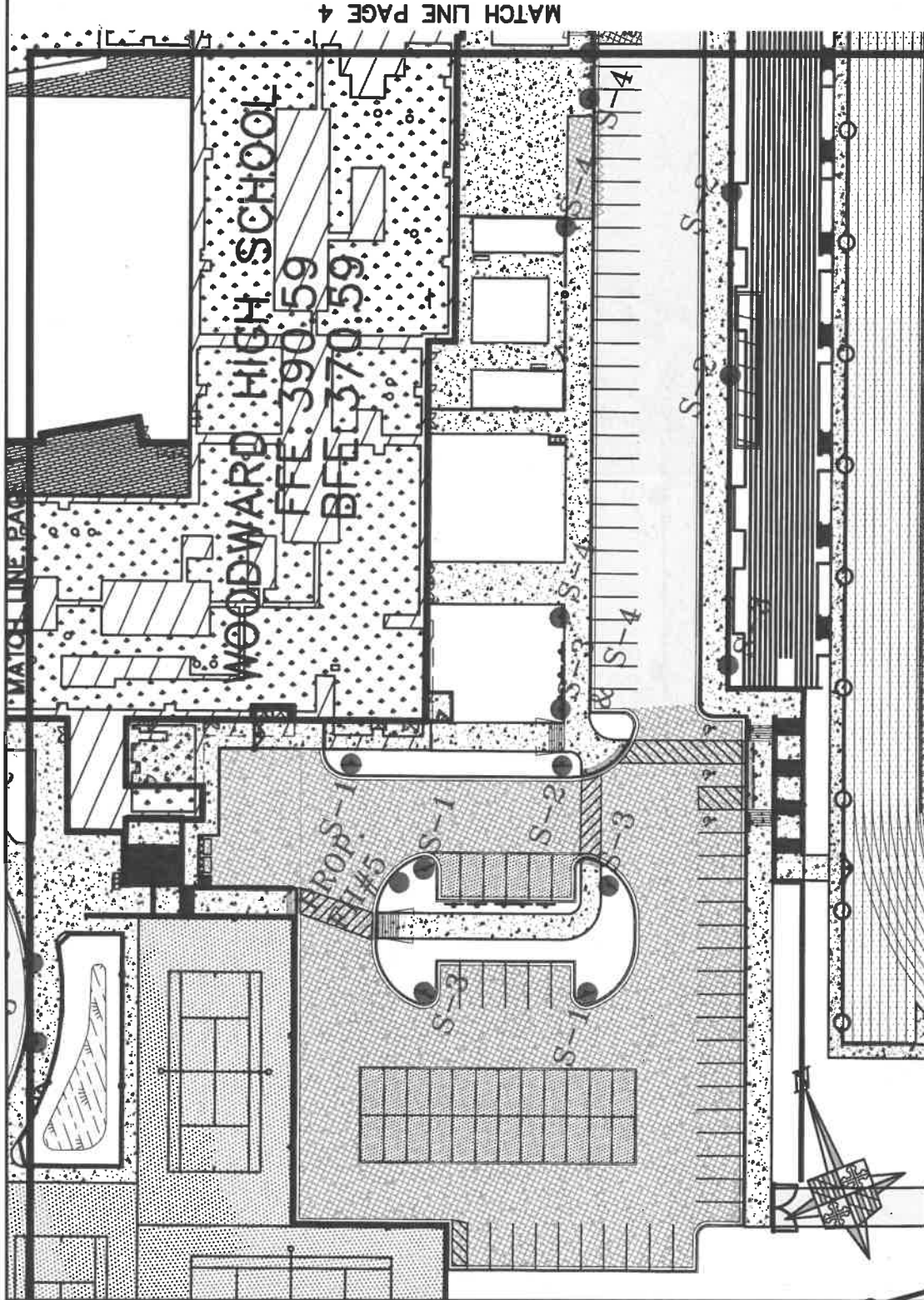

S-1



S-2



S-3

NO PARKING
FIRE LANE SIGN
NOT TO SCALE



S-4

CAUTION UNDERGROUND
STRUCTURE
AHEAD
NOT RATED FOR
PLACEMENT OF
OUTRIGGERS ON
AERIAL FIRE TRUCKS

SCALE: 1"=60'

11211 OLD GEORGETOWN ROAD
ROCKVILLE, MD 20852

SIGNING AND STRIPING NOTES:

1. ALL SIGNS SHOWN HEREON SHALL BE FIRE MARSHALL APPROVED SIGNS. SEE DETAIL THIS SHEET.
2. FIRE LANE SIGNS SHALL BE 12" WIDE AND 18" HIGH.

**FIRELANE
ORDER 3 OF 4**



S-1



S-2



S-3

**NO PARKING
FIRE LANE SIGN
NOT TO SCALE**



S-4

**CAUTION UNDERGROUND
STRUCTURE
AHEAD
NOT TO SCALE**

SCALE: 1"=60'

11211 OLD GEORGETOWN ROAD
ROCKVILLE, MD 20852

**FIRELANE
ORDER 4 OF 4**

- SIGNING AND STRIPING NOTES:**
1. ALL SIGNS SHOWN HEREON SHALL BE FIRE MARSHALL APPROVED SIGNS. SEE DETAIL THIS SHEET.
 2. FIRE LANE SIGNS SHALL BE 12" WIDE AND 18" HIGH.

