



MONTGOMERY COUNTY EXECUTIVE ORDER

Offices of the County Executive • 101 Monroe Street • Rockville, Maryland 20850

Subject Fire Lane Establishment Order Washington Waldorf School	Executive Order No. 118-19	Subject Suffix
Originating Department Montgomery County Department of Permitting Services	Department Number MCDPS 18-19	Effective Date 6/11/2019

Fire Lane Establishment Order

Pursuant to Section 22 - 33, Montgomery County Code, 1971, as amended, you are hereby notified that a Fire Lane has been established as described in this order. You are hereby ordered to post fire lane signs and paint curbs/pavement (painting optional) as identified below. When signs and paint work (painting optional) have been completed, this order will authorize the enforcement of this Fire Lane by appropriate police and fire officials. Compliance with this order must be achieved within 30 days of receipt.

LOCATION: 4800 Sangamore Rd.

All areas where indicated by signs and paint.

SIGNS - - (See attached diagram for location of sign placement)



\$250 FINE

FIRE LANE

Signs must be posted so that it is not possible to park a vehicle without being in sight of a sign. Signs may be no further apart than 100 feet

(Red letters on white background)

PAINT - - (See attached diagram if painting).

Paint must be traffic yellow with lines of sufficient width to be readily identifiable/readable by motor vehicle operators.



Fire Marshal, Montgomery County Department of Permitting Services

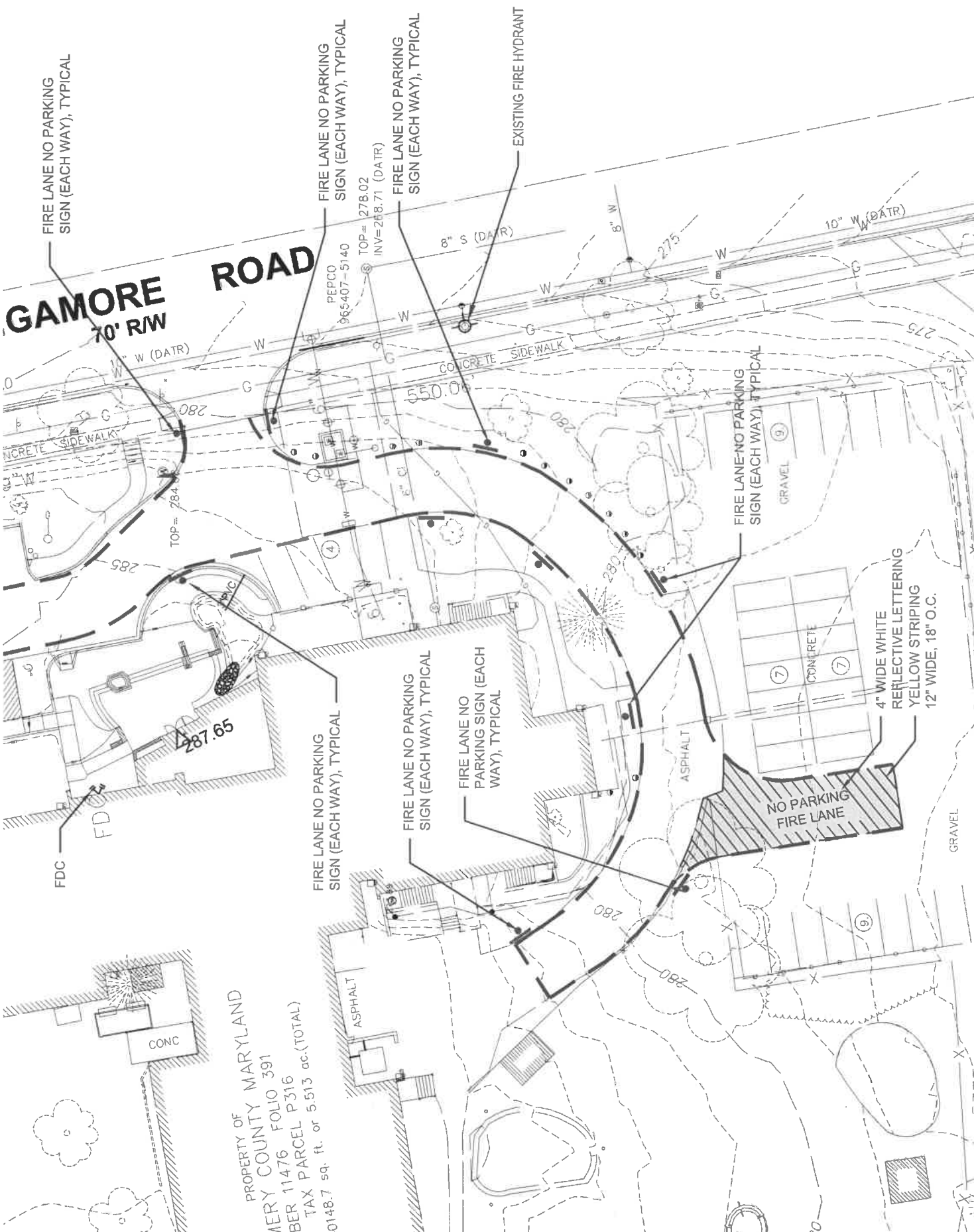

FIRE LANE NO PARKING SIGN (EACH WAY), TYPICAL

GAMORE ROAD

70' R/W

FIRE LANE NO PARKING SIGN (EACH WAY), TYPICAL

FIRE LANE NO PARKING SIGN (EACH WAY), TYPICAL

EXISTING FIRE HYDRANT

FIRE LANE NO PARKING SIGN (EACH WAY), TYPICAL

FIRE LANE NO PARKING SIGN (EACH WAY), TYPICAL

FIRE LANE NO PARKING SIGN (EACH WAY), TYPICAL

NO PARKING FIRE LANE

4" WIDE WHITE REFLECTIVE LETTERING YELLOW STRIPING 12" WIDE, 18" O.C.

PROPERTY OF MARYLAND
 MARY COUNTY FOLIO 391
 MBER 11476 FOLIO P316
 TAX PARCEL P316
 40148.7 sq. ft. or 5.513 ac. (TOTAL)

06/06/19

SCALE: 1" = 40'

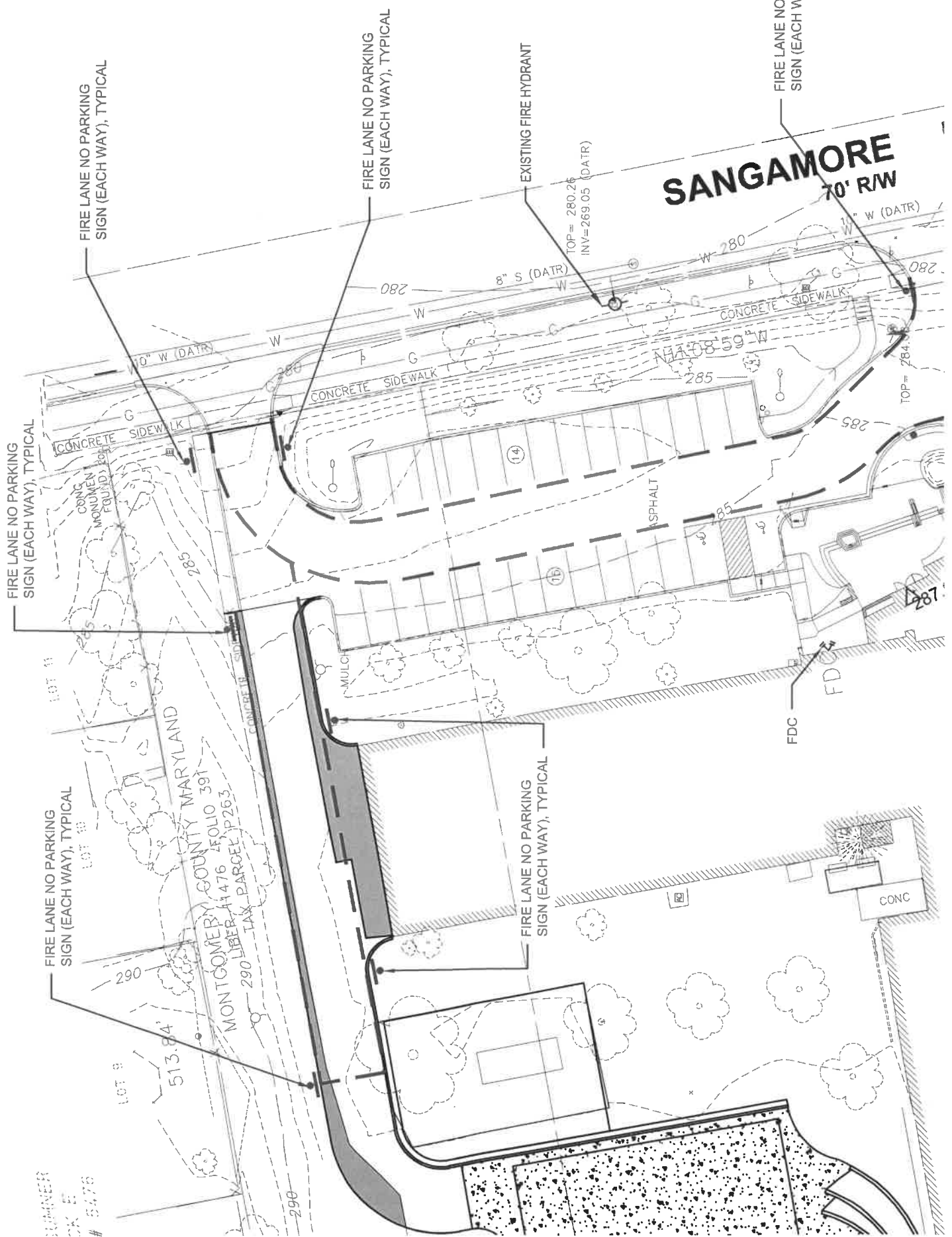

06/06/19

SCALE: 1" = 40'

3100 WEST
 OAK E
 # 5576

LOT 9
 513.84'
 MONTGOMERY COUNTY MARYLAND
 LIBER 4476 FOLIO 391
 TAX PARCEL P263

CONC

FDC

FDC

ASPHALT

CONCRETE SIDEWALK

CONCRETE SIDEWALK

EXISTING FIRE HYDRANT
 TOP= 280.26
 INV=269.05 (DATR)

FIRE LANE NO PARKING
 SIGN (EACH WAY), TYPICAL

FIRE LANE NO PARKING
 SIGN (EACH WAY), TYPICAL

FIRE LANE NO PARKING
 SIGN (EACH WAY), TYPICAL

FIRE LANE NO PARKING
 SIGN (EACH WAY), TYPICAL

FIRE LANE NO PARKING
 SIGN (EACH WAY), TYPICAL

FIRE LANE NO PARKING
 SIGN (EACH WAY), TYPICAL

10' W (DATR)

280

8" S (DATR)

280

70' R/W

10' W (DATR)

280

TOP= 280.26

287

14'08'59" W

285

285

285

LOT 11

LOT 10

LOT 8

290

290

MULCH

FDC