



MONTGOMERY COUNTY EXECUTIVE ORDER

Offices of the County Executive • 101 Monroe Street • Rockville, Maryland 20850

Subject Fire Lane Establishment Order for The Mansion at Strathmore	Executive Order No. 126-17	Subject Suffix
Originating Department Montgomery County Department of Permitting Services	Department Number MCDPS 35-17	Effective Date 08/02/2017

Fire Lane Establishment Order

Pursuant to Section 22 - 33, Montgomery County Code, 1971, as amended, you are hereby notified that a Fire Lane has been established as described in this order. You are hereby ordered to post fire lane signs and paint curbs/pavement (painting optional) as identified below. When signs and paint work (painting optional) have been completed, this order will authorize the enforcement of this Fire Lane by appropriate police and fire officials. Compliance with this order must be achieved within 30 days of receipt.

LOCATION: 10701 Rockville Pike

All areas where indicated by signs and paint.

SIGNS - - (See attached diagram for location of sign placement)



\$250 FINE

FIRE LANE

Signs must be posted so that it is not possible to park a vehicle without being in sight of a sign. Signs may be no further apart than 100 feet

(Red letters on white background)

PAINT - - (See attached diagram if painting).

Paint must be traffic yellow with lines of sufficient width to be readily identifiable/readable by motor vehicle operators.

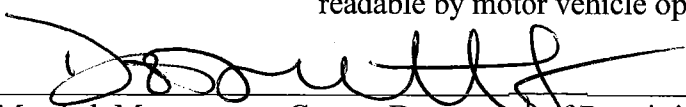

Fire Marshal, Montgomery County Department of Permitting Services

Environmental Sciences
Engineering
Planning

ROCKVILLE OFFICE
2 Research Place, Suite 100
Rockville, MD 20850
P. 301.948.2750 F. 301.948.9067



Rockville
Lanham
Waldorf
Leondtown
www.soltesz.com

JOB NO. 0184-56-00

SCALE 1" = 80'

DATE JULY 2017

FIRE LANE SIGN PLAN THE MANSION AT STRATHMORE 10701 ROCKVILLE PIKE NORTH BETHESDA, MD 20852

SHEET 1 OF 1

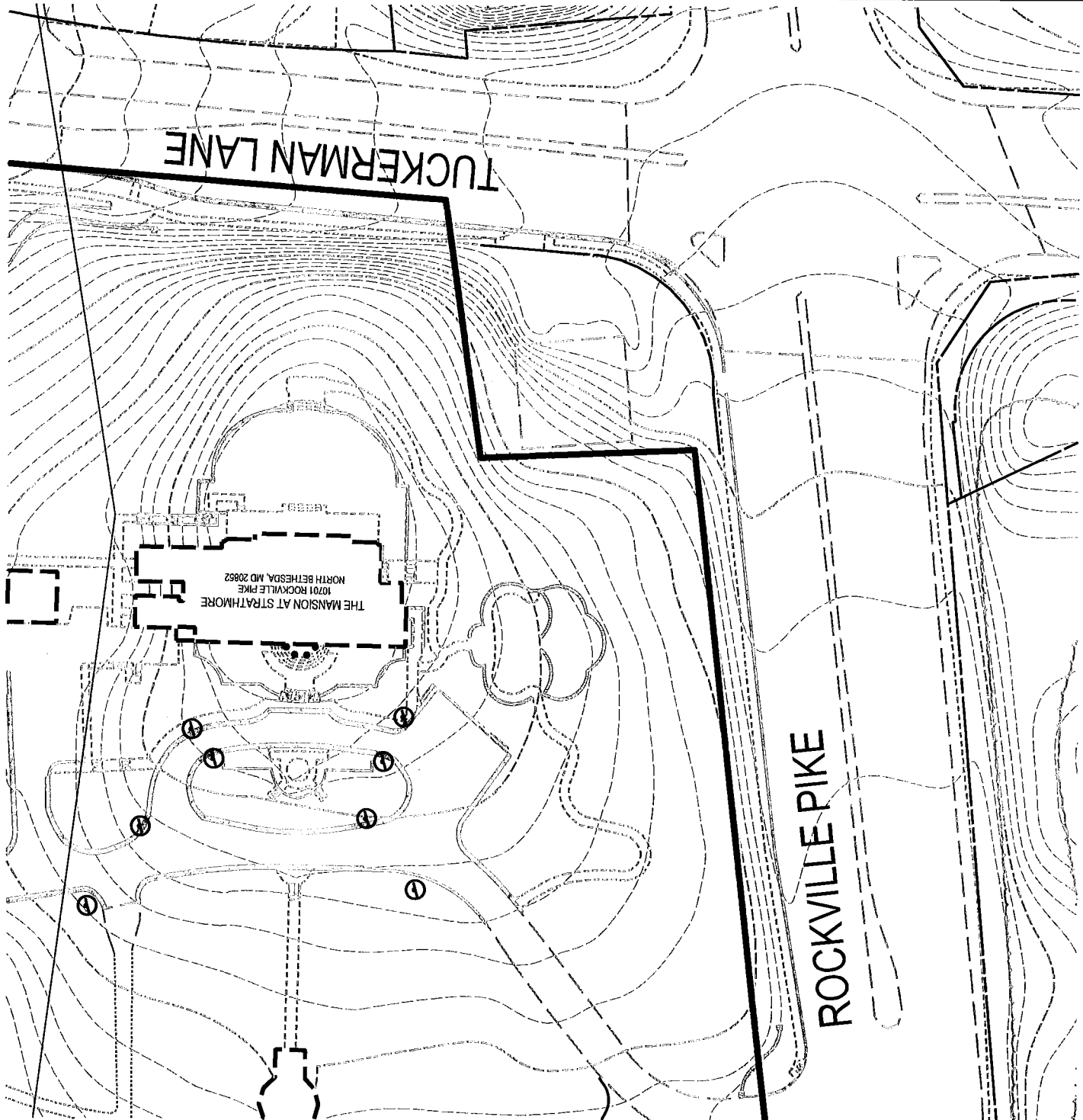

FIRE LANE NO PARKING SIGN DETAILS

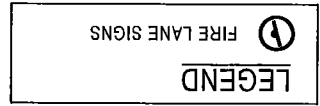

P:\01845600\ENGINEER\PAV\STORM\Fire Lane Order\Fire Order Plan-mansion.sht Scale= 80,0000 ft / in. User= EOrtega-Alay PLT\ave PDF Grev 150.plt\cjo Pentb= TEXT SUB.tbl 7/21/2017 3:32:01 PM