



MONTGOMERY COUNTY EXECUTIVE ORDER

Offices of the County Executive • 101 Monroe Street • Rockville, Maryland 20850

Subject Fire Lane Establishment Order Flower Valley Elementary School	Executive Order No. 131-19	Subject Suffix
Originating Department Montgomery County Department of Permitting Services	Department Number MCDPS 22-19	Effective Date 7/18/2019

Fire Lane Establishment Order

Pursuant to Section 22 - 33, Montgomery County Code, 1971, as amended, you are hereby notified that a Fire Lane has been established as described in this order. You are hereby ordered to post fire lane signs and paint curbs/pavement (painting optional) as identified below. When signs and paint work (painting optional) have been completed, this order will authorize the enforcement of this Fire Lane by appropriate police and fire officials. Compliance with this order must be achieved within 30 days of receipt.

LOCATION: 4615 Sunflower Dr.

All areas where indicated by signs and paint.

SIGNS - - (See attached diagram for location of sign placement)



\$250 FINE

FIRE LANE

Signs must be posted so that it is not possible to park a vehicle without being in sight of a sign. Signs may be no further apart than 100 feet

(Red letters on white background)

PAINT - - (See attached diagram if painting).

Paint must be traffic yellow with lines of sufficient width to be readily identifiable/readable by motor vehicle operators.

Fire Marshal, Montgomery County Department of Permitting Services

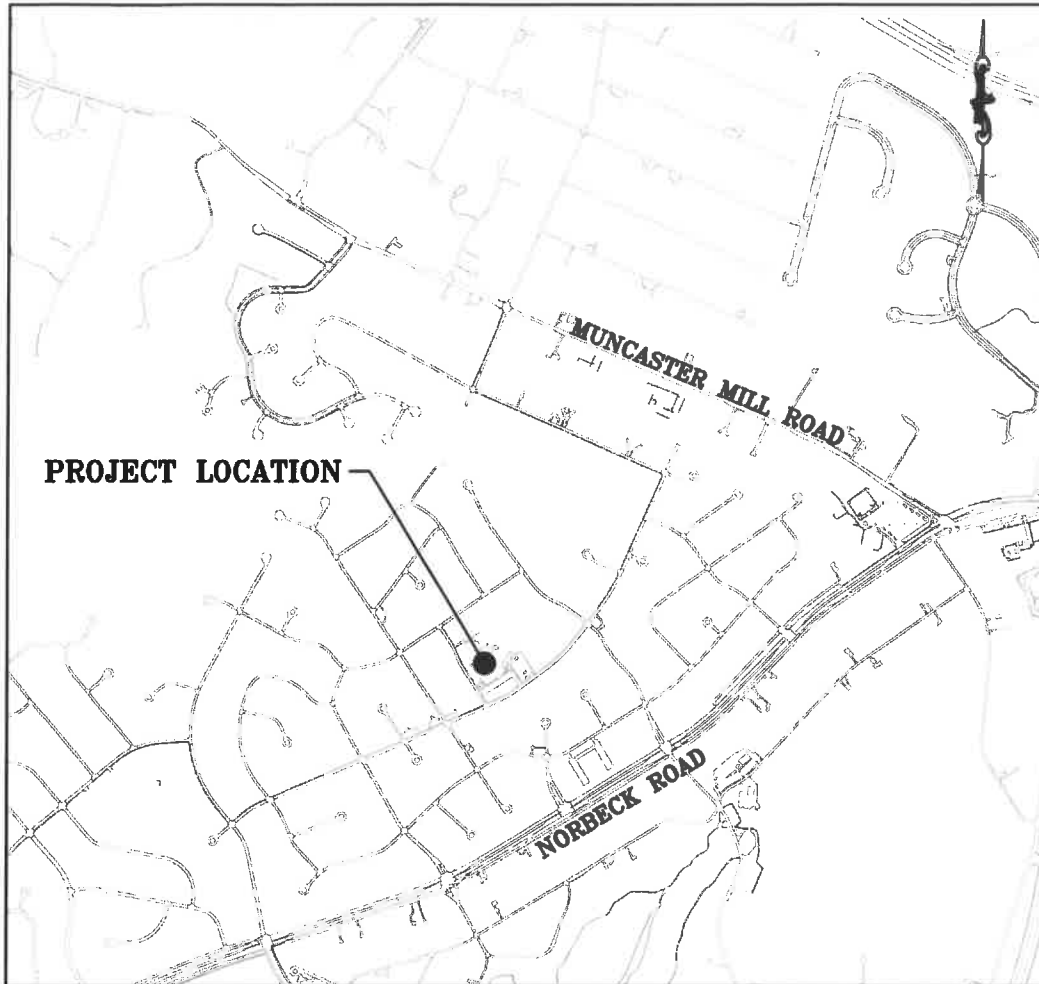

VICINITY MAP
SCALE: 1" = 1000'

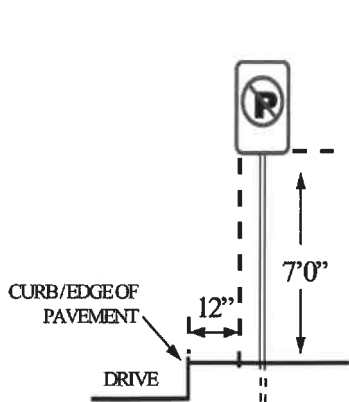

SIGN PLACEMENT DIAGRAM



FIRE LANE SIGNS

GENERAL NOTES:

1. SIGNS TO BE CONSISTENT WITH THE MONTGOMERY COUNTY FIRE AND RESCUE (MCFR) GUIDELINES
2. FIRE LANE SIGNS TO BE 12" WIDE BY 18" HIGH



CLARK | AZAR & ASSOCIATES
20440 Century Blvd, Suite 220
Germantown, MD. 20874
T(301) 528-2010
www.clarkazar.com
A Woman Owned Small Business

MODULAR CLASSROOM IMPROVEMENTS
FLOWER VALLEY ELEMENTARY SCHOOL
4615 SUNFLOWER DRIVE
ROCKVILLE, MD 20853
FIRE LANE ORDER DETAILS

JOB NO.: 200.042

SCALE: 1" = 1000'

DATE: JUNE 2019

SHEET NUMBER:

1 OF 2

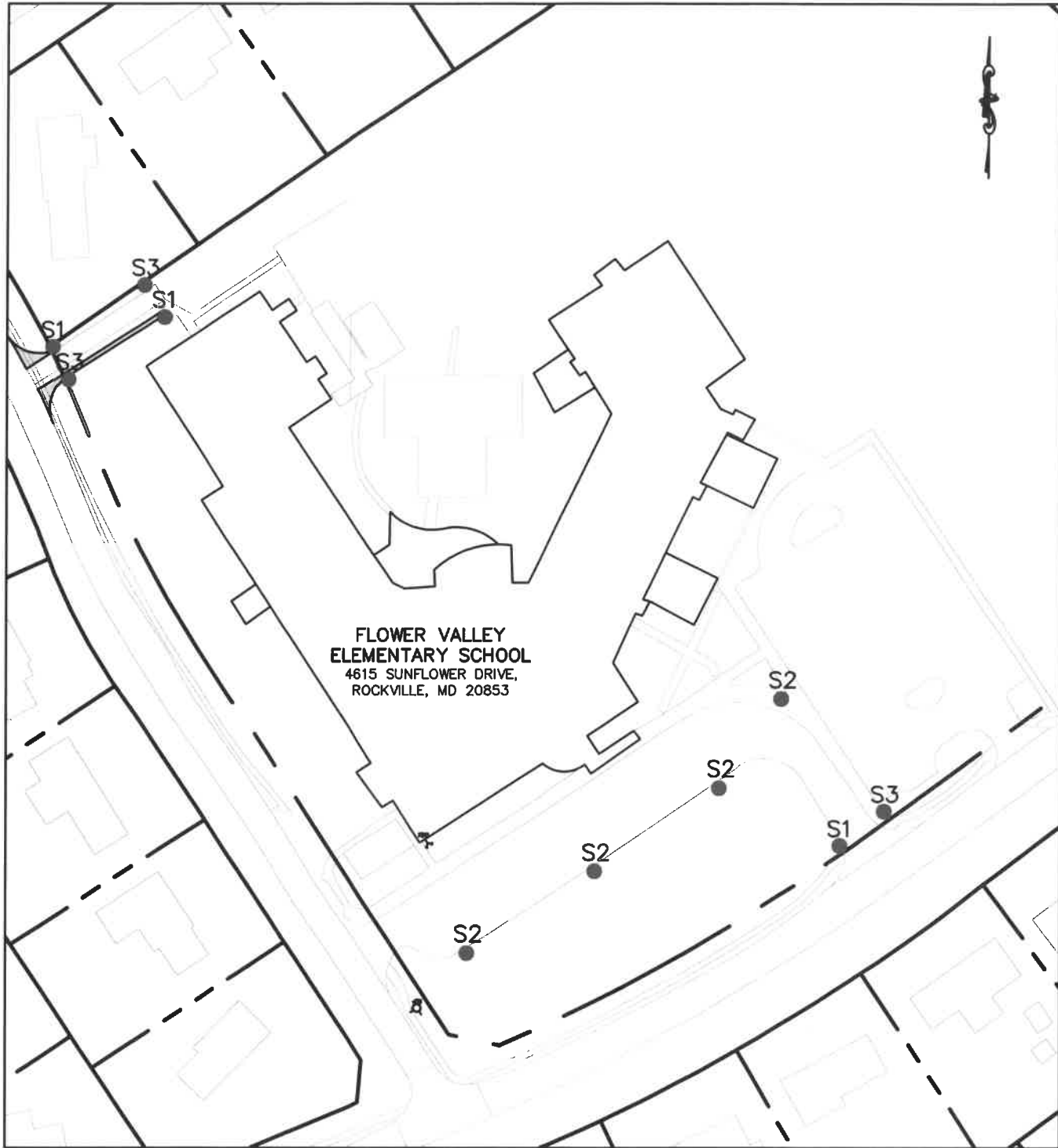

FIRE LANE PLAN

SCALE: 1" = 100'

LEGEND
S1 FIRE LANE SIGN (TYP.)



CLARK | AZAR & ASSOCIATES
 20440 Century Blvd, Suite 220
 Germantown, MD, 20874
 T(301) 528-2010
 www.clarkazar.com
 A Woman Owned Small Business

MODULAR CLASSROOM IMPROVEMENTS
FLOWER VALLEY ELEMENTARY SCHOOL
 4615 SUNFLOWER DRIVE
 ROCKVILLE, MD 20853
 FIRE LANE ORDER SIGNAGE PLAN

JOB NO.: 200.042

SCALE: 1" = 100'

DATE: JUNE 2019

SHEET NUMBER:

2 OF 2