



MONTGOMERY COUNTY EXECUTIVE ORDER

Offices of the County Executive • 101 Monroe Street • Rockville, Maryland 20850

Subject Fire Lane Establishment Order for Clarksburg Village	Executive Order No. 132-13	Subject Suffix
Originating Department Montgomery County Fire and Rescue Service	Department Number MCFRS 23-13	Effective Date 8/5/2013

Fire Lane Establishment Order

Pursuant to Section 22 - 33, Montgomery County Code, 1971, as amended, you are hereby notified that a Fire Lane has been established as described in this order. You are hereby ordered to post fire lane signs and paint curbs/pavement (painting optional) as identified below. When signs and paint work (painting optional) have been completed, this order will authorize the enforcement of this Fire Lane by appropriate police and fire officials. Compliance with this order must be achieved within 30 days of receipt.

LOCATION: Clarksburg Village
11881 Emerald Green Cir. and Peppervine Dr.

All areas where indicated by signs and paint.

SIGNS - - (See attached diagram for location of sign placement)



\$250 FINE

FIRE LANE

Signs must be posted so that it is not possible to park a vehicle without being in sight of a sign. Signs may be no further apart than 100 feet

(Red letters on white background)

PAINT - - (See attached diagram if painting).

Paint must be traffic yellow with lines of sufficient width to be readily identifiable/readable by motor vehicle operators.

Fire Chief, Montgomery County Fire and Rescue Service

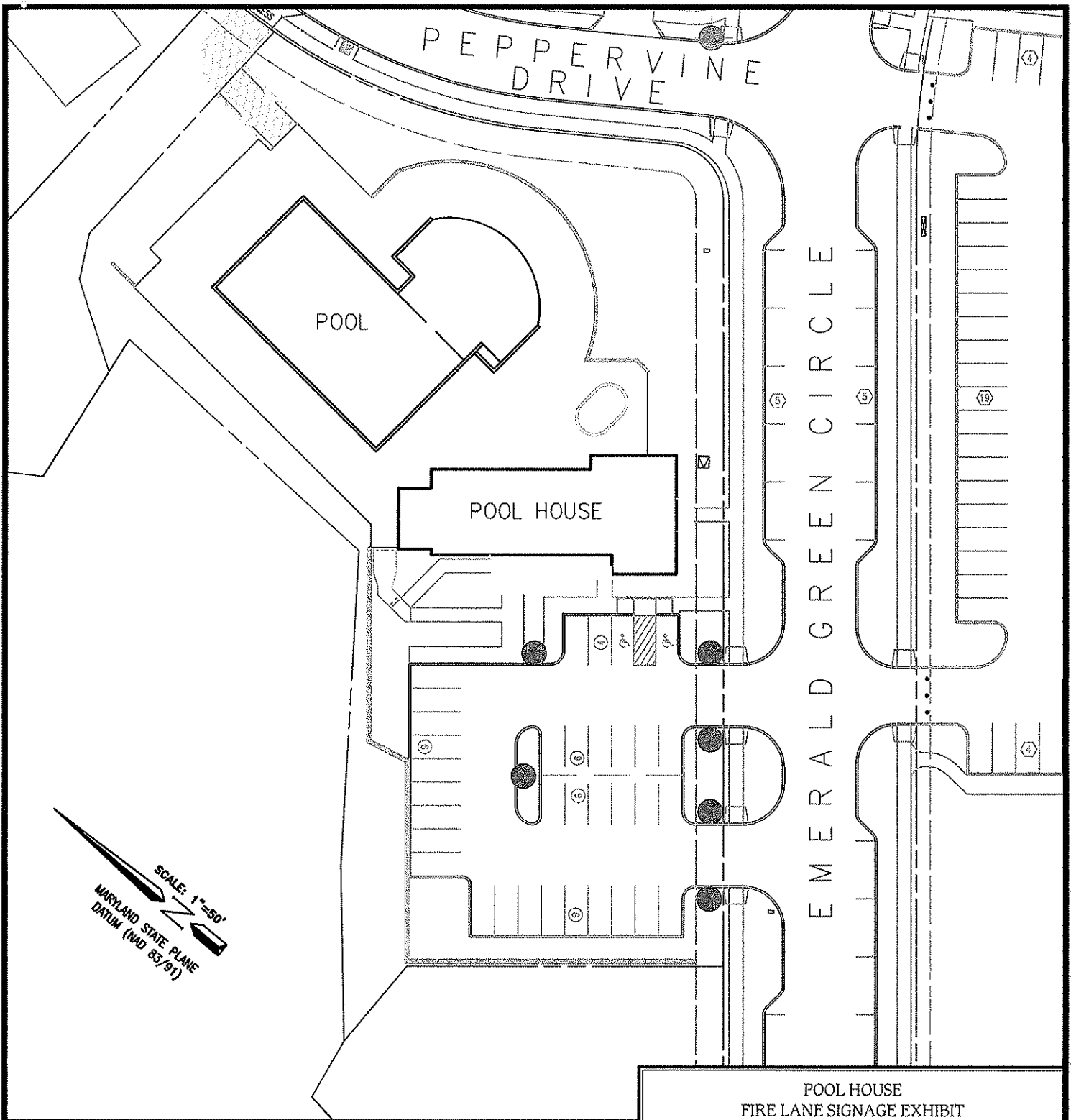

KEY

FIRE HYDRANT



LOCATION OF FIRE LANE SIGNAGE



FIRE LANE - NO PARKING



POOL HOUSE
 FIRE LANE SIGNAGE EXHIBIT
 PHASE 2B
CLARKSBURG VILLAGE
 CLARKSBURG (2nd) ELECTION DISTRICT
 MONTGOMERY COUNTY, MARYLAND

CPJ Charles P. Johnson & Associates, Inc.
 Civil and Environmental Engineers • Planners • Landscape Architects • Surveyors
Associates 1751 Elton Rd., Ste. 300 Silver Spring, MD 20903 301-434-7000 Fax: 301-434-9394
 www.cpja.com • Silver Spring, MD • Gaithersburg, MD • College Park, MD • Frederick, MD • Fairfax, VA

CLIENT:	CLARKSBURG VILLAGE INVESTMENTS, INC. 1355 BEVERLY ROAD, SUITE 240 MCLEAN, VIRGINIA 22101 PHONE: (703) 754-9790	PRELIMINARY PLAN NO.	SITE PLAN NO.
DESIGN	AR	SHEET	OF
DRAFT	MED	1	1
DATE:	AUG. 2013	FILE NO.:	
SCALE	AS SHOWN		32-202-94

COPYRIGHT © LATEST DATE HEREON CHARLES P. JOHNSON & ASSOCIATES, INC. ALL RIGHTS RESERVED. UNAUTHORIZED USE OR REPRODUCTION IS PROHIBITED.

Attached Xrefs: 21-p2-amend/44-039/48-039/788x11-P/21-p2NE-amend/21-p2NW-amend/21-p2SE-amend/21-p2SW-amend/21-p2SE-amend