



MONTGOMERY COUNTY EXECUTIVE ORDER

Offices of the County Executive • 101 Monroe Street • Rockville, Maryland 20850

Subject Fire Lane Establishment Order for Fox Hill	Executive Order No. 134-16	Subject Suffix
Originating Department Montgomery County Department of Permitting Services	Department Number MCDPS 39-16	Effective Date 8/23/2016

Fire Lane Establishment Order

Pursuant to Section 22 - 33, Montgomery County Code, 1971, as amended, you are hereby notified that a Fire Lane has been established as described in this order. You are hereby ordered to post fire lane signs and paint curbs/pavement (painting optional) as identified below. When signs and paint work (painting optional) have been completed, this order will authorize the enforcement of this Fire Lane by appropriate police and fire officials. Compliance with this order must be achieved within 30 days of receipt.

LOCATION: 8300 Burdette Rd

All areas where indicated by signs and paint.

SIGNS - - (See attached diagram for location of sign placement)



\$250 FINE

FIRE LANE

Signs must be posted so that it is not possible to park a vehicle without being in sight of a sign. Signs may be no further apart than 100 feet

(Red letters on white background)

PAINT - - (See attached diagram if painting).

Paint must be traffic yellow with lines of sufficient width to be readily identifiable/readable by motor vehicle operators.



Fire Marshal, Montgomery County Department of Permitting Services

DIMEL
Shah
Architectural & Landscape Design
14100 14th Ave SE
Bellevue, WA 98007
Tel: 206.467.1234
Fax: 206.467.1235

DATE	DESCRIPTION
01/12/06	PRELIMINARY
02/02/06	REVISED
03/02/06	REVISED
04/02/06	REVISED
05/02/06	REVISED
06/02/06	REVISED
07/02/06	REVISED
08/02/06	REVISED
09/02/06	REVISED
10/02/06	REVISED
11/02/06	REVISED
12/02/06	REVISED
01/03/07	REVISED
02/03/07	REVISED
03/03/07	REVISED
04/03/07	REVISED
05/03/07	REVISED
06/03/07	REVISED
07/03/07	REVISED
08/03/07	REVISED
09/03/07	REVISED
10/03/07	REVISED
11/03/07	REVISED
12/03/07	REVISED
01/04/08	REVISED
02/04/08	REVISED
03/04/08	REVISED
04/04/08	REVISED
05/04/08	REVISED
06/04/08	REVISED
07/04/08	REVISED
08/04/08	REVISED
09/04/08	REVISED
10/04/08	REVISED
11/04/08	REVISED
12/04/08	REVISED
01/05/09	REVISED
02/05/09	REVISED
03/05/09	REVISED
04/05/09	REVISED
05/05/09	REVISED
06/05/09	REVISED
07/05/09	REVISED
08/05/09	REVISED
09/05/09	REVISED
10/05/09	REVISED
11/05/09	REVISED
12/05/09	REVISED
01/06/10	REVISED
02/06/10	REVISED
03/06/10	REVISED
04/06/10	REVISED
05/06/10	REVISED
06/06/10	REVISED
07/06/10	REVISED
08/06/10	REVISED
09/06/10	REVISED
10/06/10	REVISED
11/06/10	REVISED
12/06/10	REVISED
01/07/11	REVISED
02/07/11	REVISED
03/07/11	REVISED
04/07/11	REVISED
05/07/11	REVISED
06/07/11	REVISED
07/07/11	REVISED
08/07/11	REVISED
09/07/11	REVISED
10/07/11	REVISED
11/07/11	REVISED
12/07/11	REVISED
01/08/12	REVISED
02/08/12	REVISED
03/08/12	REVISED
04/08/12	REVISED
05/08/12	REVISED
06/08/12	REVISED
07/08/12	REVISED
08/08/12	REVISED
09/08/12	REVISED
10/08/12	REVISED
11/08/12	REVISED
12/08/12	REVISED
01/09/13	REVISED
02/09/13	REVISED
03/09/13	REVISED
04/09/13	REVISED
05/09/13	REVISED
06/09/13	REVISED
07/09/13	REVISED
08/09/13	REVISED
09/09/13	REVISED
10/09/13	REVISED
11/09/13	REVISED
12/09/13	REVISED
01/10/14	REVISED
02/10/14	REVISED
03/10/14	REVISED
04/10/14	REVISED
05/10/14	REVISED
06/10/14	REVISED
07/10/14	REVISED
08/10/14	REVISED
09/10/14	REVISED
10/10/14	REVISED
11/10/14	REVISED
12/10/14	REVISED
01/11/15	REVISED
02/11/15	REVISED
03/11/15	REVISED
04/11/15	REVISED
05/11/15	REVISED
06/11/15	REVISED
07/11/15	REVISED
08/11/15	REVISED
09/11/15	REVISED
10/11/15	REVISED
11/11/15	REVISED
12/11/15	REVISED
01/12/16	REVISED
02/12/16	REVISED
03/12/16	REVISED
04/12/16	REVISED
05/12/16	REVISED
06/12/16	REVISED
07/12/16	REVISED
08/12/16	REVISED
09/12/16	REVISED
10/12/16	REVISED
11/12/16	REVISED
12/12/16	REVISED
01/13/17	REVISED
02/13/17	REVISED
03/13/17	REVISED
04/13/17	REVISED
05/13/17	REVISED
06/13/17	REVISED
07/13/17	REVISED
08/13/17	REVISED
09/13/17	REVISED
10/13/17	REVISED
11/13/17	REVISED
12/13/17	REVISED
01/14/18	REVISED
02/14/18	REVISED
03/14/18	REVISED
04/14/18	REVISED
05/14/18	REVISED
06/14/18	REVISED
07/14/18	REVISED
08/14/18	REVISED
09/14/18	REVISED
10/14/18	REVISED
11/14/18	REVISED
12/14/18	REVISED
01/15/19	REVISED
02/15/19	REVISED
03/15/19	REVISED
04/15/19	REVISED
05/15/19	REVISED
06/15/19	REVISED
07/15/19	REVISED
08/15/19	REVISED
09/15/19	REVISED
10/15/19	REVISED
11/15/19	REVISED
12/15/19	REVISED
01/16/20	REVISED
02/16/20	REVISED
03/16/20	REVISED
04/16/20	REVISED
05/16/20	REVISED
06/16/20	REVISED
07/16/20	REVISED
08/16/20	REVISED
09/16/20	REVISED
10/16/20	REVISED
11/16/20	REVISED
12/16/20	REVISED
01/17/21	REVISED
02/17/21	REVISED
03/17/21	REVISED
04/17/21	REVISED
05/17/21	REVISED
06/17/21	REVISED
07/17/21	REVISED
08/17/21	REVISED
09/17/21	REVISED
10/17/21	REVISED
11/17/21	REVISED
12/17/21	REVISED
01/18/22	REVISED
02/18/22	REVISED
03/18/22	REVISED
04/18/22	REVISED
05/18/22	REVISED
06/18/22	REVISED
07/18/22	REVISED
08/18/22	REVISED
09/18/22	REVISED
10/18/22	REVISED
11/18/22	REVISED
12/18/22	REVISED
01/19/23	REVISED
02/19/23	REVISED
03/19/23	REVISED
04/19/23	REVISED
05/19/23	REVISED
06/19/23	REVISED
07/19/23	REVISED
08/19/23	REVISED
09/19/23	REVISED
10/19/23	REVISED
11/19/23	REVISED
12/19/23	REVISED
01/20/24	REVISED
02/20/24	REVISED
03/20/24	REVISED
04/20/24	REVISED
05/20/24	REVISED
06/20/24	REVISED
07/20/24	REVISED
08/20/24	REVISED
09/20/24	REVISED
10/20/24	REVISED
11/20/24	REVISED
12/20/24	REVISED

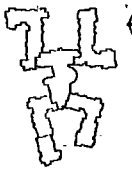

PROJECT NO.	200601
DATE	01/17/17
DRAWN BY	CHANG, Y.
CHECKED BY	SHAH, D.
DATE	01/17/17
PROJECT NO.	200601
DATE	01/17/17
DRAWN BY	CHANG, Y.
CHECKED BY	SHAH, D.
DATE	01/17/17

For Hill
A Hill Group
SUNRISE
DEVELOPMENT, INC.
SUNRISE DEVELOPMENT, INC.
SUNRISE DEVELOPMENT, INC.

SITE PLAN
RECEIVED
01/31/2024
WASHINGTON
A0.10

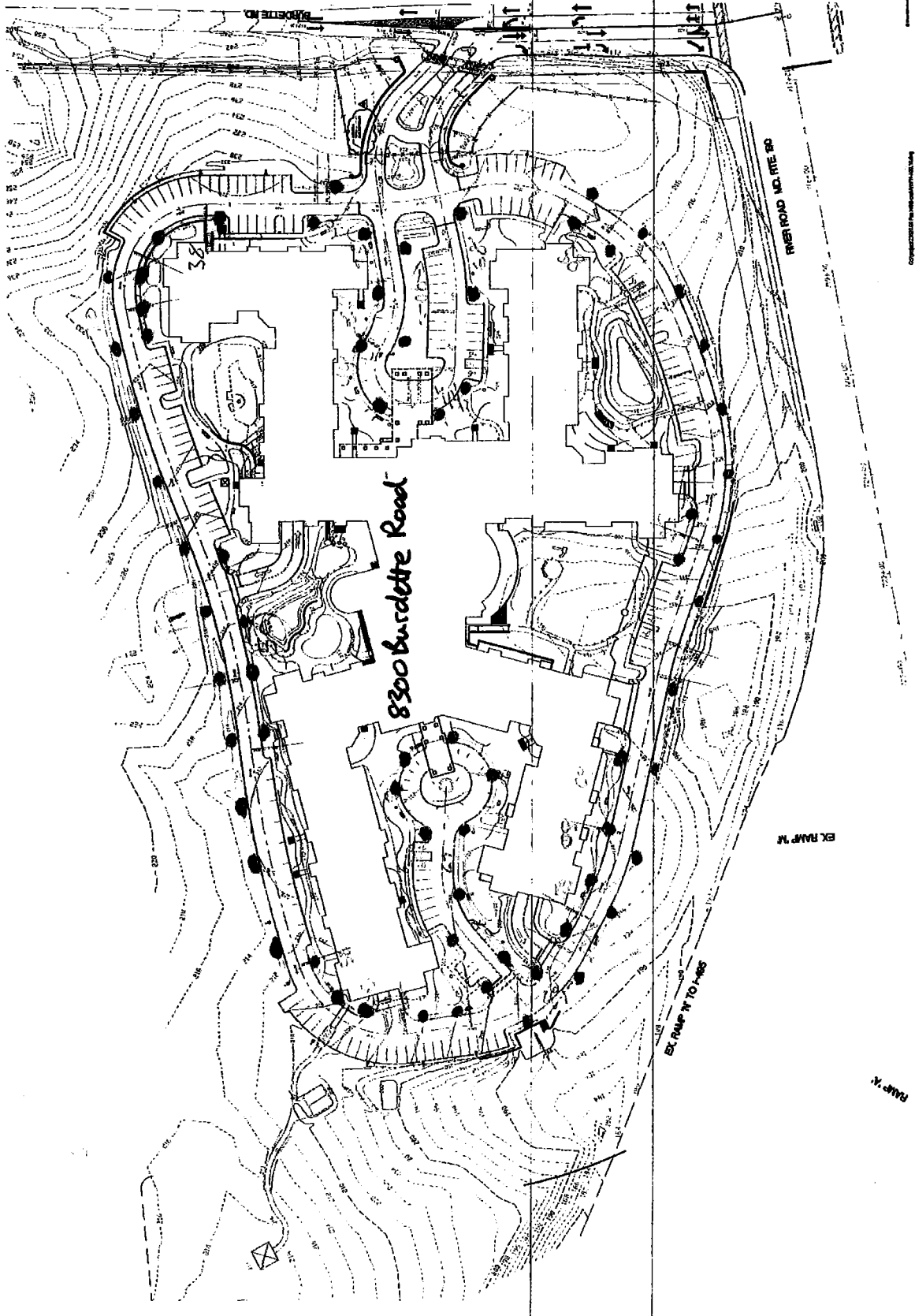

Copyright © 2006 by Hill Group