



# MONTGOMERY COUNTY EXECUTIVE ORDER

Offices of the County Executive • 101 Monroe Street • Rockville, Maryland 20850

Subject Fire Lane Establishment Order for St. Constantine & Helen Greek Orthodox Church	Executive Order No. 146-17	Subject Suffix
Originating Department Montgomery County Department of Permitting Services	Department Number MCDPS 41-17	Effective Date 09/06/2017

### Fire Lane Establishment Order

Pursuant to Section 22 - 33, Montgomery County Code, 1971, as amended, you are hereby notified that a Fire Lane has been established as described in this order. You are hereby ordered to post fire lane signs and paint curbs/pavement (painting optional) as identified below. When signs and paint work (painting optional) have been completed, this order will authorize the enforcement of this Fire Lane by appropriate police and fire officials. Compliance with this order must be achieved within 30 days of receipt.

LOCATION: 721 Norwood Rd  
\_\_\_\_\_  
\_\_\_\_\_

All areas where indicated by signs and paint.

SIGNS - - (See attached diagram for location of sign placement)



\$250 FINE

FIRE LANE

Signs must be posted so that it is not possible to park a vehicle without being in sight of a sign. Signs may be no further apart than 100 feet

(Red letters on white background)

PAINT - - (See attached diagram if painting).

Paint must be traffic yellow with lines of sufficient width to be readily identifiable/readable by motor vehicle operators.

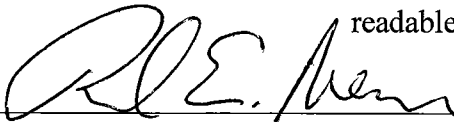
  
\_\_\_\_\_  
Fire Marshal, Montgomery County Department of Permitting Services

LIMITS OF YELLOW NO PARKING FIRE LANES (TYP.)



SIGN A



SIGN B



SIGN C

NORWOOD ROAD

20' FIRE ACCESS LANE

FIRE DEPARTMENT CONNECTION  
**PROPOSED SANCTUARY**  
 # 721 Norwood Road  
 F.F. = 386.0  
 L.L. = 374.33  
 Height = 46.5'

Matchline

**FIRE LANE SIGNAGE PLAN 91 of 2)**

**SAINTS CONSTANTINE AND HELEN  
 GREEK ORTHODOX CHURCH**  
 PARCEL 942

SCALE: 1" = 60' DATE: 8-28-17  
 MONTGOMERY COUNTY, MARYLAND

**MHG** Macris, Hendricks & Glascock, P.A.  
 Engineers ■ Planners  
 Landscape Architects ■ Surveyors

9220 Wightman Road, Suite 120  
 Montgomery Village, Maryland  
 20886-1279

Phone 301.670.0840  
 Fax 301.948.0693  
 www.mhgpa.com

JOB NO. 2012.161.22

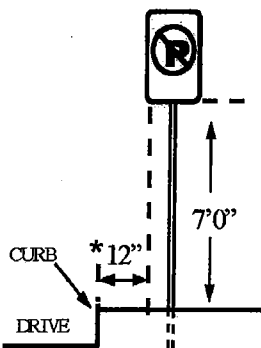

\*Where possible, or at back of sidewalk

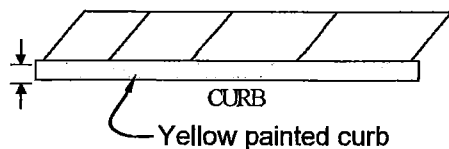

**Curb Painting Diagram**

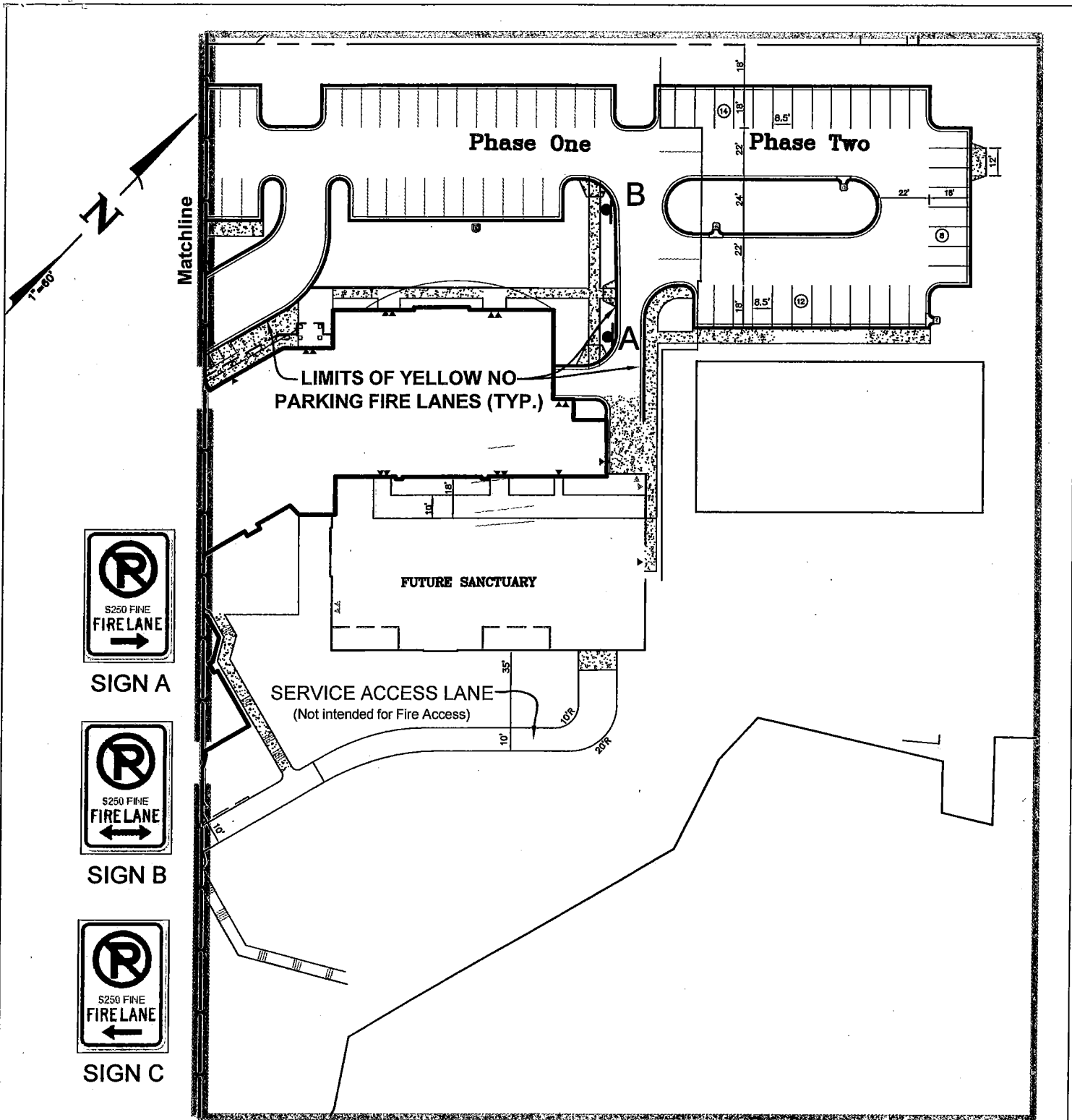

**FIRE LANE SIGNAGE PLAN (2 of 2)**

**SAINTS CONSTANTINE AND HELEN  
GREEK ORTHODOX CHURCH  
PARCEL 942**

SCALE: 1" = 60' DATE: 8-15-17  
MONTGOMERY COUNTY, MARYLAND

**MHG** Macris, Hendricks & Glascock, P.A.  
Engineers ■ Planners  
Landscape Architects ■ Surveyors

9220 Wightman Road, Suite 120  
Montgomery Village, Maryland  
20886-1279

Phone 301.670.0840  
Fax 301.948.0693  
www.mhgpca.com

JOB NO. 2012.161.22

