

# MONTGOMERY COUNTY EXECUTIVE ORDER

Offices of the County Executive • 101 Monroe Street • Rockville, Maryland 20850

Subject Fire Lane Establishment Order for Garden of Remembrance Memorial Park	Executive Order No. 149-18	Subject Suffix
Originating Department Montgomery County Department of Permitting Services	Department Number MCDPS 38-18	Effective Date 7/17/2018

### Fire Lane Establishment Order

Pursuant to Section 22 - 33, Montgomery County Code, 1971, as amended, you are hereby notified that a Fire Lane has been established as described in this order. You are hereby ordered to post fire lane signs and paint curbs/pavement (painting optional) as identified below. When signs and paint work (painting optional) have been completed, this order will authorize the enforcement of this Fire Lane by appropriate police and fire officials. Compliance with this order must be achieved within 30 days of receipt.

LOCATION: 14321 Comus Rd  
\_\_\_\_\_  
\_\_\_\_\_

All areas where indicated by signs and paint.

- SIGNS - - (See attached diagram for location of sign placement)



\$250 FINE

FIRE LANE

Signs must be posted so that it is not possible to park a vehicle without being in sight of a sign. Signs may be no further apart than 100 feet

(Red letters on white background)

- PAINT - - (See attached diagram if painting).

Paint must be traffic yellow with lines of sufficient width to be readily identifiable/readable by motor vehicle operators.

  
\_\_\_\_\_  
Fire Marshal, Montgomery County Department of Permitting Services

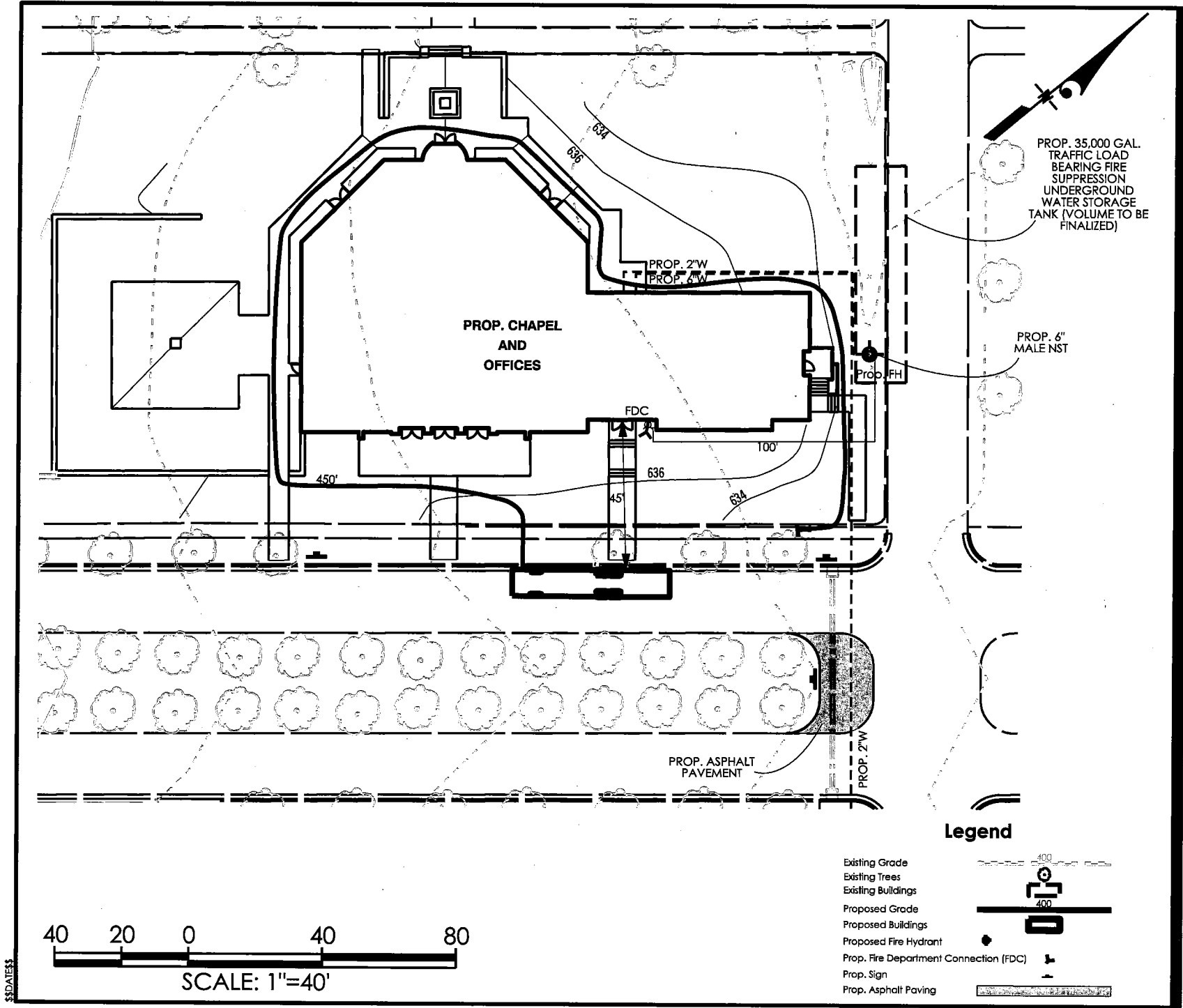

- Legend**
- Existing Grade
  - Existing Trees
  - Existing Buildings
  - Proposed Grade
  - Proposed Buildings
  - Proposed Fire Hydrant
  - Prop. Fire Department Connection (FDC)
  - Prop. Sign
  - Prop. Asphalt Paving

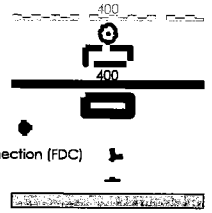

PROP. 35,000 GAL.  
TRAFFIC LOAD  
BEARING FIRE  
SUPPRESSION  
UNDERGROUND  
WATER STORAGE  
TANK (VOLUME TO BE  
FINALIZED)

PROP. 6"  
MALE NST

Prop. FH

PROP. 2"W  
PROP. 6"W

FDC

100'

45'

PROP. ASPHALT  
PAVEMENT

PROP. 2"W

450'

636  
634

636  
634



20410 Century Boulevard, Suite 200  
Germantown, Maryland 20874  
Phone: (301) 444-9282 Fax: (301) 444-8181  
www.stantec.com  
The Contractor will read and be responsible for all drawings. DO NOT scale the drawing - any errors or omissions shall be reported to Stantec without delay. The Copyrights to all designs and drawings are the property of Stantec. Reproduction or use for any purpose other than that authorized by Stantec is forbidden.

Owner/Developer:  
**GARDEN OF REMEMBRANCE**  
14321 Cornus Road, Clarksburg, MD 20874  
Phone: (301) 428-3000  
Contact/Attn.: Mr. Sheldon Grosberg

**SIGNAGE PLAN**  
**GARDEN OF REMEMBRANCE CHAPEL**

4th Election District  
Montgomery County, Maryland

Project No.	Scale
2029077488	1"=40'
Design	Checked
MH	KWC
Drawn	Date
MAD	June 2018
Sheet	