



MONTGOMERY COUNTY EXECUTIVE ORDER

Offices of the County Executive • 101 Monroe Street • Rockville, Maryland 20850

Subject Fire Lane Establishment Order for Village West at Germantown Town Center	Executive Order No. 16-18	Subject Suffix
Originating Department Montgomery County Department of Permitting Services	Department Number MCDPS 10-18	Effective Date 2/06/2018

Fire Lane Establishment Order

Pursuant to Section 22 - 33, Montgomery County Code, 1971, as amended, you are hereby notified that a Fire Lane has been established as described in this order. You are hereby ordered to post fire lane signs and paint curbs/pavement (painting optional) as identified below. When signs and paint work (painting optional) have been completed, this order will authorize the enforcement of this Fire Lane by appropriate police and fire officials. Compliance with this order must be achieved within 30 days of receipt.

LOCATION: 13220-13530 Waterford Hill Blvd., 19611-19874 Vaughn Landing Dr.

13201-13205 Tiber Falls Way

All areas where indicated by signs and paint.

SIGNS - - (See attached diagram for location of sign placement)



\$250 FINE

FIRE LANE

Signs must be posted so that it is not possible to park a vehicle without being in sight of a sign. Signs may be no further apart than 100 feet

(Red letters on white background)

PAINT - - (See attached diagram if painting).

Paint must be traffic yellow with lines of sufficient width to be readily identifiable/readable by motor vehicle operators.



Fire Marshal, Montgomery County Department of Permitting Services

Information contained herein is released contact
has been transmitted by electronic means

Information contained herein is released contact
has been transmitted by electronic means

1



2



3



LEGEND

- FIRE HYDRANT LOCATIONS
- NO PARKING/FIRE LANE SIGN
- CURB PAINTING

SCALE 1" = 80'

MATCHLINE - SEE SHEET 2

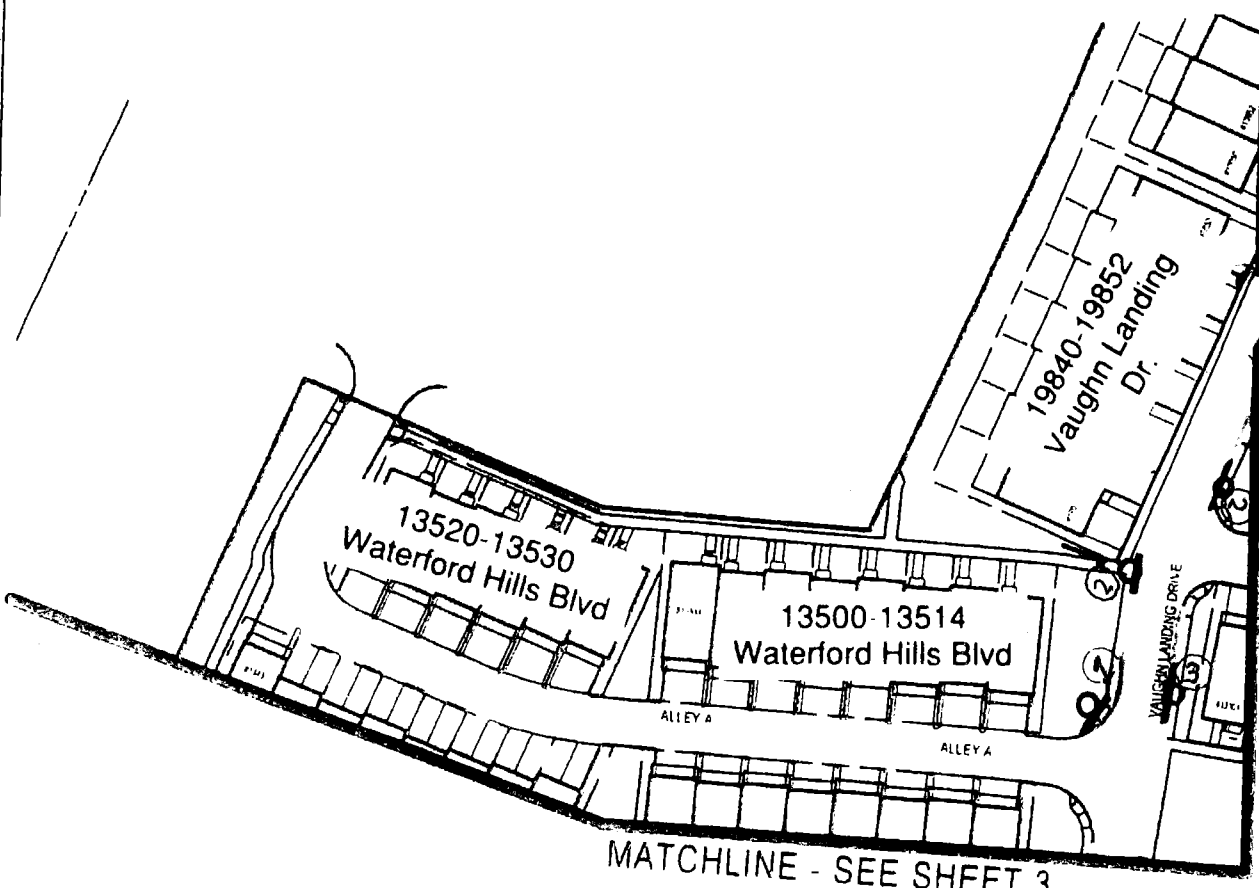

MATCHLINE - SEE SHEET 3



SOLTESZ
 2 Research Place, Suite 100
 Rockville, MD 20850
 P. 301.948.2750 F 301.948.9067
 www.solteszco.com

FIRE LANE SIGN PLAN
MARTENS PROPERTY
 GERMANTOWN (2nd) ELECTION DISTRICT
 MONTGOMERY COUNTY, MARYLAND

1/7

1896-0000

SCALE 1" = 80'

June 10, 2013

LSAPLOT/COMMENTS

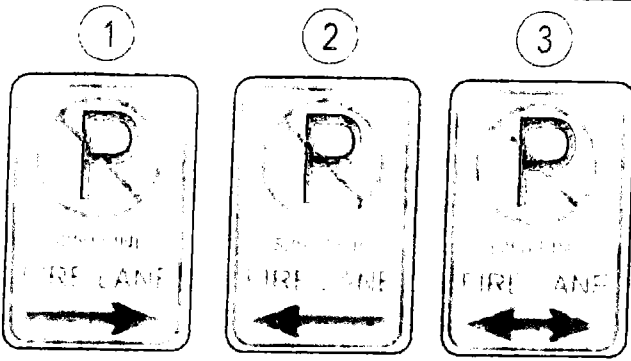

LEGEND

- FIRE HYDRANT LOCATIONS
- NO PARKING/FIRE LANE SIGN
- ▭ CURB PAINTING



Information contained herein was prepared by electronic means and is subject to change without notice. It was last updated on 06/10/2013. If you have any questions, please contact the person listed below.

This drawing was prepared by electronic means and is subject to change without notice. It was last updated on 06/10/2013. If you have any questions, please contact the person listed below.

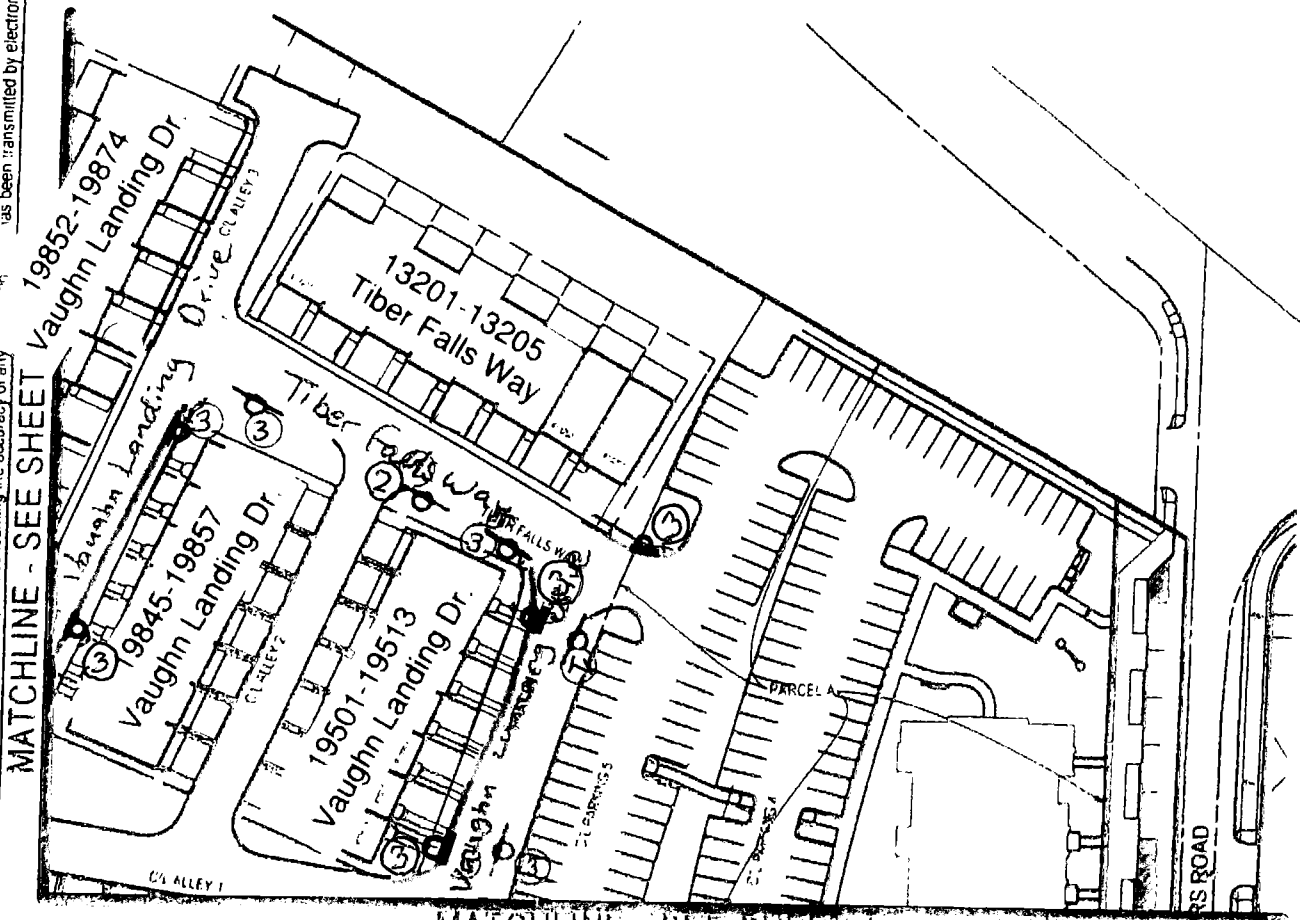

MATCHLINE - SEE SHEET 19852-19874

MATCHLINE - SEE SHEET 4



SOLTESZ
 2 Research Place, Suite 100
 Rockville MD 20850
 P. 301.948.2750 F. 301.948.9067
 www.solteszco.com

FIRE LANE SIGN PLAN
MARTENS PROPERTY
 GERMANTOWN (2nd) ELECTION DISTRICT
 MONTGOMERY COUNTY MARYLAND

2
 7

1896-0000 1" = 80' June 10, 2013

SLSAPLOTCCMENTS

Information contained herein is needed. Contact has been transmitted by electronic means

Information contained herein is needed. Contact has been transmitted by electronic means

SP

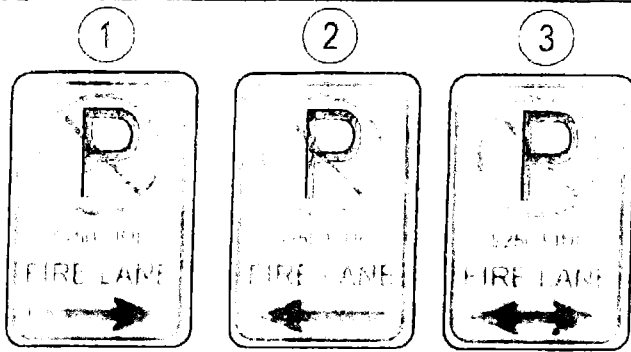

LEGEND

- FIRE HYDRANT LOCATIONS
- NO PARKING/FIRE LANE SIGN
- CURB PAINTING

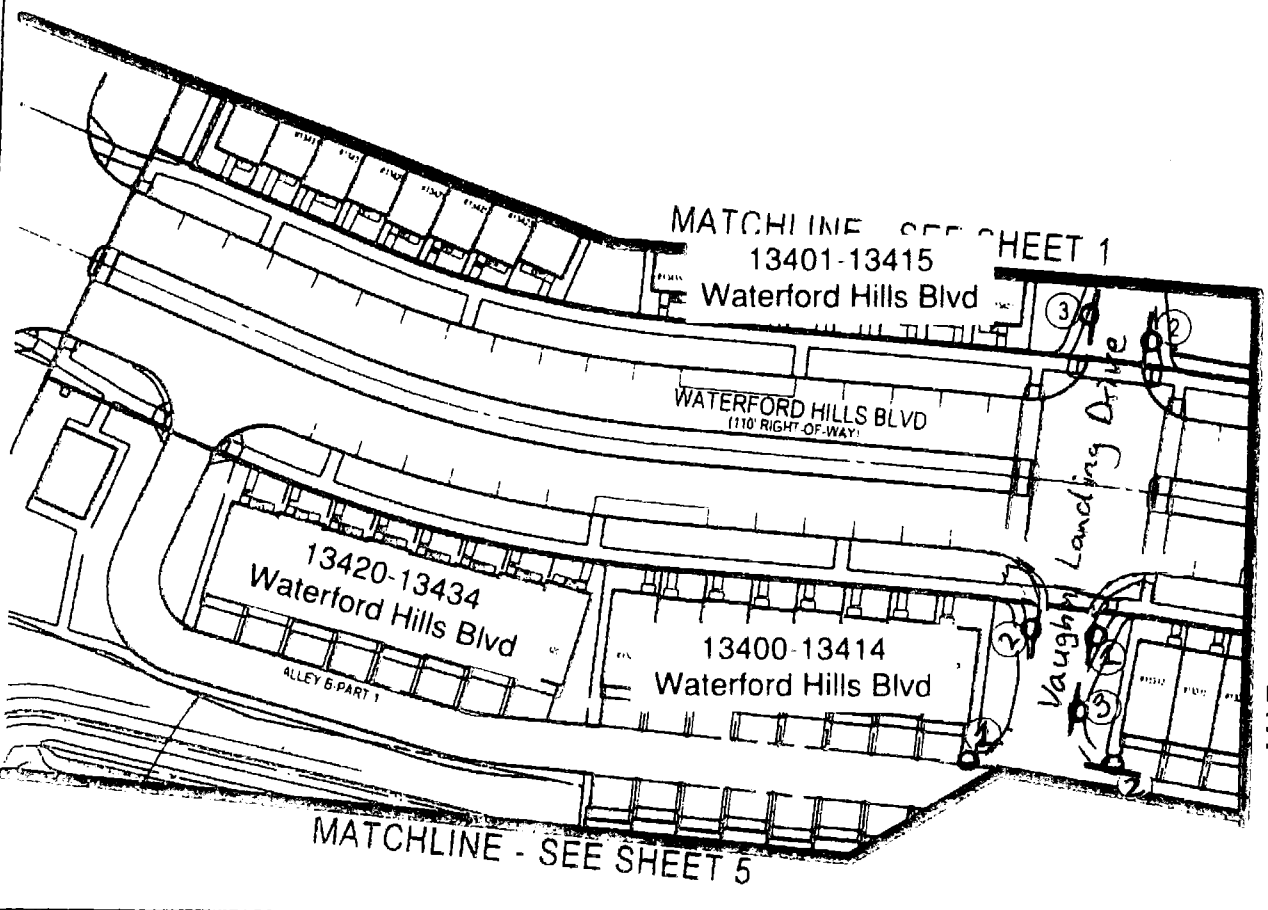

SOLTESZ
 2 Research Place, Suite 100
 Rockville, MD 20850
 P. 301.948.2750 F. 301.948.9067
 www.solteszco.com

FIRE LANE SIGN PLAN
MARTENS PROPERTY
 GERMANTOWN (2nd) ELECTION DISTRICT
 MONTGOMERY COUNTY, MARYLAND

SHEET 3
 OF 7

1896-0000 SCALE 1" = 80' DATE June 10, 2013

LSA/PLOT/COMMENTS

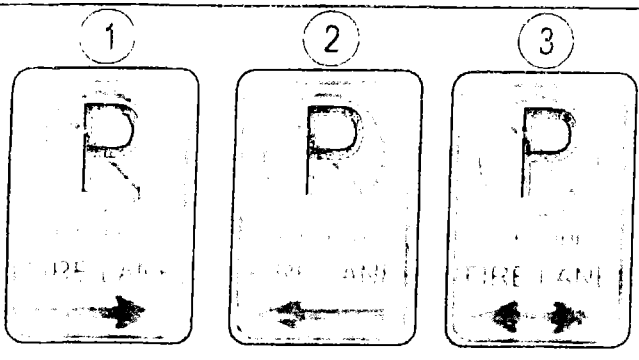

LEGEND
 FIRE HYDRANT LOCATIONS
 NO PARKING/FIRE LANE SIGN
 CURB PAINTING



MATCHLINE - SEE SHEET 2

MATCHLINE - SEE SHEET 3

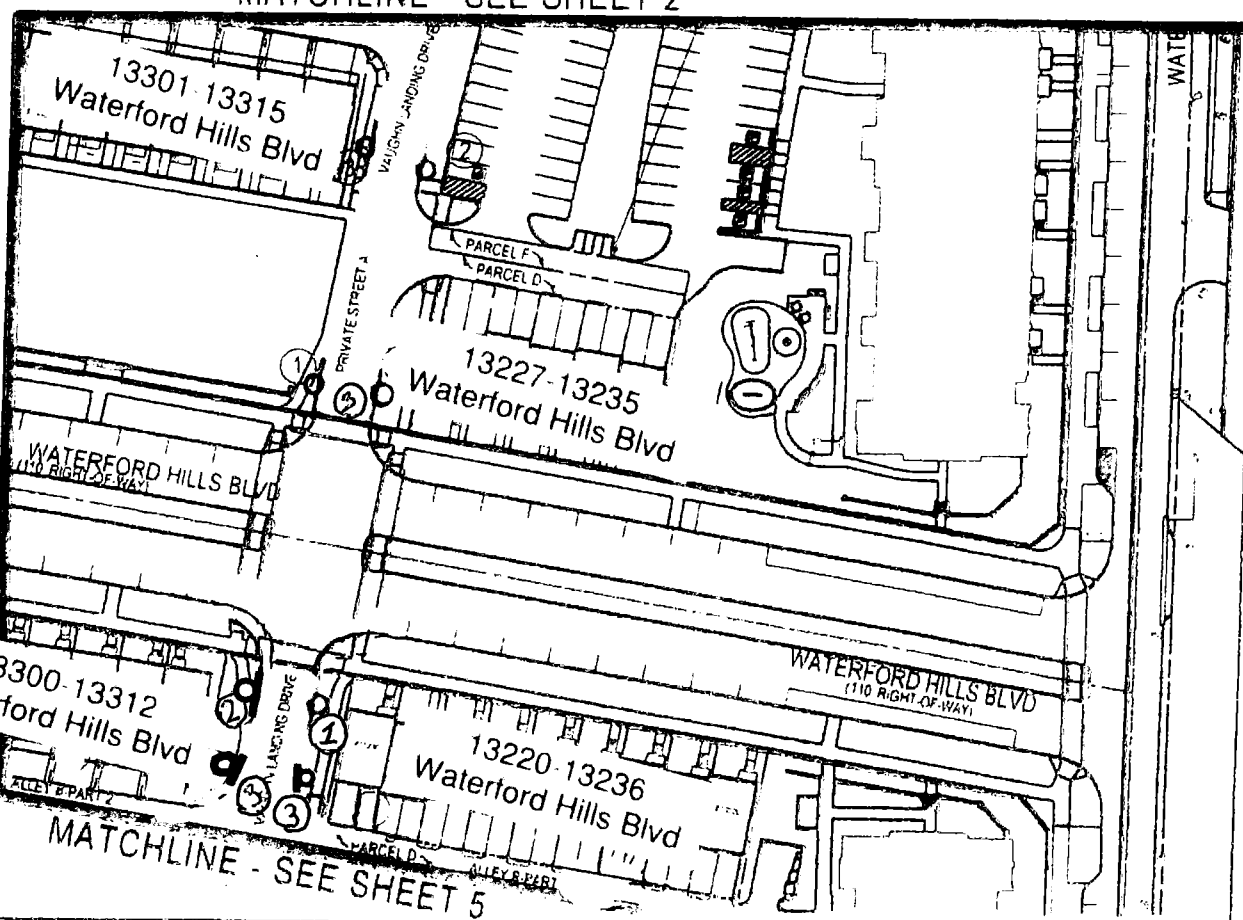

MATCHLINE - SEE SHEET 5

Information contained hereon is needed contact has been transmitted by electronic means.

Information contained hereon is not made by others. If verifier has been transmitted by electronic means.

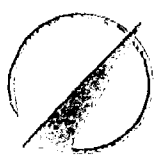

SOLTESZ
 2 Research Place, Suite 100
 Rockville, MD 20850
 P. 301.948.2750 F 301.948.9067
 www.solteszco.com

FIRE LANE SIGN PLAN
MARTENS PROPERTY
 GERMANTOWN (2nd) ELECTION DISTRICT
 MONTGOMERY COUNTY MARYLAND

1896-0000

1" = 80'

June 10, 2013

SAPLOT/COURT/ENTS

1

2

3

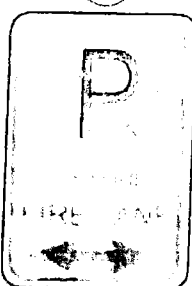
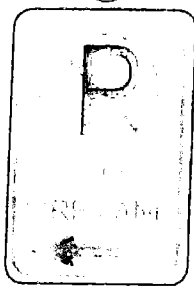
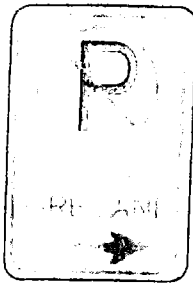

LEGEND

- FIRE HYDRANT LOCATIONS
- NO PARKING/FIRE LANE SIGN
- CURB PAINTING

Information contained hereon is based on data furnished by the client and is not warranted by LSA. LSA makes no warranties, express or implied, concerning the accuracy of any information transmitted by electronic means.

Information contained hereon is based on data furnished by the client and is not warranted by LSA. LSA makes no warranties, express or implied, concerning the accuracy of any information transmitted by electronic means.

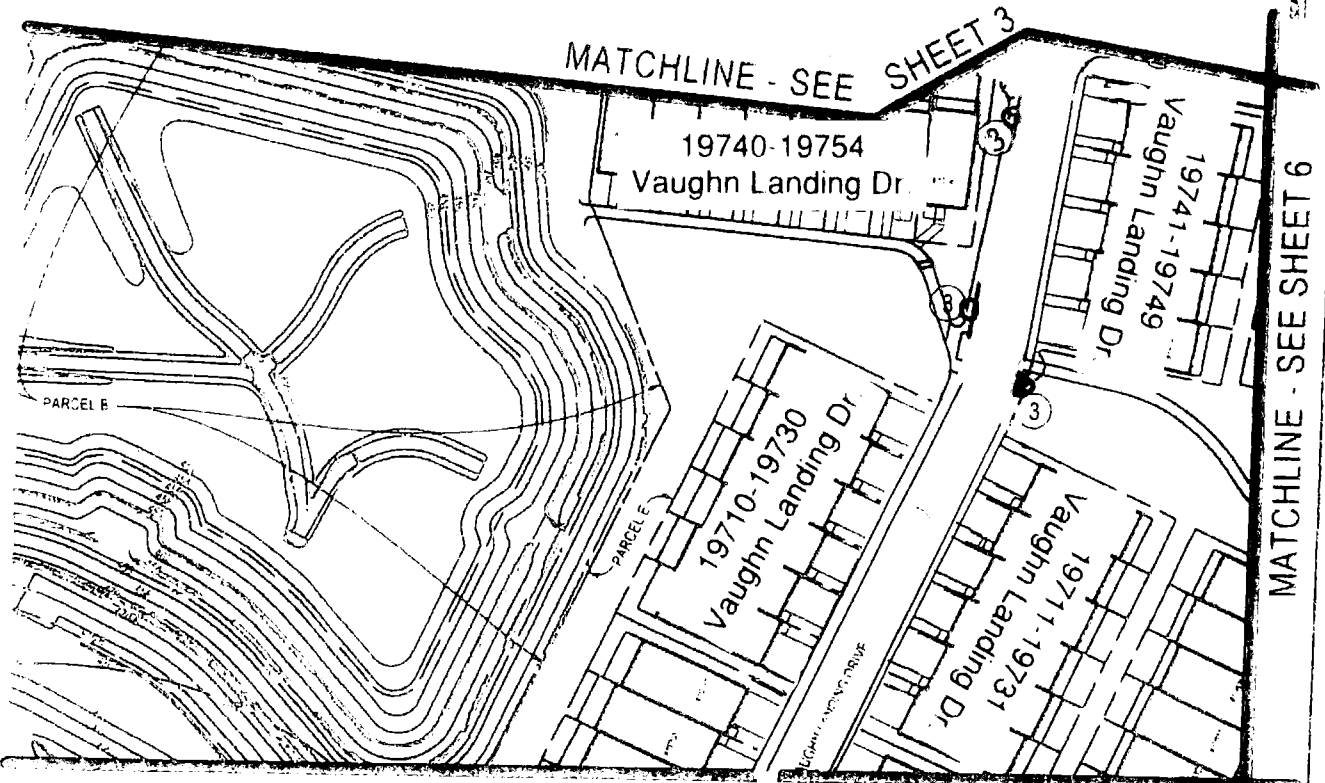

MATCHLINE - SEE SHEET 3

MATCHLINE - SEE SHEET 6

MATCHLINE - SEE SHEET 7



SOLTESZ
 2 Research Place, Suite 100
 Rockville MD 20850
 P. 301.948.2750 F. 301.948.9067
 www.solteszco.com

FIRE LANE SIGN PLAN
MARTENS PROPERTY
 GERMANTOWN (2nd) ELECTION DISTRICT
 MONTGOMERY COUNTY, MARYLAND

5
 7

1896-0000

SCALE 1" = 80'

June 10, 2013

LSA PLOT COMMENTS

All printed guarantees that unamended changes and / or alterations were not made by others. If verifiers information contained hereon is needed, contact LSA. LSA makes no warranties, express or implied, concerning the accuracy of any information has been transmitted by electronic means.

LEGEND

- FIRE HYDRANT LOCATIONS
- NO PARKING/FIRE LANE SIGN
- CURB PAINTING

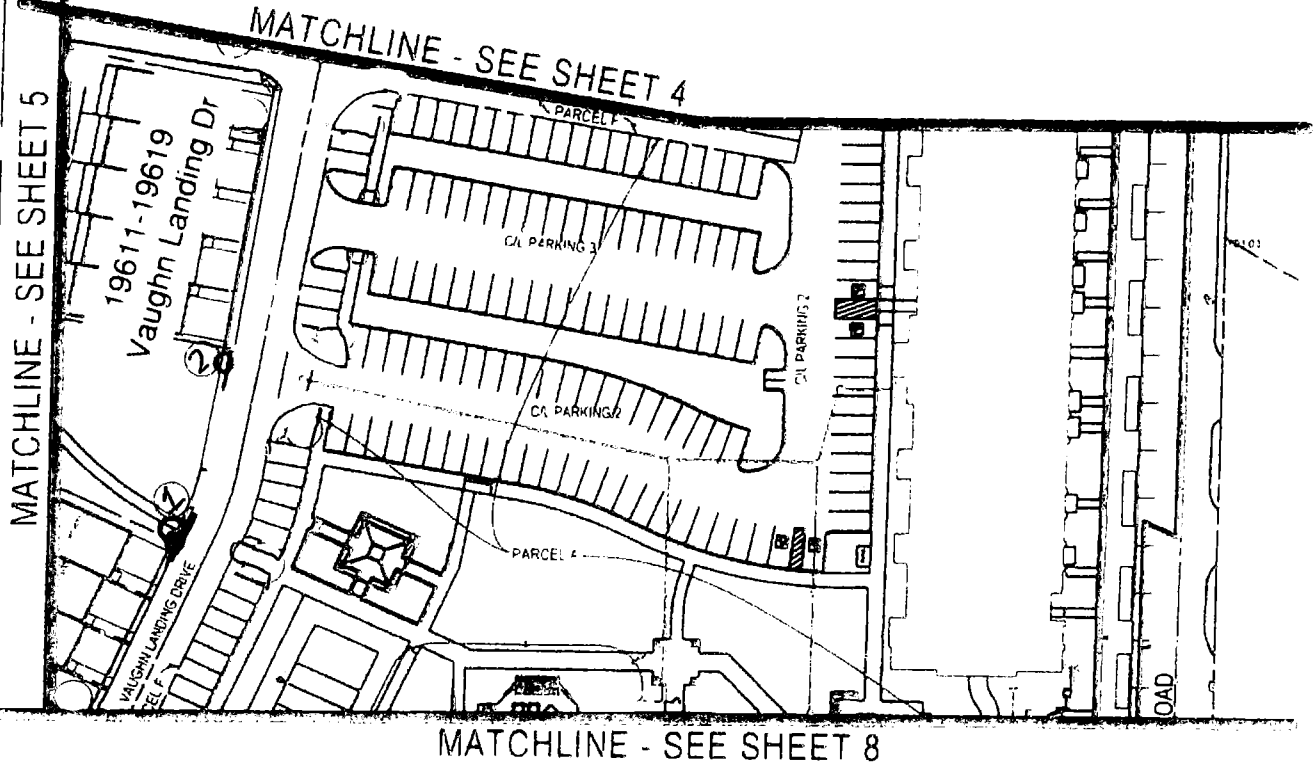
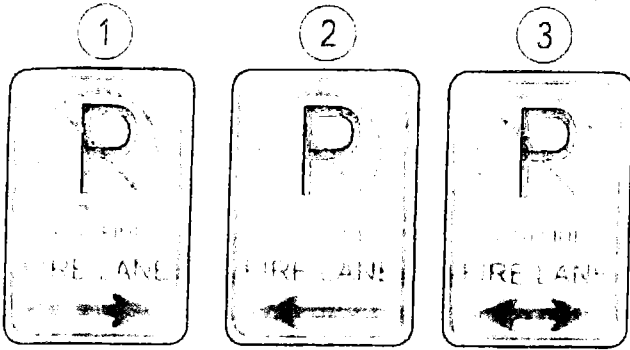

SOLTESZ
 2 Research Place, Suite 100
 Rockville, MD 20850
 P.301.948.2750 F.301.948.9067
www.solteszco.com

FIRE LANE SIGN PLAN
MARTENS PROPERTY
 GERMANTOWN (2nd) ELECTION DISTRICT
 MONTGOMERY COUNTY, MARYLAND

SHEET 6
 OF 7

1896-0000

1" = 80'

June 10, 2013

SLS/AP/TCOMMENTS

Information contained herein is the property of Soltesz & Company, Inc. and its use for any other purpose without the written consent of Soltesz & Company, Inc. is prohibited. If you have any questions, please contact Soltesz & Company, Inc. at 301.948.2750.

Soltesz & Company, Inc. makes no warranties, express or implied, concerning the accuracy of any information contained herein. The information is provided for informational purposes only and should not be relied upon for any legal or other purpose. Soltesz & Company, Inc. is not responsible for any errors or omissions in this document.

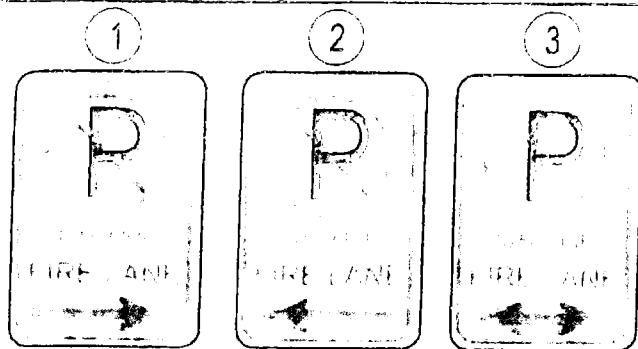

LEGEND

- FIRE HYDRANT LOCATIONS
- NO PARKING/FIRE LANE SIGN
- CURB PAINTING

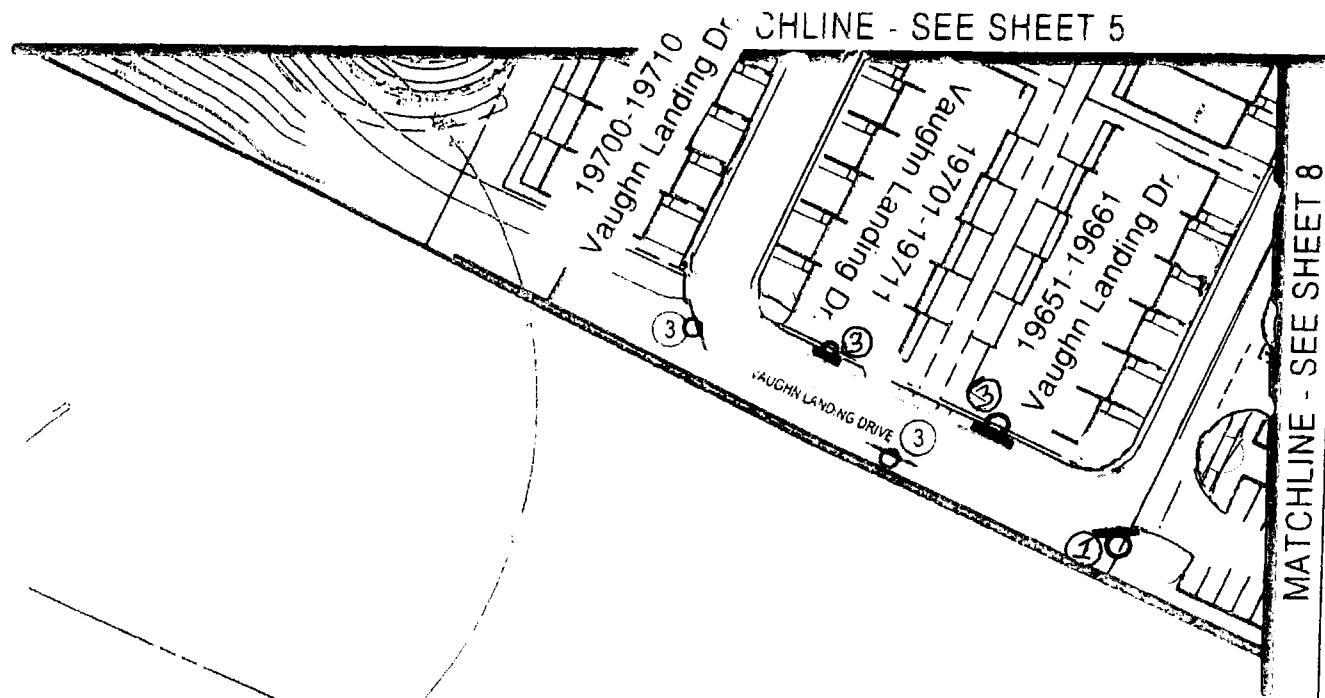

SOLTESZ
 2 Research Place, Suite 100
 Rockville, MD 20850
 P. 301.948.2750 F. 301.948.9067
 www.solteszco.com

FIRE LANE SIGN PLAN
MARTENS PROPERTY
 GERMANTOWN (2nd) ELECTION DISTRICT
 MONTGOMERY COUNTY, MARYLAND

1896-0000 SCALE 1" = 80' DATE June 10, 2013

7
7

SLSAPLOT COMMENTS