



MONTGOMERY COUNTY EXECUTIVE ORDER

Offices of the County Executive • 101 Monroe Street • Rockville, Maryland 20850

Subject Fire Lane Establishment Order St. Andrew Romanian Church	Executive Order No. 163-19	Subject Suffix
Originating Department Montgomery County Department of Permitting Services	Department Number MCDPS 27-19	Effective Date 9/10/2019

Fire Lane Establishment Order

Pursuant to Section 22 - 33, Montgomery County Code, 1971, as amended, you are hereby notified that a Fire Lane has been established as described in this order. You are hereby ordered to post fire lane signs and paint curbs/pavement (painting optional) as identified below. When signs and paint work (painting optional) have been completed, this order will authorize the enforcement of this Fire Lane by appropriate police and fire officials. Compliance with this order must be achieved within 30 days of receipt.

LOCATION: 9111 River Rd.

All areas where indicated by signs and paint.

SIGNS -- (See attached diagram for location of sign placement)



\$250 FINE

FIRE LANE

Signs must be posted so that it is not possible to park a vehicle without being in sight of a sign. Signs may be no further apart than 100 feet

(Red letters on white background)

PAINT -- (See attached diagram if painting).

Paint must be traffic yellow with lines of sufficient width to be readily identifiable/readable by motor vehicle operators.



Fire Marshal, Montgomery County Department of Permitting Services

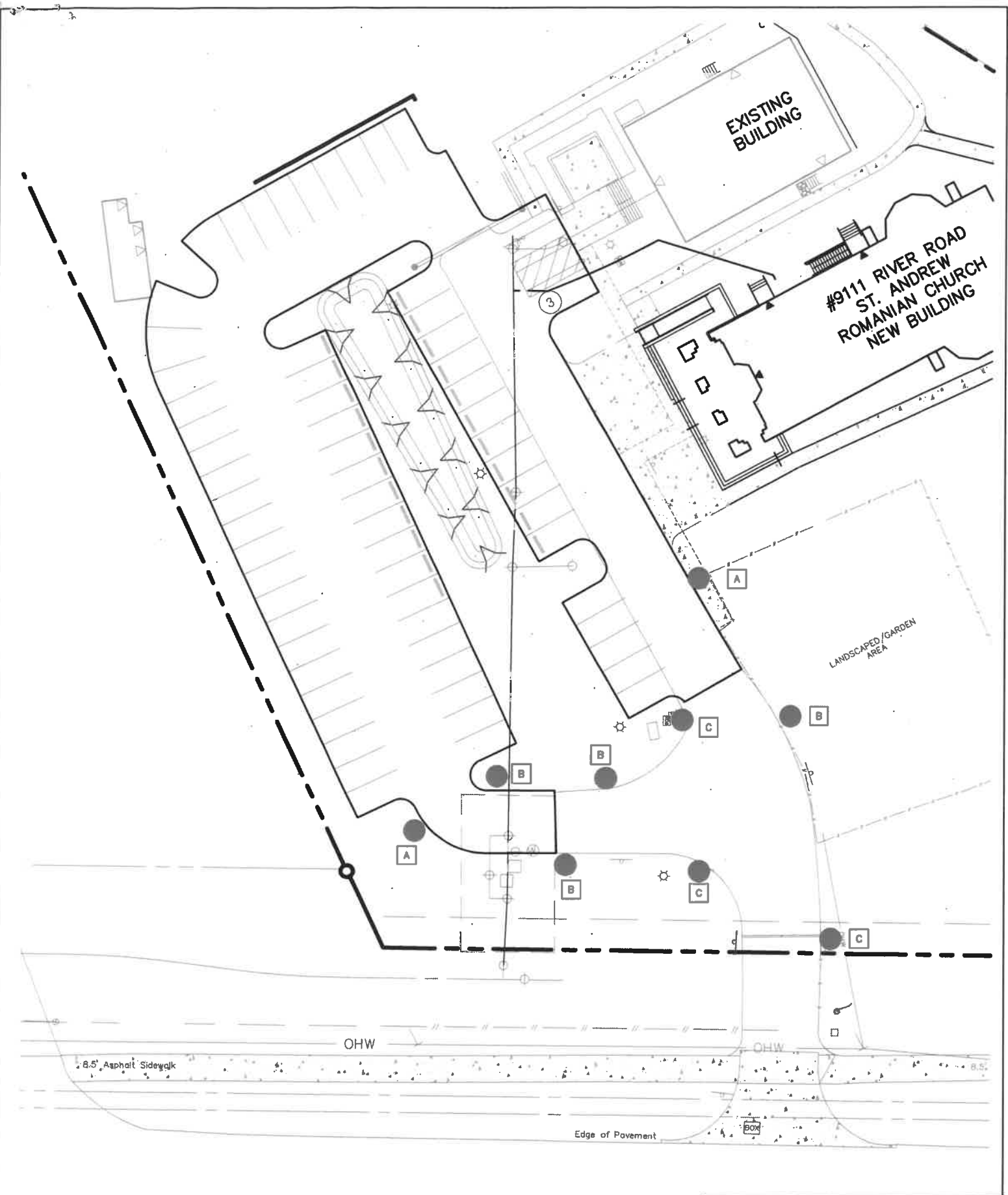

LEGEND
 ● FIRE LANE SIGN
 SEE SHEET 2 OF 2

FIRE SIGNAGE PLAN
 LOT 34, BLOCK 9
ST. ANDREW CHURCH
 BRADLEY FARMS
 10TH ELECTION DISTRICT - MONTGOMERY COUNTY - MARYLAND

Proj. Mgr. BJD	Designer BJD
Date 08/20/2018	Scale 1" = 40'
Project No. 2018.130.14	Sheet 1 of 2

MHG Macris, Hendricks & Glascock, P.A.
 Engineers • Planners
 Landscape Architects • Surveyors
 8220 Wighman Road, Suite 120
 Montgomery Village, Maryland
 20886-1218
 Phone 301.670.0840
 Fax 301.948.0263
 www.mhga.com



Either type may be used provided the same type is used consistently.



A

←100 ft.→



B

←100 ft.→



C

Begin/End Restriction signs shall have the arrow pointing toward the restricted area. Restricted Area signs shall have arrows pointing in both directions.

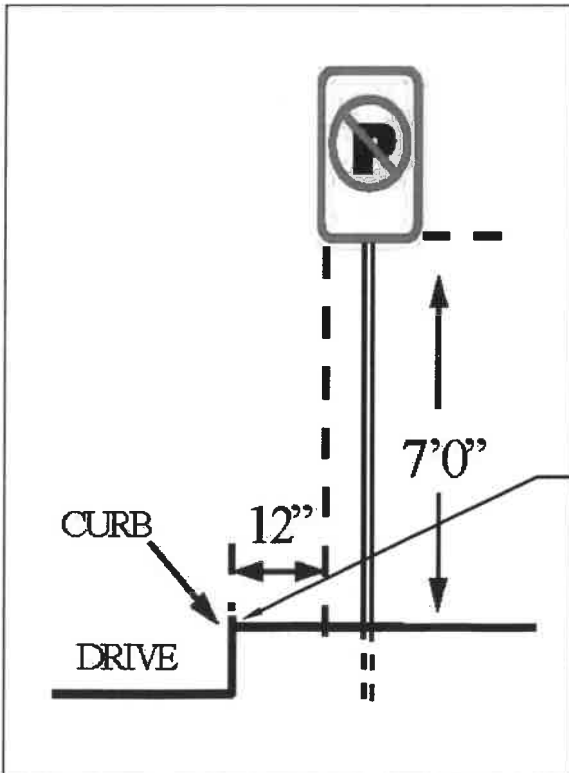

No curb exists. Signs shall be located 12" from the edge of pavement.

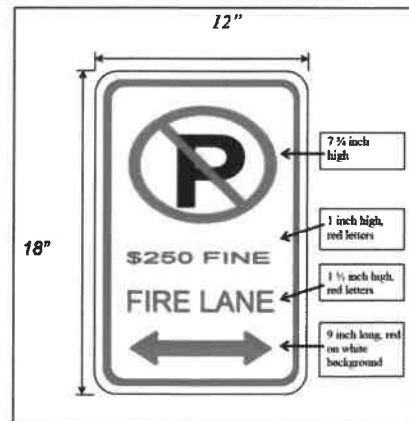

Lettering Detail

FIRE SIGNAGE PLAN
LOT 34, BLOCK 9
ST. ANDREW CHURCH
 BRADLEY FARMS
 10TH ELECTION DISTRICT - MONTGOMERY COUNTY - MARYLAND

Macris, Hendricks & Glascock, P.A. Engineers • Planners Landscape Architects • Surveyors <small>9220 Wightman Road, Suite 120 Montgomery Village, Maryland 20886-1279</small>	Proj. Mgr. BJD	Designer BJD
	Date 08/20/19	Scale NTS
	Project No. 2014.130.14	Sheet 2 of 2