



MONTGOMERY COUNTY EXECUTIVE ORDER

Offices of the County Executive • 101 Monroe Street • Rockville, Maryland 20850

Subject Fire Lane Establishment Order for Brookside Gardens (revision)	Executive Order No. 164-13	Subject Suffix
Originating Department Montgomery County Fire and Rescue Service	Department Number MCFRS 27-13	Effective Date 9/26/2013

Fire Lane Establishment Order

Pursuant to Section 22 - 33, Montgomery County Code, 1971, as amended, you are hereby notified that a Fire Lane has been established as described in this order. You are hereby ordered to post fire lane signs and paint curbs/pavement (painting optional) as identified below. When signs and paint work (painting optional) have been completed, this order will authorize the enforcement of this Fire Lane by appropriate police and fire officials. Compliance with this order must be achieved within 30 days of receipt.

LOCATION: Brookside Gardens revision to MCFRS 25-13
1800 Glenallan Ave.

All areas where indicated by signs and paint.

- SIGNS - - (See attached diagram for location of sign placement)



\$250 FINE

FIRE LANE

Signs must be posted so that it is not possible to park a vehicle without being in sight of a sign. Signs may be no further apart than 100 feet

(Red letters on white background)

- PAINT - - (See attached diagram if painting).

Paint must be traffic yellow with lines of sufficient width to be readily identifiable/readable by motor vehicle operators.

John J. Kelly 9/30/13

Fire Chief, Montgomery County Fire and Rescue Service

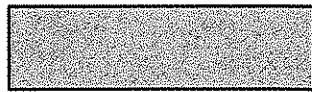

NEW ASPHALT PAVEMENT



NEW OR REDEVELOPED
HARDSCAPE



PERMEABLE PAVING (SWM)



FIRE APPARATUS
ACCESS ROUTE



FIREFIGHTER
ACCESS ROUTE



FIRE DEPARTMENT
CONNECTION



FIRE HYDRANT



MAIN SIDE HINGE
LOCATION



FIRE LANE NO
PARKING SIGN

NOTES:

1. PROVIDE SIGNAGE IN ACCORDANCE WITH MONTGOMERY COUNTY FIRE AND RESCUE DOCUMENT "FIRE LANE SIGN REQUIREMENTS INFORMATION PACKET, PRIVATE STREETS" DATED MAY 2008

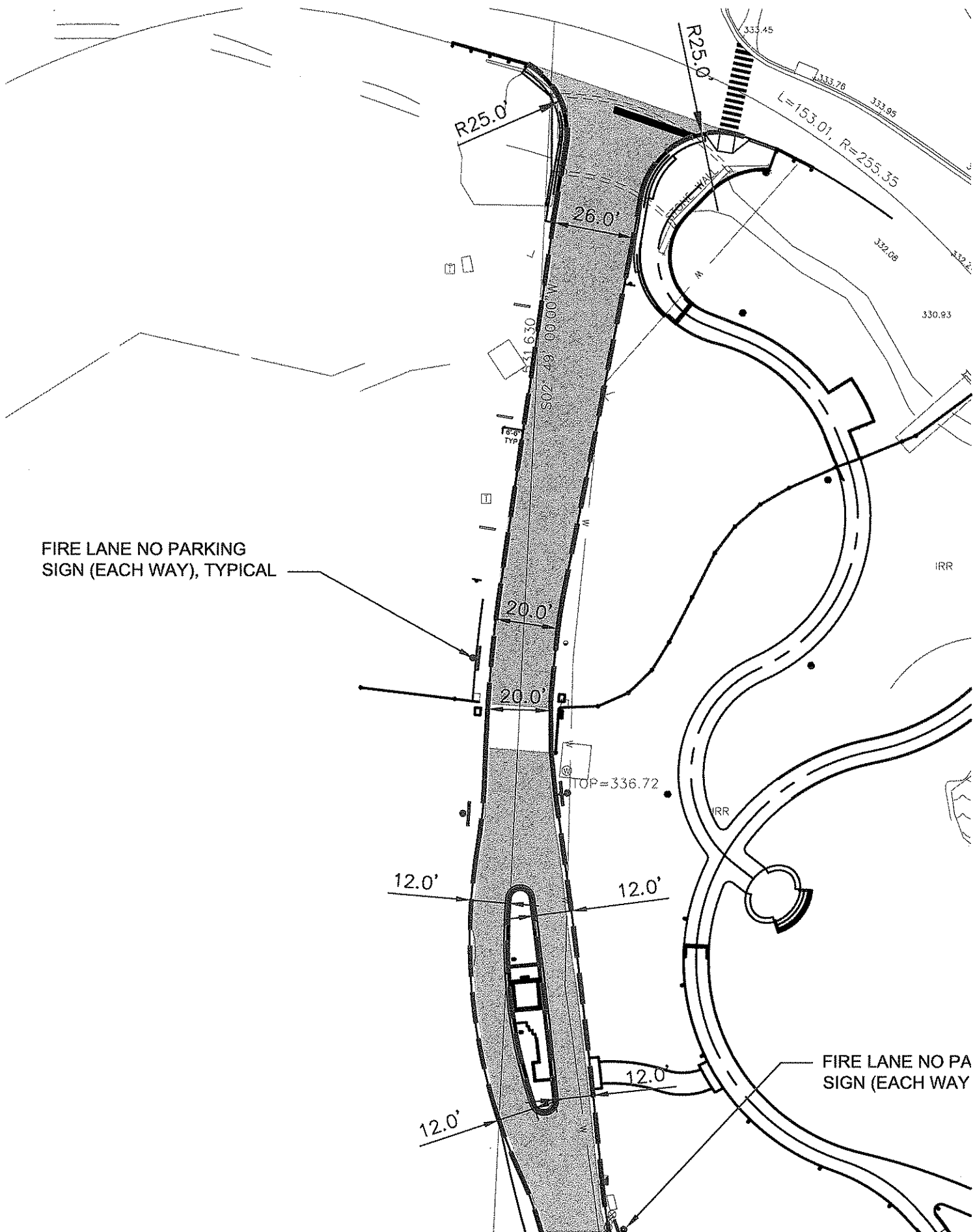

FIRE LANE NO PARKING
SIGN (EACH WAY), TYPICAL

FIRE LANE NO PA
SIGN (EACH WAY)

SEE PAGE 4

SCALE: 1" = 40'

PAGE 3

SEE PAGE 3

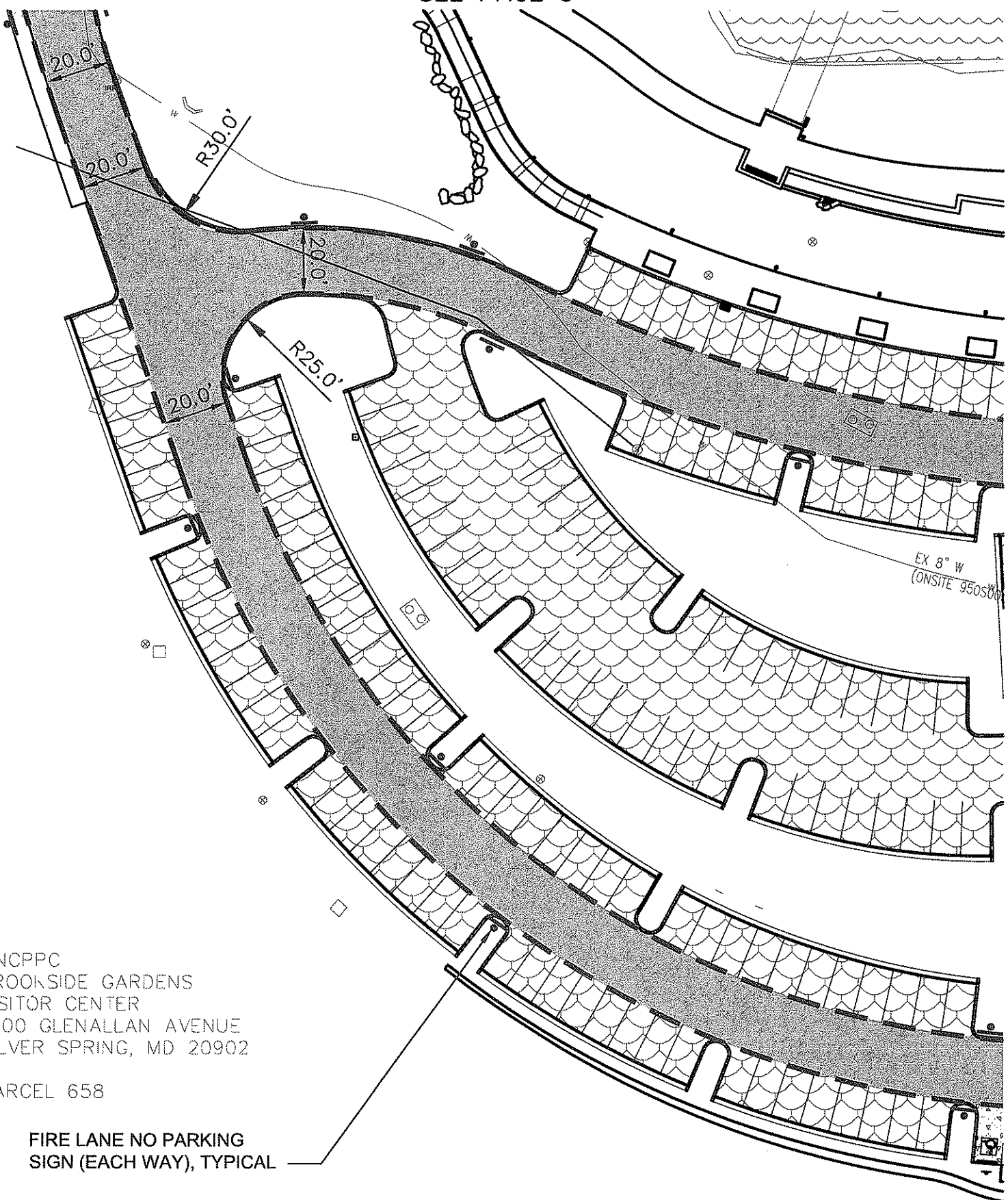

SEE PAGE 5

1/4 NCPPC
 3/8 BROOKSIDE GARDENS
 1/4 VISITOR CENTER
 800 GLENALLAN AVENUE
 SILVER SPRING, MD 20902

PARCEL 658

FIRE LANE NO PARKING
 SIGN (EACH WAY), TYPICAL

SCALE: 1" = 40'

PAGE 4

FIRE LANE NO PARKING
SIGN (EACH WAY), TYPICAL

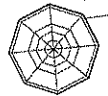

IRR

EXISTING FIRE HYDRANT
(TO BE REMOVED)

SEE PAGE 4

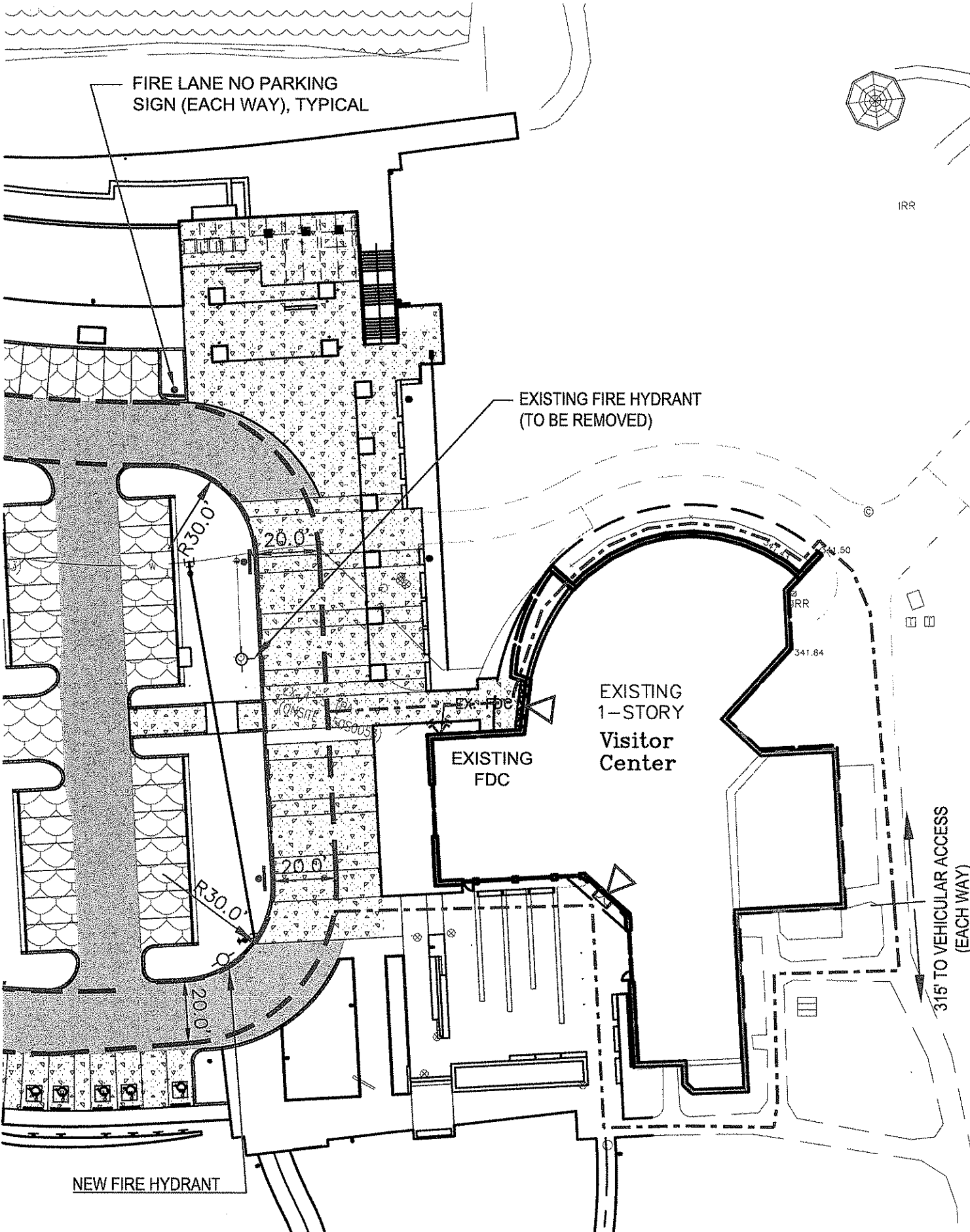

SCALE: 1" = 40'

PAGE 5