



# MONTGOMERY COUNTY EXECUTIVE ORDER

Offices of the County Executive • 101 Monroe Street • Rockville, Maryland 20850

Subject Fire Lane Establishment Order for Mont. Cty. Multi-Agency Svc. Park	Executive Order No. 17-14	Subject Suffix
Originating Department Montgomery County Fire and Rescue Service	Department Number MCFRS 5-14	Effective Date 1/24/2014

### Fire Lane Establishment Order

Pursuant to Section 22 - 33, Montgomery County Code, 1971, as amended, you are hereby notified that a Fire Lane has been established as described in this order. You are hereby ordered to post fire lane signs and paint curbs/pavement (painting optional) as identified below. When signs and paint work (painting optional) have been completed, this order will authorize the enforcement of this Fire Lane by appropriate police and fire officials. Compliance with this order must be achieved within 30 days of receipt.

LOCATION: 8751 Snouffer School Rd.  
\_\_\_\_\_  
\_\_\_\_\_

All areas where indicated by signs and paint.

SIGNS - - (See attached diagram for location of sign placement)



\$250 FINE

FIRE LANE

Signs must be posted so that it is not possible to park a vehicle without being in sight of a sign. Signs may be no further apart than 100 feet

(Red letters on white background)

PAINT - - (See attached diagram if painting).

Paint must be traffic yellow with lines of sufficient width to be readily identifiable/readable by motor vehicle operators.

\_\_\_\_\_  
Fire Chief, Montgomery County Fire and Rescue Service

The original of this drawing document was prepared by Soltesz, Inc. (Soltesz). If this document was not obtained directly from Soltesz and/or it was transmitted electronically, Soltesz cannot guarantee that unauthorized changes and / or alterations were not made by others. If verification of the information contained hereon is needed, contact should be made directly with Soltesz. Soltesz makes no warranties, express or implied, concerning the accuracy of any information that has been transmitted by electronic means.

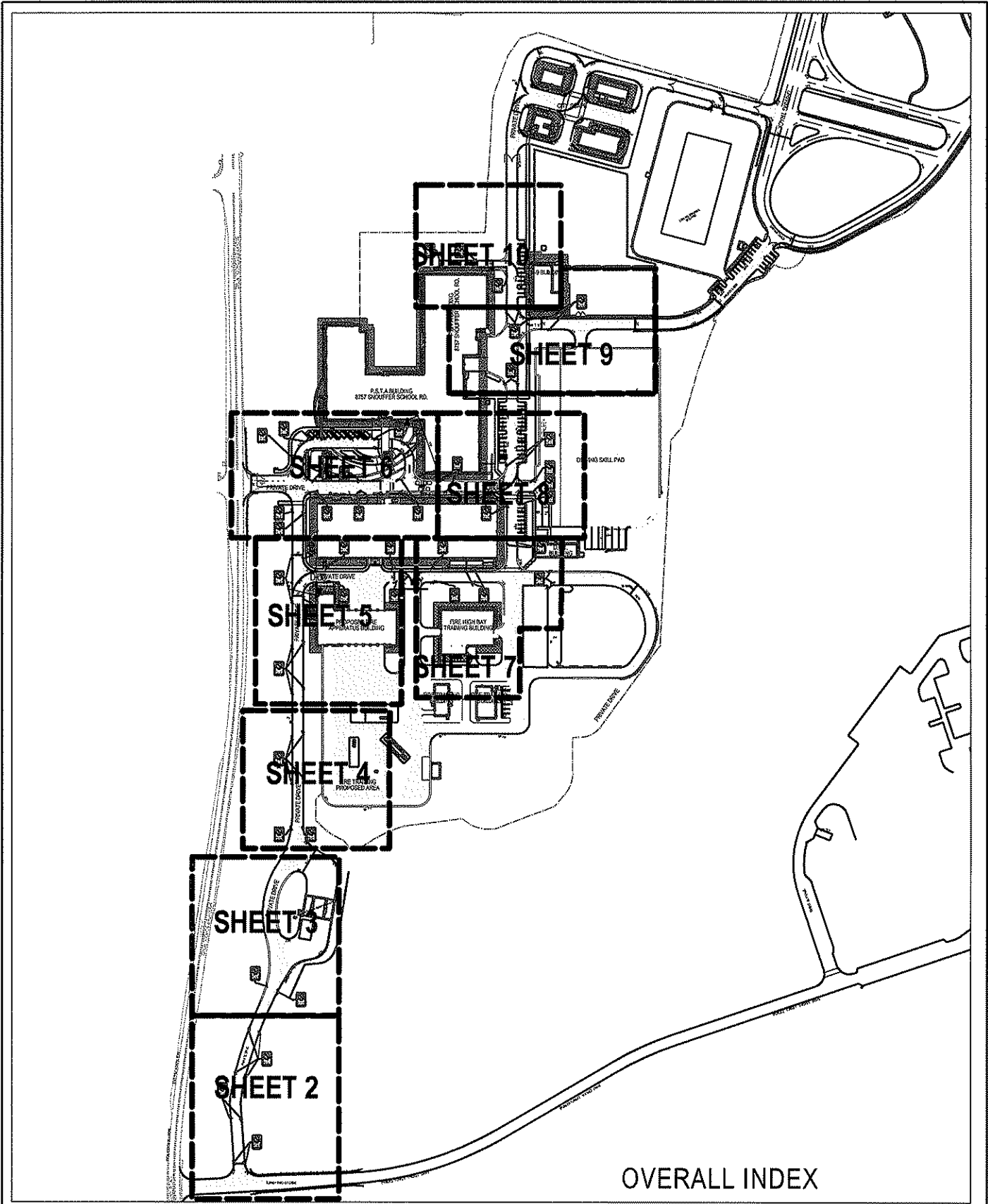

**SOLTESZ**  
 2 Research Place, Suite 100  
 Rockville, MD 20850  
 P.301.948.2750 F.301.948.9067  
 www.solteszco.com

FIRE ORDER SIGNAGE PLAN - PSTA  
 PSTA & MONTGOMERY COUNTY  
 MULLTI AGENCY SERVICE PARK  
 LAYTONSVILLE (1st) ELECTION DISTRICT  
 MONTGOMERY COUNTY, MARYLAND 1 OF 10

JOB NO. 1989-00-00	SCALE 1" = 50'	DATE 07/10/2013
-----------------------	-------------------	--------------------

1/16/2014 12:07:57 PM

The original of this drawing document was prepared by Soltesz, Inc. (Soltesz). If this document was not obtained directly from Soltesz and/or it was transmitted electronically, Soltesz cannot guarantee that unauthorized changes and / or alterations were not made by others. If verification of the information contained hereon is needed, contact should be made directly with Soltesz. Soltesz makes no warranties, express or implied, concerning the accuracy of any information that has been transmitted by electronic means.

SCALE: 1" = 50'

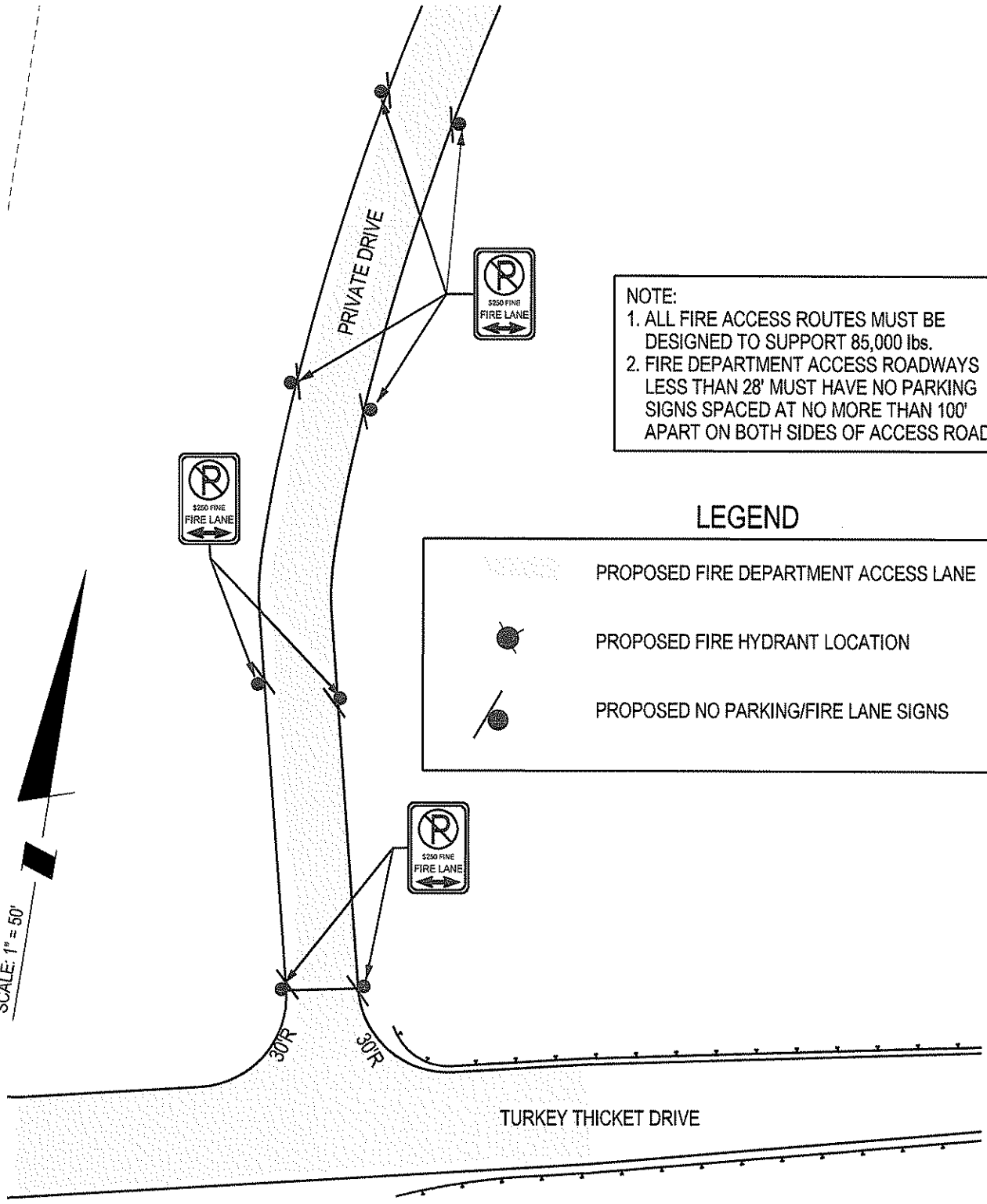

**NOTE:**  
 1. ALL FIRE ACCESS ROUTES MUST BE DESIGNED TO SUPPORT 85,000 lbs.  
 2. FIRE DEPARTMENT ACCESS ROADWAYS LESS THAN 28' MUST HAVE NO PARKING SIGNS SPACED AT NO MORE THAN 100' APART ON BOTH SIDES OF ACCESS ROAD.

**LEGEND**

	PROPOSED FIRE DEPARTMENT ACCESS LANE
	PROPOSED FIRE HYDRANT LOCATION
	PROPOSED NO PARKING/FIRE LANE SIGNS



**SOLTESZ**  
 2 Research Place, Suite 100  
 Rockville, MD 20850  
 P.301.948.2750 F.301.948.9067  
 www.solteszco.com



FIRE ORDER SIGNAGE PLAN - PSTA  
 PSTA & MONTGOMERY COUNTY  
 MULLTI AGENCY SERVICE PARK  
 LAYTONSVILLE (1st) ELECTION DISTRICT  
 MONTGOMERY COUNTY, MARYLAND 2 OF 10

JOB NO. 1989-00-00	SCALE 1" = 50'	DATE 07/10/2013
-----------------------	-------------------	--------------------

The original of this drawing document was prepared by Soltesz, Inc. (Soltesz). If this document was not obtained directly from Soltesz and/or it was transmitted electronically, Soltesz cannot guarantee that unauthorized changes and / or alterations were not made by others. If verification of the information contained hereon is needed, contact should be made directly with Soltesz. Soltesz makes no warranties, express or implied, concerning the accuracy of any information that has been transmitted by electronic means.

**NOTE:**  
 1. ALL FIRE ACCESS ROUTES MUST BE DESIGNED TO SUPPORT 85,000 lbs.  
 2. FIRE DEPARTMENT ACCESS ROADWAYS LESS THAN 28' MUST HAVE NO PARKING SIGNS SPACED AT NO MORE THAN 100' APART ON BOTH SIDES OF ACCESS ROAD.

**LEGEND**

-  PROPOSED FIRE DEPARTMENT ACCESS LANE
-  PROPOSED FIRE HYDRANT LOCATION
-  PROPOSED NO PARKING/FIRE LANE SIGNS

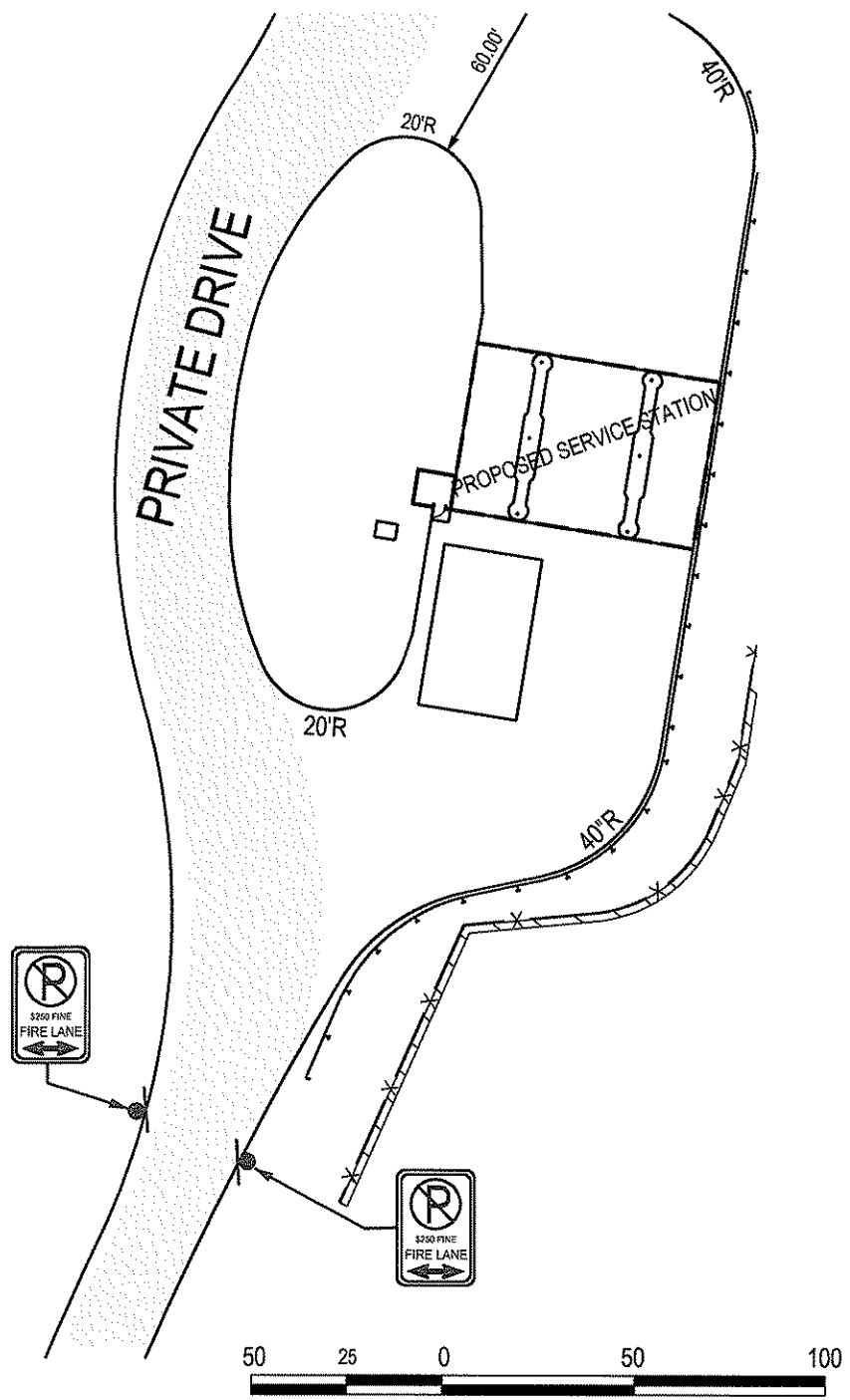
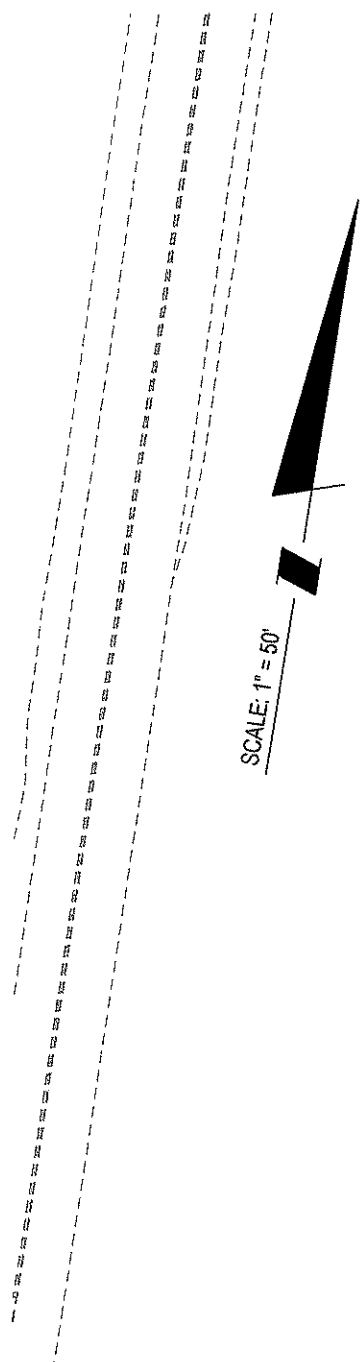

**SOLTESZ**  
 2 Research Place, Suite 100  
 Rockville, MD 20850  
 P.301.948.2750 F.301.948.9067  
 www.solteszco.com

**FIRE ORDER SIGNAGE PLAN - PSTA**  
**PSTA & MONTGOMERY COUNTY**  
**MULLTI AGENCY SERVICE PARK**  
 LAYTONSVILLE (1st) ELECTION DISTRICT  
 MONTGOMERY COUNTY, MARYLAND 3 OF 10



JOB NO. 1989-00-00	SCALE 1" = 50'	DATE 07/10/2013
-----------------------	-------------------	--------------------

1/16/2014 12:08:00 PM

The original of this drawing document was prepared by Soltesz, Inc. (Soltesz). If this document was not obtained directly from Soltesz and/or it was transmitted electronically, Soltesz cannot guarantee that unauthorized changes and / or alterations were not made by others. If verification of the information contained hereon is needed, contact should be made directly with Soltesz. Soltesz makes no warranties, express or implied, concerning the accuracy of any information that has been transmitted by electronic means.

### LEGEND

**NOTE:**  
 1. ALL FIRE ACCESS ROUTES MUST BE DESIGNED TO SUPPORT 85,000 lbs.  
 2. FIRE DEPARTMENT ACCESS ROADWAYS LESS THAN 28' MUST HAVE NO PARKING SIGNS SPACED AT NO MORE THAN 100' APART ON BOTH SIDES OF ACCESS ROAD.

	PROPOSED FIRE DEPARTMENT ACCESS LANE
	PROPOSED FIRE HYDRANT LOCATION
	PROPOSED NO PARKING/FIRE LANE SIGNS

SCALE: 1" = 50'

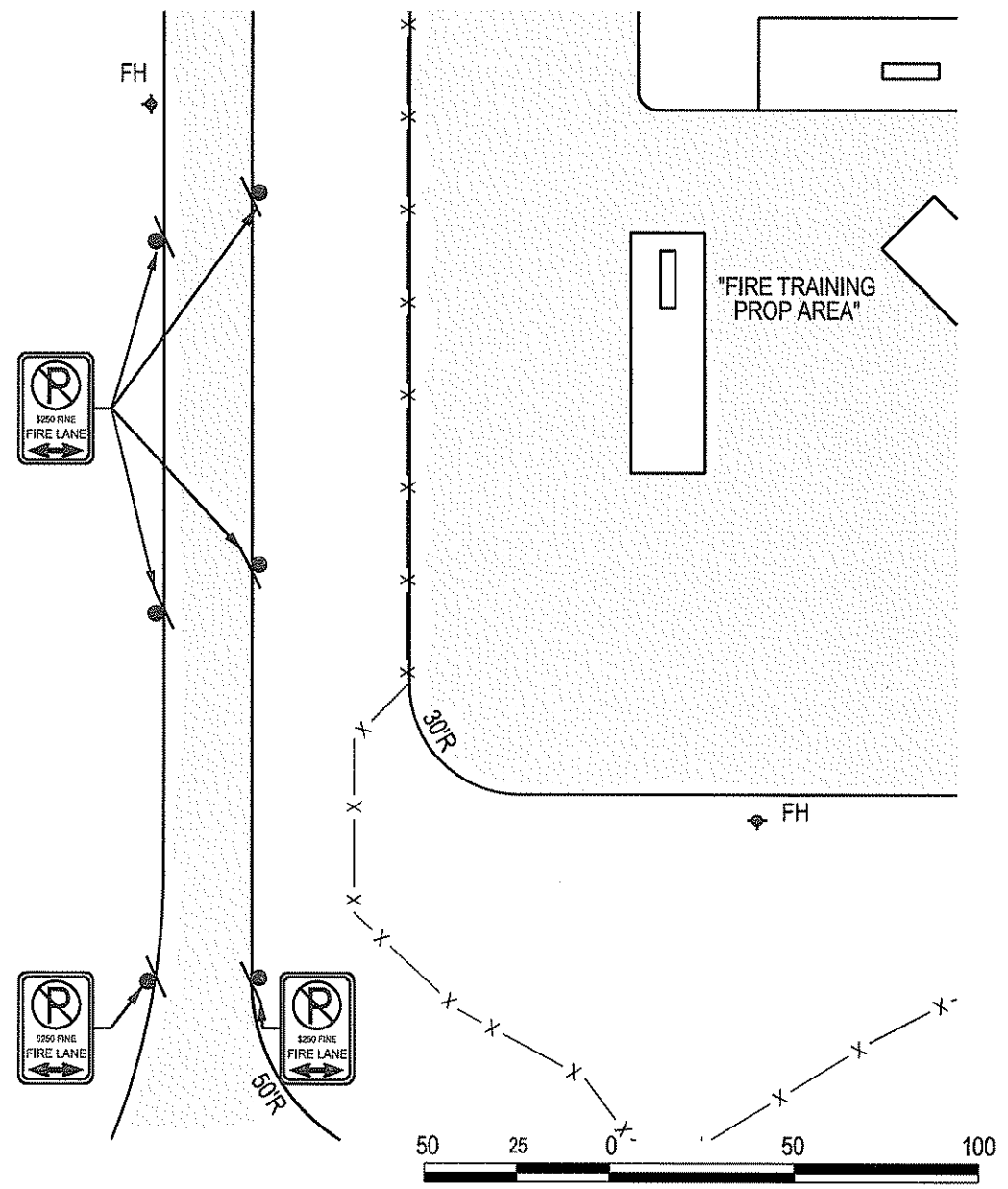

**SOLTESZ**  
 2 Research Place, Suite 100  
 Rockville, MD 20850  
 P.301.948.2750 F.301.948.9067  
 www.solteszco.com



FIRE ORDER SIGNAGE PLAN - PSTA  
 PSTA & MONTGOMERY COUNTY  
 MULLTI AGENCY SERVICE PARK  
 LAYTONSVILLE (1st) ELECTION DISTRICT  
 MONTGOMERY COUNTY, MARYLAND 4 OF 10

JOB NO. 1989-00-00	SCALE 1" = 50'	DATE 07/10/2013
-----------------------	-------------------	--------------------

1/16/2014 12:08:01 PM

The original of this drawing document was prepared by Soltesz, Inc. (Soltesz). If this document was not obtained directly from Soltesz and/or it was transmitted electronically, Soltesz cannot guarantee that unauthorized changes and / or alterations were not made by others. If verification of the information contained hereon is needed, contact should be made directly with Soltesz. Soltesz makes no warranties, express or implied, concerning the accuracy of any information that has been transmitted by electronic means.

**LEGEND**

-  PROPOSED FIRE DEPARTMENT ACCESS LANE
-  PROPOSED FIRE HYDRANT LOCATION
-  PROPOSED NO PARKING/FIRE LANE SIGNS

**NOTE:**

1. ALL FIRE ACCESS ROUTES MUST BE DESIGNED TO SUPPORT 85,000 lbs.
2. FIRE DEPARTMENT ACCESS ROADWAYS LESS THAN 28' MUST HAVE NO PARKING SIGNS SPACED AT NO MORE THAN 100' APART ON BOTH SIDES OF ACCESS ROAD.

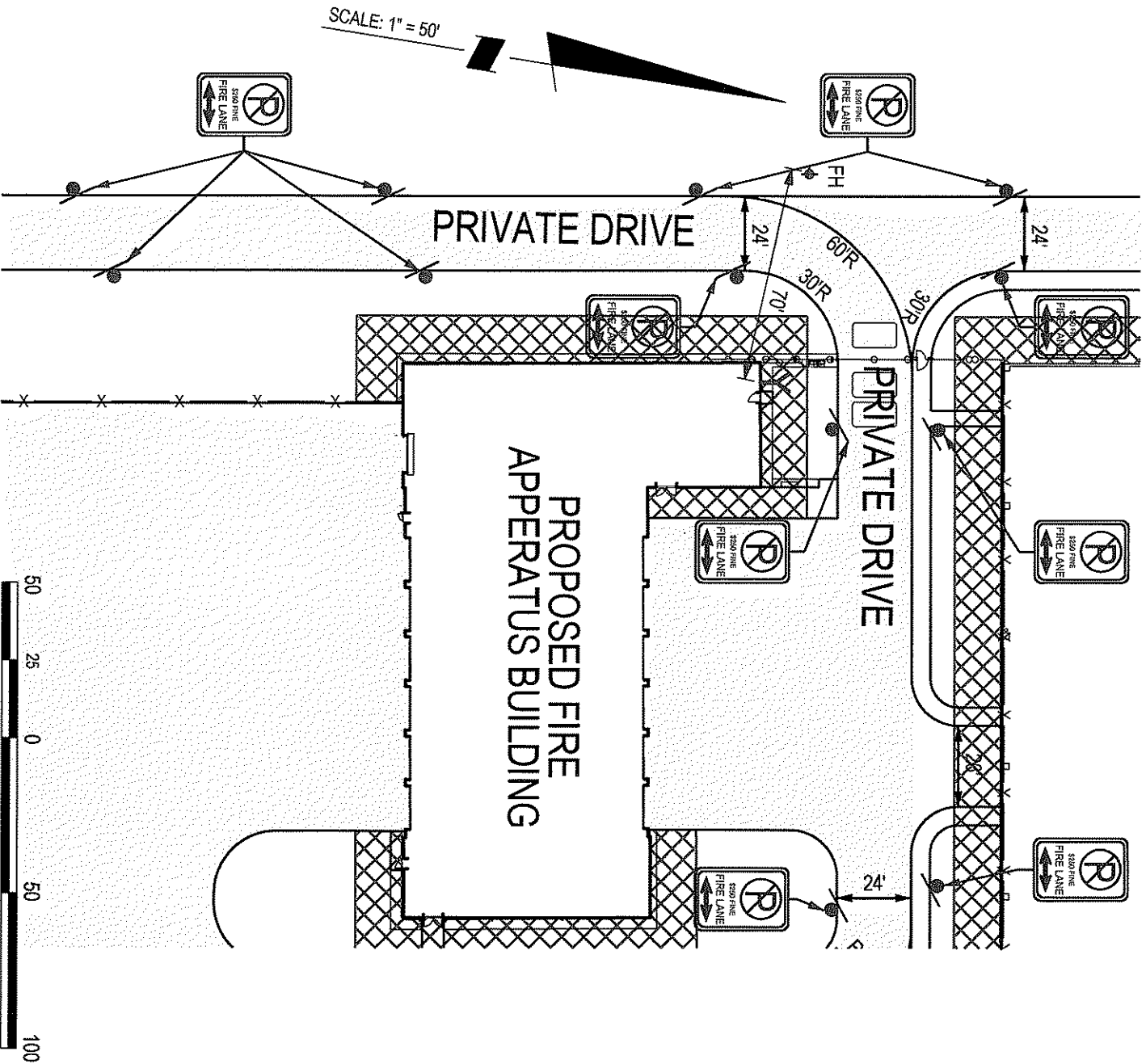

**SOLTESZ**  
 2 Research Place, Suite 100  
 Rockville, MD 20850  
 P.301.948.2750 F.301.948.9067  
 www.solteszco.com

**FIRE ORDER SIGNAGE PLAN - PSTA  
 PSTA & MONTGOMERY COUNTY  
 MULTI AGENCY SERVICE PARK  
 LAYTONSVILLE (1st) ELECTION DISTRICT  
 MONTGOMERY COUNTY, MARYLAND 5 OF 10**

JOB NO. 1989-00-00 SCALE 1" = 50' DATE 07/10/2013

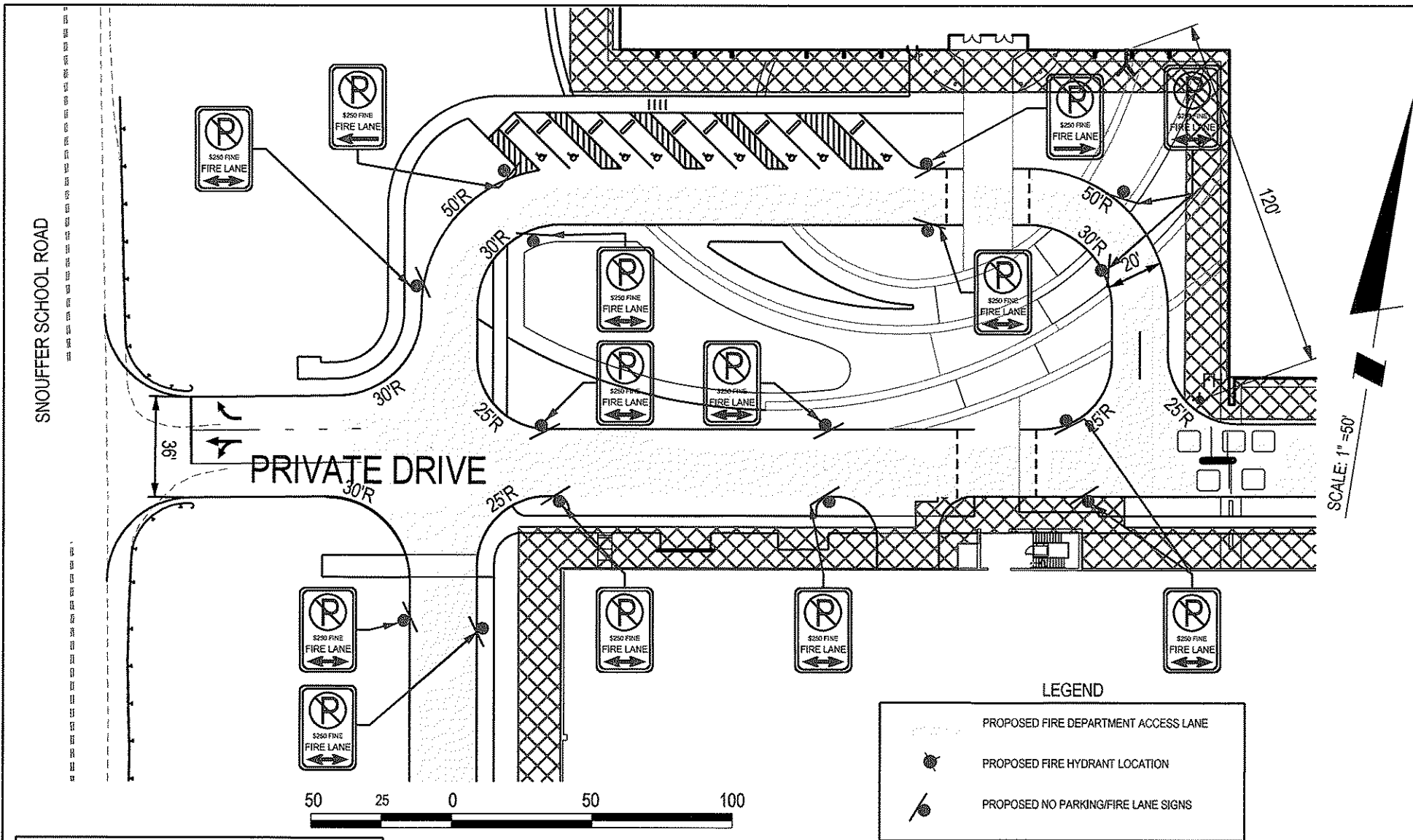

- NOTE:**
1. ALL FIRE ACCESS ROUTES MUST BE DESIGNED TO SUPPORT 85,000 lbs.
  2. FIRE DEPARTMENT ACCESS ROADWAYS LESS THAN 28' MUST HAVE NO PARKING SIGNS SPACED AT NO MORE THAN 100' APART ON BOTH SIDES OF ACCESS ROAD.



**SOLTESZ**  
 2 Research Place, Suite 100  
 Rockville, MD 20850  
 P.301.948.2750 F.301.948.9067  
 www.solteszco.com

**LEGEND**

	PROPOSED FIRE DEPARTMENT ACCESS LANE
	PROPOSED FIRE HYDRANT LOCATION
	PROPOSED NO PARKING/FIRE LANE SIGNS

**FIRE ORDER SIGNAGE PLAN - PSTA  
 PSTA & MONTGOMERY COUNTY  
 MULLTI AGENCY SERVICE PARK  
 LAYTONSVILLE (1st) ELECTION DISTRICT  
 MONTGOMERY COUNTY, MARYLAND 6 OF 10**

JOB NO. 1989-00-00	SCALE 1" = 50'	DATE 06/05/2013
-----------------------	-------------------	--------------------

The original of this drawing document was prepared by Soltesz, Inc. (Soltesz). If this document was not obtained directly from Soltesz and/or it was transmitted electronically, Soltesz cannot guarantee that unauthorized changes and / or alterations were not made by others. If verification of the information contained hereon is needed, contact should be made directly with Soltesz. Soltesz makes no warranties, express or implied, concerning the accuracy of any information that has been transmitted by electronic means.

The original of this drawing document was prepared by Soltesz, Inc. (Soltesz). If this document was not obtained directly from Soltesz and/or it was transmitted electronically, Soltesz cannot guarantee that unauthorized changes and / or alterations were not made by others. If verification of the information contained hereon is needed, contact should be made directly with Soltesz. Soltesz makes no warranties, express or implied, concerning the accuracy of any information that has been transmitted by electronic means.

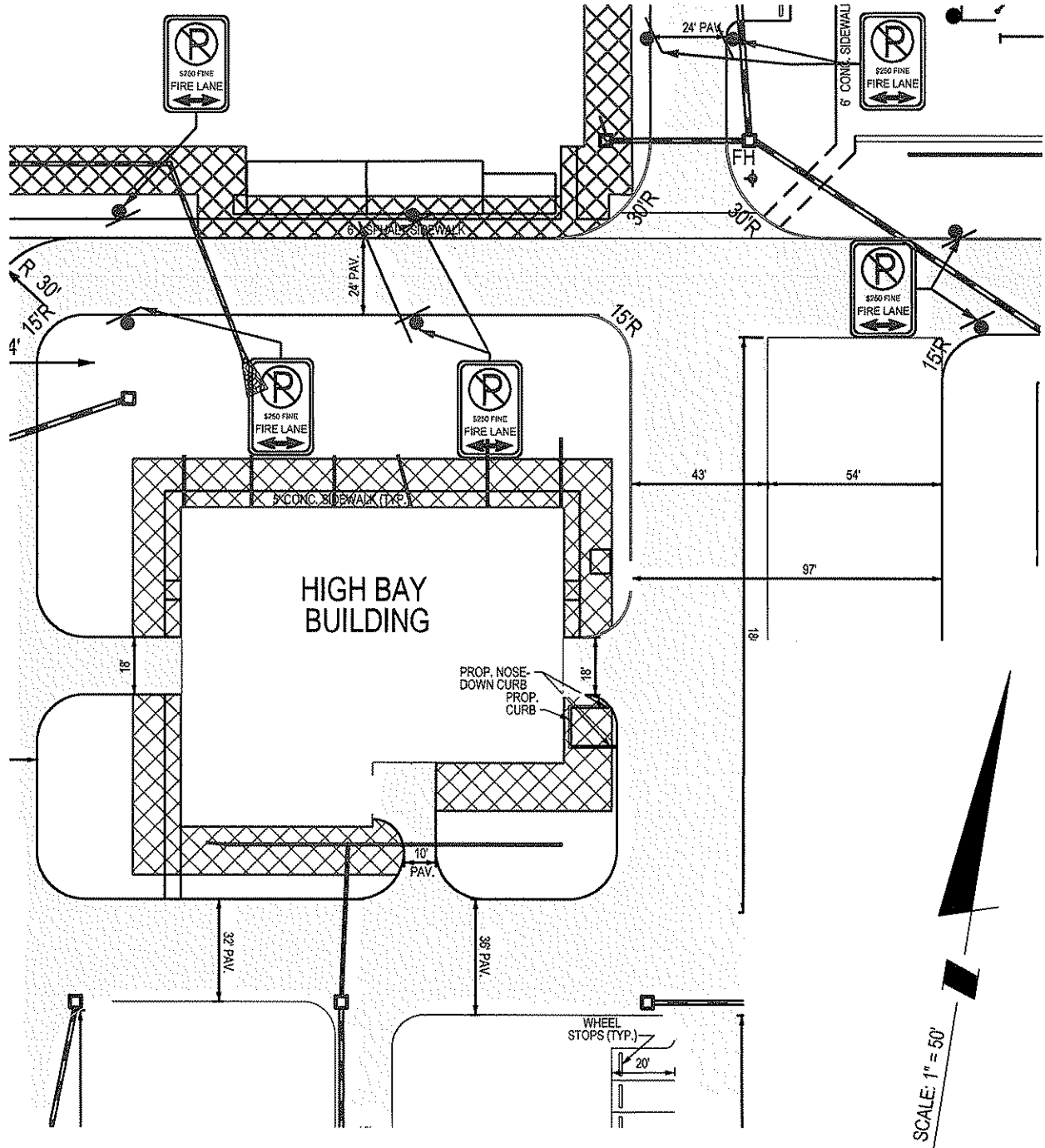

**LEGEND**

	PROPOSED FIRE DEPARTMENT ACCESS LANE
	PROPOSED FIRE HYDRANT LOCATION
	PROPOSED NO PARKING/FIRE LANE SIGNS



**SOLTESZ**  
 2 Research Place, Suite 100  
 Rockville, MD 20850  
 P.301.948.2750 F.301.948.9067  
 www.solteszco.com

**FIRE ORDER SIGNAGE PLAN - PSTA  
 PSTA & MONTGOMERY COUNTY  
 MULLTI AGENCY SERVICE PARK  
 LAYTONSVILLE (1st) ELECTION DISTRICT  
 MONTGOMERY COUNTY, MARYLAND**

7 OF 10

JOB NO. 1989-00-00	SCALE 1" = 50'	DATE 07/10/2013
-----------------------	-------------------	--------------------

1/16/2014 12:08:05 PM



The original of this drawing document was prepared by Soltesz, Inc. (Soltesz). If this document was not obtained directly from Soltesz and/or it was transmitted electronically, Soltesz cannot guarantee that unauthorized changes and / or alterations were not made by others. If verification of the information contained hereon is needed, contact should be made directly with Soltesz. Soltesz makes no warranties, express or implied, concerning the accuracy of any information that has been transmitted by electronic means.

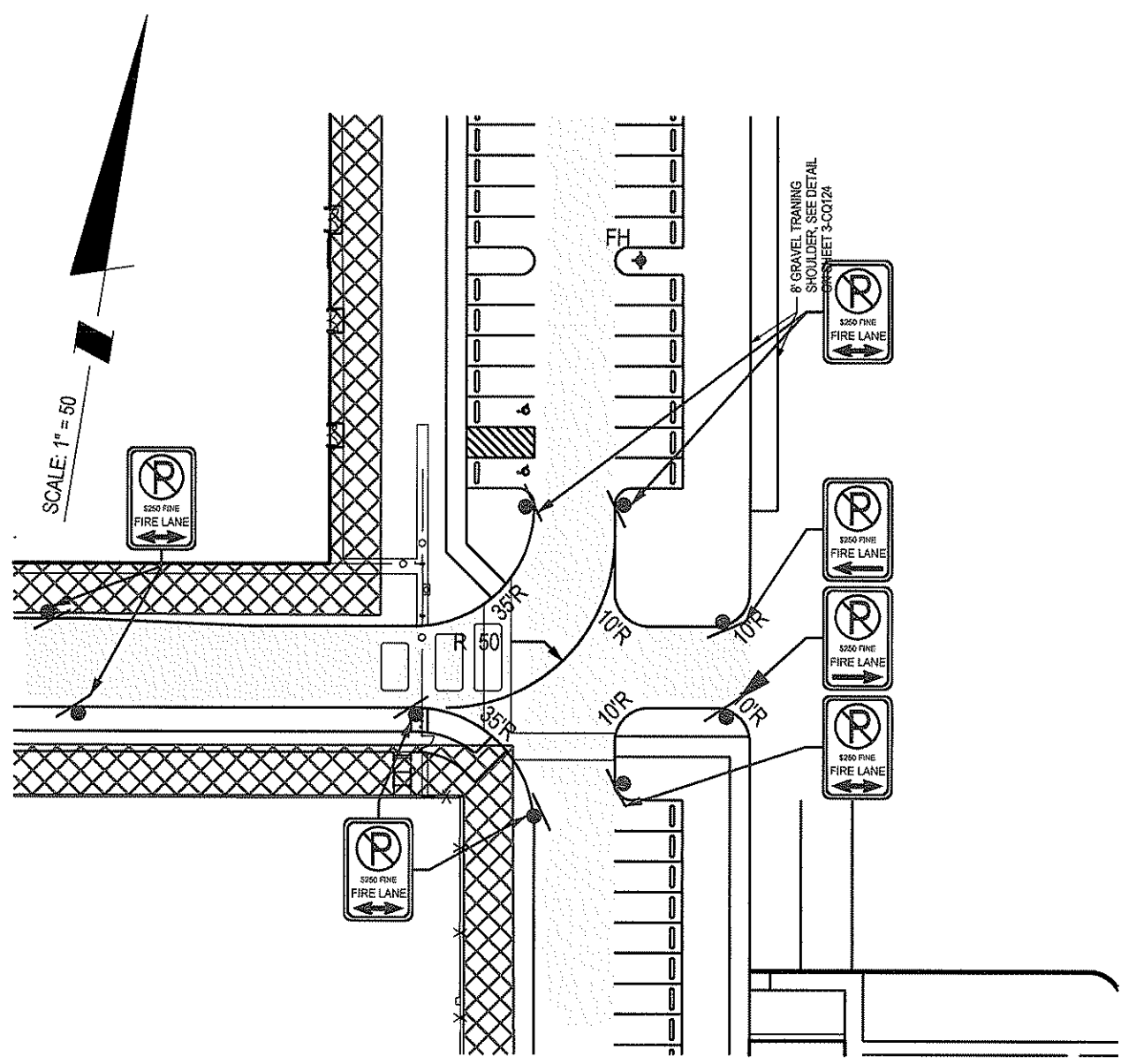

**NOTE:**  
 1. ALL FIRE ACCESS ROUTES MUST BE DESIGNED TO SUPPORT 85,000 lbs.  
 2. FIRE DEPARTMENT ACCESS ROADWAYS LESS THAN 28' MUST HAVE NO PARKING SIGNS SPACED AT NO MORE THAN 100' APART ON BOTH SIDES OF ACCESS ROAD.

**LEGEND**

	PROPOSED FIRE DEPARTMENT ACCESS LANE
	PROPOSED FIRE HYDRANT LOCATION
	PROPOSED NO PARKING/FIRE LANE SIGNS



**SOLTESZ**  
 2 Research Place, Suite 100  
 Rockville, MD 20850  
 P.301.948.2750 F.301.948.9067  
 www.solteszco.com

**FIRE ORDER SIGNAGE PLAN - PSTA  
 PSTA & MONTGOMERY COUNTY  
 MULLTI AGENCY SERVICE PARK  
 LAYTONSVILLE (1st) ELECTION DISTRICT  
 MONTGOMERY COUNTY, MARYLAND**

8 OF 10

JOB NO. 1989-00-00	SCALE 1" = 50'	DATE 07/10/2013
-----------------------	-------------------	--------------------

1/16/2014 12:08:08 PM

**LEGEND**

 PROPOSED FIRE DEPARTMENT ACCESS LANE

 PROPOSED FIRE HYDRANT LOCATION

 PROPOSED NO PARKING/FIRE LANE SIGNS

**NOTE:**

1. ALL FIRE ACCESS ROUTES MUST BE DESIGNED TO SUPPORT 85,000 lbs.
2. FIRE DEPARTMENT ACCESS ROADWAYS LESS THAN 28' MUST HAVE NO PARKING SIGNS SPACED AT NO MORE THAN 100' APART ON BOTH SIDES OF ACCESS ROAD.

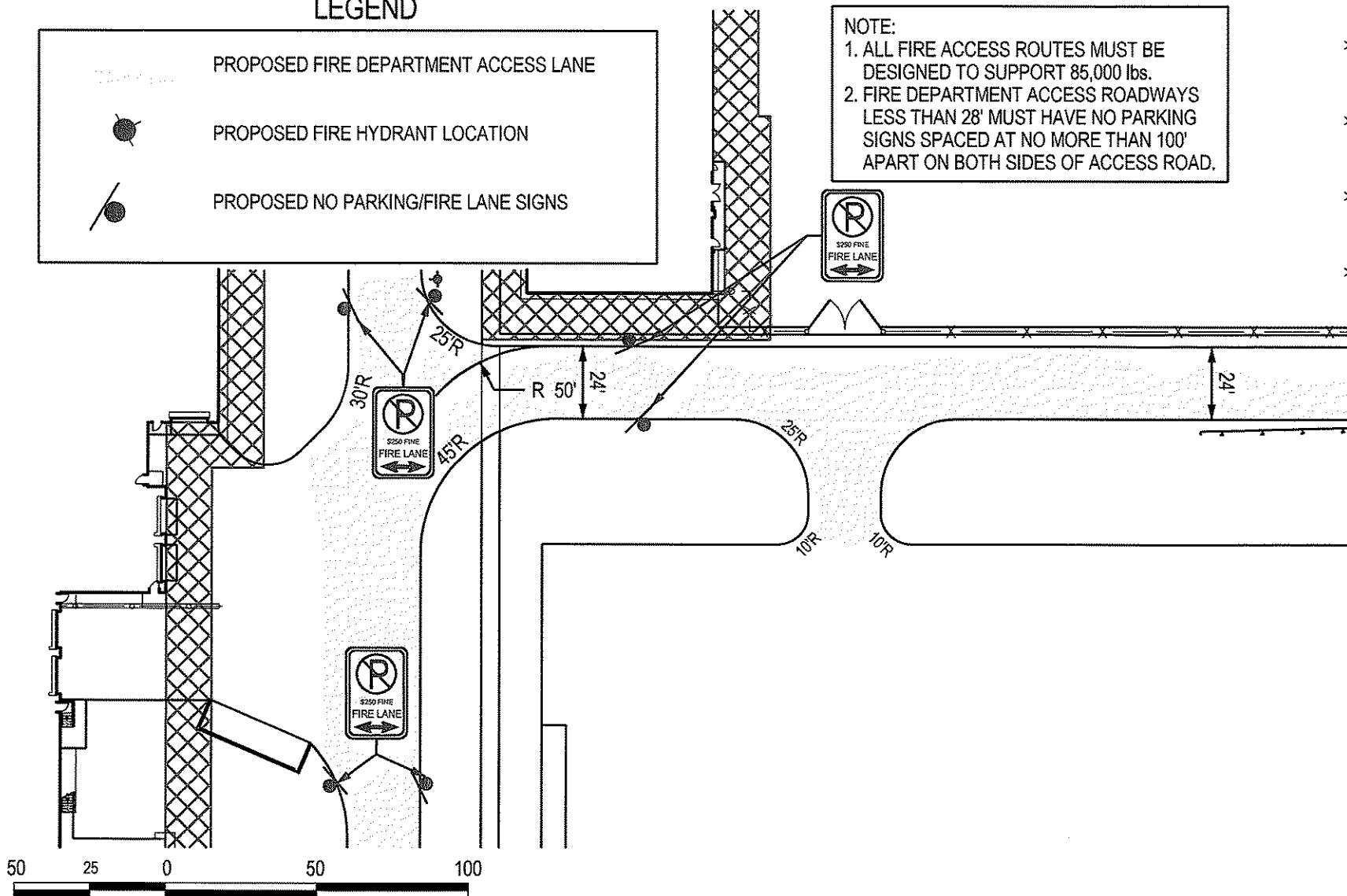

**SOLTESZ**  
 2 Research Place, Suite 100  
 Rockville, MD 20850  
 P.301.948.2750 F.301.948.9067  
 www.solteszco.com



FIRE ORDER SIGNAGE PLAN - PSTA  
**PSTA & MONTGOMERY COUNTY**  
**MULLTI AGENCY SERVICE PARK**  
 LAYTONSVILLE (1st) ELECTION DISTRICT  
 MONTGOMERY COUNTY, MARYLAND 9 OF 10

JOB NO.	1989-00-00	SCALE	1" = 50'	DATE	06/05/2013
---------	------------	-------	----------	------	------------

1/16/2014 12:08:09 PM

The original of this drawing document was prepared by Soltesz, Inc. (Soltesz). If this document was not obtained directly from Soltesz and/or it was transmitted electronically, Soltesz cannot guarantee that unauthorized changes and / or alterations were not made by others. If verification of the information contained hereon is needed, contact should be made directly with Soltesz. Soltesz makes no warranties, express or implied, concerning the accuracy of any information that has been transmitted by electronic means.

# LEGEND

-  PROPOSED FIRE DEPARTMENT ACCESS LANE
-  PROPOSED FIRE HYDRANT LOCATION
-  PROPOSED NO PARKING/FIRE LANE SIGNS

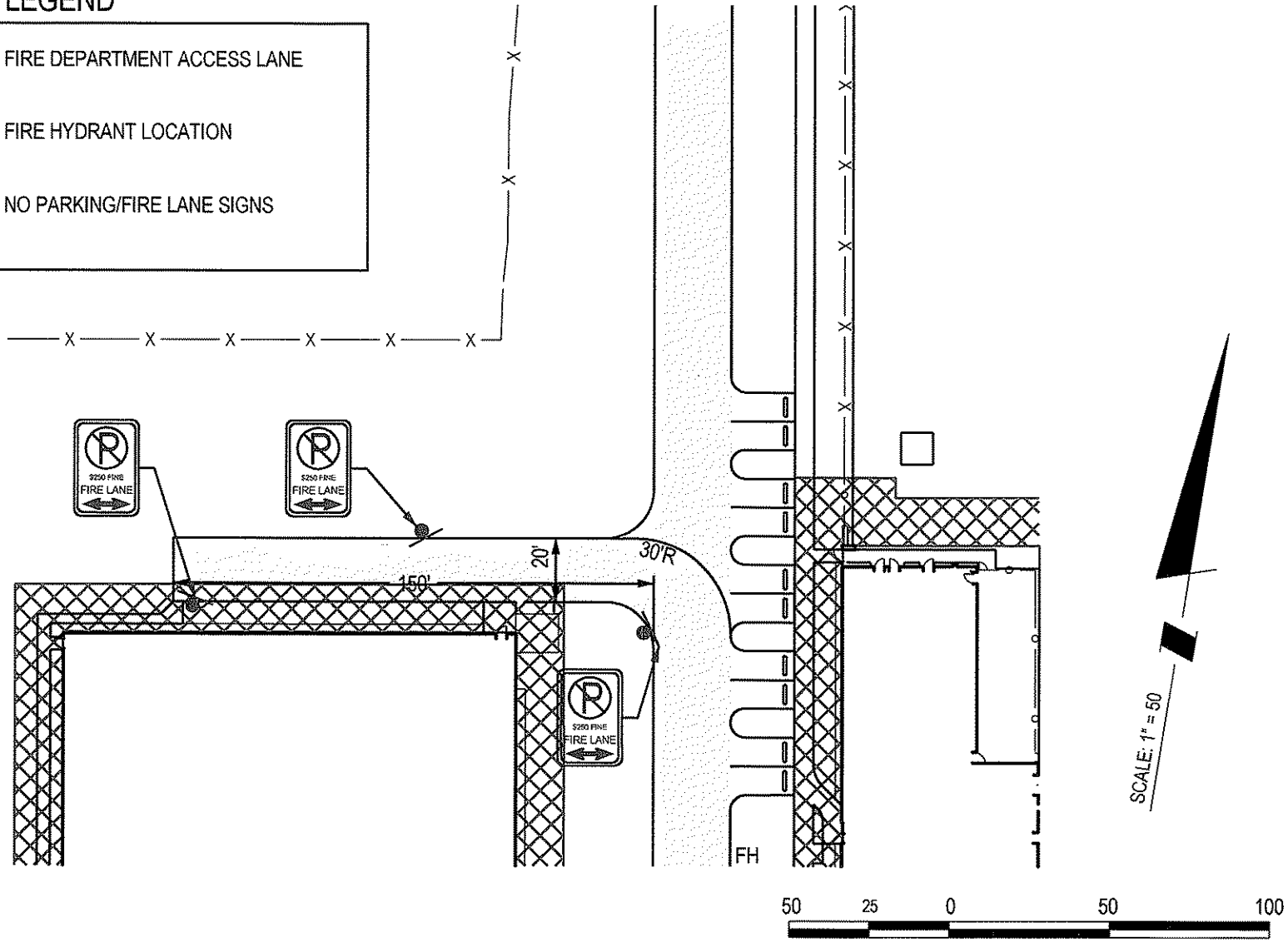

**NOTE:**  
 1. ALL FIRE ACCESS ROUTES MUST BE DESIGNED TO SUPPORT 85,000 lbs.  
 2. FIRE DEPARTMENT ACCESS ROADWAYS LESS THAN 28' MUST HAVE NO PARKING SIGNS SPACED AT NO MORE THAN 100' APART ON BOTH SIDES OF ACCESS ROAD.



**SOLTESZ**  
 2 Research Place, Suite 100  
 Rockville, MD 20850  
 P.301.948.2750 F.301.948.9067  
 www.solteszco.com

**FIRE ORDER SIGNAGE PLAN - PSTA**  
**PSTA & MONTGOMERY COUNTY**  
**MULLTI AGENCY SERVICE PARK**  
 LAYTONSVILLE (1st) ELECTION DISTRICT  
 MONTGOMERY COUNTY, MARYLAND 10 OF 10

JOB NO. 1989-00-00	SCALE 1"= 50'	DATE 06/05/2013
--------------------	---------------	-----------------

The original of this drawing document was prepared by Soltesz, Inc. (Soltesz). If this document was not obtained directly from Soltesz and/or it was transmitted electronically, Soltesz cannot guarantee that unauthorized changes and / or alterations were not made by others. If verification of the information contained hereon is needed, contact should be made directly with Soltesz. Soltesz makes no warranties, express or implied, concerning the accuracy of any information that has been transmitted by electronic means.

1/16/2014 12:08:10 PM