



MONTGOMERY COUNTY EXECUTIVE ORDER

Offices of the County Executive • 101 Monroe Street • Rockville, Maryland 20850

Subject Fire Lane Establishment Order Montgomery Industrial Park	Executive Order No. 177-22	Subject Suffix
Originating Department Montgomery County Department of Permitting Services	Department Number MCDPS 19-22	Effective Date 5/23/2022

Fire Lane Establishment Order

Pursuant to Section 22 - 33, Montgomery County Code, 1971, as amended, you are hereby notified that a Fire Lane has been established as described in this order. You are hereby ordered to post fire lane signs and paint curbs/pavement (painting optional) as identified below. When signs and paint work (painting optional) have been completed, this order will authorize the enforcement of this Fire Lane by appropriate police and fire officials. Compliance with this order must be achieved within 30 days of receipt.

LOCATION: 12263 Prosperity Dr

All areas where indicated by signs and paint.

- SIGNS - - (See attached diagram for location of sign placement)



\$250 FINE

FIRE LANE

Signs must be posted so that it is not possible to park a vehicle without being in sight of a sign. Signs may be no further apart than 100 feet

(Red letters on white background)

- PAINT - - (See attached diagram if painting).

Paint must be traffic yellow with lines of sufficient width to be readily identifiable/readable by motor vehicle operators.

Richard E Merck

Fire Marshal, Montgomery County Department of Permitting Services



MONTGOMERY COUNTY FIRE AND RESCUE SERVICE

Date: May 11, 2022

Fire Lane Establishment Order

Pursuant to Section 22-33, Montgomery County Code, 1971, as amended, you are hereby notified that a Fire Lane has been established as described in this order. You are hereby ordered to post fire lane signs and paint curbs/pavement as identified below. When signs or paint work has been completed, this order will authorize the enforcement of this Fire Lane by appropriate police or fire officials. Compliance with this order must be achieved within 30 days of receipt when any of the following conditions are met:

- One or more structures addressed from the subject road are occupied;
- The road or accessway is available for use and at least one building permit for an address on the subject road has been issued; or
- The road or accessway is necessary fire department access.

LOCATION: Grocer (Building A) proposed at the SE Quadrant of the intersection of Prosperity Drive and Industrial Parkway

ADDRESS: 12263 Prosperity Drive
Silver Spring, MD 20904

Delineate all areas where indicated by signs and/or paint.

SIGNS -- (See attached diagram for location of sign placement)



(Red letters on white background)

Signs must be posted so that it is not possible to park a vehicle without being in sight of a sign. Signs may be no further apart than 100 feet.

PAINT -- (See attached diagram when painting is required)

Paint must be traffic yellow with lines of sufficient width to be readily identifiable/readable by motor vehicle operators.

LS1189

Signature of Order Writer/I.D. #

May 19, 2022

Cc: Fire Code Enforcement Section
Attachment: Fire Lane Diagram

FIRE LANE ESTABLISHMENT FORM

BUILDING OR SUBDIVISION NAME: Montgomery Industrial Park

FIRE LANE LOCATION/ADDRESS: 12263 Prosperity Drive, Silver Spring, MD 20904
SE Quadrant, Intersection of Prosperity Drive and Industrial Parkway

See attached drawing for designated fire lanes:

I have received the drawing and instructions for installing the designated fire lanes on property not owned by state or local government.

NAME AND TITLE OF PROPERTY REPRESENTATIVE

NAME: Robert Sandler TITLE: Executive Vice President

SIGNATURE: 

PHONE: 202-363-6301 DATE: 3/22/2022

ADDRESS (where processed order will be mailed):

5301 Wisconsin Avenue, NW, Suite 500, Washington, DC 20015

The designated fire lanes are the minimum necessary for fire/rescue access and are in accordance with Section 22-33 of the Fire Safety Code.

NAME: Marie LaBaw SIGNATURE: 

STA.#: DPS I.D.#: LS1189 DATE: May 19, 2022

Comments: _____

Fire Lane Installed Per Order

NAME: _____ DATE: _____

PROSPERITY DRIVE

H:\21\WB21\2016\DRAWINGS\PLAN SETS\SITE PLAN SUPPLEMENTAL\FDA\MB212016\FDA-2-...->LAYOUT: FIRE LANE ORDER (8.5X11)

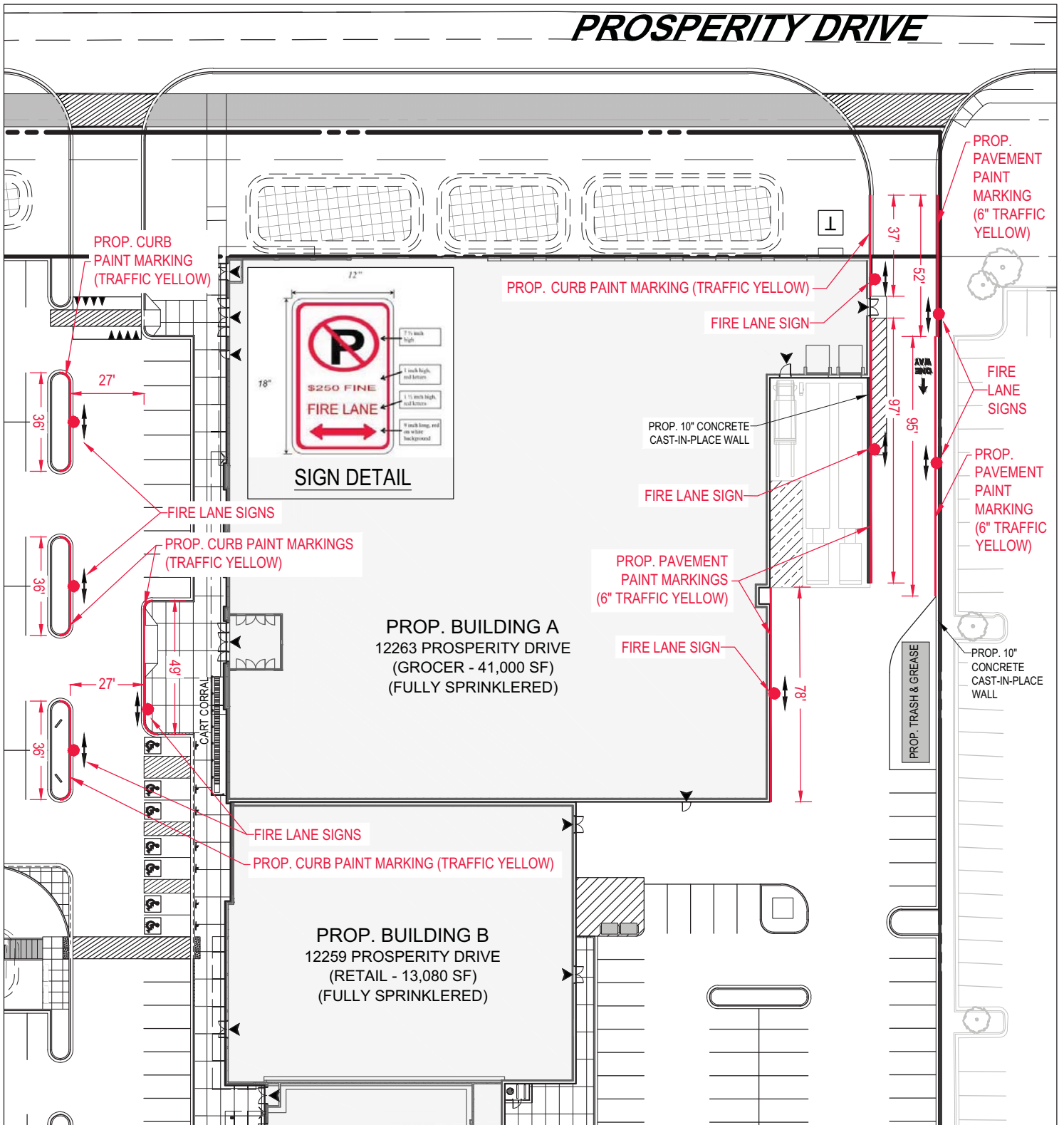

05.11.2022 | LMW | MB212105 | REV. 2

BOHLER //

16701 MELFORD BLVD, SUITE 310
BOWIE, MARYLAND 20715
Phone: (301) 809-4500
Fax: (301) 809-4501
MD@BohlerEng.com

FIRE LANE ESTABLISHMENT ORDER DIAGRAM



12263 PROSPERITY DR
SILVER SPRING, MD 20904

