



MONTGOMERY COUNTY EXECUTIVE ORDER

Offices of the County Executive • 101 Monroe Street • Rockville, Maryland 20850

Subject Fire Lane Establishment Order for Clopper Mill Elementary School	Executive Order No. 181-16	Subject Suffix
Originating Department Montgomery County Department of Permitting Services	Department Number MCDPS 47-16	Effective Date 12/01/2016

Fire Lane Establishment Order

Pursuant to Section 22 - 33, Montgomery County Code, 1971, as amended, you are hereby notified that a Fire Lane has been established as described in this order. You are hereby ordered to post fire lane signs and paint curbs/pavement (painting optional) as identified below. When signs and paint work (painting optional) have been completed, this order will authorize the enforcement of this Fire Lane by appropriate police and fire officials. Compliance with this order must be achieved within 30 days of receipt.

LOCATION: 18501 Cinnamon Dr.

All areas where indicated by signs and paint.

SIGNS - - (See attached diagram for location of sign placement)



\$250 FINE

FIRE LANE

Signs must be posted so that it is not possible to park a vehicle without being in sight of a sign. Signs may be no further apart than 100 feet

(Red letters on white background)

PAINT - - (See attached diagram if painting).

Paint must be traffic yellow with lines of sufficient width to be readily identifiable/readable by motor vehicle operators.

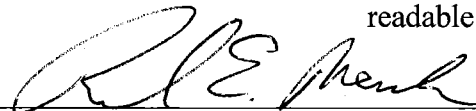

Fire Marshal, Montgomery County Department of Permitting Services

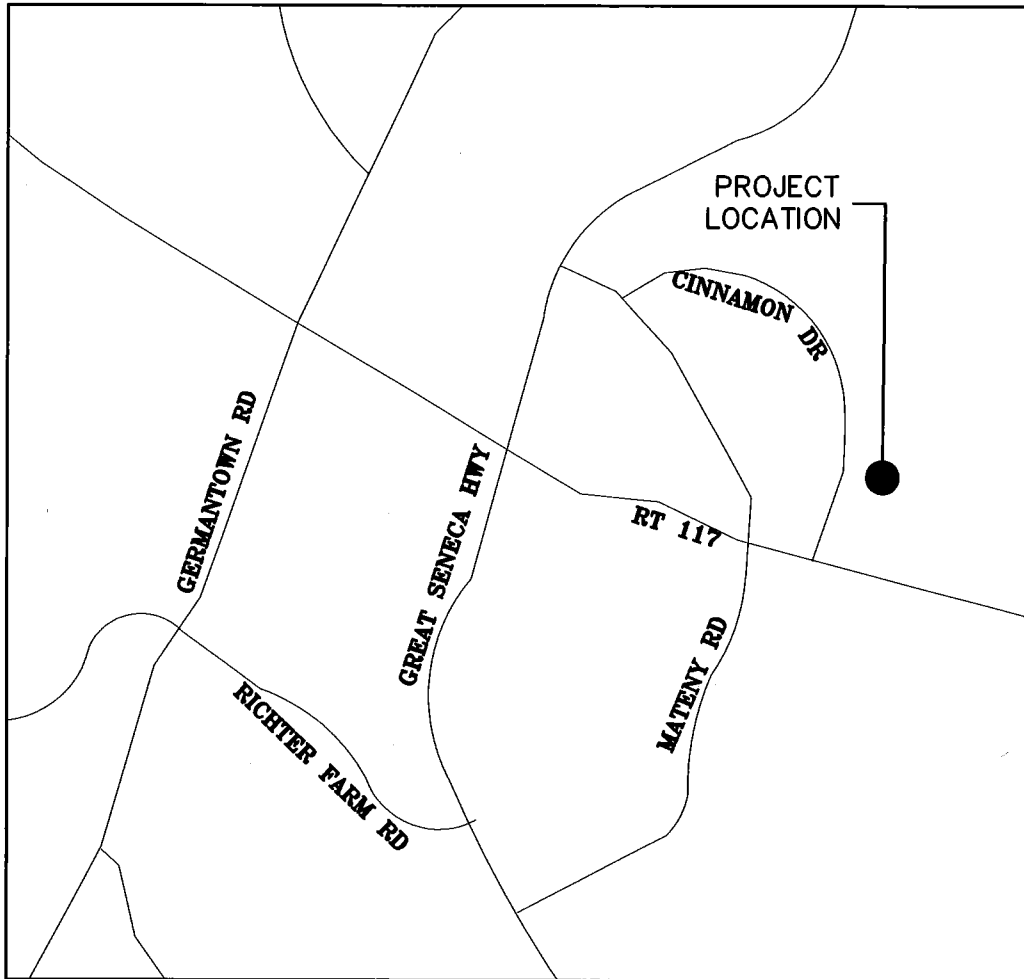

VICINITY MAP

SCALE: 1"=2000'

S1

S2

S3



FIRE LANE SIGNS

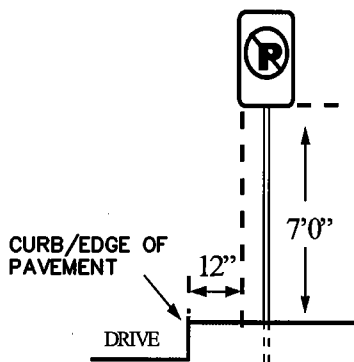

SIGN PLACEMENT DIAGRAM

GENERAL NOTES:

1. SIGNS TO BE CONSISTENT WITH THE MONTGOMERY COUNTY FIRE AND RESCUE (MCFR) GUIDELINES
2. FIRE LANE SIGNS TO BE 12" WIDE BY 18" HIGH



Engineering a Sustainable Future
 Nobis Engineering, Inc.
 20410 Century Blvd Suite 230
 Germantown, MD 20874
 T(301) 528-2010
 www.nobiseng.com
 Client - Focused, Employee - Owned

CLOPPER MILL ELEMENTARY SCHOOL
 18501 CINNAMON DR,
 GERMANTOWN, MD 20874
 FIRE LANE ACCESS PLAN

JOB NO.: 86980.58

SCALE: 1"=2000'

DATE: NOVEMBER 2016

SHEET NO:
 1 OF 2

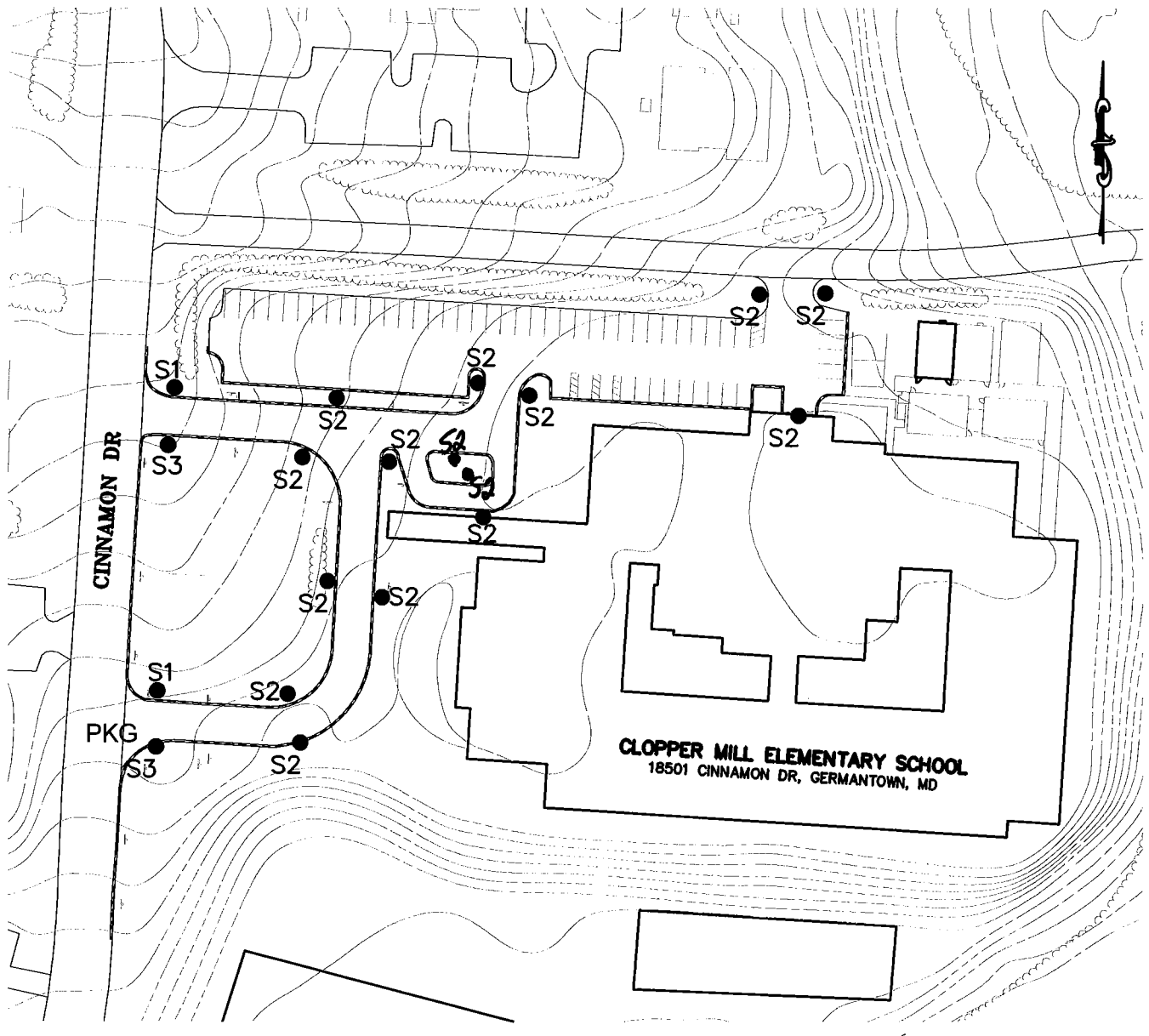

FIRE LANE PLAN
1"=100'

LEGEND

- FIRE LANE SIGN (TYP)



Engineering a Sustainable Future
Nobis Engineering, Inc.
20410 Century Blvd Suite 230
Germantown, MD 20874
T(301) 528-2010
www.nobiseng.com
Client - Focused, Employee - Owned

CLOPPER MILL ELEMENTARY SCHOOL
18501 CINNAMON DR,
GERMANTOWN, MD 20874
FIRE LANE ACCESS PLAN

JOB NO.: 86980.58

SCALE: 1"=100'

DATE: NOVEMBER 2016

SHEET NO:
2 OF 2