



# MONTGOMERY COUNTY EXECUTIVE ORDER

Offices of the County Executive • 101 Monroe Street • Rockville, Maryland 20850

Subject Fire Lane Establishment Order for Stonegate Elementary School	Executive Order No. 182-16	Subject Suffix
Originating Department Montgomery County Department of Permitting Services	Department Number MCDPS 48-16	Effective Date 12/01/2016

### Fire Lane Establishment Order

Pursuant to Section 22 - 33, Montgomery County Code, 1971, as amended, you are hereby notified that a Fire Lane has been established as described in this order. You are hereby ordered to post fire lane signs and paint curbs/pavement (painting optional) as identified below. When signs and paint work (painting optional) have been completed, this order will authorize the enforcement of this Fire Lane by appropriate police and fire officials. Compliance with this order must be achieved within 30 days of receipt.

LOCATION: 14811 Notley Rd.  
\_\_\_\_\_  
\_\_\_\_\_

All areas where indicated by signs and paint.

SIGNS - - (See attached diagram for location of sign placement)



\$250 FINE

FIRE LANE

Signs must be posted so that it is not possible to park a vehicle without being in sight of a sign. Signs may be no further apart than 100 feet

\_\_\_\_\_  
(Red letters on white background)

PAINT - - (See attached diagram if painting).

Paint must be traffic yellow with lines of sufficient width to be readily identifiable/readable by motor vehicle operators.

\_\_\_\_\_  
Fire Marshal, Montgomery County Department of Permitting Services

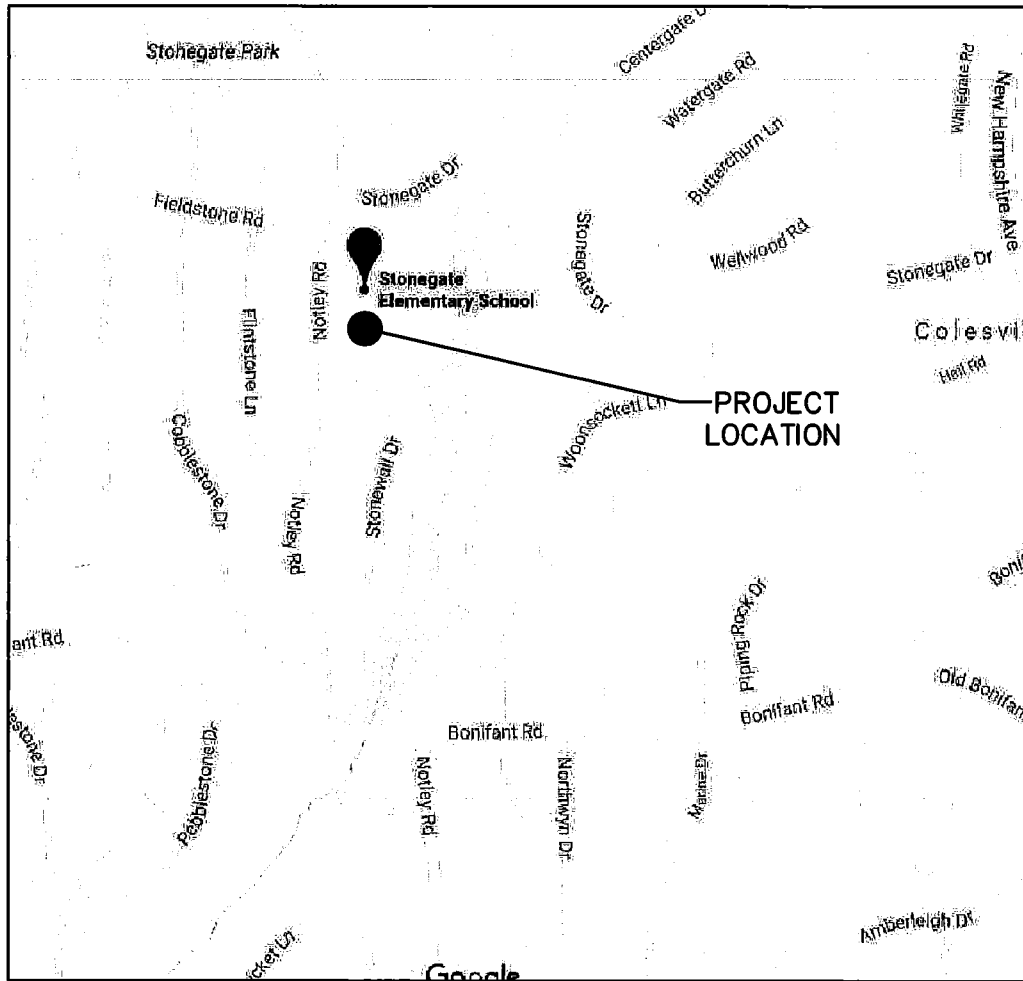

## VICINITY MAP

SCALE: 1"=1000'

S1

S2

S3



FIRE LANE SIGNS

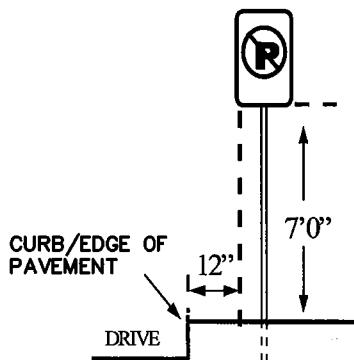

SIGN PLACEMENT DIAGRAM

### GENERAL NOTES:

1. SIGNS TO BE CONSISTENT WITH THE MONTGOMERY COUNTY FIRE AND RESCUE (MCFR) GUIDELINES
2. FIRE LANE SIGNS TO BE 12" WIDE BY 18" HIGH



Engineering a Sustainable Future

Nobis Engineering, Inc.  
20410 Century Blvd Suite 230  
Germantown, MD 20874  
T(301) 528-2010  
www.nobiseng.com

Client - Focused, Employee - Owned

STONEGATE ELEMENTARY SCHOOL  
14811 NOTLEY ROAD, SILVER  
SPRING, MD 20905

FIRE LANE ACCESS PLAN

JOB NO.: 86980.60

SCALE: 1"=2000'

DATE: NOVEMBER 2016

SHEET NO:

1 OF 2

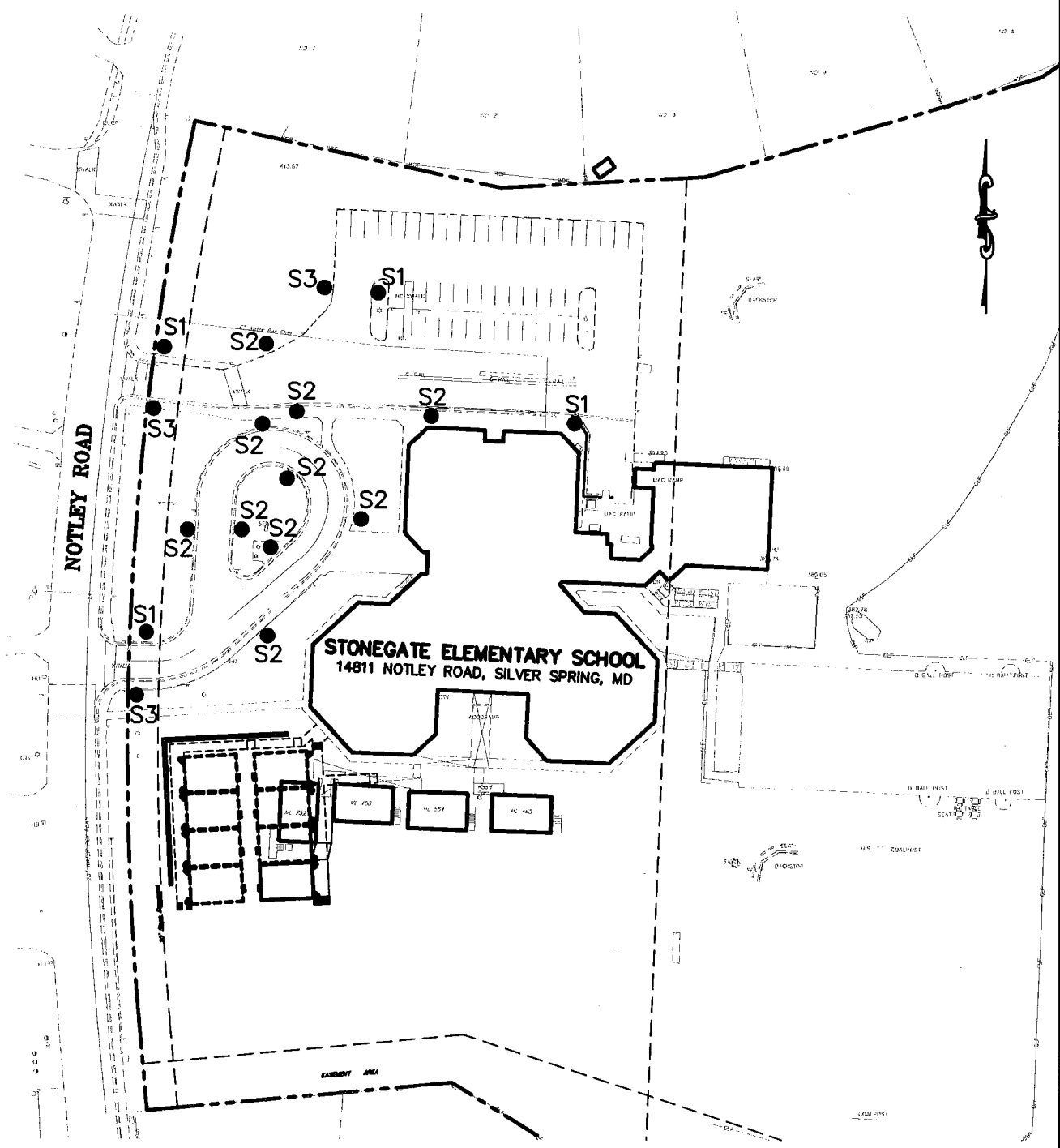

**FIRE LANE PLAN**  
1"=100'

**LEGEND**

- FIRE LANE SIGN (TYP)



**Engineering a Sustainable Future**  
Nobis Engineering, Inc.  
20410 Century Blvd Suite 230  
Germantown, MD 20874  
T(301) 528-2010  
www.nobiseng.com  
Client - Focused, Employee - Owned

**STONEGATE ELEMENTARY SCHOOL**  
14811 NOTLEY ROAD, SILVER  
SPRING, MD 20905  
FIRE LANE ACCESS PLAN

JOB NO.: 86980.60

SCALE: 1"=100'

DATE: NOVEMBER 2016

SHEET NO:  
2 OF 2