



# MONTGOMERY COUNTY EXECUTIVE ORDER

Offices of the County Executive • 101 Monroe Street • Rockville, Maryland 20850

Subject Fire Lane Establishment Order Washington Spanish Bilingual SDA Church	Executive Order No. 188-25	Subject Suffix
Originating Department Montgomery County Department of Permitting Services	Department Number MCDPS 27-25	Effective Date 12/3/2025

Fire Lane Establishment Order

Pursuant to Section 22 - 33, Montgomery County Code, 1971, as amended, you are hereby notified that a Fire Lane has been established as described in this order. You are hereby ordered to post fire lane signs and paint curbs/pavement (painting optional) as identified below. When signs and paint work (painting optional) have been completed, this order will authorize the enforcement of this Fire Lane by appropriate police and fire officials. Compliance with this order must be achieved within 30 days of receipt.

LOCATION: 12604 New Hampshire Ave.  
\_\_\_\_\_  
\_\_\_\_\_

All areas where indicated by signs and paint.

☒ SIGNS - - (See attached diagram for location of sign placement)



\$250 FINE

FIRE LANE

Signs must be posted so that it is not possible to park a vehicle without being in sight of a sign. Signs may be no further apart than 100 feet

\_\_\_\_\_  
(Red letters on white background)

☒ PAINT - - (See attached diagram if painting).

Paint must be traffic yellow with lines of sufficient width to be readily identifiable/readable by motor vehicle operators.

Pastora Warnick 12/5/2025 \_\_\_\_\_  
Fire Marshal, Montgomery County Department of Permitting  
Services



## MONTGOMERY COUNTY FIRE AND RESCUE SERVICE

Date: 11/24/2025

### Fire Lane Establishment Order

Pursuant to Section 22-33, Montgomery County Code, 1971, as amended, you are hereby notified that a Fire Lane has been established as described in this order. You are hereby ordered to post fire lane signs and paint curbs/pavement as identified below. When signs or paint work has been completed, this order will authorize the enforcement of this Fire Lane by appropriate police or fire officials. Compliance with this order must be achieved within 30 days of receipt when any of the following conditions are met:

- One or more structures addressed from the subject road are occupied;
- The road or accessway is available for use and at least one building permit for an address on the subject road has been issued; or
- The road or accessway is necessary fire department access.

LOCATION: Washington Spanish Bilingual SDA Church - Gym Addition  
12604 New Hampshire Avenue, Silver Spring, MD 20904

Delineate all areas where indicated by signs and/or paint.

☒ **SIGNS** -- (See attached diagram for location of sign placement)



(Red letters on white background)

Signs must be posted so that it is not possible to park a vehicle without being in sight of a sign. Signs may be no further apart than 100 feet.

☒ **PAINT** -- (See attached diagram when painting is required)

Paint must be traffic yellow with lines of sufficient width to be readily identifiable/readable by motor vehicle operators.

LS1189

Signature of Order Writer/I.D. #

November 26, 2025

Cc: Fire Code Enforcement Section  
Attachment: Fire Lane Diagram

## FIRE LANE ESTABLISHMENT FORM

BUILDING OR SUBDIVISION NAME: Washington Spanish Bilingual SDA ChurchFIRE LANE LOCATION/ADDRESS: 12604 New Hampshire Avenue, Silver Spring, MD 20904

See attached drawing for designated fire lanes:

I have received the drawing and instructions for installing the designated fire lanes on property not owned by state or local government.

NAME AND TITLE OF PROPERTY REPRESENTATIVENAME: Darryl Hevener TITLE: Associate TreasurerSIGNATURE: PHONE: 540-886-0771 Ext 115 DATE: 11/24/2025

ADDRESS (where processed order will be mailed):

115 M.II Place Pkwy, Verona, Va. 24482 darylh@pcsda.org

The designated fire lanes are the minimum necessary for fire/rescue access and are in accordance with Section 22-33 of the Fire Safety Code.

NAME: Marie LaBaw SIGNATURE: STA.#: DPS I.D.#: LS1189 DATE: November 26, 2025

Comments: \_\_\_\_\_

Fire Lane Installed Per Order

NAME: \_\_\_\_\_ DATE: \_\_\_\_\_

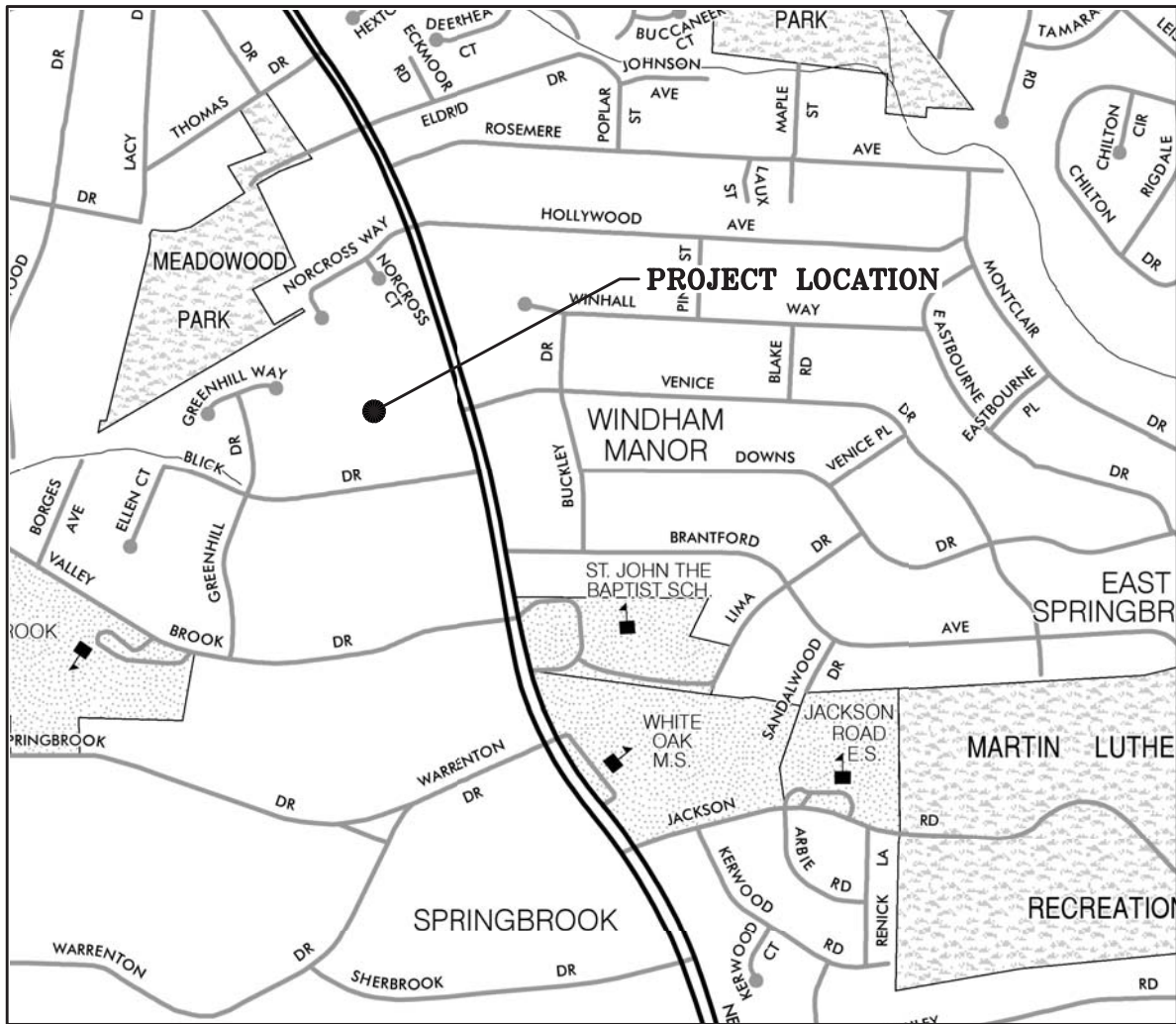

**VICINITY MAP**  
SCALE: 1" = 1000'

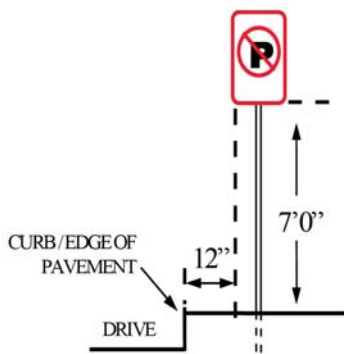

**SIGN PLACEMENT DIAGRAM**



**FIRE LANE SIGNS**

**GENERAL NOTES:**

1. SIGNS TO BE CONSISTENT WITH THE MONTGOMERY COUNTY FIRE AND RESCUE (MCFR) GUIDELINES
2. FIRE LANE SIGNS TO BE 12" WIDE BY 18" HIGH



**CLARK | AZAR & ASSOCIATES**  
20440 Century Blvd, Suite 220  
Germantown, MD. 20874  
T(301) 528-2010  
www.clarkazar.com  
A Woman Owned Small Business

WASHINGTON SPANISH BILINGUAL SDA CHURCH  
GYM ADDITION  
12604 NEW HAMPSHIRE AVENUE  
SILVER SPRING, MD 20904  
FIRE LANE ORDER DETAILS

JOB NO.: 946.001

SCALE: 1" = 1000'

DATE: NOVEMBER 2025

SHEET NUMBER:

1 OF 2



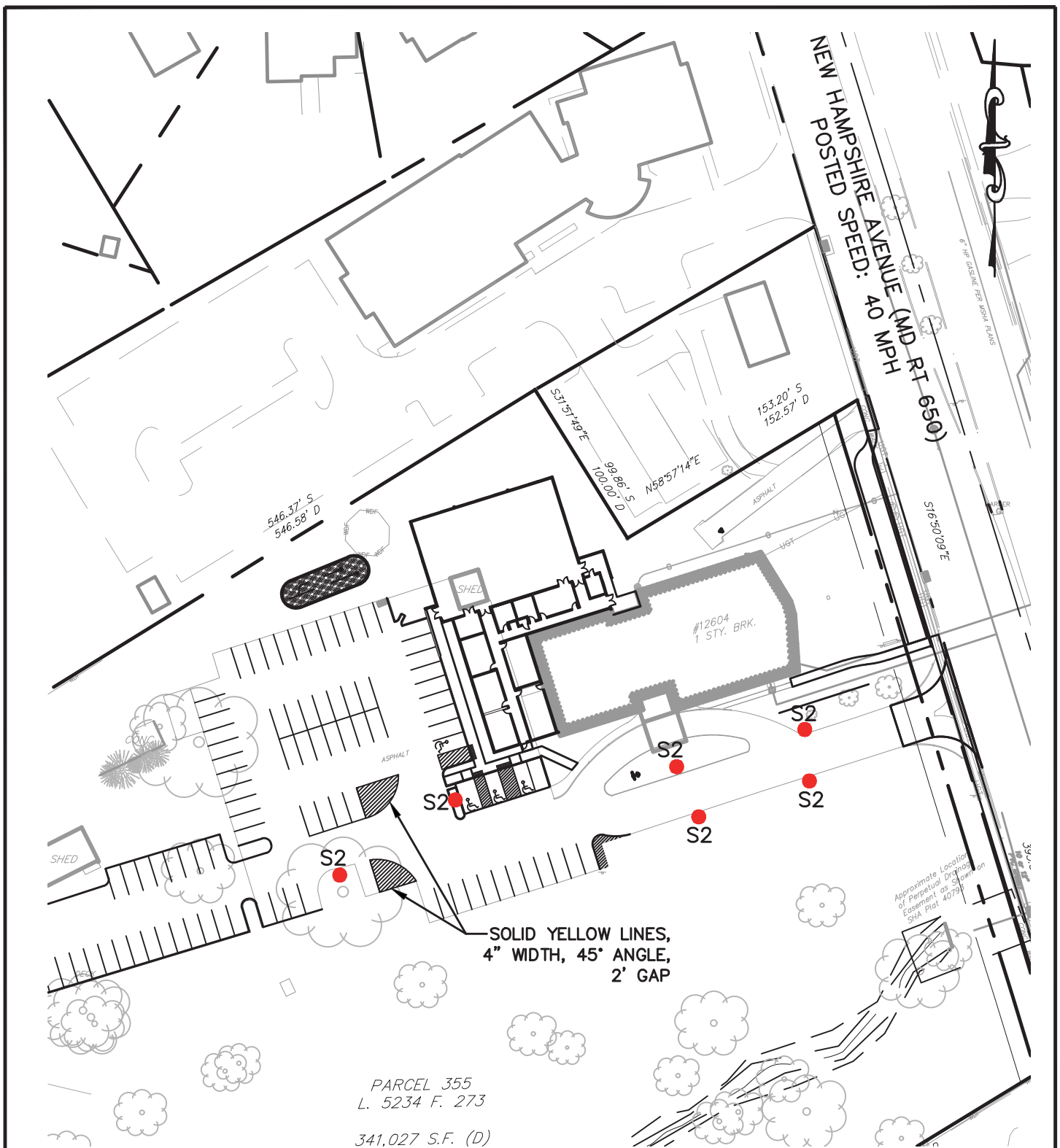

PARCEL 355  
L. 5234 F. 273  
341,027 S.F. (D)

**FIRE LANE PLAN**  
SCALE: 1" = 80'

LEGEND	
S2	FIRE LANE SIGN (TYP.)



**CLARK | AZAR & ASSOCIATES**  
20440 Century Blvd, Suite 220  
Germantown, MD. 20874  
T(301) 528-2010  
www.clarkazar.com  
A Woman Owned Small Business

WASHINGTON SPANISH BILINGUAL SDA CHURCH  
GYM ADDITION  
12604 NEW HAMPSHIRE AVENUE  
SILVER SPRING, MD 20904  
FIRE LANE ORDER SIGNAGE PLAN

JOB NO.: 946.001

SCALE: 1" = 1000'

DATE: NOVEMBER 2025

SHEET NUMBER:

2 OF 2